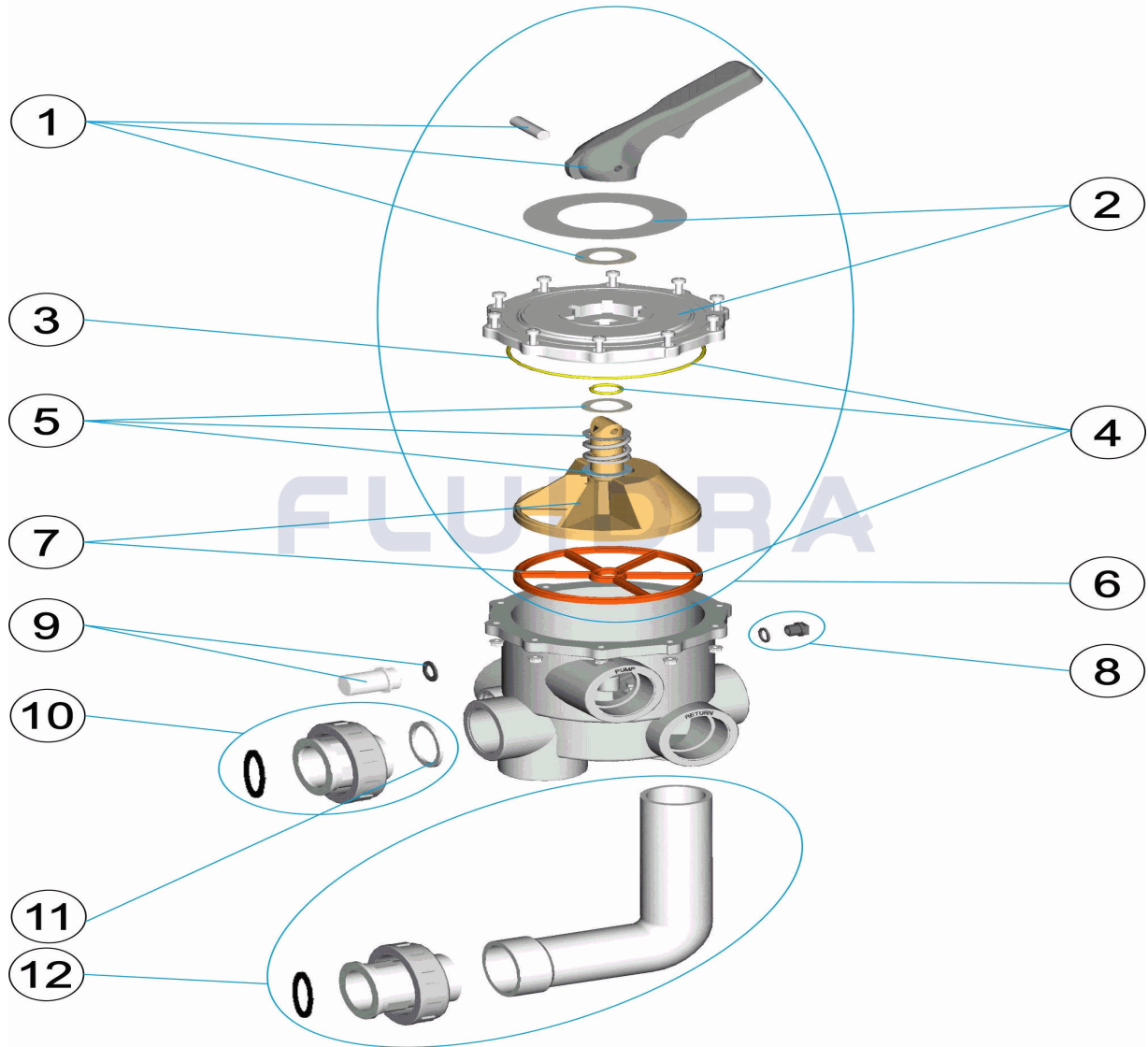
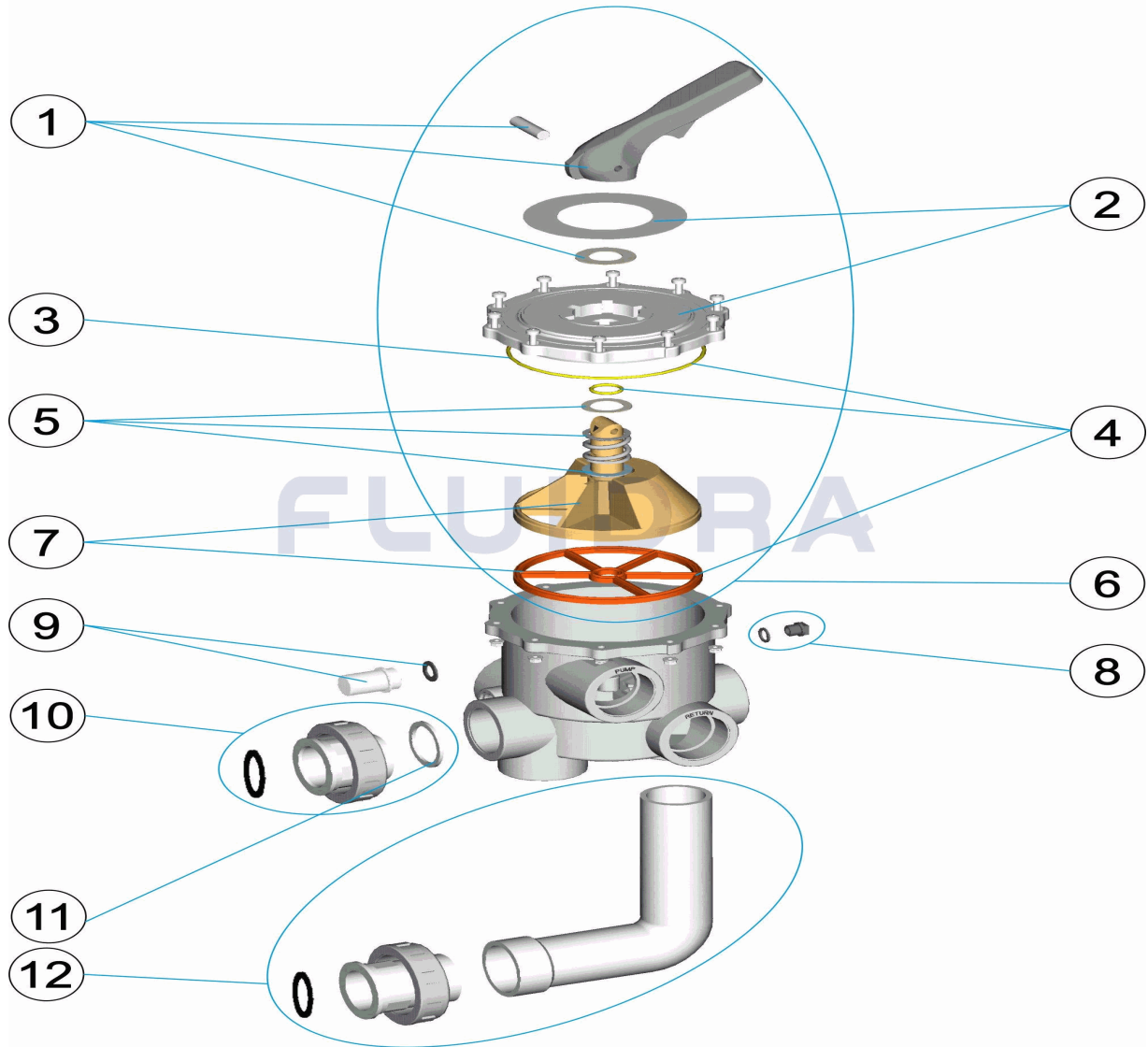

CODIGO **PS-6202**

 DESCRIPCION: **VALVULA SELECTORA CON ENLACES 2"**

ESPAÑOL

POS	CODIGO	DESCRIPCION	CANTIDAD	POS	CODIGO	DESCRIPCION	CANTIDAD
1	SP-04-0109	MANETA 2" MNB BLANCA NEUTR "		7	SP-04-0053	DISTRIBUIDOR CON JUNTAS 2' NUEVO	
2	SP-04-0110	TAPA VALVULA S. 2" MNB BLANC "		8	SP-04-0054	TAPON 1/4" VALVULA NUEV "	
3	SP-04-0050	JUNTA TORICA TAPA 2"		9	SP-04-0007	VISOR CON JUNTA	
4	SP-04-0051	JUNTAS VALVULA 2'		10	SP-04-0112	ENLACE RECTO BLANCO 2' NUEVO	
5	SP-04-0041	RESORTE CON ARANDELAS		11	SP-04-0056	JUNTAS ENLACE 2'	
6	SP-04-0111	CJTO. SUPERIOR 2"		12	SP-04-0113	ENLACE ACODADO BLANCO 2' NUEVO	

CODE **PS-6202**

 DESCRIPTION: **SÉLECTEUR AVEC LIENS 2"**

FRANCAIS

POS	CODE	DESCRIPTION	QUANTITE	POS	CODE	DESCRIPTION	QUANTITE
1	SP-04-0109	POIGNEE BLANCHE 2"		7	SP-04-0053	BOISSEAU AVEC JOINTS 2"	
2	SP-04-0110	DESSUS DE VANNE 2"		8	SP-04-0054	BOUCHON 1/4" VANNE NOUVEA "	
3	SP-04-0050	JOINT TORIQUE COUVERCLE 2"		9	SP-04-0007	VOYANT ET JOINT	
4	SP-04-0051	JOINTS DE VANNE 2"		10	SP-04-0112	SORTIE DROITE BLANCHE 2" NOUVEAU MC	
5	SP-04-0041	RESSORT ET RONDELLES		11	SP-04-0056	JOINTS DE SORTIES 2"	
6	SP-04-0111	ENSEMBLE SUPÉRIEUR 2"		12	SP-04-0113	SORTIE COUDEE BLANCHE 2" NOUVEAU M	

CODE PS-6202

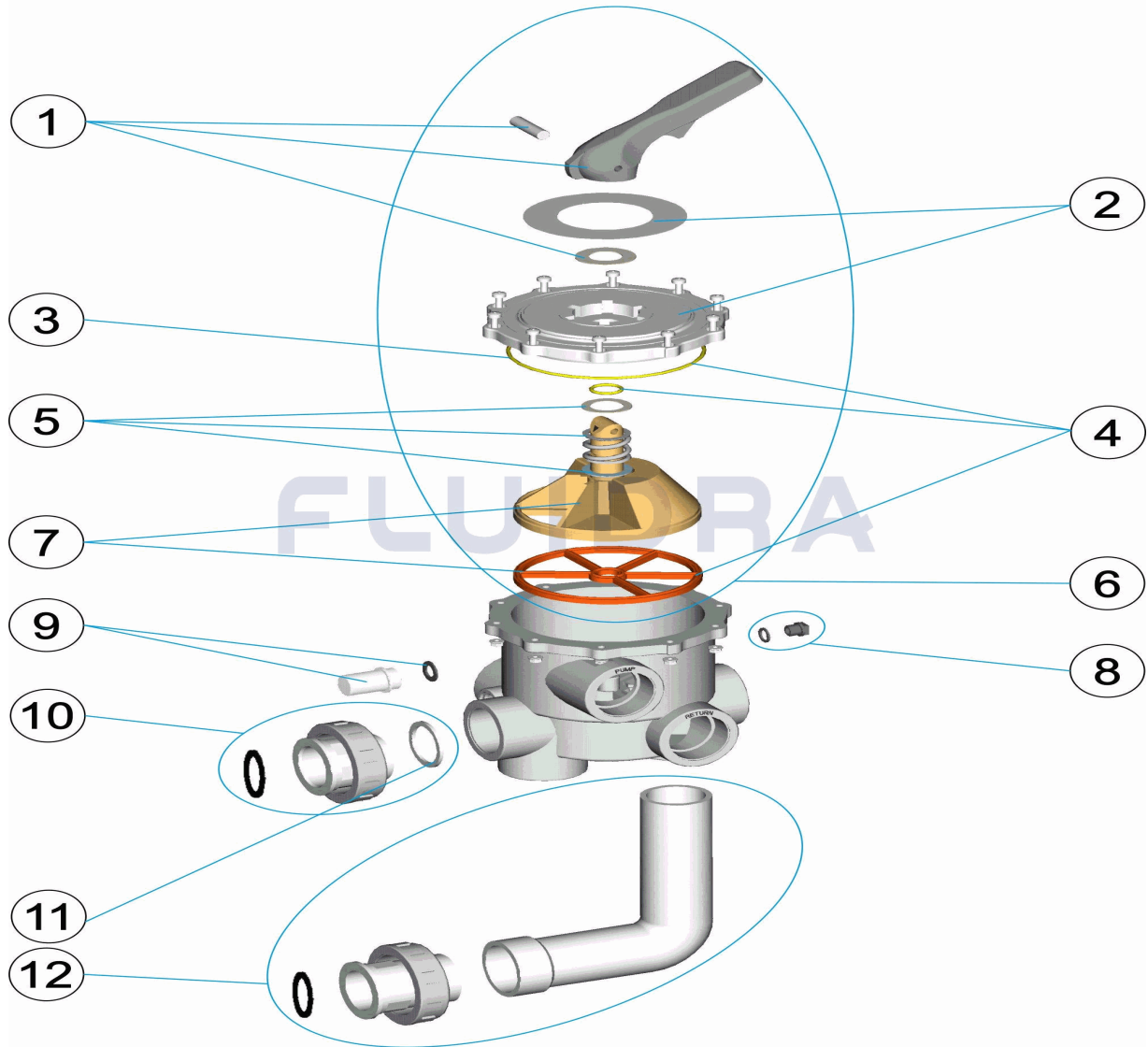
DESCRIPTION: SELECTOR VALVE WITH LINKS 2"



ENGLISH

POS	CODE	DESCRIPTION	QUANTITY	POS	CODE	DESCRIPTION	QUANTITY
1	SP-04-0109	WHITE HANDLE 2'		7	SP-04-0053	DISTRIBUTOR WITH GASKETS 2' NEW	
2	SP-04-0110	COVERS SELECTOR VALVE 2		8	SP-04-0054	NEW 1/4" VALVE CA "	
3	SP-04-0050	2" LID 'O' RING "		9	SP-04-0007	VISOR WITH SEAL	
4	SP-04-0051	GASKETS 2'		10	SP-04-0112	UNION WHITE 2' NEW	
5	SP-04-0041	SPRING WITH WASHERS		11	SP-04-0056	UNION SEALS 2'	
6	SP-04-0111	SET. SUPERIOR 2		12	SP-04-0113	ELBOW WHITE 2' NEW	

CODICE **PS-6202**

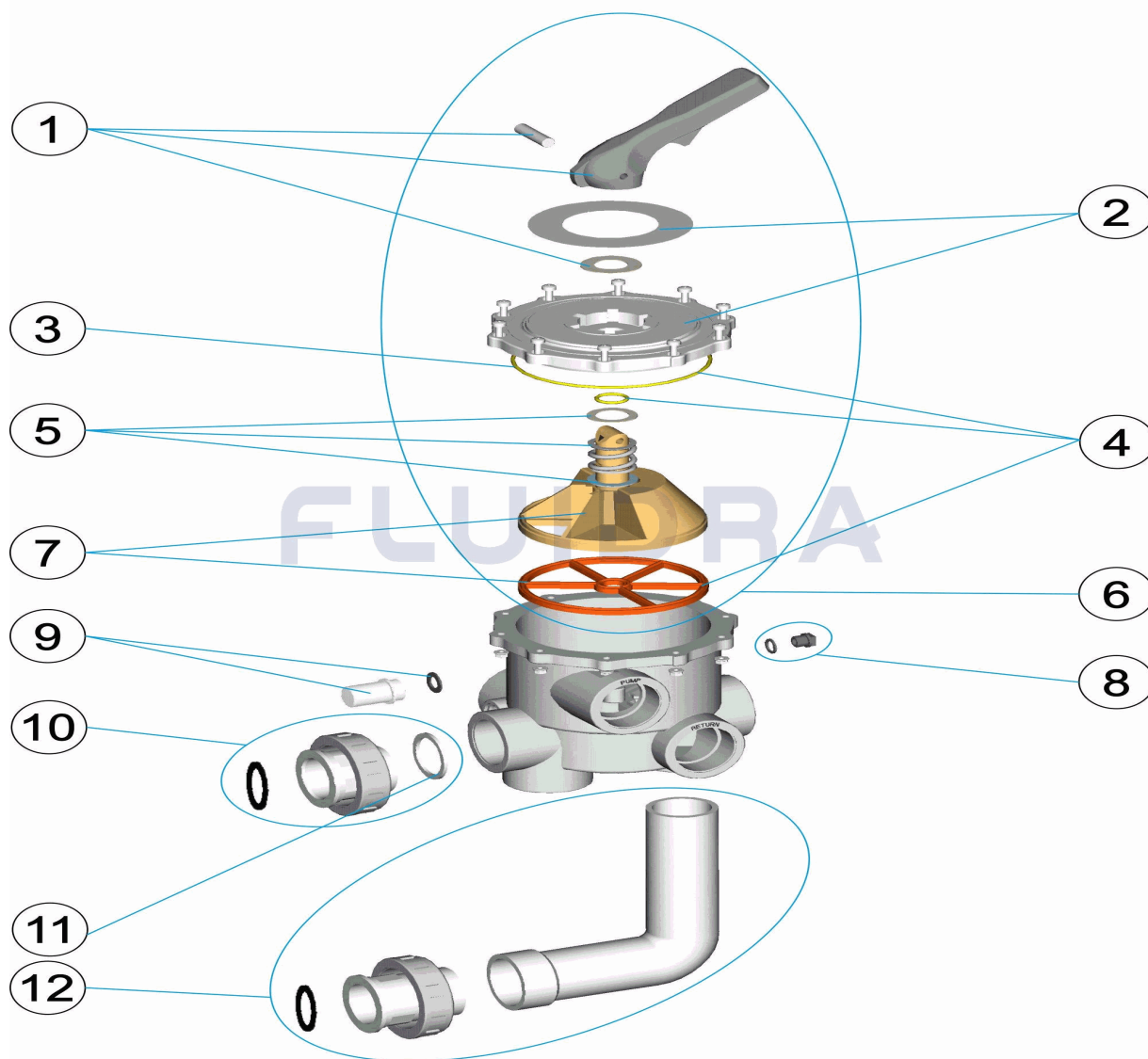
 DESCRIZIONE: **VALVOLA SELETRICE CON COLLEGAMENTI 2"**

ITALIANO

POS	CODICE	DESCRIZIONE	QUANTITA'	POS	CODICE	DESCRIZIONE	QUANTITA'
1	SP-04-0109	MANIGLIA BIANCA 2'		7	SP-04-0053	DISTRIBUTORE CON GUARNIZIONI 2' NUO	
2	SP-04-0110	COPERCHIO VALVOLA 2"		8	SP-04-0054	GUARNIZIONE SAGOMATA + GURANIZIONE	
3	SP-04-0050	O-RING COPERCHIO 2"		9	SP-04-0007	VISORE CON GUARNIZIONE	
4	SP-04-0051	GUARNIZIONI VALVOLA 2'		10	SP-04-0112	GUARNIZIONE PER RACCORDO 2" BIANC '	
5	SP-04-0041	MOLLA CON RONDELLA		11	SP-04-0056	GUARNIZIONE PER RACCORDO 2'	
6	SP-04-0111	KIT PARTE SUPERIORE SELETRICE 2"		12	SP-04-0113	RACCORDO A GOMITO BIANCO 2' NUOVO	

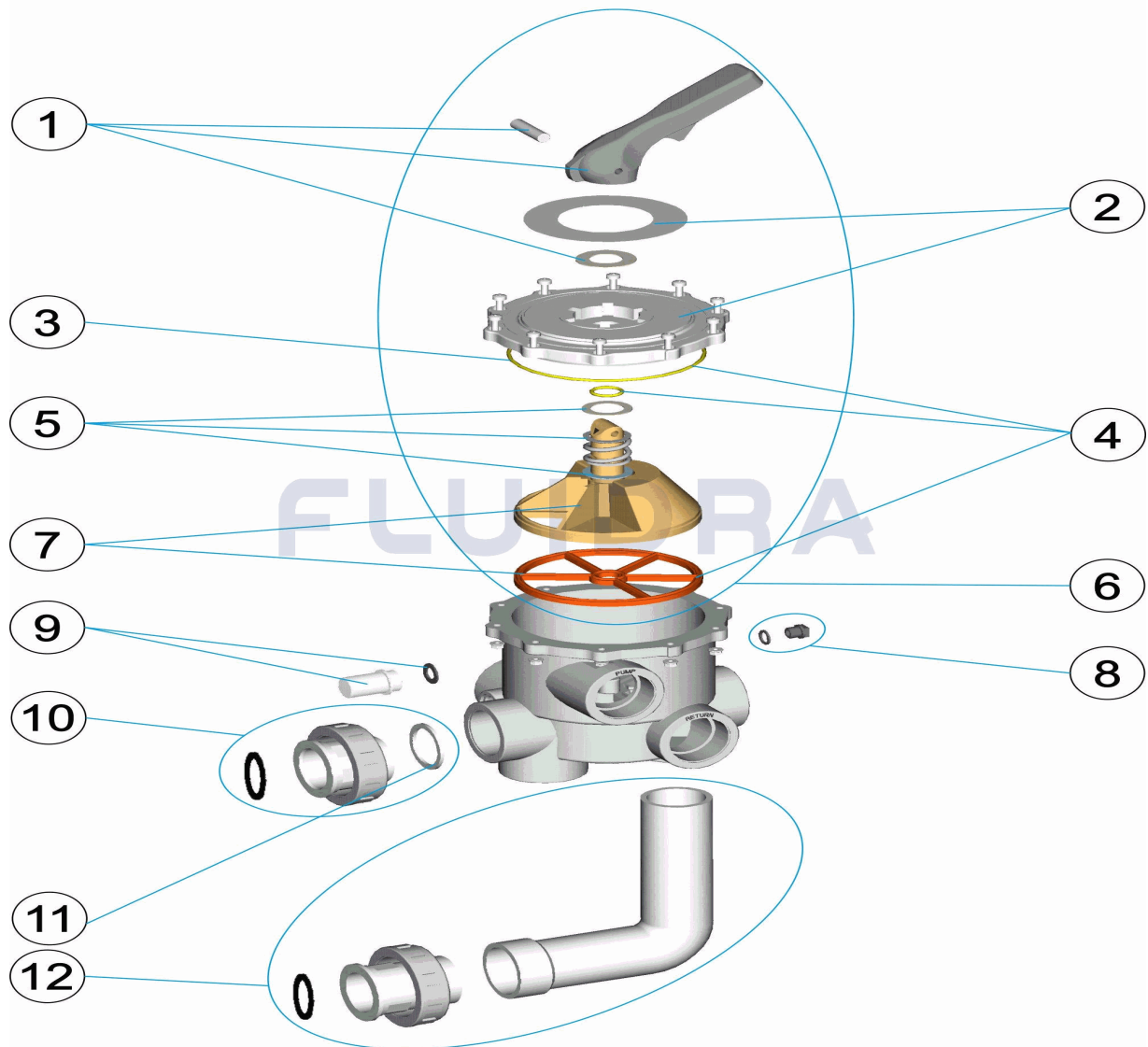
CODE

PS-6202
BESCHREIBUNG: MEHRWEGVENTIL MIT ANSCHLÜSSEN 2"

DEUTSCH

POS	CODE	BESCHREIBUNG	MENGE	POS	CODE	BESCHREIBUNG	MENGE
1	SP-04-0109	GRIFF 2" MNB WEISS NEUTRA "		7	SP-04-0053	VERTEILER UND DICHTUNGEN 2' NEUVER!	
2	SP-04-0110	VENTILABDECKUNG S. 2" MNB WEIS "		8	SP-04-0054	STOPFEN 1/4" VENTIL NEUVERSIO "	
3	SP-04-0050	O-RING ABDECKUNG 2"		9	SP-04-0007	SCHAUGLAS UND DICHTUNG	
4	SP-04-0051	VENTILDICHTUNGEN 2'		10	SP-04-0112	ANSCHLUSS GERADE WEISS 2' NEUVERSI	
5	SP-04-0041	FEDER MIT UNTERLEGSCHIEBEN		11	SP-04-0056	DICHTUNGEN ANSCHLUSS 2'	
6	SP-04-0111	SET OBEN 2"		12	SP-04-0113	ANSCHLUSSWINKEL WEISS 2' NEUVERSIO	

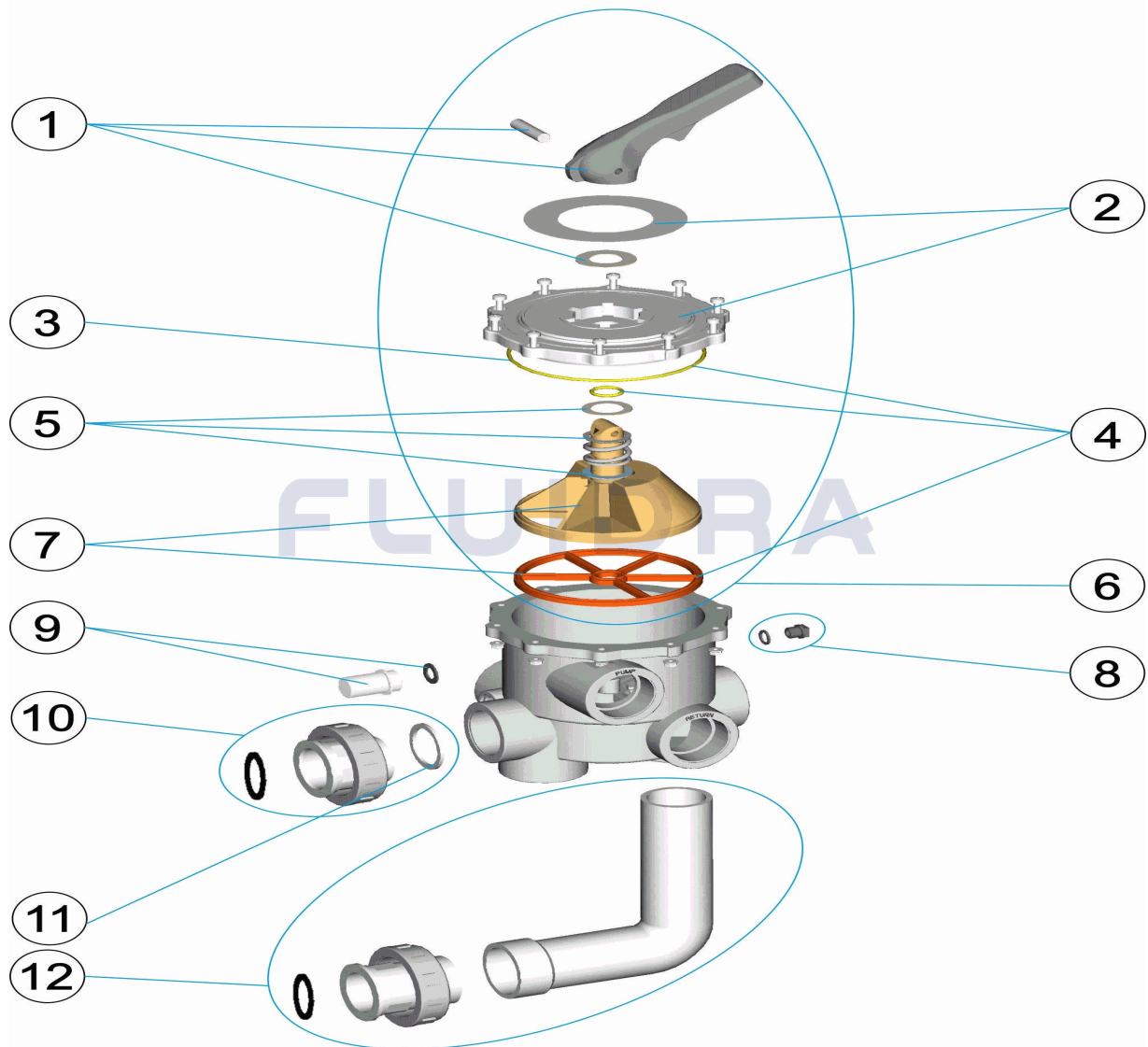
CODIGO **PS-6202**

 DESCRIÇÃO: **VÁLVULA SELECTORA COM LIGAÇÕES 2"**

PORTUGUES

POS	CODIGO	DESCRIÇÃO	JANTIDADE	POS	CODIGO	DESCRIÇÃO	JANTIDADE
1	SP-04-0109	MANIPULO BRANCO 2'		7	SP-04-0053	DISTRIBUIDOR COM JUNTAS 2' NOVO	
2	SP-04-0110	TAMPA VALVULA 2"		8	SP-04-0054	TAMPAO 1/4" VALVULA NOV "	
3	SP-04-0050	JUNTA TÓRICA TAMPA 2"		9	SP-04-0007	VISOR COM JUNTA	
4	SP-04-0051	JUNTAS VÁLVULA 2"		10	SP-04-0112	LIGAÇÃO RECTA BRANCA 2' NOVA	
5	SP-04-0041	MOLA COM ANILHAS		11	SP-04-0056	JUNTAS LIGAÇÃO 2'	
6	SP-04-0111	CONJUNTO SUPERIOR 2"		12	SP-04-0113	LIGAÇÃO CURVA BRANCA 2' NOVA	