

CODIGO **PS-6104**

DESCRIPCION: **VALVULA SELECTORA CON ENLACES 2"**

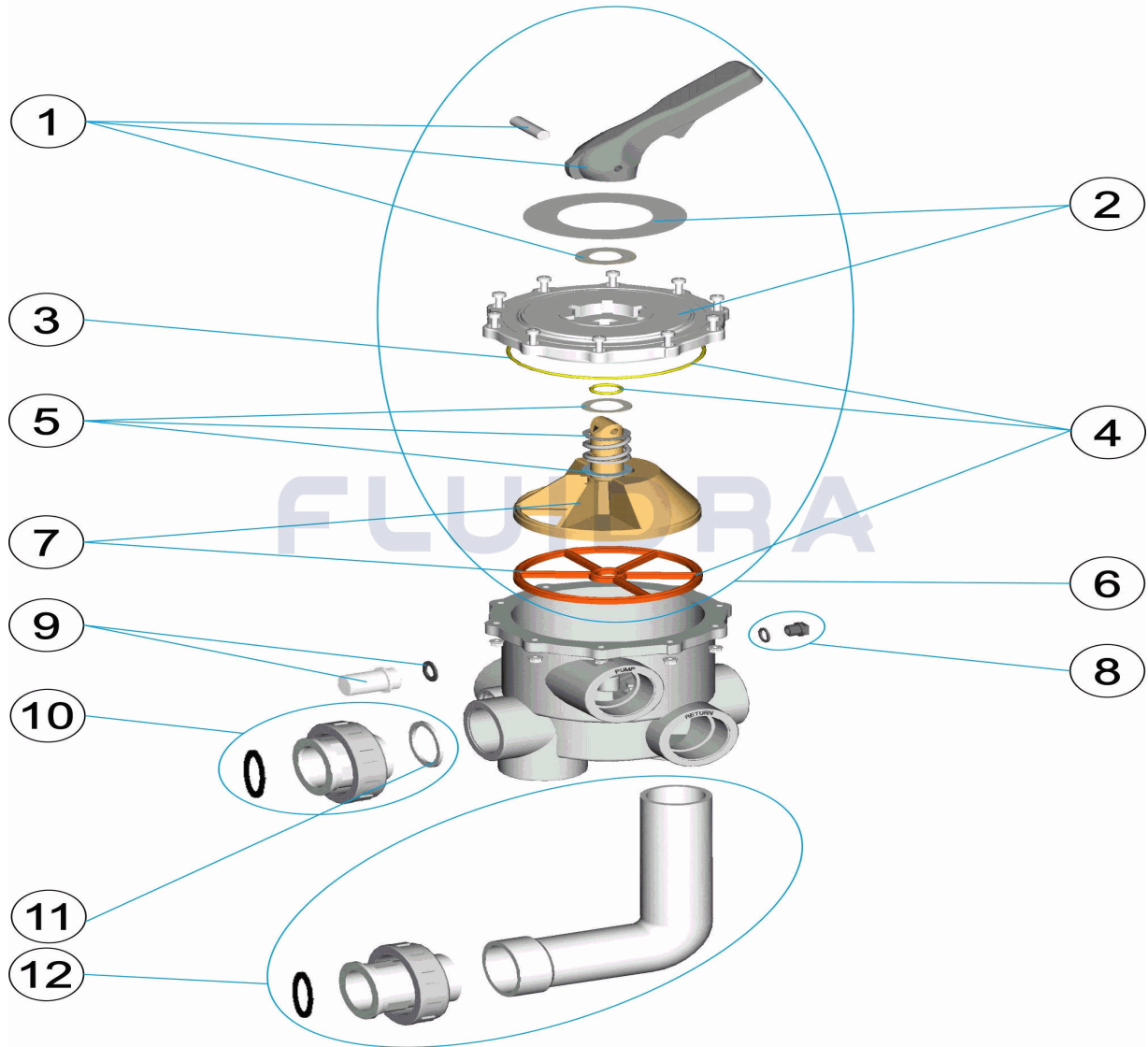

ESPAÑOL

POS	CODIGO	DESCRIPCION	CANTIDAD	POS	CODIGO	DESCRIPCION	CANTIDAD
1	SP-04-0048	MANETA NEGRA VALVULA 2"		7	SP-04-0053	DISTRIBUIDOR CON JUNTAS 2" NUEVO	
2	SP-04-0049	TAPA VALVULA 2"		8	SP-04-0054	TAPON 1/4" VALVULA NUEV "	
3	SP-04-0050	JUNTA TORICA TAPA 2"		9	SP-04-0007	VISOR CON JUNTA	
4	SP-04-0051	JUNTAS VALVULA 2"		10	SP-04-0522	ENLACE RECTO 2"	
5	SP-04-0041	RESORTE CON ARANDELAS		11	SP-04-0056	JUNTAS ENLACE 2"	
6	SP-04-0052	CJTO. SUPERIOR 2"		12	SP-04-0057	ENLACE ACODADO NEGRO 2" NUEVO	

CODE **PS-6104**

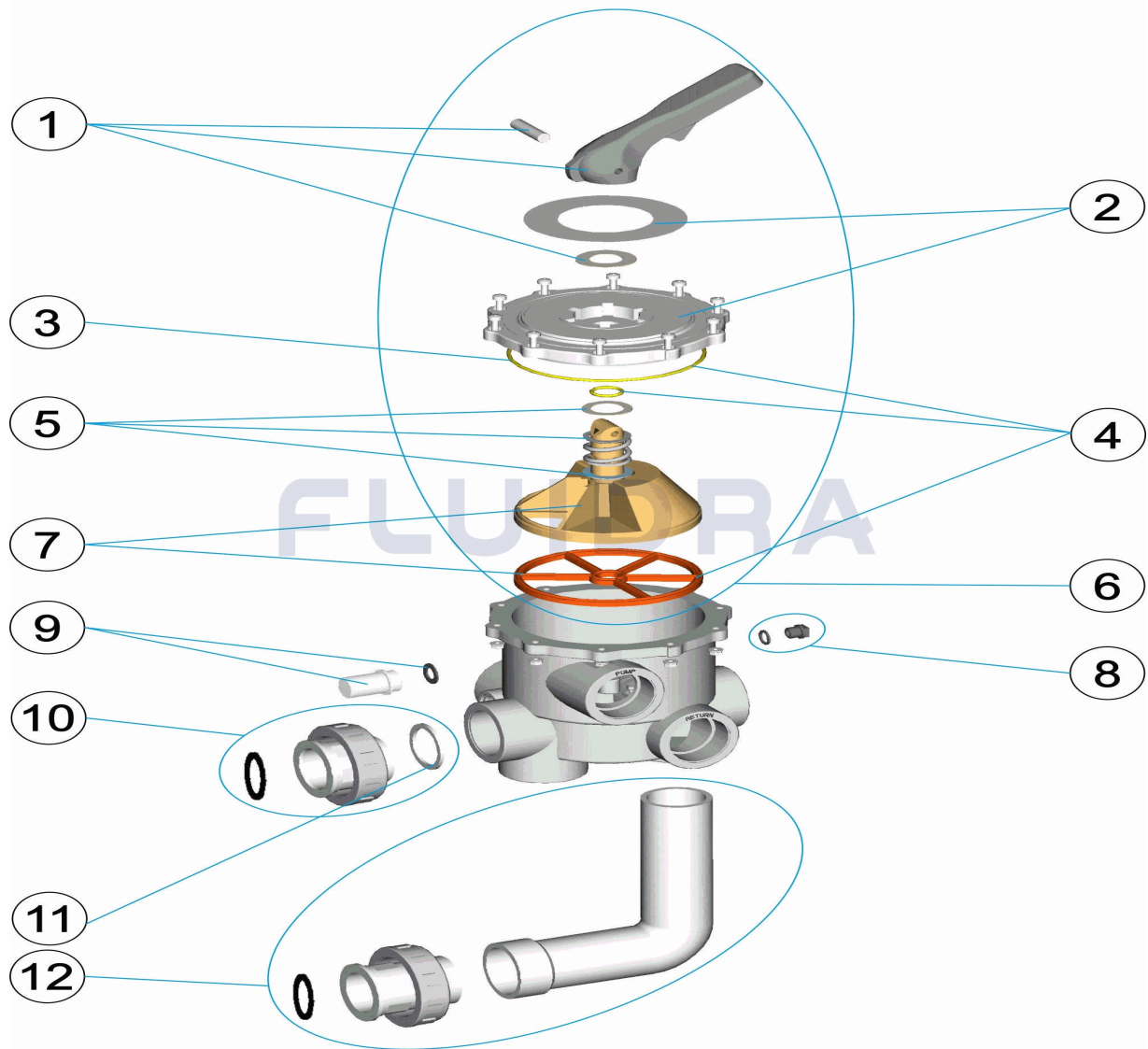
 DESCRIPTION: **SÉLECTEUR AVEC LIENS 2"**

FRANCAIS

POS	CODE	DESCRIPTION	QUANTITE	POS	CODE	DESCRIPTION	QUANTITE
1	SP-04-0048	POIGNEE NOIRE 2"		7	SP-04-0053	BOISSEAU AVEC JOINTS 2"	
2	SP-04-0049	DESSUS DE VANNE 2"		8	SP-04-0054	BOUCHON 1/4" VANNE NOUVEA "	
3	SP-04-0050	JOINT TORIQUE COUVERCLE 2"		9	SP-04-0007	VOYANT ET JOINT	
4	SP-04-0051	JOINTS DE VANNE 2"		10	SP-04-0522	SORTIE DROITE 2"	
5	SP-04-0041	RESSORT ET RONDELLES		11	SP-04-0056	JOINTS DE SORTIES 2"	
6	SP-04-0052	ENSEMBLE SUPERIEUR 2"		12	SP-04-0057	SORTIE COUDEE NOIRE 2" NOUVEAU MOD	

CODE PS-6104

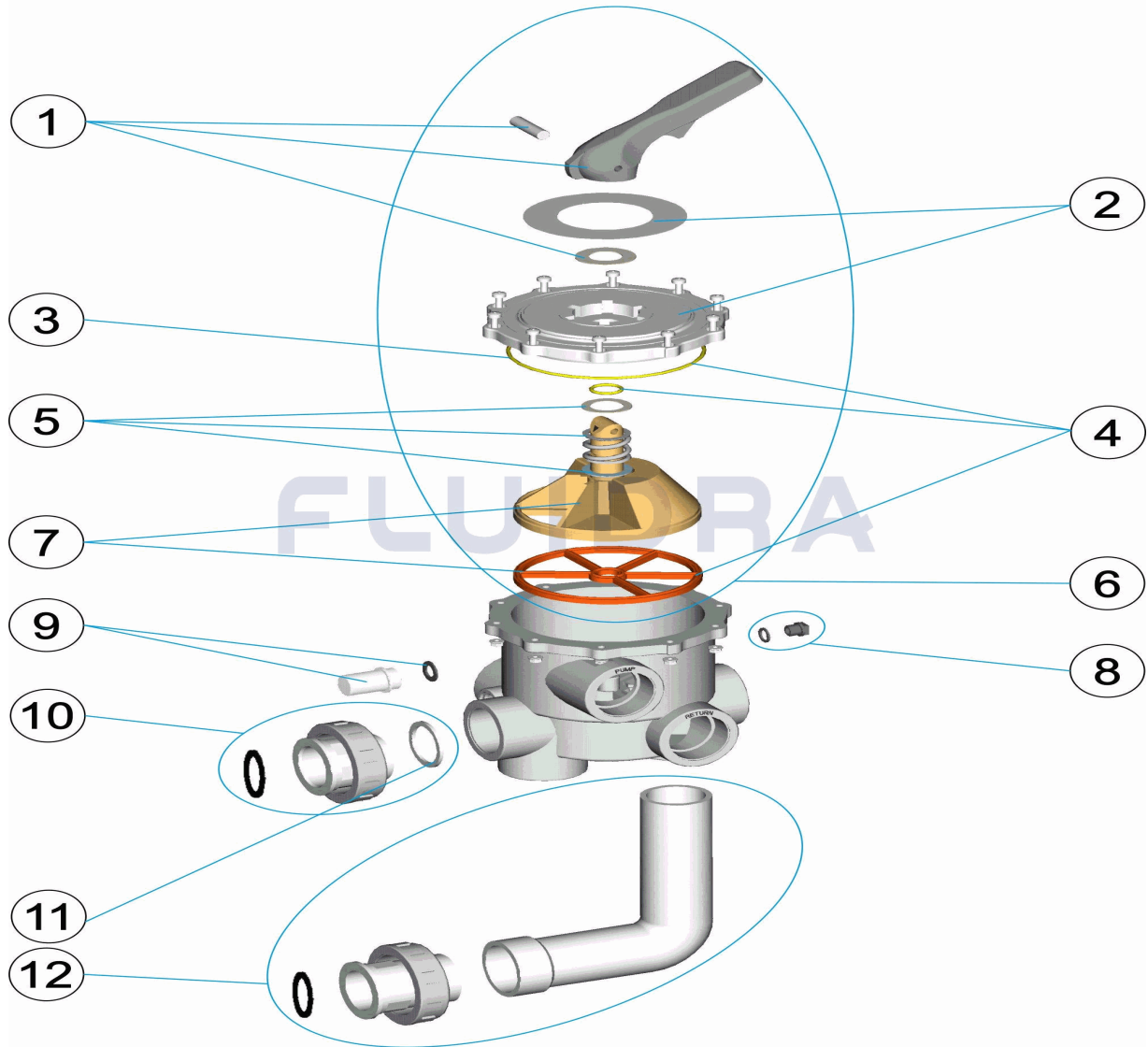
DESCRIPTION: SELECTOR VALVE WITH LINKS 2"



ENGLISH

POS	CODE	DESCRIPTION	QUANTITY	POS	CODE	DESCRIPTION	QUANTITY
1	SP-04-0048	BLACK HANDLE 2"		7	SP-04-0053	DISTRIBUTOR WITH GASKETS 2" NEW	
2	SP-04-0049	VALVE 2"		8	SP-04-0054	NEW 1/4" VALVE CA "	
3	SP-04-0050	2" LID 'O' RING "		9	SP-04-0007	VISOR WITH SEAL	
4	SP-04-0051	GASKETS 2"		10	SP-04-0522	UNION 2"	
5	SP-04-0041	SPRING WITH WASHERS		11	SP-04-0056	UNION SEALS 2"	
6	SP-04-0052	SET. SUPERIOR 2		12	SP-04-0057	ELBOW BLACK 2' NEW	

CODICE **PS-6104**

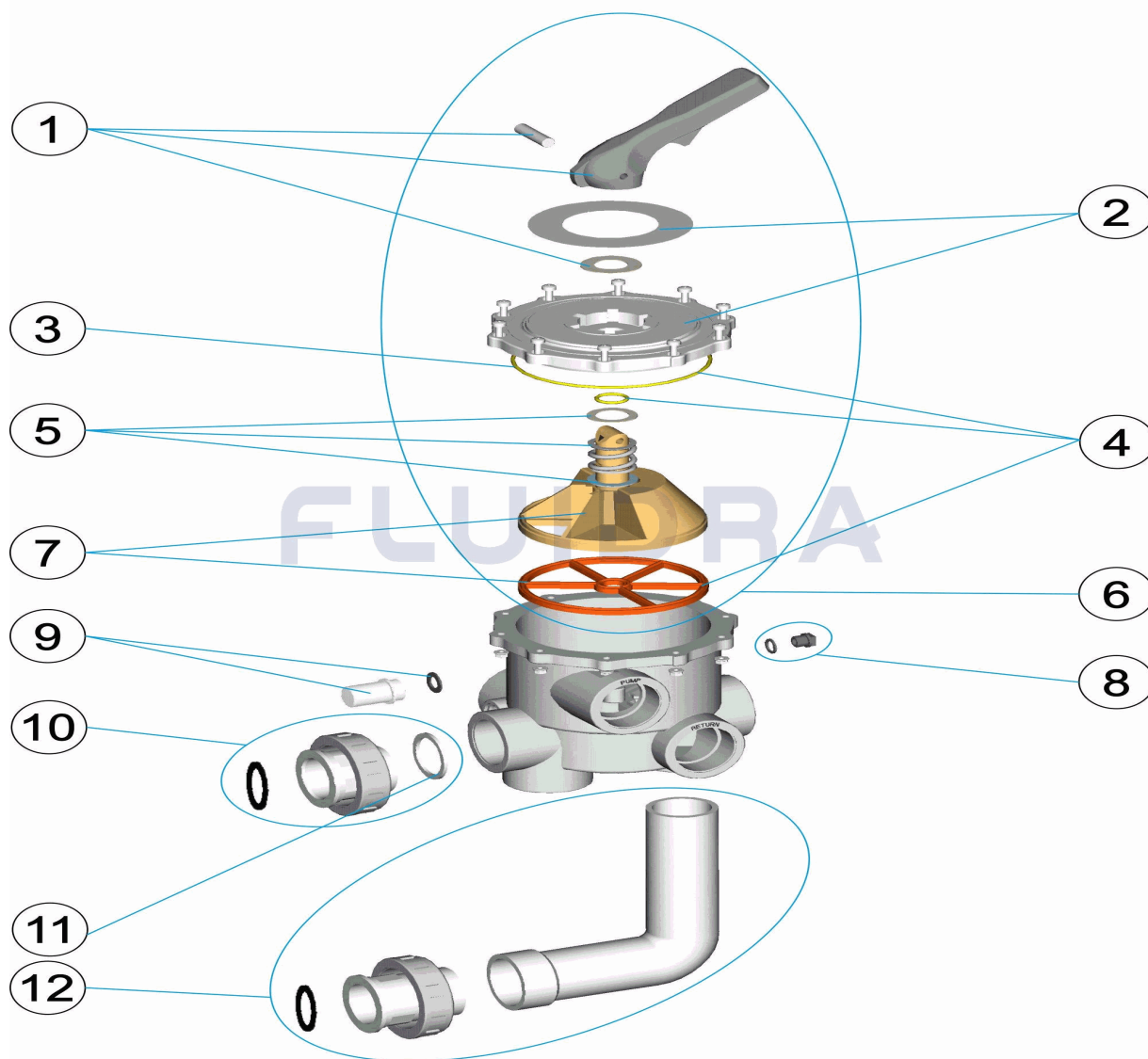
 DESCRIZIONE: **VALVOLA SELETRICE CON COLLEGAMENTI 2"**

ITALIANO

POS	CODICE	DESCRIZIONE	QUANTITA'	POS	CODICE	DESCRIZIONE	QUANTITA'
1	SP-04-0048	MANIGLIA NERA PER VALVOLA 2"		7	SP-04-0053	DISTRIBUTORE CON GUARNIZIONI 2' NUO	
2	SP-04-0049	COPERCHIO VALVOLA 2"		8	SP-04-0054	GUARNIZIONE SAGOMATA + GURANIZIONE	
3	SP-04-0050	O-RING COPERCHIO 2"		9	SP-04-0007	VISORE CON GUARNIZIONE	
4	SP-04-0051	GUARNIZIONI VALVOLA 2'		10	SP-04-0522	GUARNIZIONE PER RACCORDO 2"	
5	SP-04-0041	MOLLA CON RONDELLA		11	SP-04-0056	GUARNIZIONE PER RACCORDO 2'	
6	SP-04-0052	KIT PARTE SUPERIORE SELETRICE 2"		12	SP-04-0057	RACCORDO A GOMITO NERO 2' NUOVO	

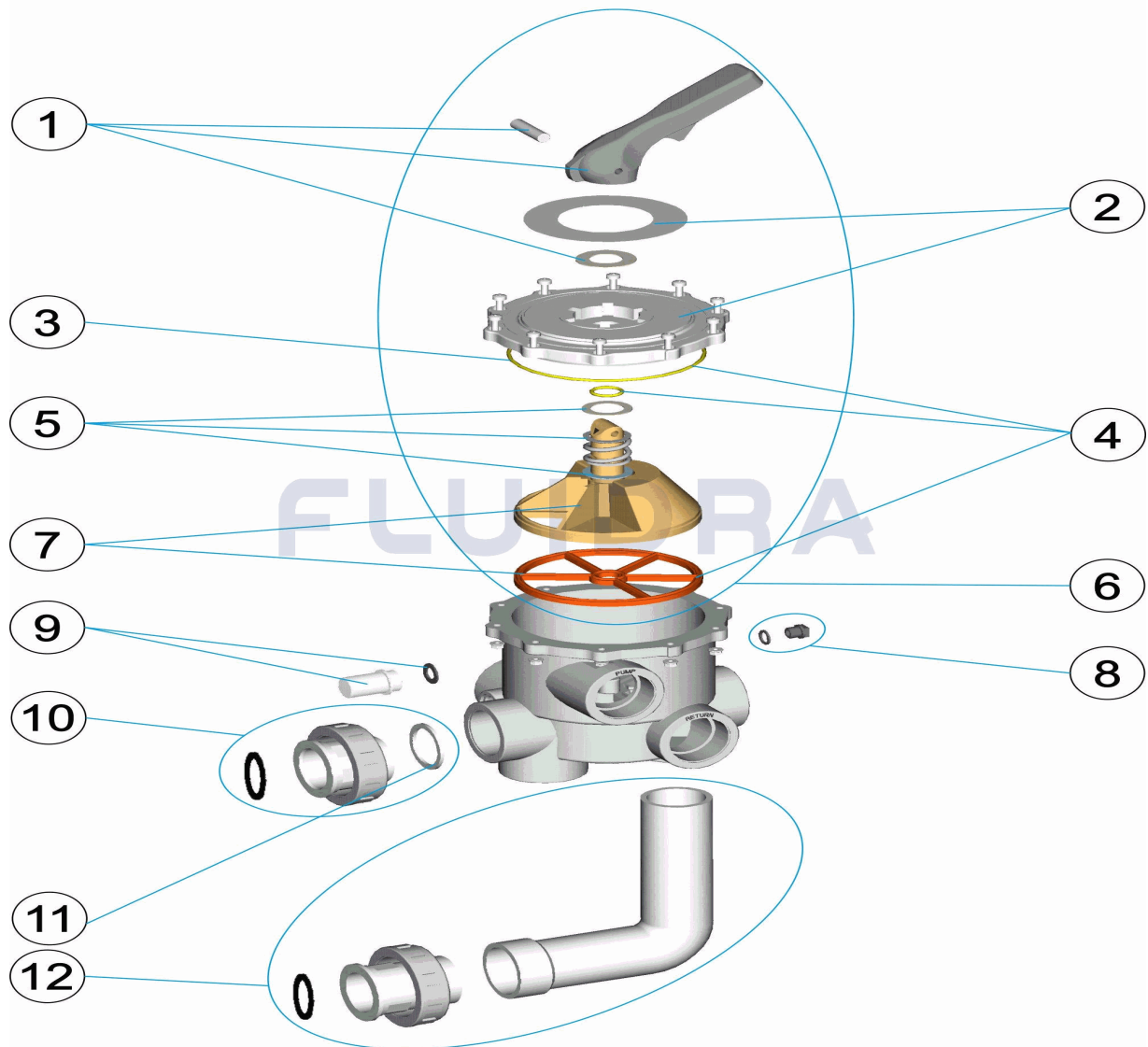
CODE

PS-6104
BESCHREIBUNG: MEHRWEGVENTIL MIT ANSCHLÜSSEN 2"

DEUTSCH

POS	CODE	BESCHREIBUNG	MENGE	POS	CODE	BESCHREIBUNG	MENGE
1	SP-04-0048	GRIFF SCHWARZ VENTIL 2'		7	SP-04-0053	VERTEILER UND DICHTUNGEN 2' NEUVER!	
2	SP-04-0049	VENTILDECKEL 2"		8	SP-04-0054	STOPFEN 1/4" VENTIL NEUVERSIO "	
3	SP-04-0050	O-RING ABDECKUNG 2"		9	SP-04-0007	SCHAUGLAS UND DICHTUNG	
4	SP-04-0051	VENTILDICHTUNGEN 2'		10	SP-04-0522	ANSCHLUSS GERADE 2 "	
5	SP-04-0041	FEDER MIT UNTERLEGSCHIEBEN		11	SP-04-0056	DICHTUNGEN ANSCHLUSS 2'	
6	SP-04-0052	SET OBEN 2"		12	SP-04-0057	ANSCHLUSSWINKEL SCHWARZ 2' NEUVER	

CODIGO **PS-6104**

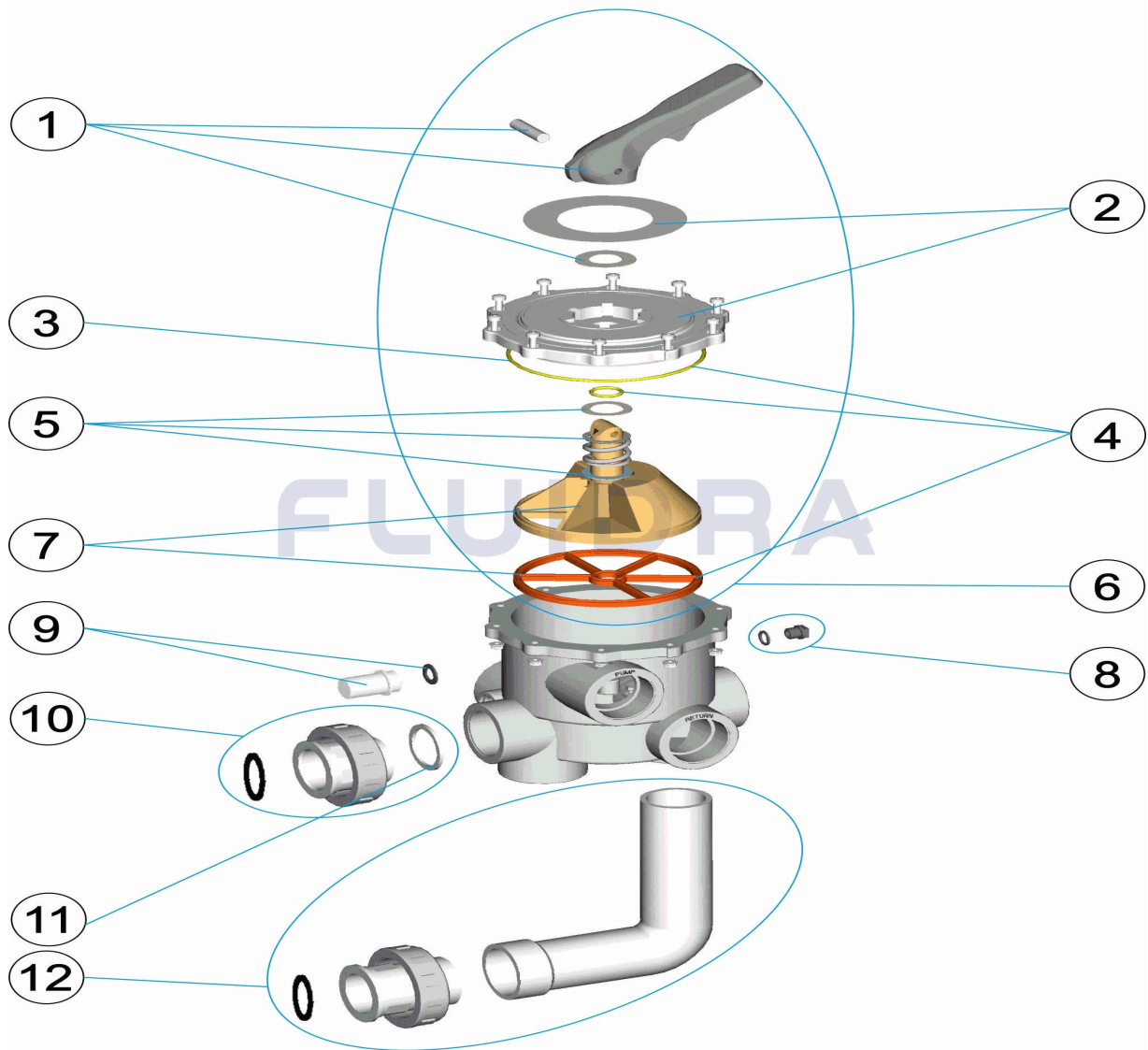
DESCRICAÇÃO: **VÁLVULA SELECTORA COM LIGAÇÕES 2"**



PORTUGUES

POS	CODIGO	DESCRICAÇÃO	JANTIDADE	POS	CODIGO	DESCRICAÇÃO	JANTIDADE
1	SP-04-0048	MANIPULO PRETO VÁLVULA 2'		7	SP-04-0053	DISTRIBUIDOR COM JUNTAS 2' NOVO	
2	SP-04-0049	TAMPA VALVULA 2"		8	SP-04-0054	TAMPAO 1/4" VALVULA NOV "	
3	SP-04-0050	JUNTA TÓRICA TAMPA 2"		9	SP-04-0007	VISOR COM JUNTA	
4	SP-04-0051	JUNTAS VÁLVULA 2'		10	SP-04-0522	LIGAÇÃO RECTA 2"	
5	SP-04-0041	MOLA COM ANILHAS		11	SP-04-0056	JUNTAS LIGAÇÃO 2'	
6	SP-04-0052	CONJUNTO SUPERIOR 2"		12	SP-04-0057	LIGAÇÃO CURVA PRETA 2' NOVA	