

CODIGO 34624, 34625, 34626, 34627

DESCRIPCION: ELECTROLISIS DE SAL ASTRAL SEL

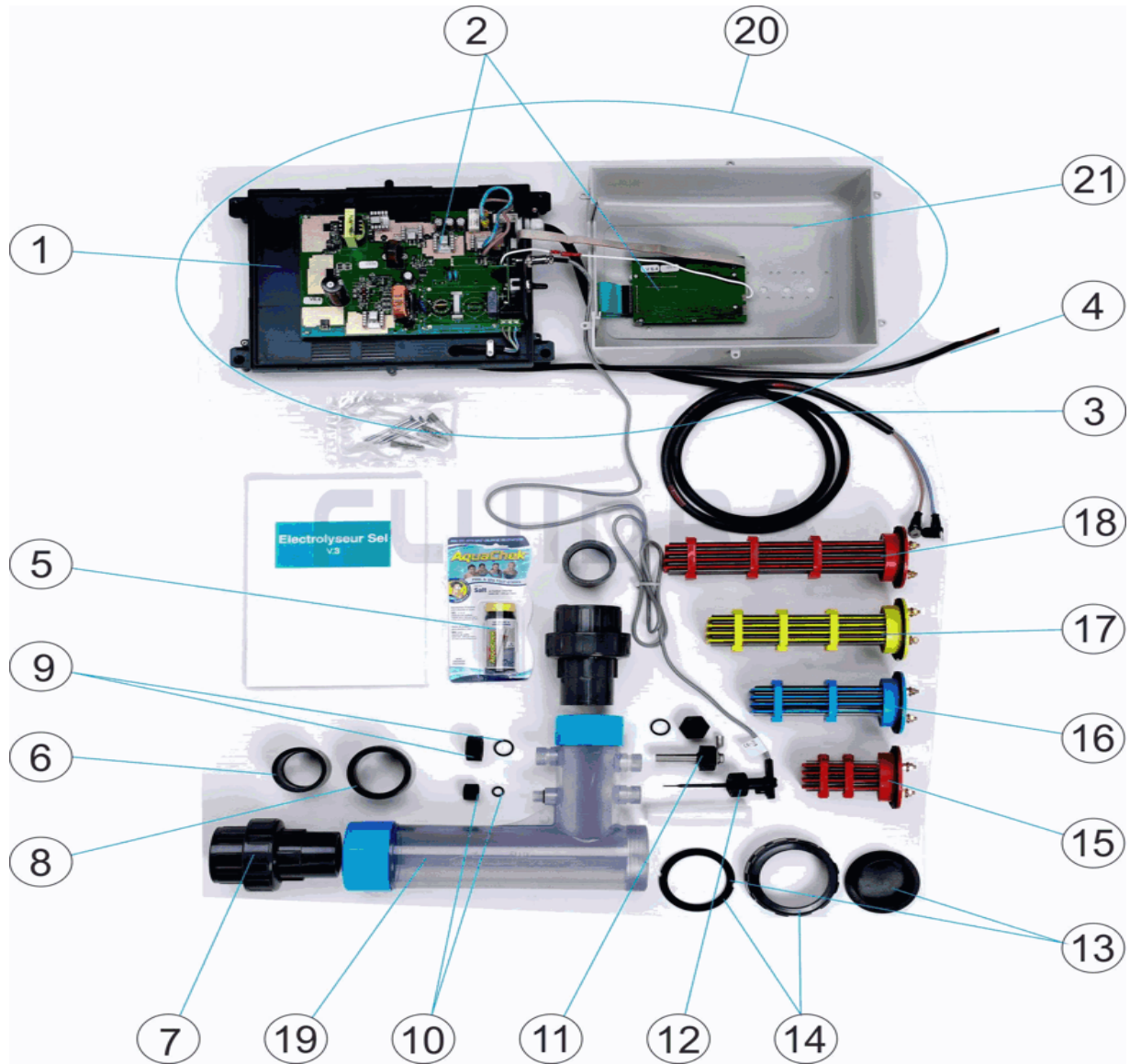

ESPAÑOL

POS	CODIGO	DESCRIPCION	CANTIDAD	POS	CODIGO	DESCRIPCION	CANTIDAD
1	4408060005	BASE CENTRALITA ASTRAL SEL		14	4408060105	TUERCA D. 92 ELECTRODO SEL + JUNTA	
2	4408060006	CIRCUITO COMPLETO V3		15	* 28419	ELECTRODO SEL 40 - 9 PLACAS	
3	4408060003	CABLE ALIMENTACION 3X1MM2 2.1M		16	* 54054	ELECTRODO SEL 60 - 9 PLACAS	
4	4408060002	CABLE ELECTRODO COMPLETO		17	* 54055	ELECTRODO SEL 100 - 9 PLACAS	
5	4408060007	ESTUCHE ANALISIS SEL		18	* 54056	ELECTRODO SEL 160 - 9 PLACAS	
6	4408060103	REDUCCION 63/50		19	* 4408060101	CARCASA PORTACELULAS (40 - 160 M3)	
7	4408060104	RACCOR UNION A COLLAR M/H. 63		19	* 4408060128	CARCASA PORTACELULAS (60 M3)	
8	4408060102	REDUCCION 75/63		19	* 4408060129	CARCASA PORTACELULA (100 M3)	
9	4408060121	TAPON NEGRO OBTURADOR + JUNTA		20	* 300401-40	CENTRAL ASTRAL SEL PURE V4 40	
10	4408060008	TAPON PEQUEÑO INYECCIÓN PARA VASO		20	* 300401-60	CENTRAL ASTRAL SEL PURE V4 60	
11	4408060109	TOMA DE TIERRA PARA VASO SEL		20	* 300401-100	CENTRAL ASTRAL SEL PURE V4 100	
12	4408060108	FLUXOSTATO COMPLETO		20	* 300401-160	CENTRAL ASTRAL SEL PURE V4 160	
13	4408060122	TAPON GRANDE VASO + JUNTA		21	4408060010	TAPA CARATULA CENTRALITA ASTRAL SEL	

CODIGO **34624, 34625, 34626, 34627**

DESCRIPCION: ELECTROLISIS DE SAL ASTRAL SEL

OBSERVACIONES

POS	CODIGO	OBSERVACIONES
15	* 28419	PARA: 34624
16	* 54054	PARA: 34625
17	* 54055	PARA: 34626
18	* 54056	PARA: 34627
19	* 4408060101	PARA: 34624, 34627
19	* 4408060128	PARA: 34625
19	* 4408060129	PARA: 34626
20	* 300401-40	PARA: 34624
20	* 300401-60	PARA: 34625
20	* 300401-100	PARA: 34626
20	* 300401-160	PARA: 34627

CODE **34624, 34625, 34626, 34627**

DESCRIPTION: **ÉLECTROLYSE AU SEL ASTRAL**

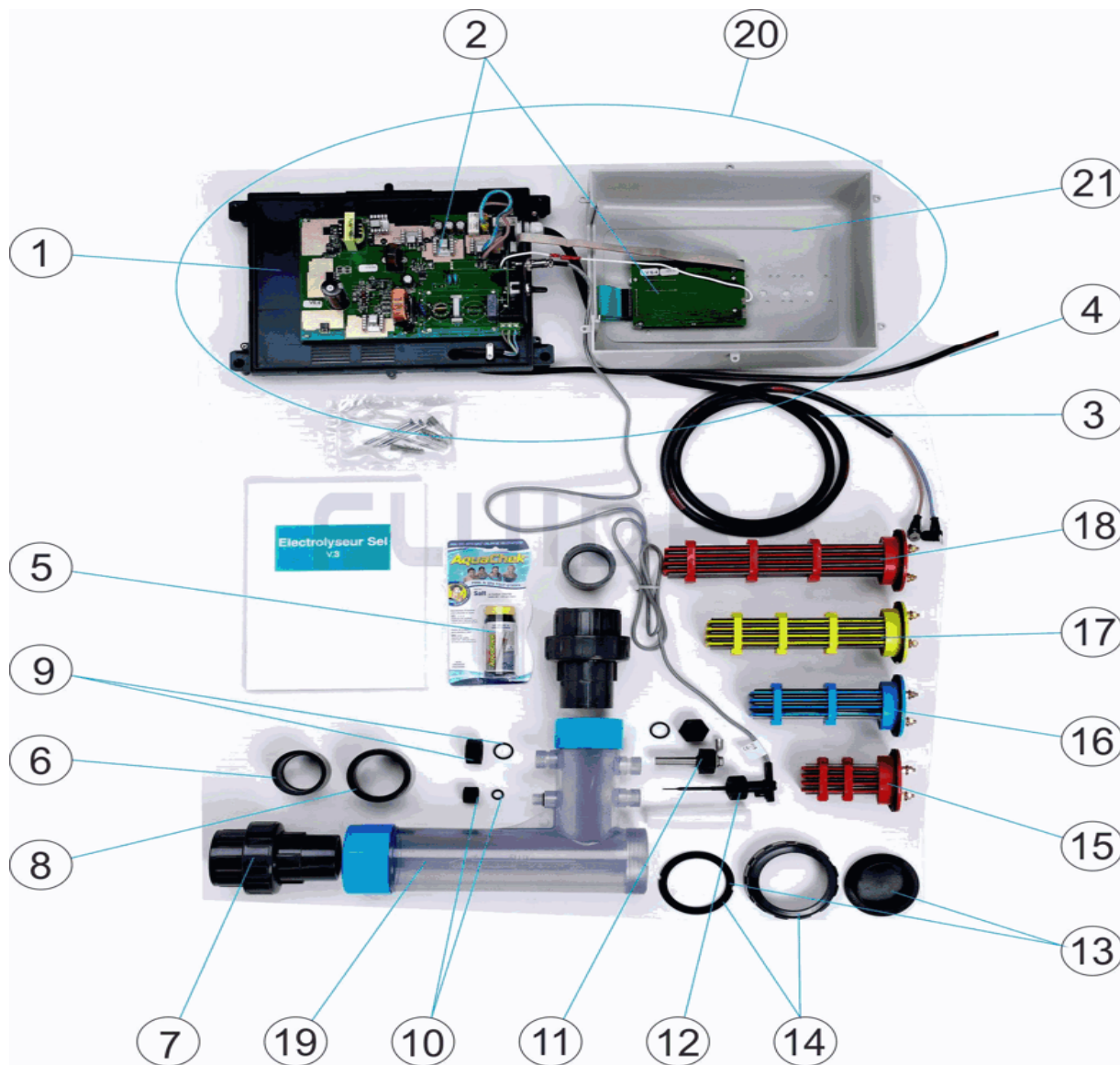

FRANCAIS

POS	CODE	DESCRIPTION	QUANTITE	POS	CODE	DESCRIPTION	QUANTITE
1	4408060005	CACHE BOÎTIER ASTRAL SEL		14	4408060105	ECROU D. 92 ELECTRODE SEL + JOINT	
2	4408060006	CIRCUIT IMPRIMÉ		15	* 28419	ELECTRODE SEL 40 -9 PLAQUES	
3	4408060003	CABLE ALIMENTATION 3X1MM2 2.1M		16	* 54054	ELECTRODE SEL 60 -9 PLAQUES	
4	4408060002	CABLE ELECTRODE		17	* 54055	ELECTRODE SEL 100 -9 PLAQUES	
5	4408060007	KIT ANALYSE SEL		18	* 54056	ELECTRODE SEL 160 -9 PLAQUES	
6	4408060103	RÉDUCTION 63/50		19	* 4408060101	PORTE-CELLULE (40 - 160 M3)	
7	4408060104	RACCORD UNION À COLLER M/H 63		19	* 4408060128	PORTE-CELLULE (60 M3)	
8	4408060102	RÉDUCTION 75/63		19	* 4408060129	PORTE-CELLULE (100 M3)	
9	4408060121	COUVERCLE NOIR DE FERMENTURE + JO		20	* 300401-40	CENTRAL ASTRAL SEL PURE V4 40	
10	4408060008	BOUCHON PETIT INJECTION POUR VASE		20	* 300401-60	CENTRAL ASTRAL SEL PURE V4 60	
11	4408060109	POOL TERRE POUR VASE SEL		20	* 300401-100	CENTRAL ASTRAL SEL PURE V4 100	
12	4408060108	CONTROLEUR DE DÉBIT COMPLET		20	* 300401-160	CENTRAL ASTRAL SEL PURE V4 160	
13	4408060122	COUVERCLE GRAND VASE + JOINT		21	4408060010	CACHE BOÎTIER ASTRAL SEL	

CODE **34624, 34625, 34626, 34627**

DESCRIPTION: **ÉLECTROLYSE AU SEL ASTRAL**

OBSERVATIONS

POS	CODE	OBSERVATIONS
15	* 28419	POUR: 34624
16	* 54054	POUR: 34625
17	* 54055	POUR: 34626
18	* 54056	POUR: 34627
19	* 4408060101	POUR: 34624, 34627
19	* 4408060128	POUR: 34625
19	* 4408060129	POUR: 34626
20	* 300401-40	POUR: 34624
20	* 300401-60	POUR: 34625
20	* 300401-100	POUR: 34626
20	* 300401-160	POUR: 34627

CODE 34624, 34625, 34626, 34627

DESCRIPTION: SALT ELECTROLYSIS ASTRAL

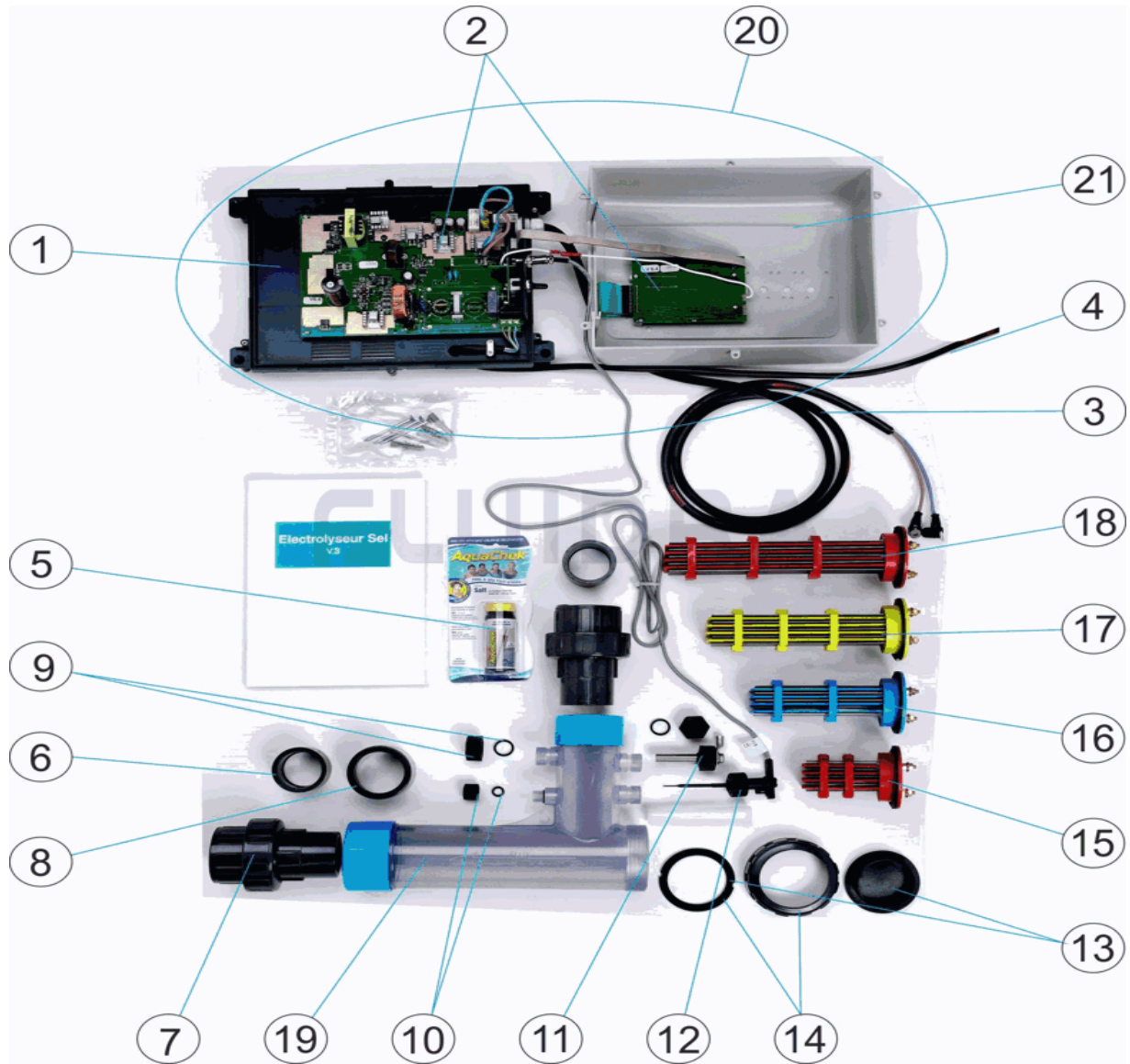

ENGLISH

POS	CODE	DESCRIPTION	QUANTITY	POS	CODE	DESCRIPTION	QUANTITY
1	4408060005	ASTRAL SEL CONTROL BOX COVER		14	4408060105	D. 92 ELECTRODE NUT + GASKET	
2	4408060006	PRINTED CIRCUIT		15	* 28419	ASTRAL SEL 40 ELECTRODE (9 PLATES)	
3	4408060003	3X1MM2 2.1M SUPPLY CABLE		16	* 54054	ASTRAL SEL 60 ELECTRODE (9 PLATES)	
4	4408060002	ELECTRODE CABLE		17	* 54055	ASTRAL SEL 100 ELECTRODE (9 PLATES)	
5	4408060007	SEL ANALYSIS CASE		18	* 54056	ASTRAL SEL 160 ELECTRODE (9 PLATES)	
6	4408060103	63/50 REDUCTION SOCKET		19	* 4408060101	ELECTRODES HOUSING (40 - 160 M3)	
7	4408060104	M/F 63 SOLVENT SOCKET UNION		19	* 4408060128	ELECTRODES HOUSING (60 M3)	
8	4408060102	75/63 REDUCTION SOCKET		19	* 4408060129	ELECTRODES HOUSING (100 M3)	
9	4408060121	BLACK OBTURATING PLUG + GASKET		20	* 300401-40	ASTRAL SEL PURE V4 40 CENTRAL	
10	4408060008	SMALL INJECTION CAP FOR RECIPIENT		20	* 300401-60	ASTRAL SEL PURE V4 60 CENTRAL	
11	4408060109	EARTH CONNECTION FOR ASTRALSEL HC		20	* 300401-100	ASTRAL SEL PURE V4 100 CENTRAL	
12	4408060108	COMPLETE FLOWSWITCH		20	* 300401-160	ASTRAL SEL PURE V4 160 CENTRAL	
13	4408060122	HOUSING CAP + GASKET		21	4408060010	ASTRAL SEL CONTROL UNIT COVER CAP	

CODE **34624, 34625, 34626, 34627**

DESCRIPTION: **SALT ELECTROLYSIS ASTRAL**

OBSERVATIONS

POS	CODE	OBSERVATIONS
15	* 28419	FOR: 34624
16	* 54054	FOR: 34625
17	* 54055	FOR: 34626
18	* 54056	FOR: 34627
19	* 4408060101	FOR: 34624, 34627
19	* 4408060128	FOR: 34625
19	* 4408060129	FOR: 34626
20	* 300401-40	FOR: 34624
20	* 300401-60	FOR: 34625
20	* 300401-100	FOR: 34626
20	* 300401-160	FOR: 34627

CODICE **34624, 34625, 34626, 34627**

DESCRIZIONE: **ELETTROLISI DA SALE ASTRAL PH BASICO**

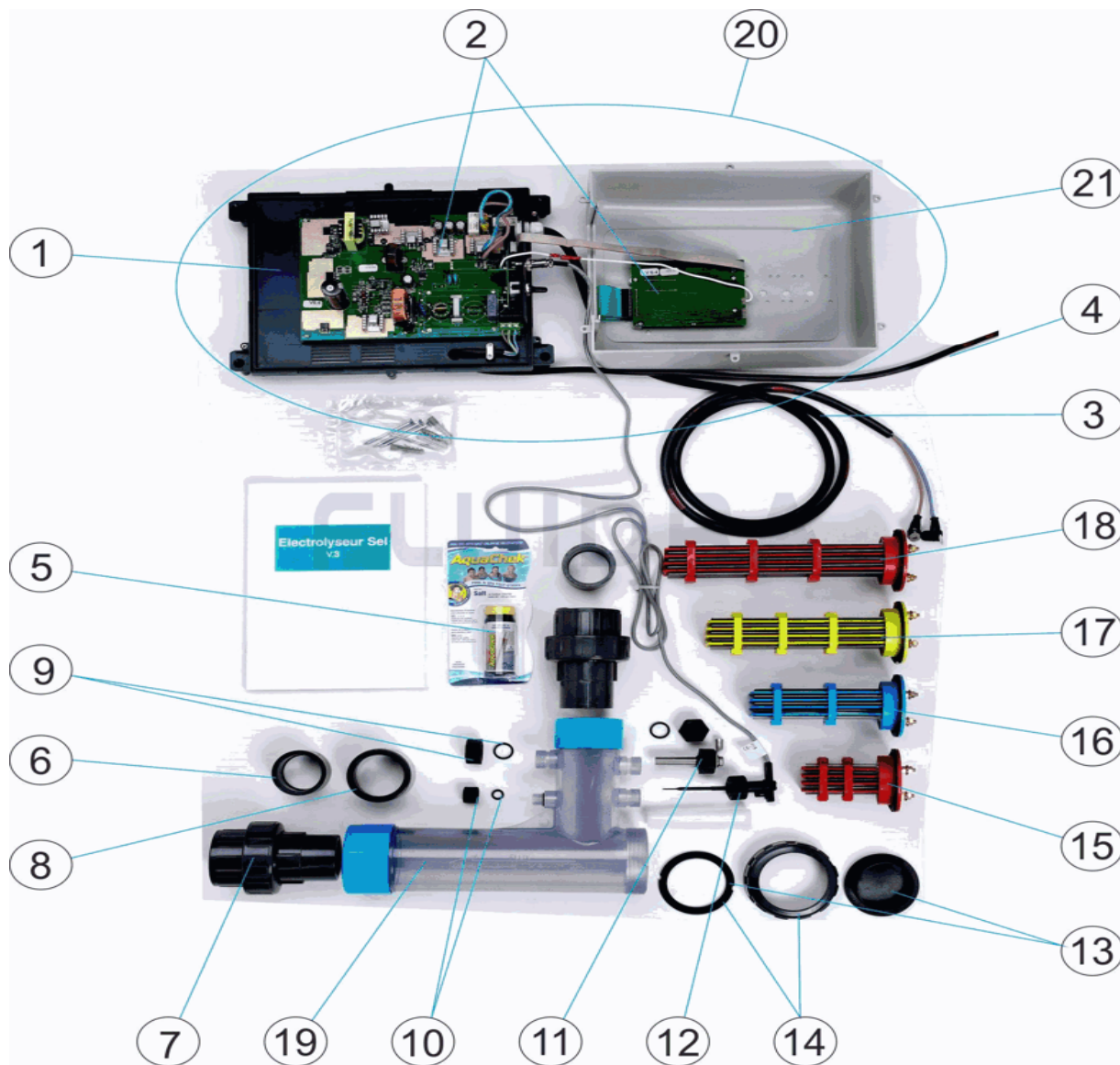

ITALIANO

POS	CODICE	DESCRIZIONE	QUANTITA'	POS	CODICE	DESCRIZIONE	QUANTITA'
1	4408060005	COPERCHIO CENTRALINA SEL		14	4408060105	GHIERA D.92 ELETTRODO + GUARNIZIONE	
2	4408060006	CIRCUITO STAMPATO		15	* 28419	ELETTRODO ASTRAL SEL 40 - 9 PLACHE	
3	4408060003	CAVO DI ALIMENTAZIONE 3X1MM2 2.1M		16	* 54054	ELETTRODO ASTRAL SEL 60 - 9 PLACHE	
4	4408060002	CAVO ELETTRODO		17	* 54055	ELETTRODO ASTRAL SEL 100 - 9 PLACHE	
5	4408060007	ASTUCCIO ANALISI SEL		18	* 54056	ELETTRODO ASTRAL SEL 160 - 9 PLACHE	
6	4408060103	RIDUZIONE 63/50		19	* 4408060101	PORTAELETTODI (40 - 160 M3)	
7	4408060104	RACCORDO INCOLLAGGIO MF D.63		19	* 4408060128	PORTAELETTODI (60 M3)	
8	4408060102	RIDUZIONE 75/63		19	* 4408060129	PORTAELETTODI (100 M3)	
9	4408060121	TAPPO NERO PICCOLO + GUARNIZIONE		20	* 300401-40	CENTRALE ASTRAL SEL PURE V4 40	
10	4408060008	TAPPO PICCOLO INIEZIONE PER VASCA		20	* 300401-60	CENTRALE ASTRAL SEL PURE V4 60	
11	4408060109	PRESA TERRA PER PORTAELETTROTI		20	* 300401-100	CENTRALE ASTRAL SEL PURE V4 100	
12	4408060108	FLUSOSTATO COMPLETO		20	* 300401-160	CENTRALE ASTRAL SEL PURE V4 160	
13	4408060122	TAPPO NERO GRANDE ELETTRODO + GU/		21	4408060010	TAPPO COPERTURA CENTRALINA ASTRAL	

*** SI FACCIA RIFERIMENTO AL FOGLIO DELLE OSSERVAZIONI**

CODICE **34624, 34625, 34626, 34627**

DESCRIZIONE: **ELETTROLISI DA SALE ASTRAL PH BASICO**

OSSERVAZIONI

POS	CODICE	OSSERVAZIONI
15	* 28419	PER: 34624
16	* 54054	PER: 34625
17	* 54055	PER: 34626
18	* 54056	PER: 34627
19	* 4408060101	PER: 34624, 34627
19	* 4408060128	PER: 34625
19	* 4408060129	PER: 34626
20	* 300401-40	PER: 34624
20	* 300401-60	PER: 34625
20	* 300401-100	PER: 34626
20	* 300401-160	PER: 34627

CODE **34624, 34625, 34626, 34627**

BESCHREIBUNG: **SALZELEKTROLYSE ASTRAL SEL**

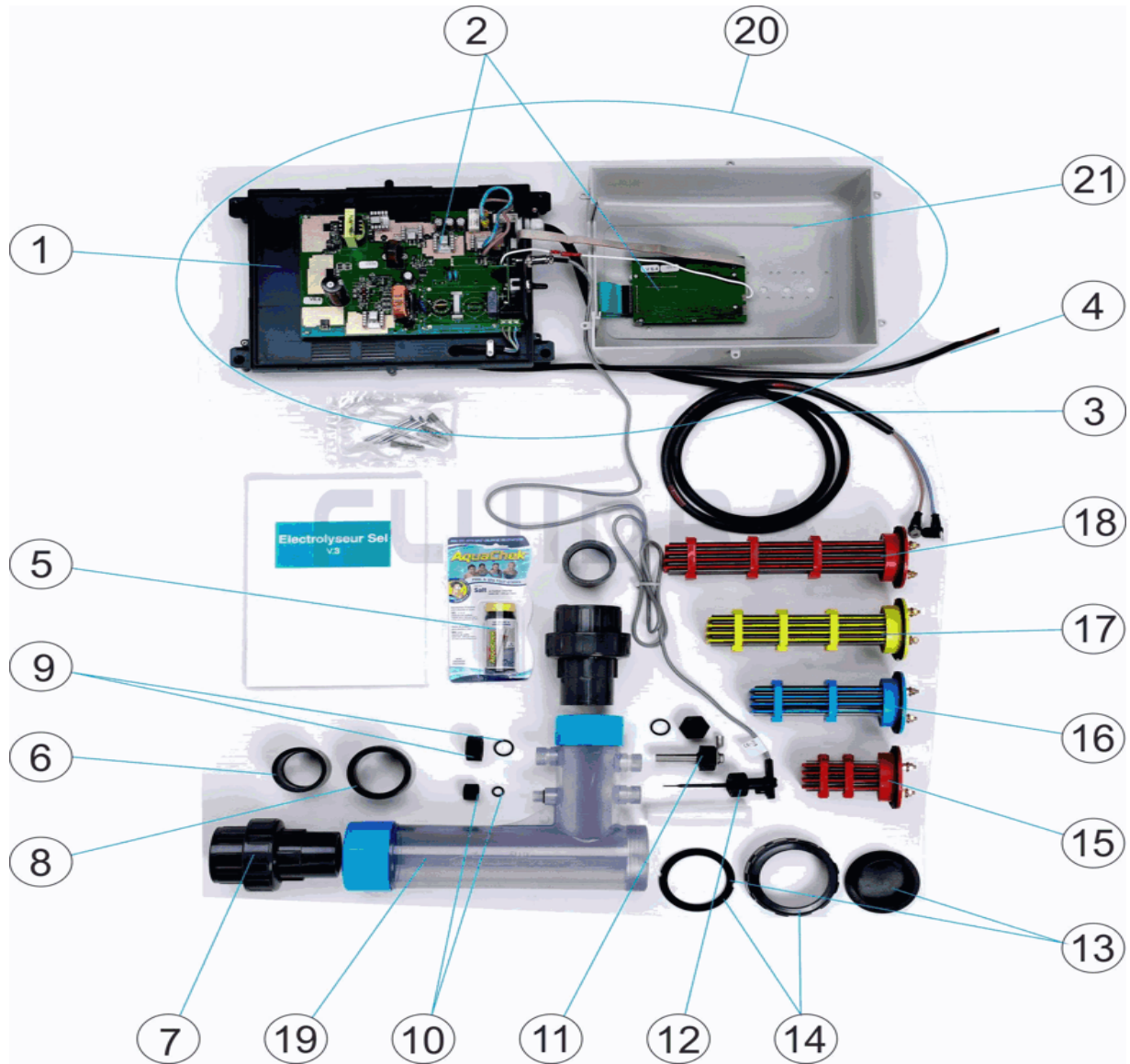

DEUTSCH

POS	CODE	BESCHREIBUNG	MENGE	POS	CODE	BESCHREIBUNG	MENGE
1	4408060005	BASIS STEUERUNG ASTRAL SEL		14	4408060105	MUTTER D. 92 ELEKTRODE SEL UND DICHT	
2	4408060006	SCHALTKREIS KOMPLETT V3		15	* 28419	SALZELECTRODE 40 - 9 PLATTEN	
3	4408060003	VERSORGUNGSKABEL 3X1MM2 2.1M		16	* 54054	SALZELECTRODE 60 - 9 PLATTEN	
4	4408060002	ELEKTRODENKABEL KOMPLETT		17	* 54055	ELEKTRODE SEL 100 - 9 PLATINEN	
5	4408060007	ANALYSEETUI SEL		18	* 54056	ELEKTRODE SEL 160 - 9 PLATINEN	
6	4408060103	REDUZIERSTÜCK 63/50		19	* 4408060101	ZELLENGEHÄUSE (40 - 160 M3)	
7	4408060104	GEWINDESTÜCK VERBINDUNG - KRAGEN		19	* 4408060128	ZELLENGEHÄUSE (60 M3)	
8	4408060102	REDUZIERSTÜCK 75/63		19	* 4408060129	ZELLENGEHÄUSE (100 M3)	
9	4408060121	STOPFEN SCHWARZ VERSCHLUSS UND C		20	* 300401-40	ZENTRALE ASTRAL SEL PURE V4 40	
10	4408060008	STOPFEN KLEIN FÜR GEHÄUSE		20	* 300401-60	ZENTRALE ASTRAL SEL PURE V4 60	
11	4408060109	ERDUNG FÜR GEHÄUSE SEL		20	* 300401-100	ZENTRALE ASTRAL SEL PURE V4 100	
12	4408060108	DURCHFLUSSMESSER KOMPLETT		20	* 300401-160	ZENTRALE ASTRAL SEL PURE V4 160	
13	4408060122	STOPFEN GROSS GEHÄUSE UND DICHTU		21	4408060010	ABDECKUNG BEDIENFELD STEUERUNG A	

CODE **34624, 34625, 34626, 34627**

BESCHREIBUNG: **SALZELEKTROLYSE ASTRAL SEL**

HINWEISE

POS	CODE	HINWEISE
15	* 28419	FÜR: 34624
16	* 54054	FÜR: 34625
17	* 54055	FÜR: 34626
18	* 54056	FÜR: 34627
19	* 4408060101	FÜR: 34624, 34627
19	* 4408060128	FÜR: 34625
19	* 4408060129	FÜR: 34626
20	* 300401-40	FÜR: 34624
20	* 300401-60	FÜR: 34625
20	* 300401-100	FÜR: 34626
20	* 300401-160	FÜR: 34627

CODIGO 34624, 34625, 34626, 34627

DESCRIÇÃO: ELECTRÓLISE DE SAL ASTRAL

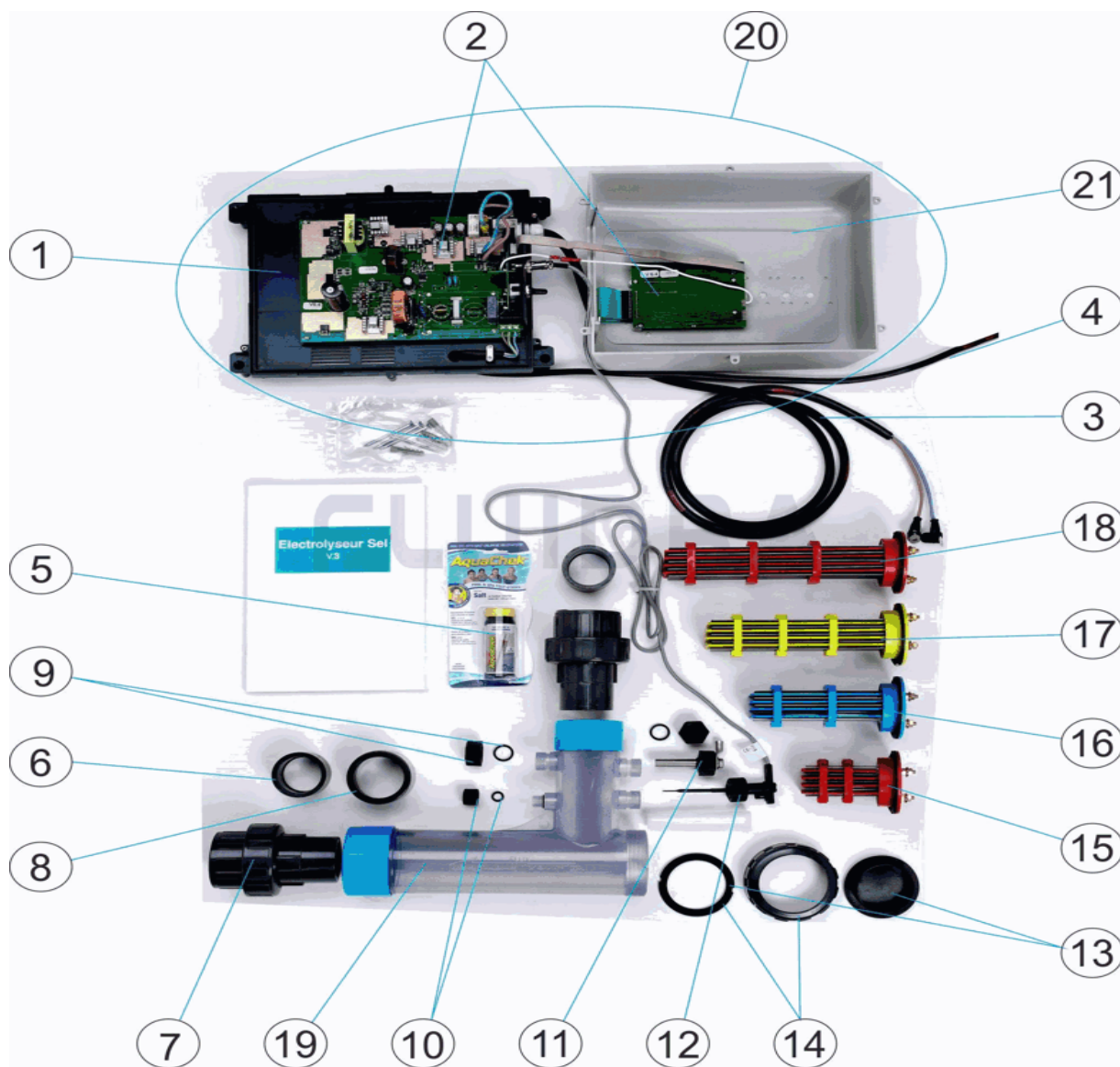

PORTUGUES

POS	CODIGO	DESCRIÇÃO	JANTIDADE	POS	CODIGO	DESCRIÇÃO	JANTIDADE
1	4408060005	TAMPA POSTO COMUTAÇÃO ASTRAL SEL		14	4408060105	PORCA D. 92 ELÉCTRODO SEL + JUNTA	
2	4408060006	CIRCUITO IMPRESSO		15	* 28419	ELÉCTRODO SEL 40 - 9 PLACAS	
3	4408060003	CABO ALIMENTAÇÃO 3X1MM2 2.1M		16	* 54054	ELÉCTRODO SEL 60 - 9 PLACAS	
4	4408060002	CABO SONDA		17	* 54055	ELÉCTRODO SEL 100 - 9 PLACAS	
5	4408060007	ESTOJO ANÁLISE SEL		18	* 54056	ELÉCTRODO SEL 160 - 9 PLACAS	
6	4408060103	REDUÇÃO 63/50		19	* 4408060101	CARÇAÇA PORTA-CÉLULAS (40 - 160 M3)	
7	4408060104	RACORD DE UNIÃO A COLAR M/F. 63		19	* 4408060128	CARÇAÇA PORTA-CÉLULAS (60 M3)	
8	4408060102	REDUÇÃO 75/63		19	* 4408060129	CARÇAÇA PORTA-CÉLULAS (100 M3)	
9	4408060121	TAMPÃO PRETO OBTURADOR + JUNTA		20	* 300401-40	CENTRAL ASTRAL SEL PURE V4 40	
10	4408060008	TAMPA PEQUENA INJECCÃO PARA COPO		20	* 300401-60	CENTRAL ASTRAL SEL PURE V4 60	
11	4408060109	TOMADA DE TERRA PARA COPO SEL		20	* 300401-100	CENTRAL ASTRAL SEL PURE V4 100	
12	4408060108	FLUXO-ESTATO COMPLETO		20	* 300401-160	CENTRAL ASTRAL SEL PURE V4 160	
13	4408060122	TAMPÃO GRANDE COPO + JUNTA		21	4408060010	TAMPA PAINEL POSTO COMUTAÇÃO ASTRAL	

* VEJA A FICHA DE OBSERVAÇÕES

CODIGO **34624, 34625, 34626, 34627**

DESCRIÇÃO: ELECTRÓLISE DE SAL ASTRAL

OBSERVACÕES

POS	CODIGO	OBSERVACÕES
15	* 28419	PARA: 34624
16	* 54054	PARA: 34625
17	* 54055	PARA: 34626
18	* 54056	PARA: 34627
19	* 4408060101	PARA: 34624, 34627
19	* 4408060128	PARA: 34625
19	* 4408060129	PARA: 34626
20	* 300401-40	PARA: 34624
20	* 300401-60	PARA: 34625
20	* 300401-100	PARA: 34626
20	* 300401-160	PARA: 34627