

CODIGO 00251, 00251CL090, 00251CL129, 00251CL144

DESCRIPCION: SKIMMER 15L PF T.CIRCULAR B.ANCHA

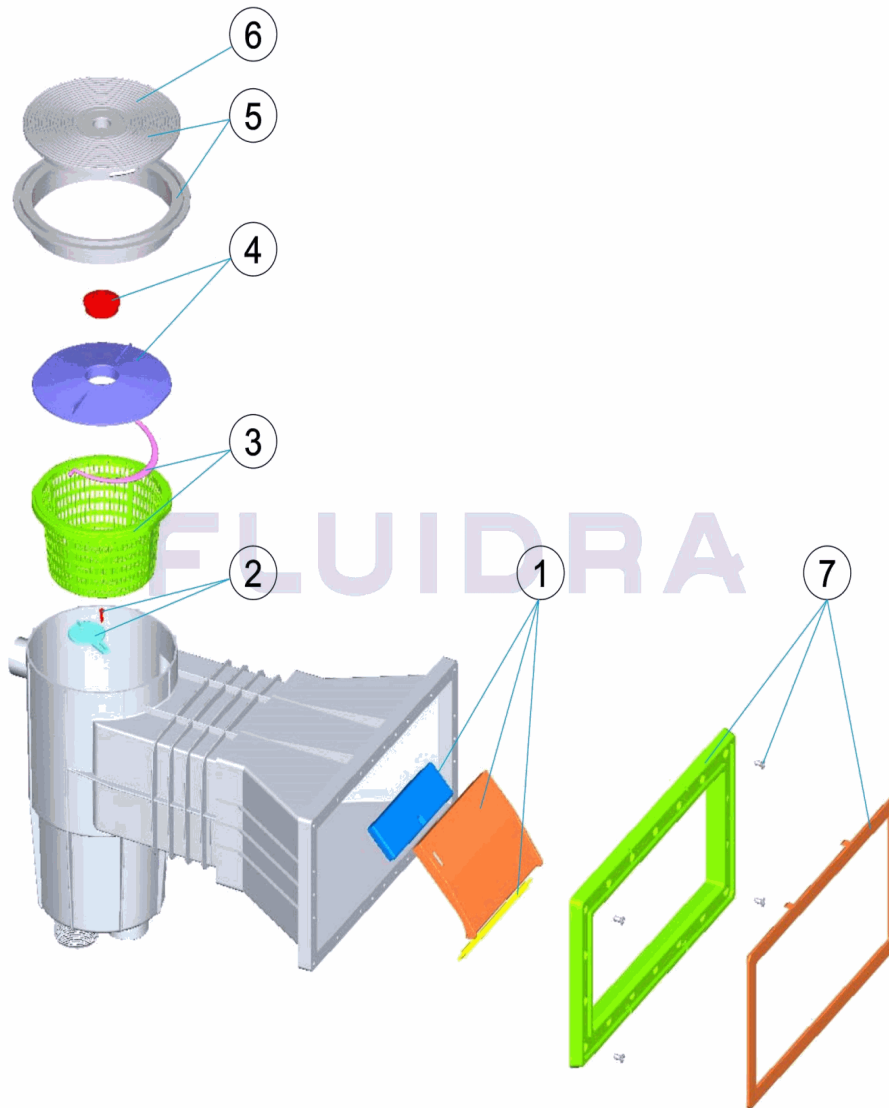

ESPAÑOL

POS	CODIGO	DESCRIPCION	CANTIDAD	POS	CODIGO	DESCRIPCION	CANTIDAD
1	* 4402010101	COMPUERTA SKIMMER BISAGRA		5	4402010105	TAPA Y ARO CIRCULAR SKIMMER	
1	* 4402010026	CONJUNTO COMPUERTA SKIMMER + FLO		6	4402010108	TAPA CIRCULAR SKIMMER	
1	* 4402010030	CONJUNTO COMPUERTA SKIMMER + FLO		7	* 4402010207	MARCO BOCA SKIMMER PISC. HORM.	
1	* 4402010072	COMPUERTA SKIMMER BISAGRA		7	* 4402010144	MARCO BOCA SKIMMER PISC. HORM.	
2	4402010102	CLAPETA SKIMMER		7	* 4402010145	MARCO BOCA SKIMMER PISC. HORM.	
3	4402010103	CESTO SKIMMER		7	* 4402010146	MARCO BOCA SKIMMER PISC. HORM.	
4	4402010104	TAPA CESTO SKIMMER CON TAPON					

CODIGO **00251, 00251CL090, 00251CL129, 00251CL144**

DESCRIPCION: SKIMMER 15L PF T.CIRCULAR B.ANCHA

OBSERVACIONES

POS	CODIGO	OBSERVACIONES
1	* 4402010101	PARA: 00251 BLANCO / WHITE
1	* 4402010026	PARA: 00251CL090 BEIGE
1	* 4402010030	PARA: 00251CL129 GRIS / GREY
1	* 4402010072	PARA: 00251CL144 ANTRACITA / ANTHRACITE
7	* 4402010207	PARA: 00251 BLANCO / WHITE
7	* 4402010144	PARA: 00251CL090 BEIGE
7	* 4402010145	PARA: 00251CL129 GRIS / GREY
7	* 4402010146	PARA: 00251CL144 ANTRACITA / ANTHRACITE

CODE **00251, 00251CL090, 00251CL129, 00251CL144**

DESCRIPTION: **SKIMMER 15L PF C.CIRCULAIRE O.LARGE**

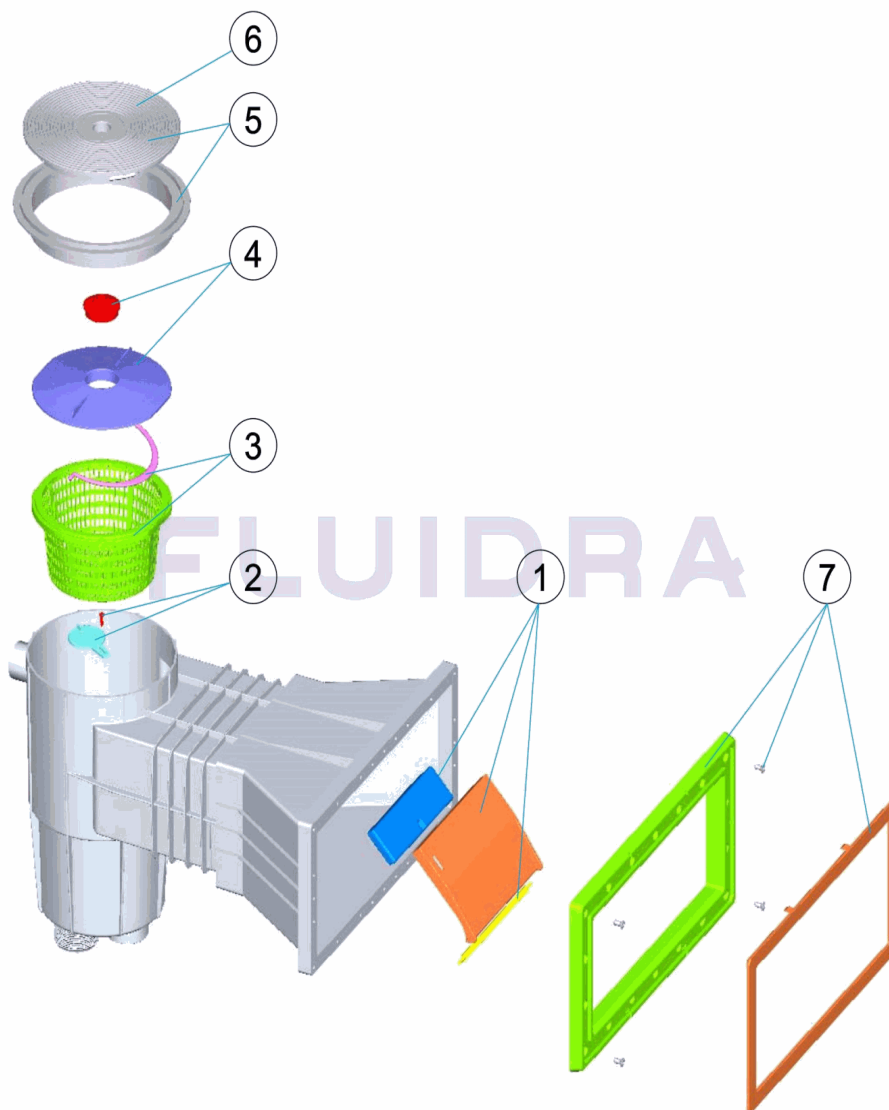

FRANCAIS

POS	CODE	DESCRIPTION	QUANTITE	POS	CODE	DESCRIPTION	QUANTITE
1	* 4402010101	VOLET ET CHARNIERE SKIMMER		5	4402010105	COUVERCLE ET CADRE ROND SKIMMER	
1	* 4402010026	VOLET ET CHARNIERE SKIMMER		6	4402010108	COUVERCLE ROND SKIMMER	
1	* 4402010030	VOLET ET CHARNIERE SKIMMER		7	* 4402010207	CADRE BOUCHE SKIMMER PISCINE BETON	
1	* 4402010072	VOLET ET CHARNIERE SKIMMER		7	* 4402010144	CADRE BOUCHE SKIMMER PISCINE BETON	
2	4402010102	CLAPET SKIMMER		7	* 4402010145	CADRE BOUCHE SKIMMER PISCINE BETON	
3	4402010103	PANIER SKIMMER		7	* 4402010146	CADRE BOUCHE SKIMMER PISCINE BETON	
4	4402010104	COUVERCLE PANIER SKIMMER AVEC BOU					

CODE **00251, 00251CL090, 00251CL129, 00251CL144**

DESCRIPTION: **SKIMMER 15L PF C.CIRCULAIRE O.LARGE**

OBSERVATIONS

POS	CODE	OBSERVATIONS
1	* 4402010101	POUR: 00251 BLANCO / WHITE
1	* 4402010026	POUR: 00251CL090 BEIGE
1	* 4402010030	POUR: 00251CL129 GRIS / GREY
1	* 4402010072	POUR: 00251CL144 ANTRACITA / ANTHRACITE
7	* 4402010207	POUR: 00251 BLANCO / WHITE
7	* 4402010144	POUR: 00251CL090 BEIGE
7	* 4402010145	POUR: 00251CL129 GRIS / GREY
7	* 4402010146	POUR: 00251CL144 ANTRACITA / ANTHRACITE

CODE 00251, 00251CL090, 00251CL129, 00251CL144

DESCRIPTION: SKIMMER 15L PF T. CIRCULAR WIDE MOUTH

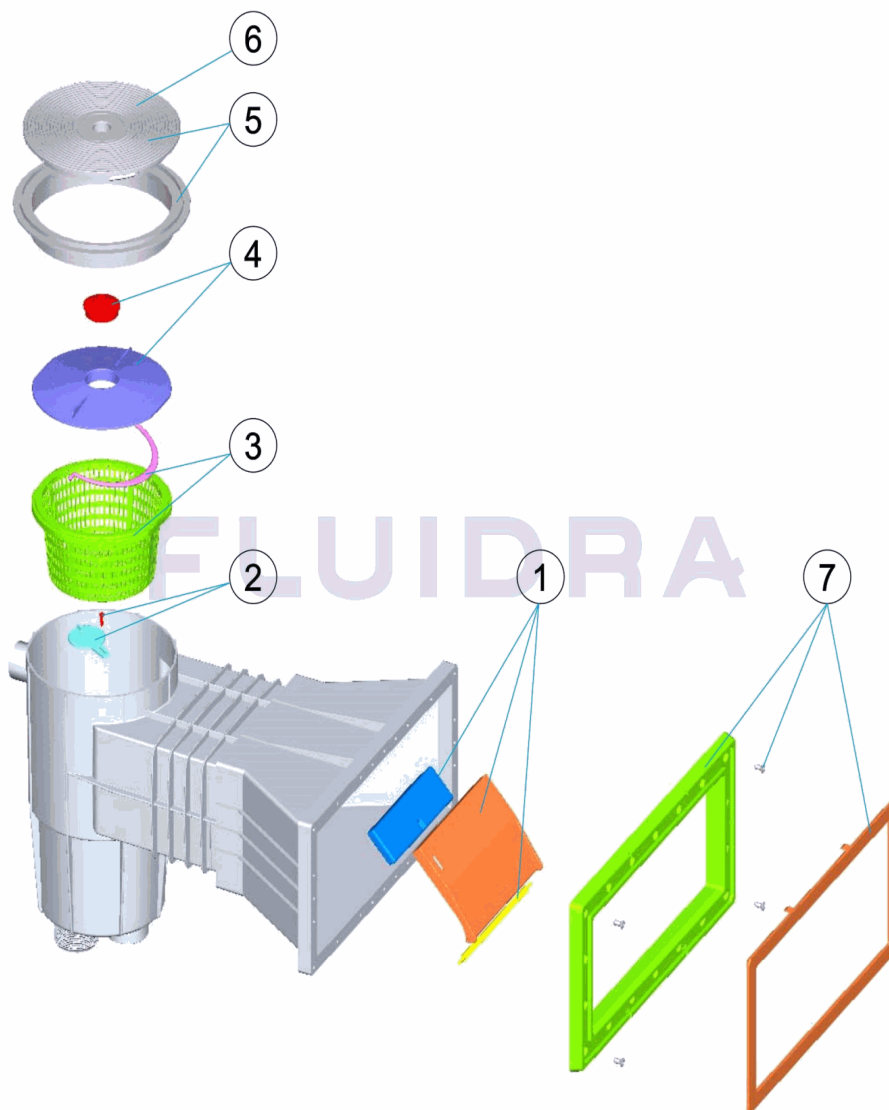

ENGLISH

POS	CODE	DESCRIPTION	QUANTITY	POS	CODE	DESCRIPTION	QUANTITY
1	* 4402010101	FLAP RETAINING CLIP		5	4402010105	CIRCULAR LID AND LID FRAME	
1	* 4402010026	FLAP RETAINING CLIP		6	4402010108	CIRCULAR SKIMMER LID	
1	* 4402010030	FLAP RETAINING CLIP		7	* 4402010207	CONCRETE SKIMMER FRAME	
1	* 4402010072	FLAP RETAINING CLIP		7	* 4402010144	CONCRETE SKIMMER FRAME	
2	4402010102	KEYHOLE FLAP		7	* 4402010145	CONCRETE SKIMMER FRAME	
3	4402010103	SKIMMER BASKET		7	* 4402010146	CONCRETE SKIMMER FRAME	
4	4402010104	VACUUM PLATE WITH PLUG					

CODE **00251, 00251CL090, 00251CL129, 00251CL144**

DESCRIPTION: **SKIMMER 15L PF T. CIRCULAR WIDE MOUTH**

OBSERVATIONS

POS	CODE	OBSERVATIONS
1	* 4402010101	FOR: 00251 BLANCO / WHITE
1	* 4402010026	FOR: 00251CL090 BEIGE
1	* 4402010030	FOR: 00251CL129 GRIS / GREY
1	* 4402010072	FOR: 00251CL144 ANTRACITA / ANTHRACITE
7	* 4402010207	FOR: 00251 BLANCO / WHITE
7	* 4402010144	FOR: 00251CL090 BEIGE
7	* 4402010145	FOR: 00251CL129 GRIS / GREY
7	* 4402010146	FOR: 00251CL144 ANTRACITA / ANTHRACITE

CODICE **00251, 00251CL090, 00251CL129, 00251CL144**

DESCRIZIONE: **SKIMMER 15L PF T. CIRCOLARE B. LARGA**

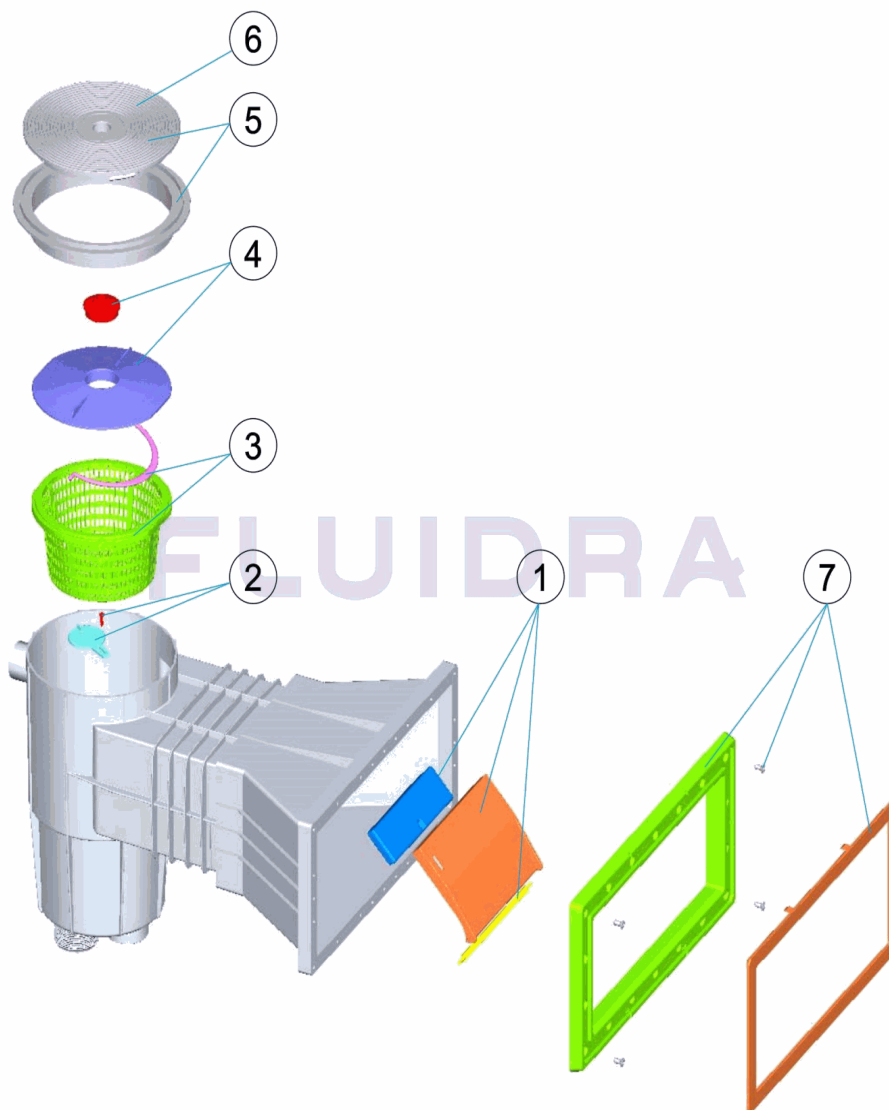

ITALIANO

POS	CODICE	DESCRIZIONE	QUANTITA'	POS	CODICE	DESCRIZIONE	QUANTITA'
1	* 4402010101	BATTENTE SKIMMER CON PERNO		5	4402010105	COPERCHIO E CORNICE TONDA SKIMMER	
1	* 4402010026	BATTENTE SKIMMER CON PERNO		6	4402010108	COPERCHIO TONDO SKIMMER	
1	* 4402010030	BATTENTE SKIMMER CON PERNO		7	* 4402010207	PER PISCINA IN C.A.	
1	* 4402010072	BATTENTE SKIMMER CON PERNO		7	* 4402010144	PER PISCINA IN C.A.	
2	4402010102	ALETTA PARZIALIZZATRICE SKIMMER		7	* 4402010145	PER PISCINA IN C.A.	
3	4402010103	CESTELLO SKIMMER		7	* 4402010146	PER PISCINA IN C.A.	
4	4402010104	COPERCHIO CESTELLO SKIMMER CON TA					

CODICE 00251, 00251CL090, 00251CL129, 00251CL144

DESCRIZIONE: SKIMMER 15L PF T. CIRCOLARE B. LARGA

OSSERVAZIONI

POS	CODICE	OSSERVAZIONI
1	* 4402010101	PER: 00251 BLANCO / WHITE
1	* 4402010026	PER: 00251CL090 BEIGE
1	* 4402010030	PER: 00251CL129 GRIS / GREY
1	* 4402010072	PER: 00251CL144 ANTRACITA / ANTHRACITE
7	* 4402010207	PER: 00251 BLANCO / WHITE
7	* 4402010144	PER: 00251CL090 BEIGE
7	* 4402010145	PER: 00251CL129 GRIS / GREY
7	* 4402010146	PER: 00251CL144 ANTRACITA / ANTHRACITE

CODE **00251, 00251CL090, 00251CL129, 00251CL144**

BESCHREIBUNG: **SKIMMER 15L PF ABDECKUNG RUND EINLASS BREIT**

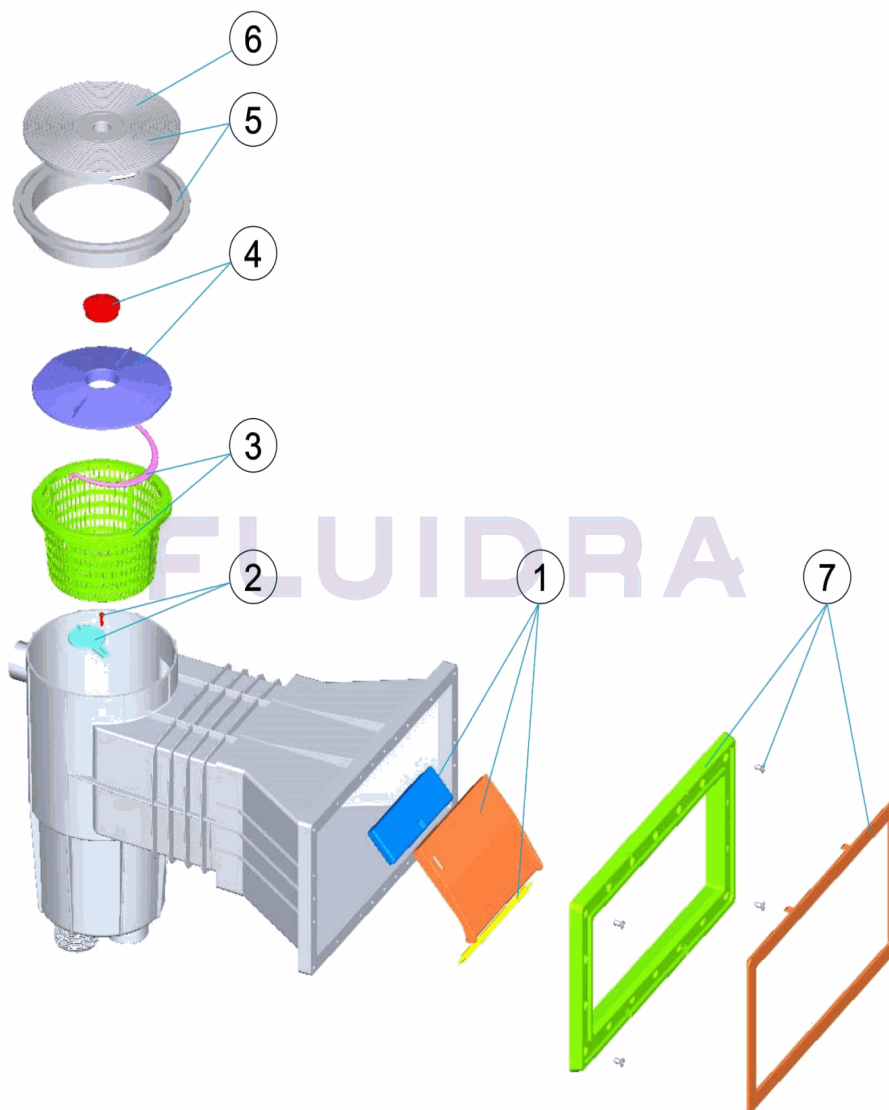

DEUTSCH

POS	CODE	BESCHREIBUNG	MENGE	POS	CODE	BESCHREIBUNG	MENGE
1	* 4402010101	SKIMMERKLAPPE SCHARNIER		5	4402010105	ABDECKUNG UND RING SKIMMER RUND	
1	* 4402010026	SET SKIMMERKLAPPE MIT SCHWIMMER		6	4402010108	ABDECKUNG RUND SKIMMER	
1	* 4402010030	SET SKIMMERKLAPPE MIT SCHWIMMER		7	* 4402010207	RAHMEN SKIMMEREINLASS BETONBECKE	
1	* 4402010072	SKIMMERKLAPPE SCHARNIER		7	* 4402010144	RAHMEN SKIMMEREINLASS BETONBECKE	
2	4402010102	ABDECKKAPPE		7	* 4402010145	RAHMEN SKIMMEREINLASS BETONBECKE	
3	4402010103	SKIMMERKORB		7	* 4402010146	RAHMEN SKIMMEREINLASS BETONBECKE	
4	4402010104	ABDECKUNG SKIMMKORB MIT STOPFEN					

CODE **00251, 00251CL090, 00251CL129, 00251CL144**

BESCHREIBUNG: **SKIMMER 15L PF ABDECKUNG RUND EINLASS BREIT**

HINWEISE

POS	CODE	HINWEISE
1	* 4402010101	FÜR: 00251 BLANCO / WHITE
1	* 4402010026	FÜR: 00251CL090 BEIGE
1	* 4402010030	FÜR: 00251CL129 GRIS / GREY
1	* 4402010072	FÜR: 00251CL144 ANTRACITA / ANTHRACITE
7	* 4402010207	FÜR: 00251 BLANCO / WHITE
7	* 4402010144	FÜR: 00251CL090 BEIGE
7	* 4402010145	FÜR: 00251CL129 GRIS / GREY
7	* 4402010146	FÜR: 00251CL144 ANTRACITA / ANTHRACITE

CODIGO **00251, 00251CL090, 00251CL129, 00251CL144**

DESCRIÇÃO: **SKIMMER 15 L PF T.CIRCULAR B. LARGA**

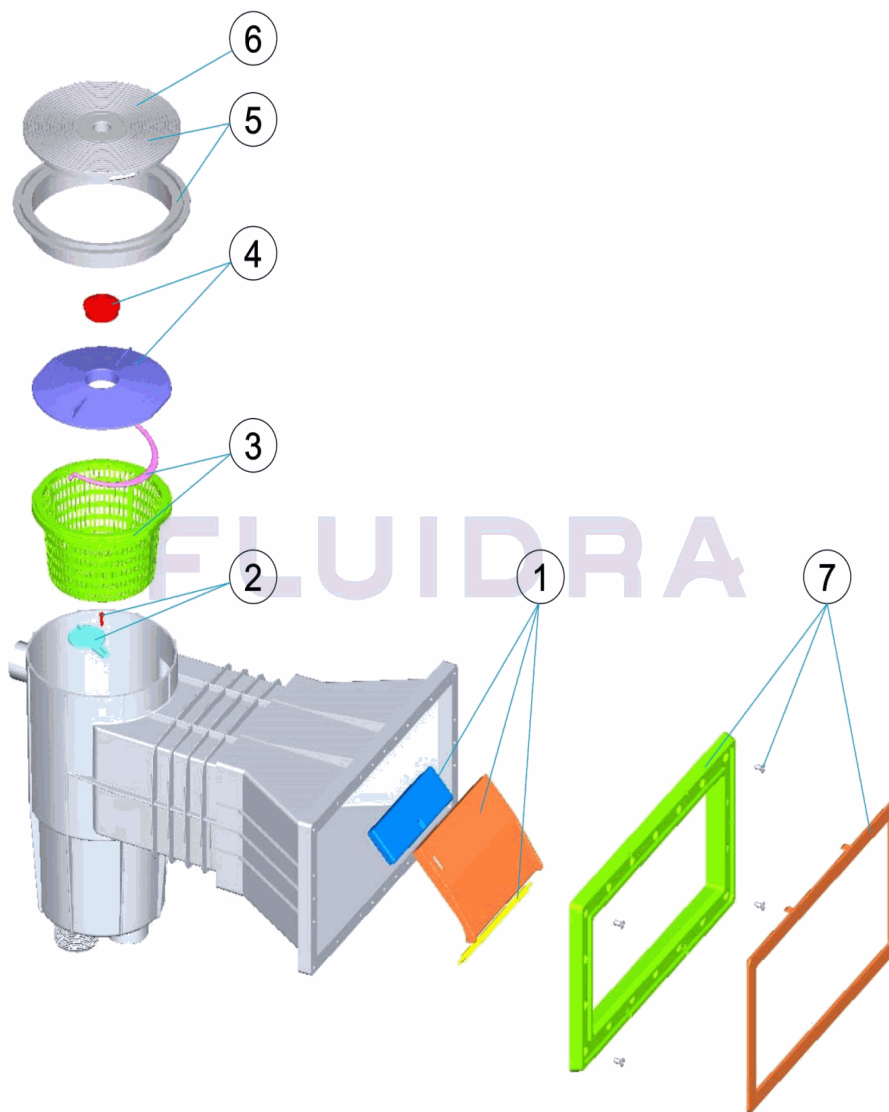

PORTUGUES

POS	CODIGO	DESCRIÇÃO	JANTIDADE	POS	CODIGO	DESCRIÇÃO	JANTIDADE
1	* 4402010101	COMPORTA SKIMMER BISAGRA		5	4402010105	TAMPA E ARO CIRCULAR SKIMMER	
1	* 4402010026	COMPORTA SKIMMER BISAGRA		6	4402010108	TAMPA CIRCULAR SKIMMER	
1	* 4402010030	COMPORTA SKIMMER BISAGRA		7	* 4402010207	CAIXILHO BOCA SKIMMER PISCINA BETÃO	
1	* 4402010072	COMPORTA SKIMMER BISAGRA		7	* 4402010144	CAIXILHO BOCA SKIMMER PISCINA BETÃO	
2	4402010102	CLAPETA SKIMMER		7	* 4402010145	CAIXILHO BOCA SKIMMER PISCINA BETÃO	
3	4402010103	CESTO SKIMMER		7	* 4402010146	CAIXILHO BOCA SKIMMER PISCINA BETÃO	
4	4402010104	TAMPA CESTO SKIMMER					

CODIGO **00251, 00251CL090, 00251CL129, 00251CL144**

DESCRIÇÃO: SKIMMER 15 L PF T.CIRCULAR B. LARGA

OBSERVACÕES

POS	CODIGO	OBSERVACÕES
1	* 4402010101	PARA: 00251 BLANCO / WHITE
1	* 4402010026	PARA: 00251CL090 BEIGE
1	* 4402010030	PARA: 00251CL129 GRIS / GREY
1	* 4402010072	PARA: 00251CL144 ANTRACITA / ANTHRACITE
7	* 4402010207	PARA: 00251 BLANCO / WHITE
7	* 4402010144	PARA: 00251CL090 BEIGE
7	* 4402010145	PARA: 00251CL129 GRIS / GREY
7	* 4402010146	PARA: 00251CL144 ANTRACITA / ANTHRACITE