

CODIGO **01364**

DESCRIPCION: **MANGO FIJO 2,5 MTS. PALOMILLAS**

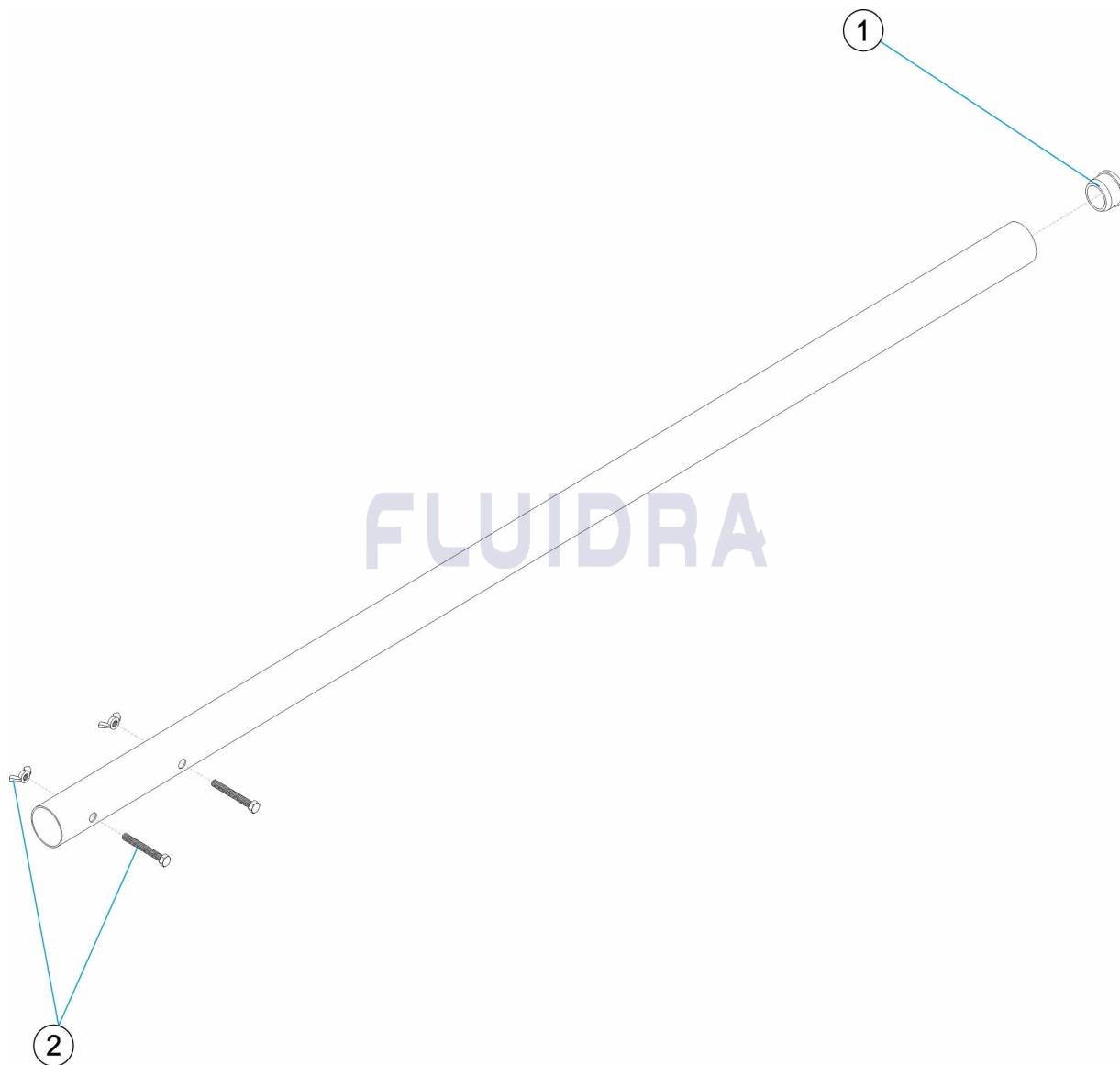

ESPAÑOL

POS	CODIGO	DESCRIPCION	CANTIDAD	POS	CODIGO	DESCRIPCION	CANTIDAD
1	4406030101	TAPON MANGO		2	4406030102	PALOMILLAS Y TORNILLOS MANGO	

CODE **01364**

DESCRIPTION: **MANCHE FIXE 2,5 M ÉCROUS PAPILLON**

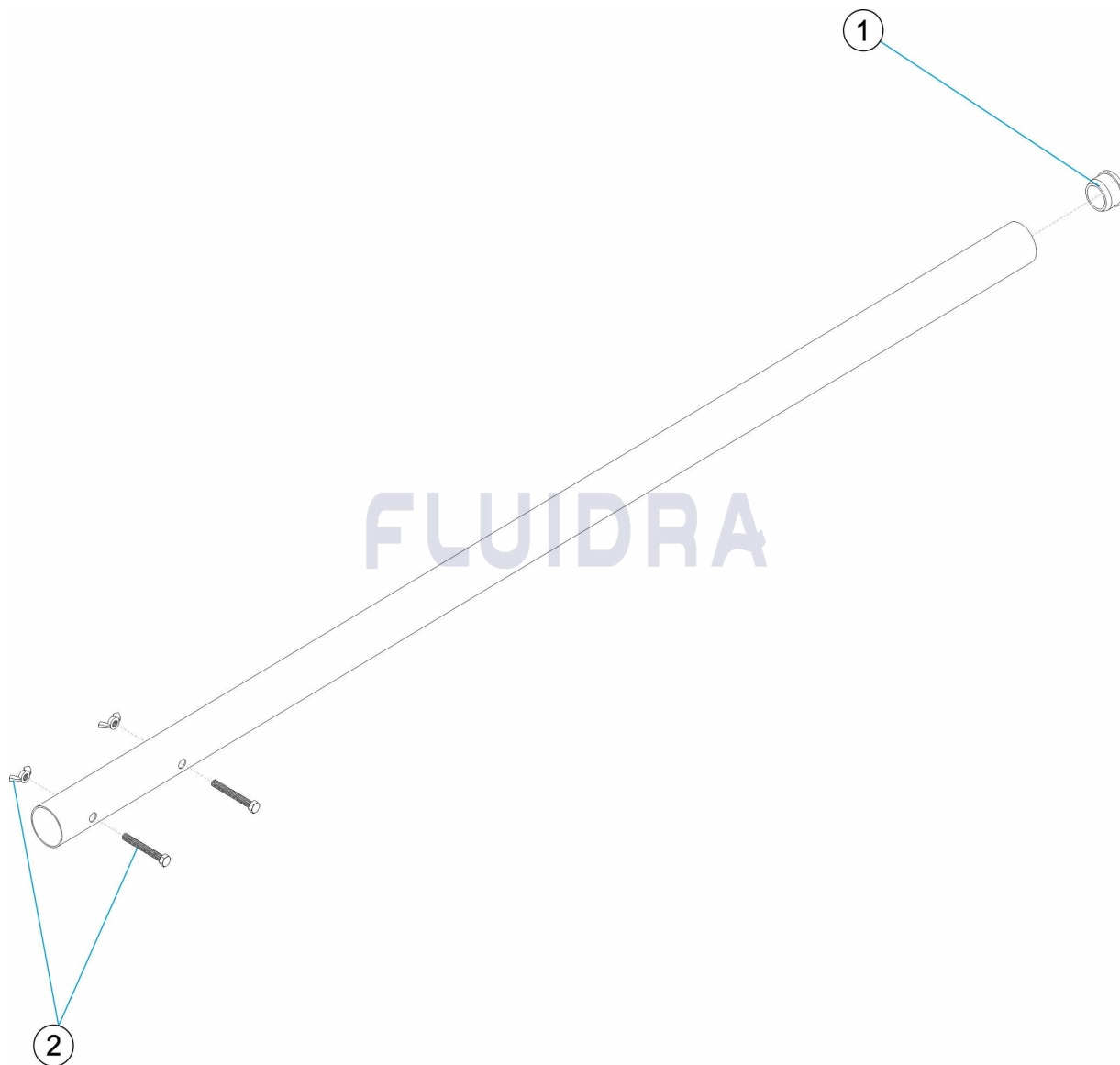

FRANCAIS

POS	CODE	DESCRIPTION	QUANTITE	POS	CODE	DESCRIPTION	QUANTITE
1	4406030101	BOUCHON DE MANCHE		2	4406030102	PAPILLONS ET VIS MANCHE	

CODE **01364**

DESCRIPTION: **FIXED HANDRAIL 2.5 METRES WALL BRACKETS**

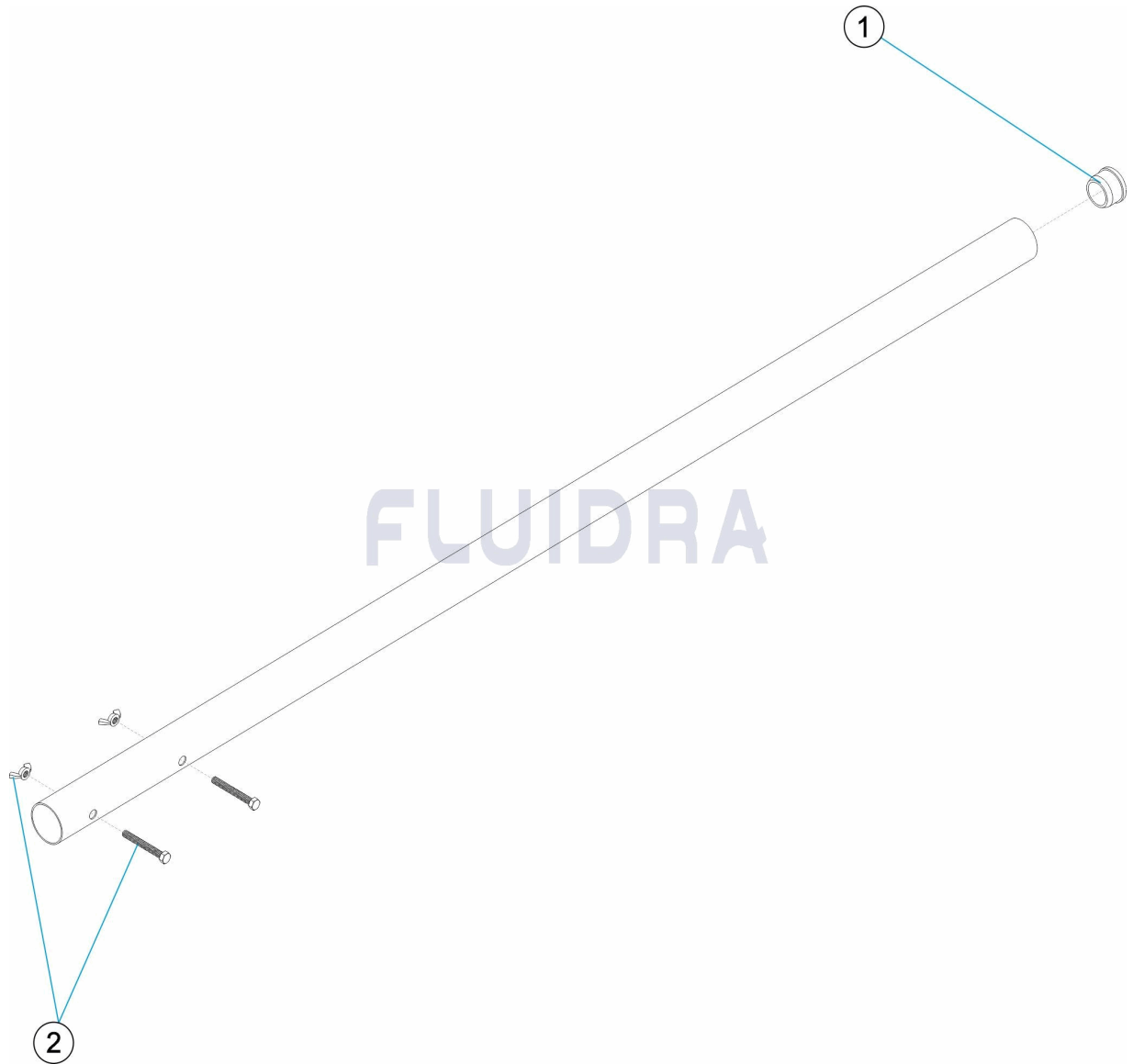

ENGLISH

POS	CODE	DESCRIPTION	QUANTITY	POS	CODE	DESCRIPTION	QUANTITY
1	4406030101	HANDLE PLUG		2	4406030102	HANDLE BUTTERFLY NUT & BOLTS	

CODICE **01364**

DESCRIZIONE: **MANICO FISSO 2,5 METRI GALLETTI**

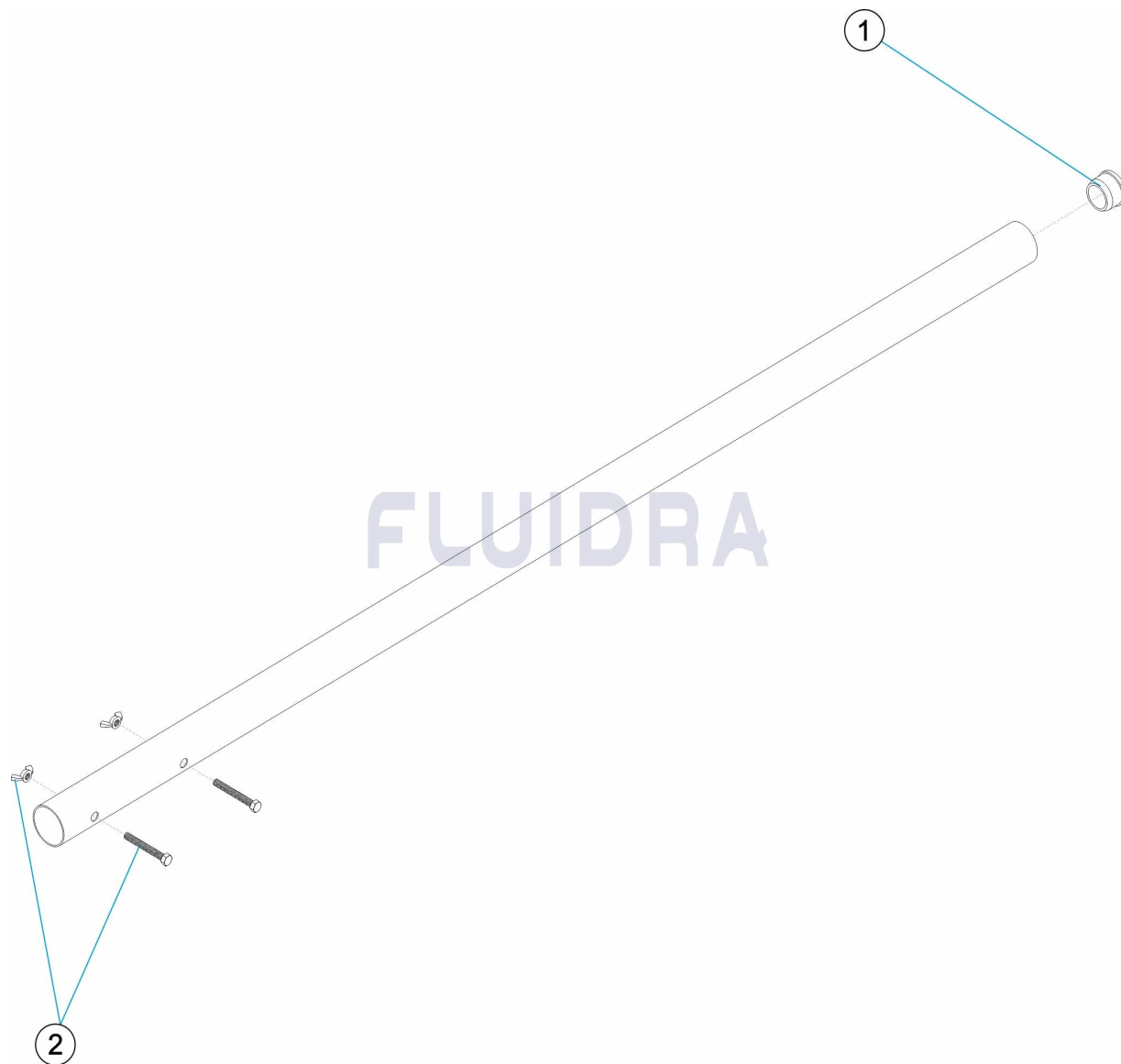

ITALIANO

POS	CODICE	DESCRIZIONE	QUANTITA'	POS	CODICE	DESCRIZIONE	QUANTITA'
1	4406030101	COPERCHIO MANICO		2	4406030102	FARFALLE E VITI PER MANICO	

CODE **01364**

BESCHREIBUNG: **GRIFF FIX 2,5 M FLÜGELMUTTERN**

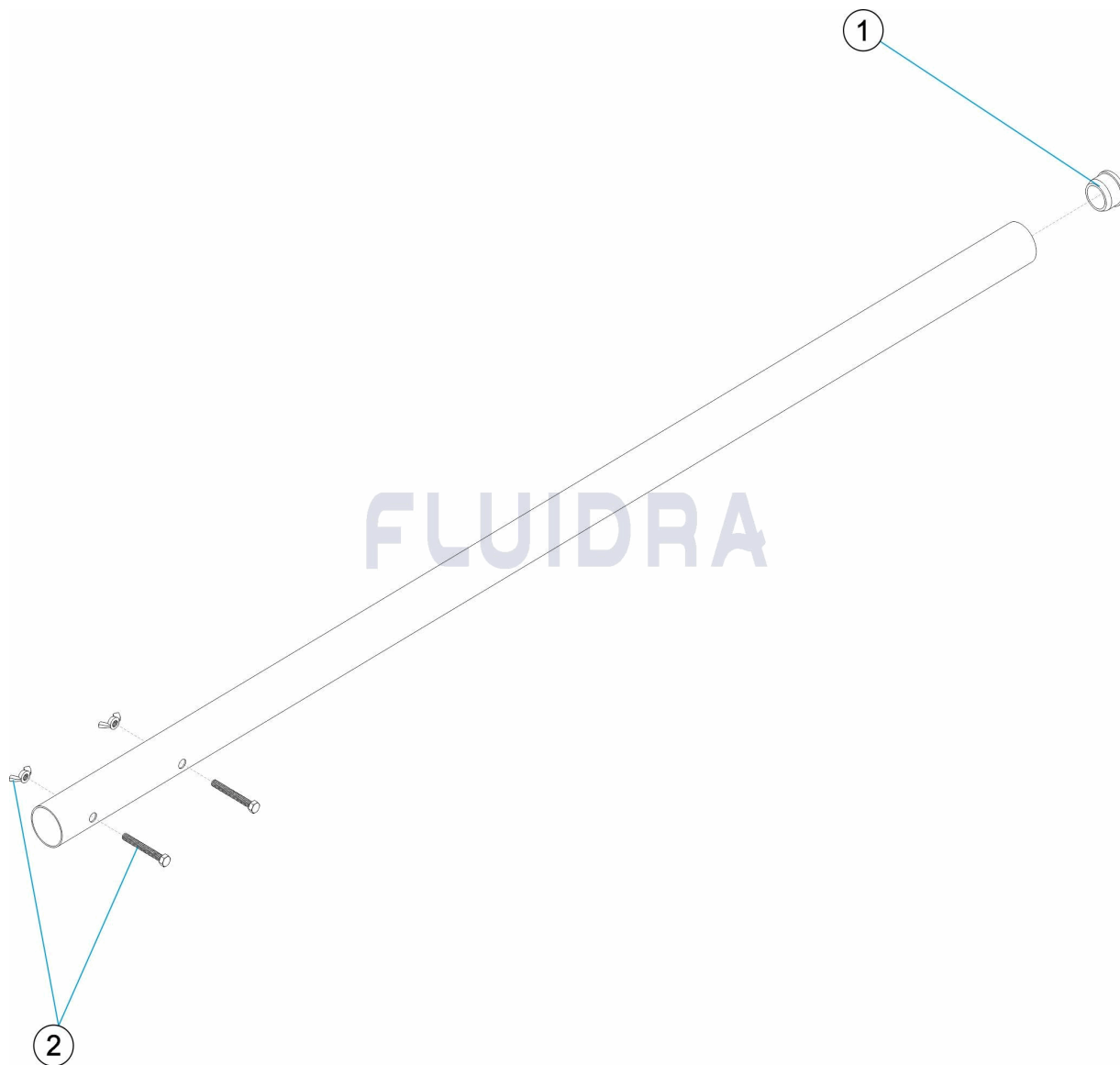

DEUTSCH

POS	CODE	BESCHREIBUNG	MENGE	POS	CODE	BESCHREIBUNG	MENGE
1	4406030101	STOPFEN GRIFF		2	4406030102	FLÜGELMUTTERN UND SCHRAUBEN GRIFI	

CODIGO **01364**

DESCRIÇÃO: **CABO FIXO 2,5 M PLACAS SUPORTE**

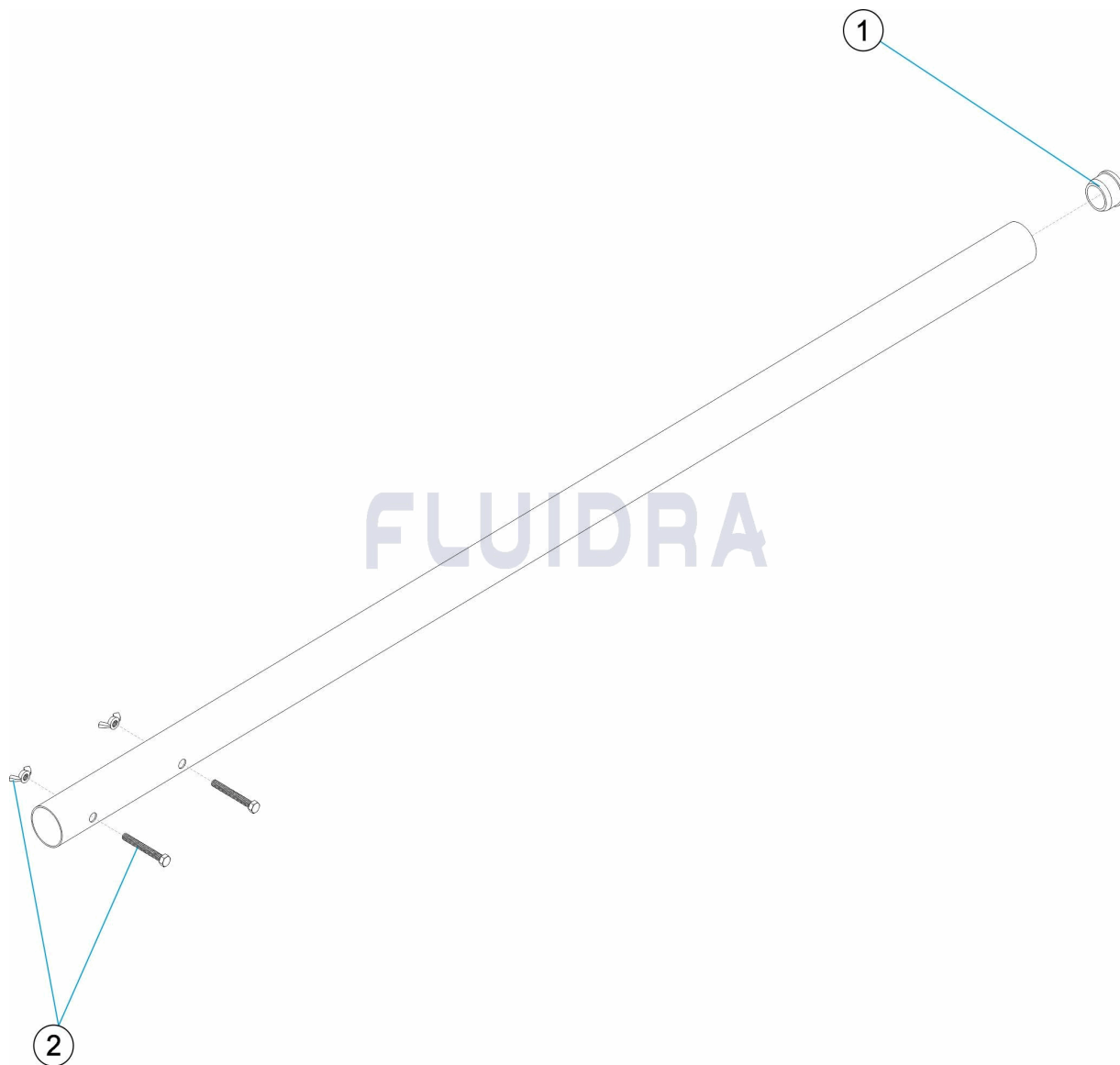

PORTUGUES

POS	CODIGO	DESCRIÇÃO	JANTIDADE	POS	CODIGO	DESCRIÇÃO	JANTIDADE
1	4406030101	TAMPÃO CABO 2,5 MTS. LIG. PARAFUSOS		2	4406030102	PORCAS E PARAFUSOS CABO	