

CODIGO 20888, 20888CL01, 20889

DESCRIPCION: SKIMMER PISCINA ELEVADA BOCA ESTÁNDAR CON BOQUILLA

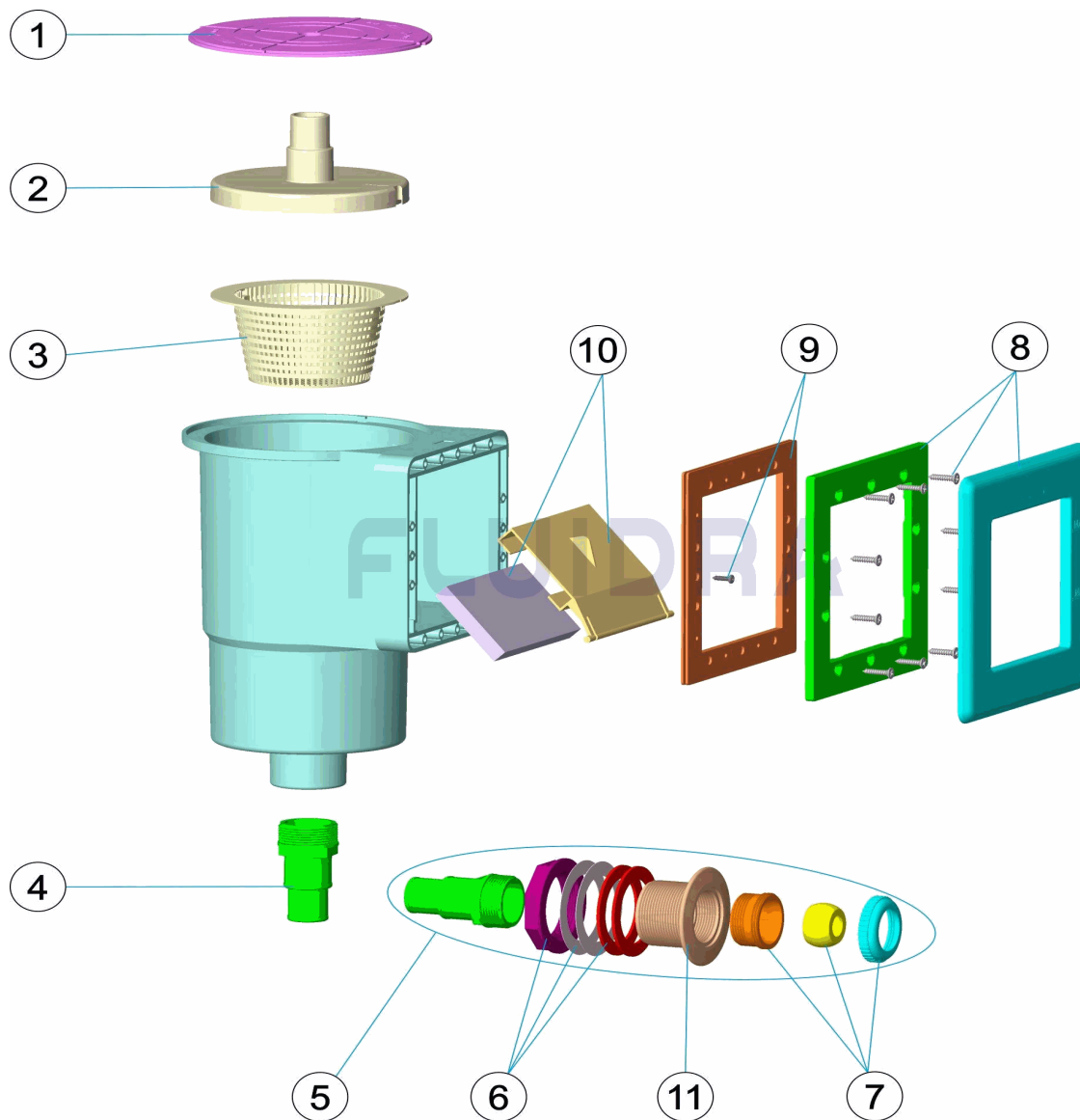

ESPAÑOL

POS	CODIGO	DESCRIPCION	CANTIDAD	POS	CODIGO	DESCRIPCION	CANTIDAD
1	* 4411030604	TAPA SKIMMER		7	* 4411030611	CJTO. BOLA	
1	* 4402010227	TAPA SKIMMER		8	* 4411030607	TAPA Y MARCO SKIMMER	
2	4411030603	TAPA ASPIRACION SKIMMER		8	* 4411030002	TAPA Y MARCO SKIMMER	
3	4411030602	CESTO SKIMMER PISCINA ELEVADA		9	* 4411030605	JUNTA SKIMMER BOCA	
4	* 4402010228	MANGUITO SKIMMER		9	* 4411030004	JUNTA SKIMMER BOCA NEGRA	
4	* 4411030609	MANGUITO SKIMMER		10	4411030601	COMPUERTA FLOTADOR SKIMMER	
5	* 06501	BOQUILLA PISCINA ELEVADA		11	* 17239R0001	BASE BOQUILLA MULTIFLOW	
6	* 4411030612	ADAPTADOR MANGUERA					

CODIGO **20888, 20888CL01, 20889**

DESCRIPCION: SKIMMER PISCINA ELEVADA BOCA ESTÁNDAR CON BOQUILLA

OBSERVACIONES

POS	CODIGO	OBSERVACIONES
1	* 4411030604	PARA: 20888, 20889 WHITE
1	* 4402010227	PARA: 20888CL01 BLACK
4	* 4402010228	PARA: 20888CL01 BLACK
4	* 4411030609	PARA: 20888, 20889 WHITE
5	* 06501	PARA: 20889
6	* 4411030612	PARA: 20889
7	* 4411030611	PARA: 20889
8	* 4411030607	PARA: 20888, 20889 WHITE
8	* 4411030002	PARA: 20888CL01 BLACK
9	* 4411030605	PARA: 20888, 20889 WHITE
9	* 4411030004	PARA: 20888CL01 BLACK
11	* 17239R0001	PARA: 20889

CODE 20888, 20888CL01, 20889

DESCRIPTION: SKIMMER PISCINE HORS SOL OUVERTURE STANDARD AVEC BUSE

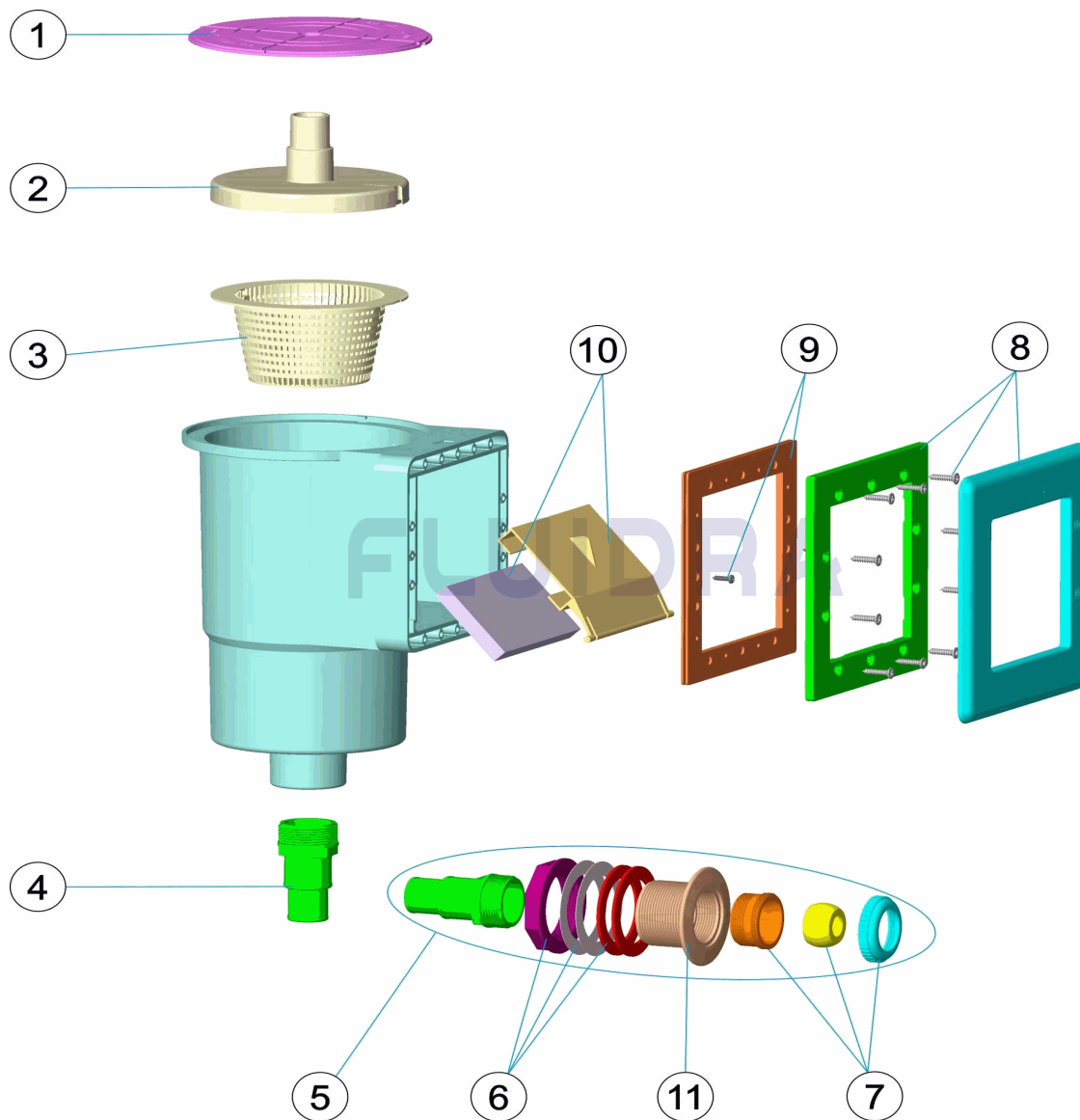

FRANCAIS

POS	CODE	DESCRIPTION	QUANTITE	POS	CODE	DESCRIPTION	QUANTITE
1	* 4411030604	COUVERCLE ROND DE SKIMMER		7	* 4411030611	ENSEMBLE SPHERE	
1	* 4402010227	COUVERCLE ROND DE SKIMMER		8	* 4411030607	COUVERCLE ET FAÇADE SKIMMER	
2	4411030603	COUVERCLE ASPIRATION SKIMMER		8	* 4411030002	COUVERCLE ET FAÇADE SKIMMER	
3	4411030602	PANIER SKIMMER PISCINE HORS SOL		9	* 4411030605	JOINT SKIMMER BOUCHE	
4	* 4402010228	MANCHON SKIMMER		9	* 4411030004	JOINT SKIMMER BOUCHE NOIR	
4	* 4411030609	MANCHON SKIMMER		10	4411030601	VOLET FLOTTEUR SKIMMER	
5	* 06501	BUSE PISCINE HORS-SOL		11	* 17239R0001	CORPS DE LA BUSE	
6	* 4411030612	ADAPTATEUR TUYAU					

CODE **20888, 20888CL01, 20889**

DESCRIPTION: **SKIMMER PISCINE HORS SOL OUVERTURE STANDARD AVEC BUSE**

OBSERVATIONS

POS	CODE	OBSERVATIONS
1	* 4411030604	POUR: 20888, 20889 WHITE
1	* 4402010227	POUR: 20888CL01 BLACK
4	* 4402010228	POUR: 20888CL01 BLACK
4	* 4411030609	POUR: 20888, 20889 WHITE
5	* 06501	POUR: 20889
6	* 4411030612	POUR: 20889
7	* 4411030611	POUR: 20889
8	* 4411030607	POUR: 20888, 20889 WHITE
8	* 4411030002	POUR: 20888CL01 BLACK
9	* 4411030605	POUR: 20888, 20889 WHITE
9	* 4411030004	POUR: 20888CL01 BLACK
11	* 17239R0001	POUR: 20889

CODE 20888, 20888CL01, 20889

DESCRIPTION: SKIMMER ABOVE-GROUND POOL STANDARD MOUTH WITH NOZZLE

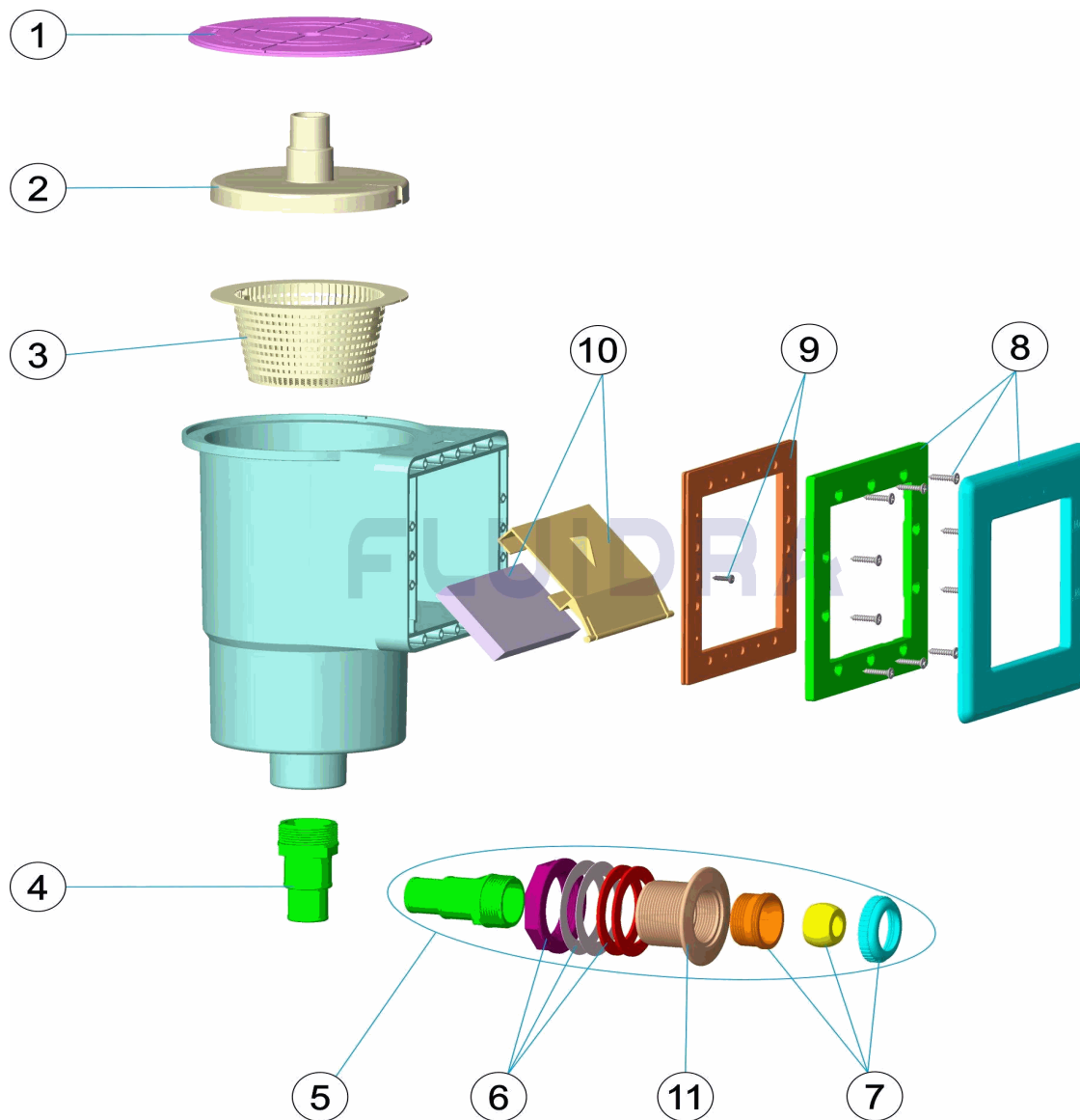

ENGLISH

POS	CODE	DESCRIPTION	QUANTITY	POS	CODE	DESCRIPTION	QUANTITY
1	* 4411030604	SKIMMER LID		7	* 4411030611	BALL ASSEMBLY	
1	* 4402010227	SKIMMER LID		8	* 4411030607	SKIMMER LID AND FRAME	
2	4411030603	SKIMMER BASKET FOR ABOVE GROUND		8	* 4411030002	SKIMMER LID AND FRAME	
3	4411030602	SKIMMER BASKET FOR ABOVE GROUND F		9	* 4411030605	SKIMMER MOUTH GASKET	
4	* 4402010228	SKIMMER HOSE		9	* 4411030004	SKIMMER MOUTH GASKET BLACK	
4	* 4411030609	SKIMMER HOSE		10	4411030601	SKIMMER FLOATING FLAP	
5	* 06501	NOZZLE ABOVE-GROUND POOL		11	* 17239R0001	INLET BASE	
6	* 4411030612	HOSE ADAPTER					

CODE **20888, 20888CL01, 20889**

DESCRIPTION: **SKIMMER ABOVE-GROUND POOL STANDARD MOUTH WITH NOZZLE**

OBSERVATIONS

POS	CODE	OBSERVATIONS
1	* 4411030604	FOR: 20888, 20889 WHITE
1	* 4402010227	FOR: 20888CL01 BLACK
4	* 4402010228	FOR: 20888CL01 BLACK
4	* 4411030609	FOR: 20888, 20889 WHITE
5	* 06501	FOR: 20889
6	* 4411030612	FOR: 20889
7	* 4411030611	FOR: 20889
8	* 4411030607	FOR: 20888, 20889 WHITE
8	* 4411030002	FOR: 20888CL01 BLACK
9	* 4411030605	FOR: 20888, 20889 WHITE
9	* 4411030004	FOR: 20888CL01 BLACK
11	* 17239R0001	FOR: 20889

CODICE **20888, 20888CL01, 20889**

DESCRIZIONE: **SKIMEMR PISCINA ELEVATA STANDARD CON BOCCHETTA**

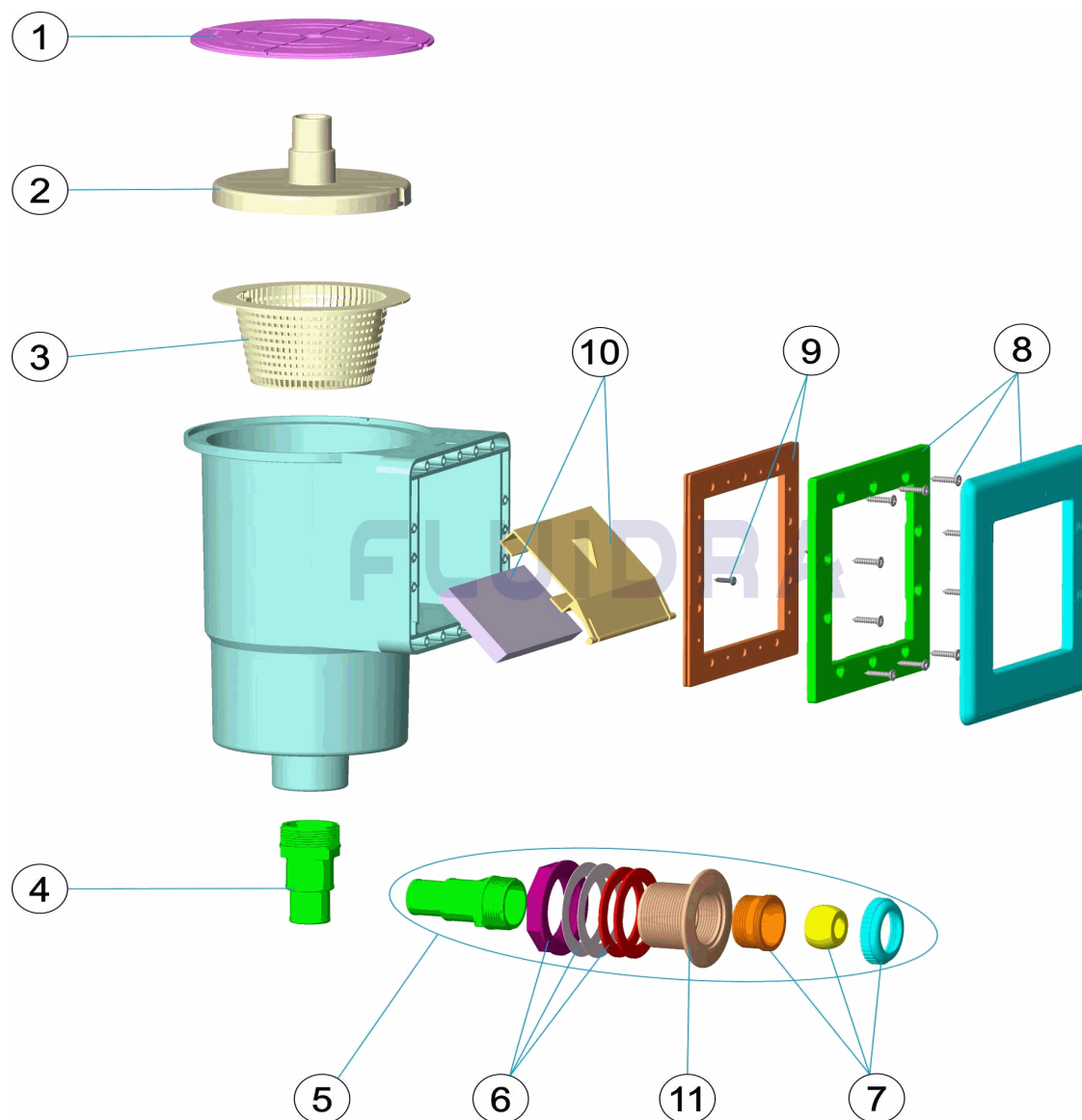

ITALIANO

POS	CODICE	DESCRIZIONE	QUANTITA'	POS	CODICE	DESCRIZIONE	QUANTITA'
1	* 4411030604	COPERCHIO SKIMMER		7	* 4411030611	GRUPPO SFERA	
1	* 4402010227	COPERCHIO SKIMMER		8	* 4411030607	COPERCHIO E CORNICE SKIMMER	
2	4411030603	COPERCHIO ASPIRAZIONE SKIMMER		8	* 4411030002	COPERCHIO E CORNICE SKIMMER	
3	4411030602	CESTELLO SKIMMER PISCINA FUORI TERF		9	* 4411030605	GUARNIZIONE SKIMMER BOCCA	
4	* 4402010228	MANICOTTO SKIMMER		9	* 4411030004	GUARNIZIONE SKIMMER BOCCA NERO	
4	* 4411030609	MANICOTTO SKIMMER		10	4411030601	SERRANDA GALLEGGIANTE SKIMMER	
5	* 06501	BOCCHETTA PISCINA ELEVATA		11	* 17239R0001	BASE BOCCHETTA	
6	* 4411030612	ADATTATORE MANICOTTO					

CODICE **20888, 20888CL01, 20889**

DESCRIZIONE: **SKIMEMR PISCINA ELEVATA STANDARD CON BOCCHETTA**

OSSERVAZIONI

POS	CODICE	OSSERVAZIONI
1	* 4411030604	PER: 20888, 20889 WHITE
1	* 4402010227	PER: 20888CL01 BLACK
4	* 4402010228	PER: 20888CL01 BLACK
4	* 4411030609	PER: 20888, 20889 WHITE
5	* 06501	PER: 20889
6	* 4411030612	PER: 20889
7	* 4411030611	PER: 20889
8	* 4411030607	PER: 20888, 20889 WHITE
8	* 4411030002	PER: 20888CL01 BLACK
9	* 4411030605	PER: 20888, 20889 WHITE
9	* 4411030004	PER: 20888CL01 BLACK
11	* 17239R0001	PER: 20889

CODE 20888, 20888CL01, 20889

BESCHREIBUNG: SKIMMER AUFSTELLBECKEN EINLASS STANDARD MIT DÜSE

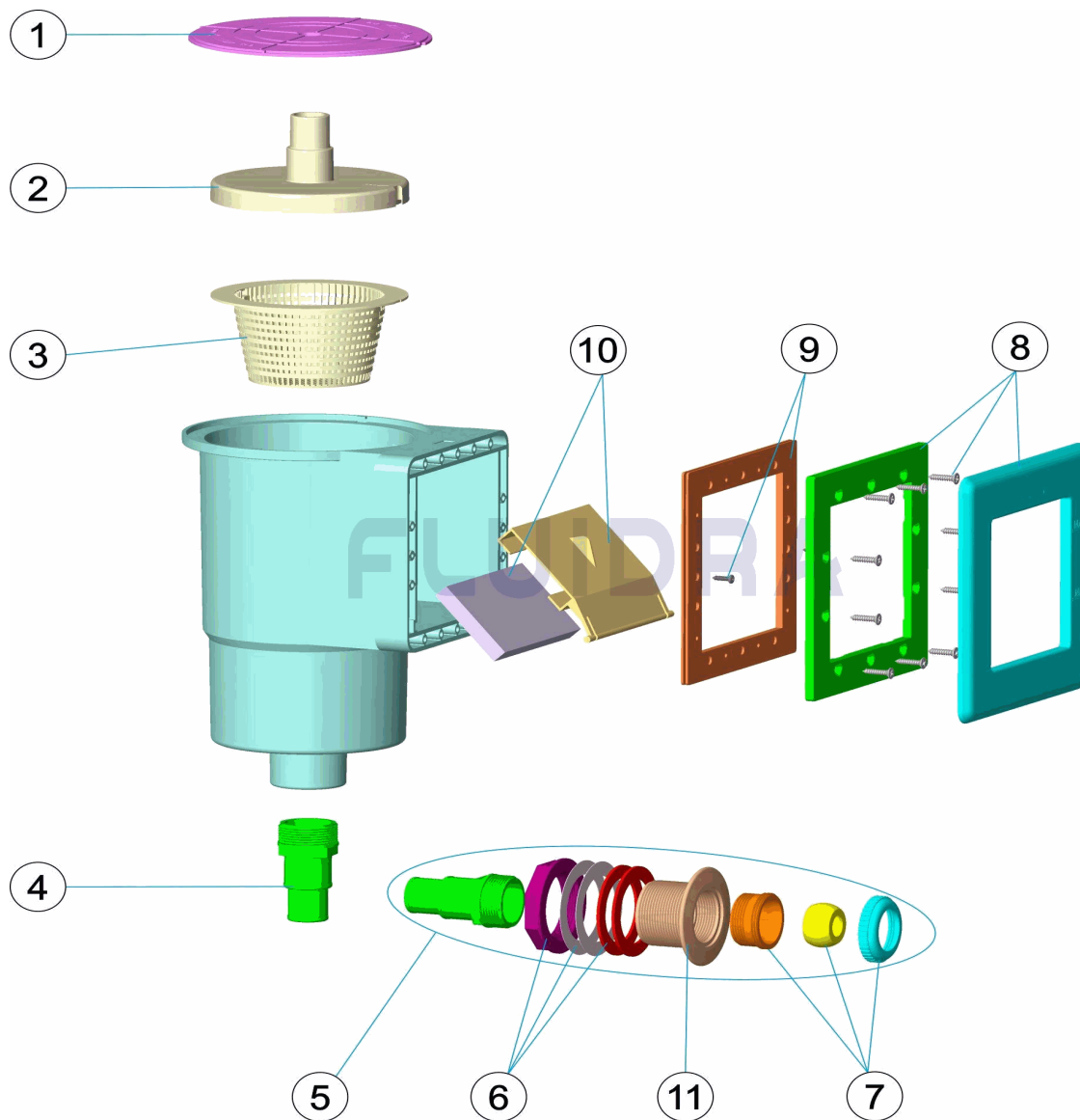

DEUTSCH

POS	CODE	BESCHREIBUNG	MENGE	POS	CODE	BESCHREIBUNG	MENGE
1	* 4411030604	SKIMMERDECKEL		7	* 4411030611	SET KUGEL	
1	* 4402010227	SKIMMERDECKEL		8	* 4411030607	ABDECKUNG UND RAHMEN SKIMMER	
2	4411030603	ABDECKUNG SKIMMER		8	* 4411030002	ABDECKUNG UND RAHMEN SKIMMER	
3	4411030602	SKIMMERKORB AUFSTELLBECKEN		9	* 4411030605	DICHTUNG SKIMMER EINLASS	
4	* 4402010228	NIPPEL SKIMMER		9	* 4411030004	DICHTUNG SKIMMER EINLASS SCHWARZE	
4	* 4411030609	NIPPEL SKIMMER		10	4411030601	KLAPPE SCHWIMMER SKIMMER	
5	* 06501	DÜSE AUFSTELLBECKEN		11	* 17239R0001	DÜSENBASIS MULTIFLOW	
6	* 4411030612	SCHLAUCHADAPTER					

CODE **20888, 20888CL01, 20889**

BESCHREIBUNG: **SKIMMER AUFSTELLBECKEN EINLASS STANDARD MIT DÜSE**

HINWEISE

POS	CODE	HINWEISE
1	* 4411030604	FÜR: 20888, 20889 WHITE
1	* 4402010227	FÜR: 20888CL01 BLACK
4	* 4402010228	FÜR: 20888CL01 BLACK
4	* 4411030609	FÜR: 20888, 20889 WHITE
5	* 06501	FÜR: 20889
6	* 4411030612	FÜR: 20889
7	* 4411030611	FÜR: 20889
8	* 4411030607	FÜR: 20888, 20889 WHITE
8	* 4411030002	FÜR: 20888CL01 BLACK
9	* 4411030605	FÜR: 20888, 20889 WHITE
9	* 4411030004	FÜR: 20888CL01 BLACK
11	* 17239R0001	FÜR: 20889

CODIGO 20888, 20888CL01, 20889

DESCRIÇÃO: SKIMMER PISCINA ELEVADA BOCA STANDARD COM BOQUILHA

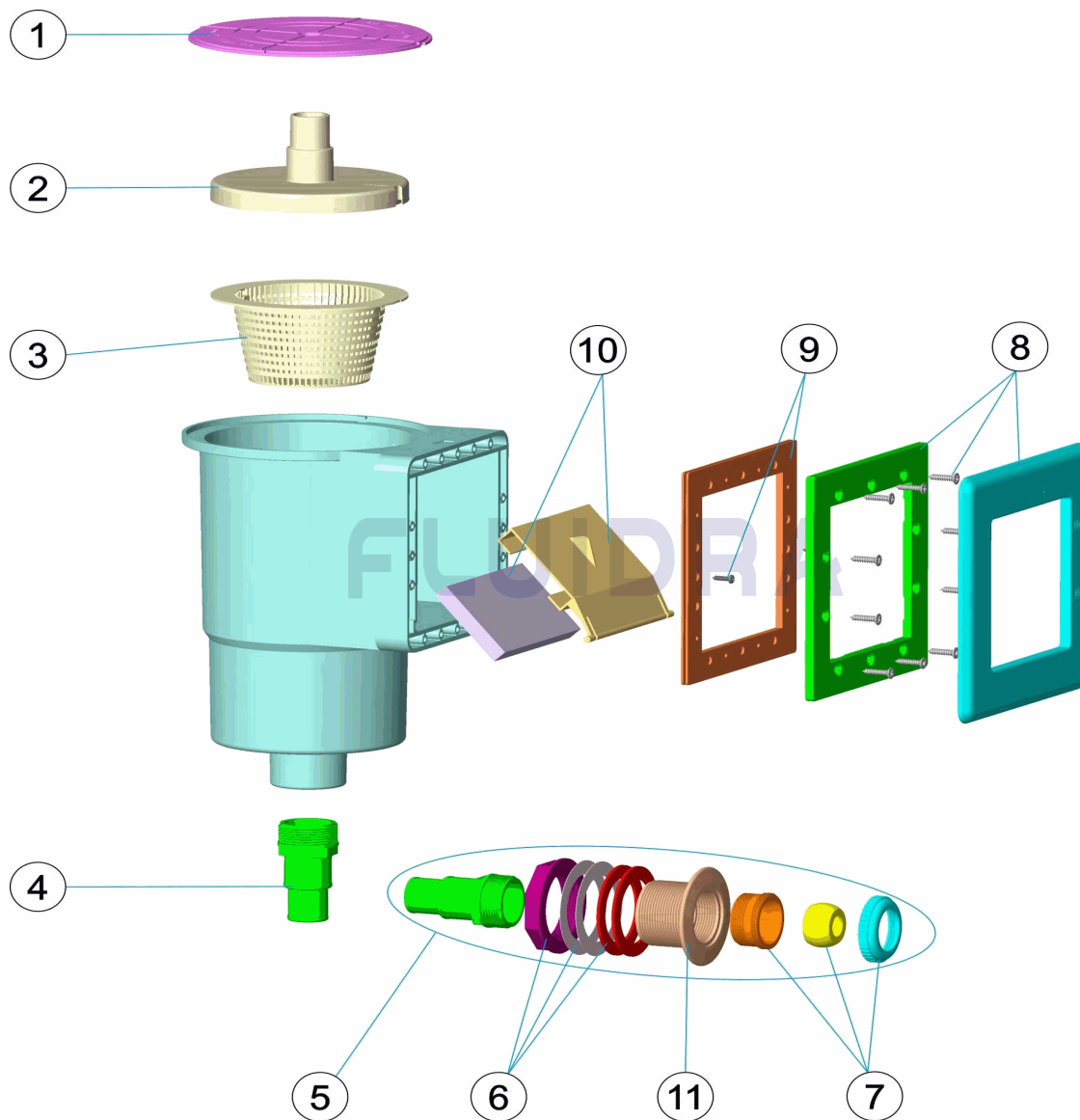

PORTUGUES

POS	CODIGO	DESCRIÇÃO	JANTIDADE	POS	CODIGO	DESCRIÇÃO	JANTIDADE
1	* 4411030604	TAMPA SKIMMER		7	* 4411030611	CONJUNTO BOLA	
1	* 4402010227	TAMPA SKIMMER		8	* 4411030607	TAMPA E MARCO SKIMMER	
2	4411030603	TAMPA ASPIRAÇÃO SKIMMER		8	* 4411030002	TAMPA E MARCO SKIMMER	
3	4411030602	CESTO SKIMMER PISCINA ELEVADA		9	* 4411030605	JUNTA SKIMMER BOCA	
4	* 4402010228	MANGUITO SKIMMER		9	* 4411030004	JUNTA SKIMMER BOCA PRETO	
4	* 4411030609	MANGUITO SKIMMER		10	4411030601	COMPORTA FLUTUADOR SKIMMER	
5	* 06501	BOQUILHA PISCINA ELEVADA		11	* 17239R0001	BASE BOCA	
6	* 4411030612	ADAPTADOR MANGUERA					

CODIGO 20888, 20888CL01, 20889

DESCRIÇÃO: SKIMMER PISCINA ELEVADA BOCA STANDARD COM BOQUILHA

OBSERVAÇÕES

POS	CODIGO	OBSERVAÇÕES
1	* 4411030604	PARA: 20888, 20889 WHITE
1	* 4402010227	PARA: 20888CL01 BLACK
4	* 4402010228	PARA: 20888CL01 BLACK
4	* 4411030609	PARA: 20888, 20889 WHITE
5	* 06501	PARA: 20889
6	* 4411030612	PARA: 20889
7	* 4411030611	PARA: 20889
8	* 4411030607	PARA: 20888, 20889 WHITE
8	* 4411030002	PARA: 20888CL01 BLACK
9	* 4411030605	PARA: 20888, 20889 WHITE
9	* 4411030004	PARA: 20888CL01 BLACK
11	* 17239R0001	PARA: 20889