

CODE **06664, 06665**

BESCHREIBUNG: **GRIFF ALUMINIUM TELESKOPISCH 3,6 - 4,8 M**

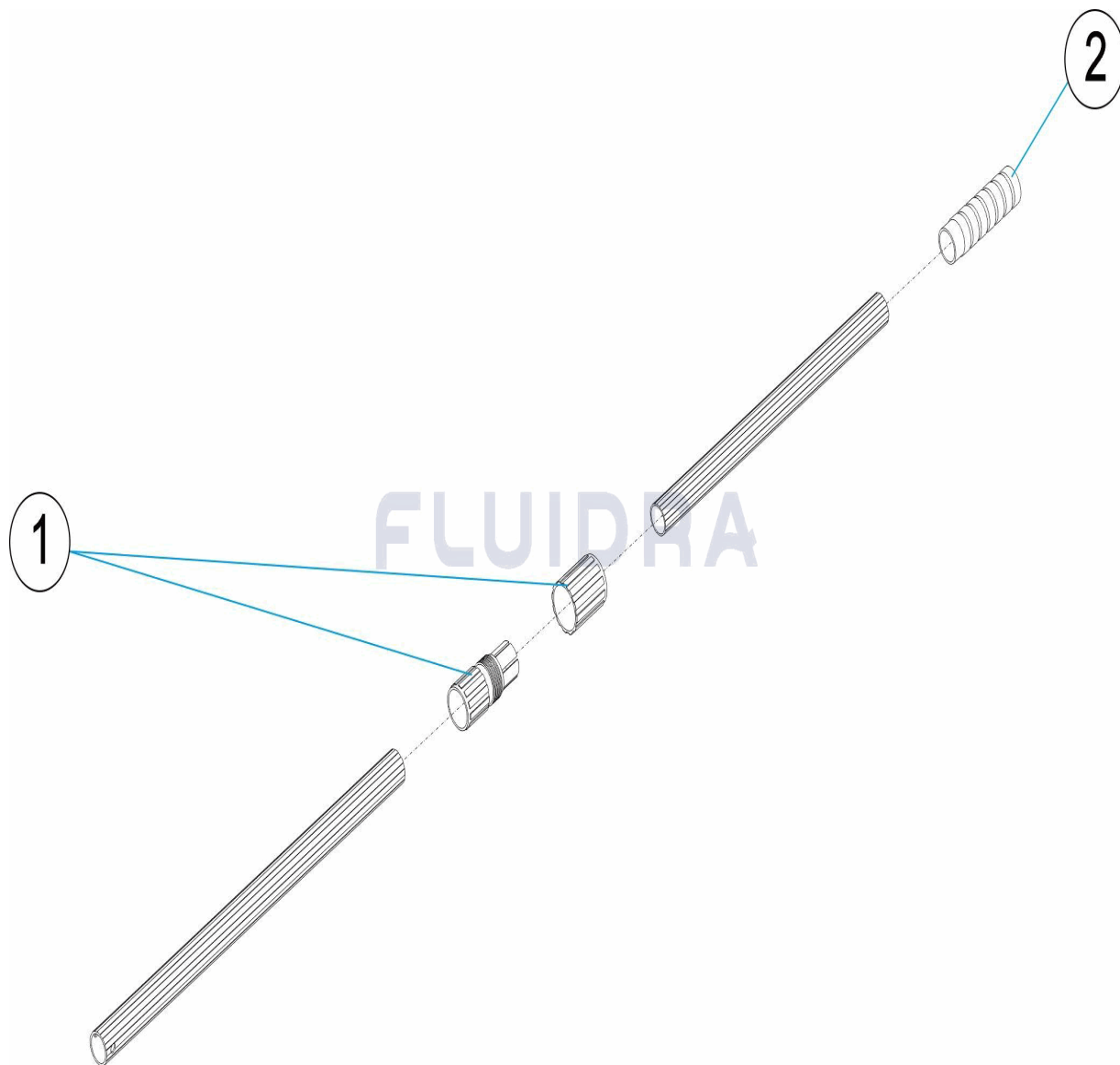

DEUTSCH

POS	CODE	BESCHREIBUNG	MENGE	POS	CODE	BESCHREIBUNG	MENGE
1	4406030501	KEMME UND MUTTER		2	4406030502	GRIFF	

CODE **06664, 06665**

DESCRIPTION: **TELESCOPIC ALUMINIUM POLE 3.6 - 4.8M**

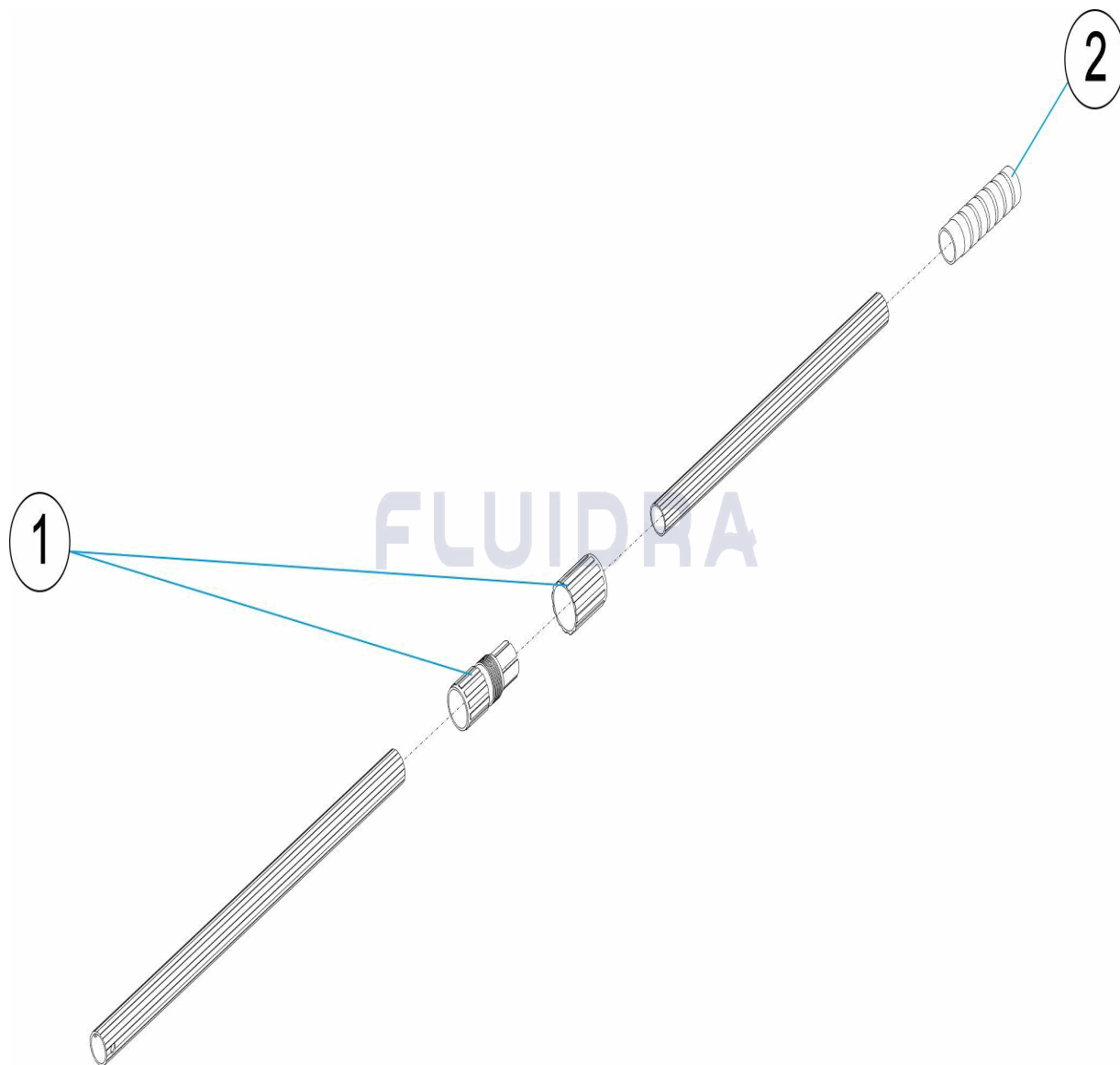

ENGLISH

POS	CODE	DESCRIPTION	QUANTITY	POS	CODE	DESCRIPTION	QUANTITY
1	4406030501	PEG AND RING NUT		2	4406030502	HANDLE GRIP	

CODIGO **06664, 06665**

DESCRIPCION: **MANGO ALUMINIO TELESCOPICO 3,6 - 4,8 M.**

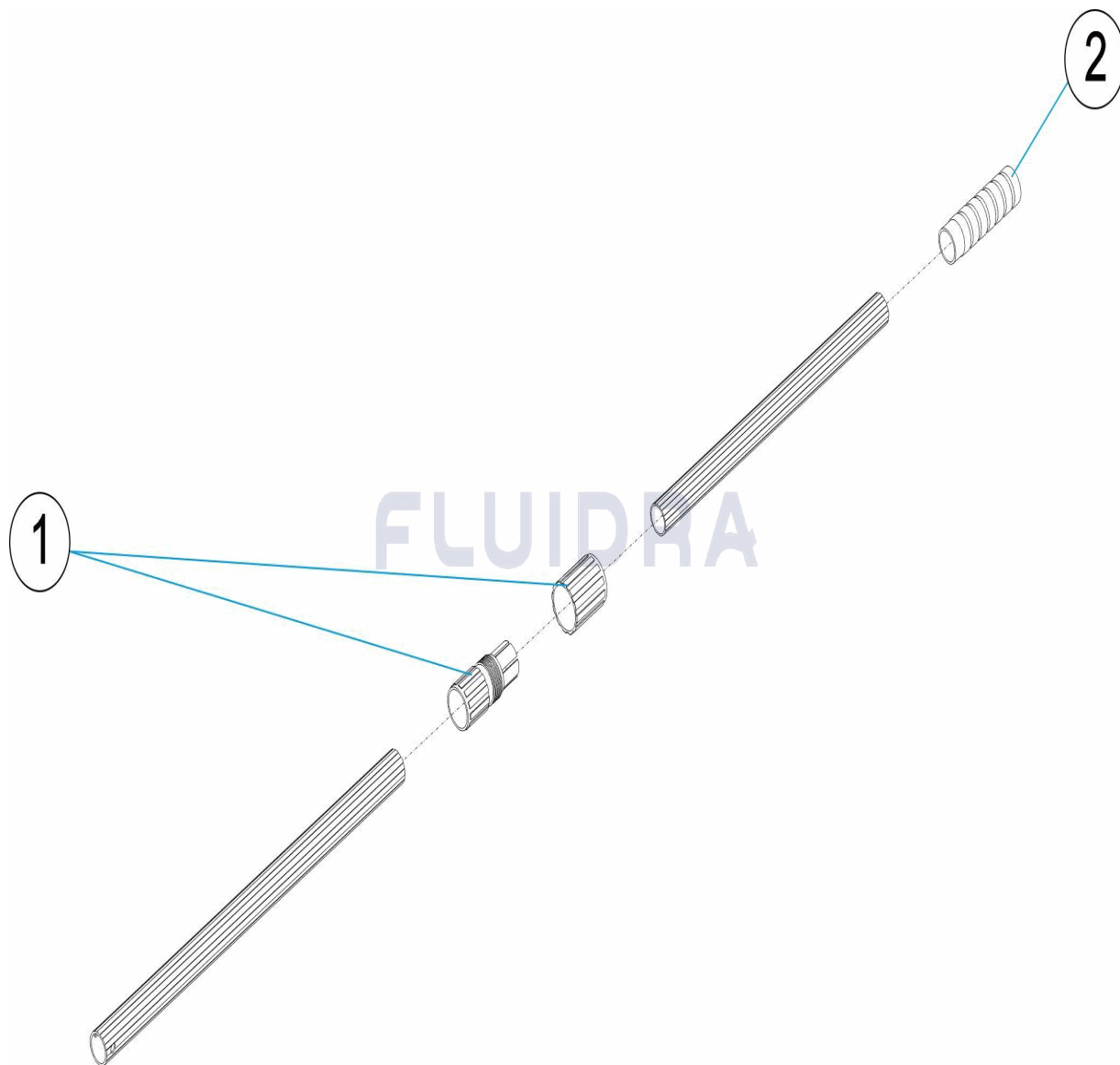

ESPAÑOL

POS	CODIGO	DESCRIPCION	CANTIDAD	POS	CODIGO	DESCRIPCION	CANTIDAD
1	4406030501	PINZA Y TUERCA		2	4406030502	EMPUÑADURA MANGO	

CODE **06664, 06665**

DESCRIPTION: **MANCHE ALUMINIUM TÉLESCOPIQUE 3,6 - 4,8 M.**

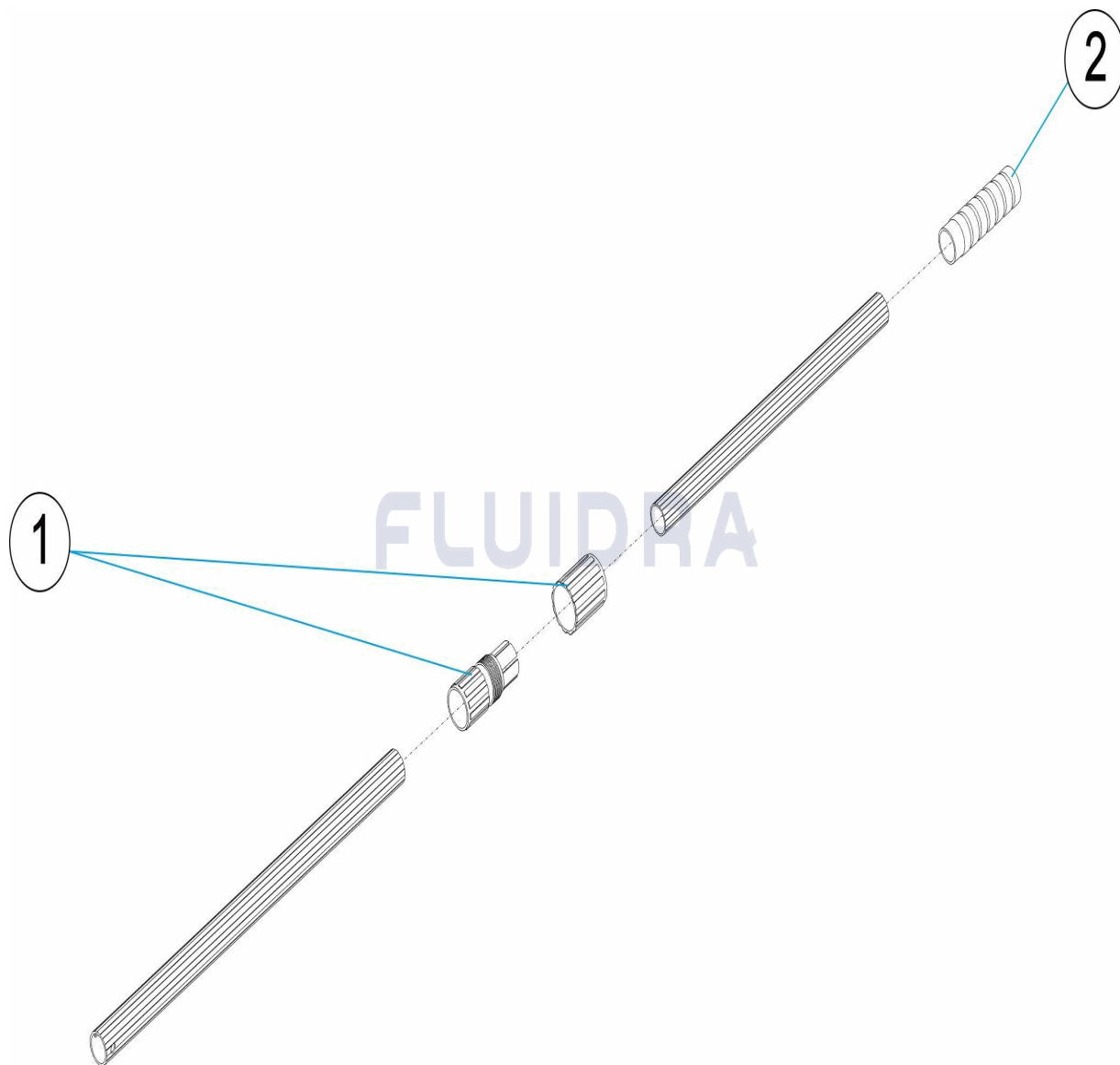

FRANCAIS

POS	CODE	DESCRIPTION	QUANTITE	POS	CODE	DESCRIPTION	QUANTITE
1	4406030501	PINCE ET ÉCROU		2	4406030502	POIGNEE DE MANCHE	

CODICE **06664, 06665**

DESCRIZIONE: **MANICO ALLUMINIO TELESCOPICO 3,6 - 4,8 M.**

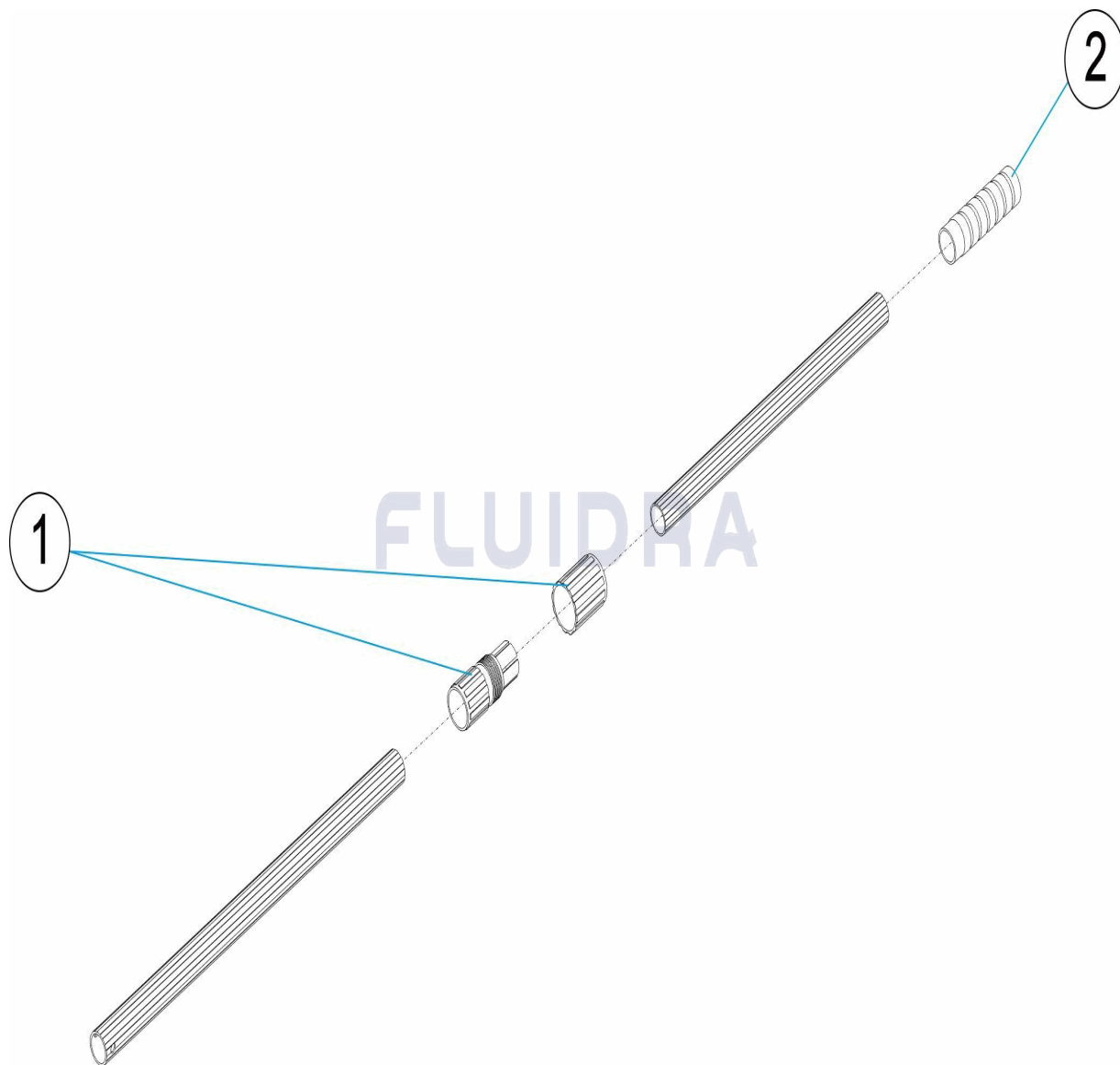

ITALIANO

POS	CODICE	DESCRIZIONE	QUANTITA'	POS	CODICE	DESCRIZIONE	QUANTITA'
1	4406030501	PINZA E GHIERA		2	4406030502	IMPUGNATURA MANICO	

CODIGO **06664, 06665**

DESCRIÇÃO: **CABO ALUMÍNIO TELESCÓPICO 3,6 - 4,8 M.**

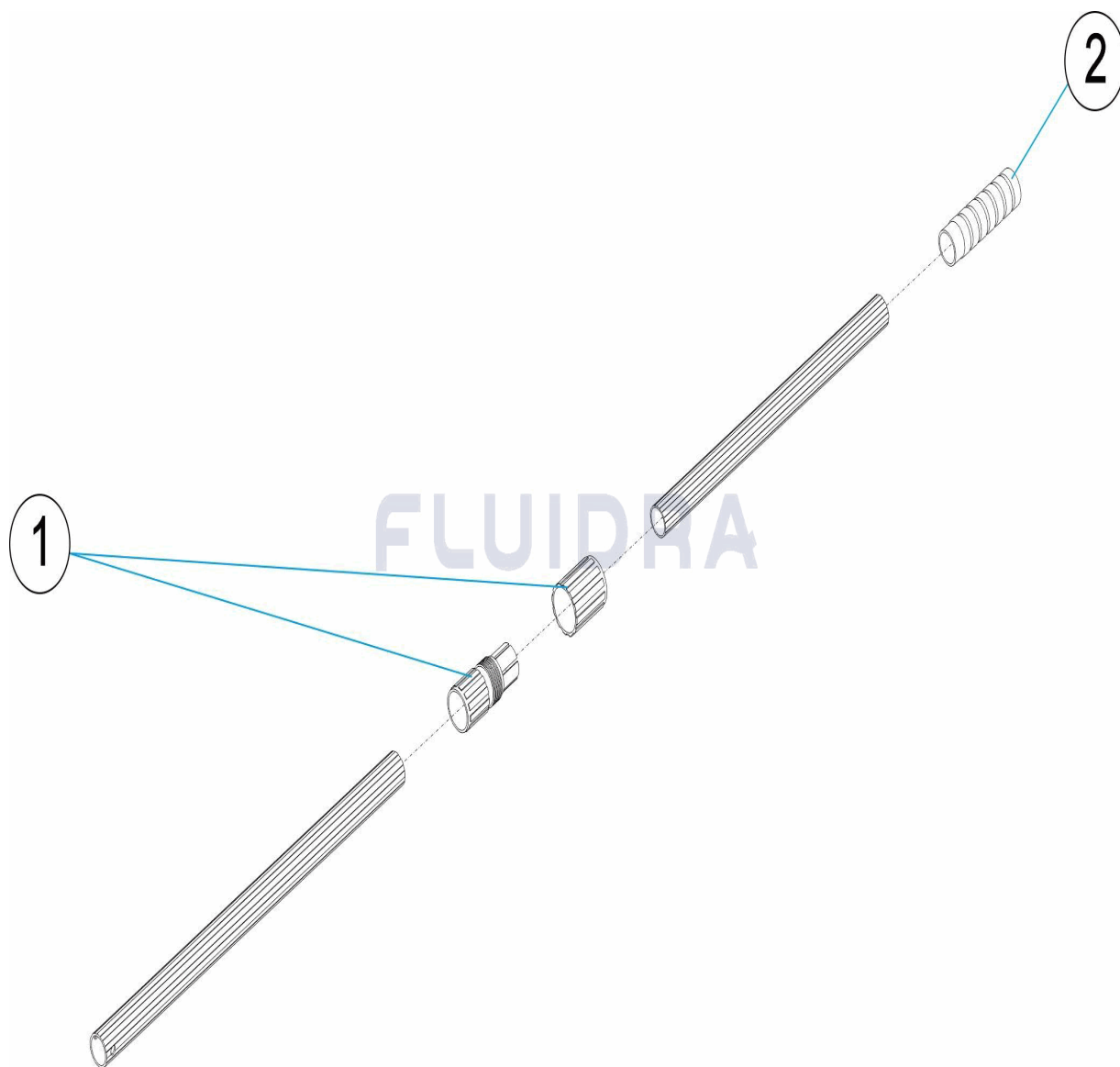

PORTUGUES

POS	CODIGO	DESCRIÇÃO	JANTIDADE	POS	CODIGO	DESCRIÇÃO	JANTIDADE
1	4406030501	PINÇA E PORCA CABOS 2,4-4,8		2	4406030502	PUNHO CABOS 2,4-4,8	