

CODIGO **08730**

DESCRIPCION: **BASE CON RUEDAS SILLA SOCORRISTA**

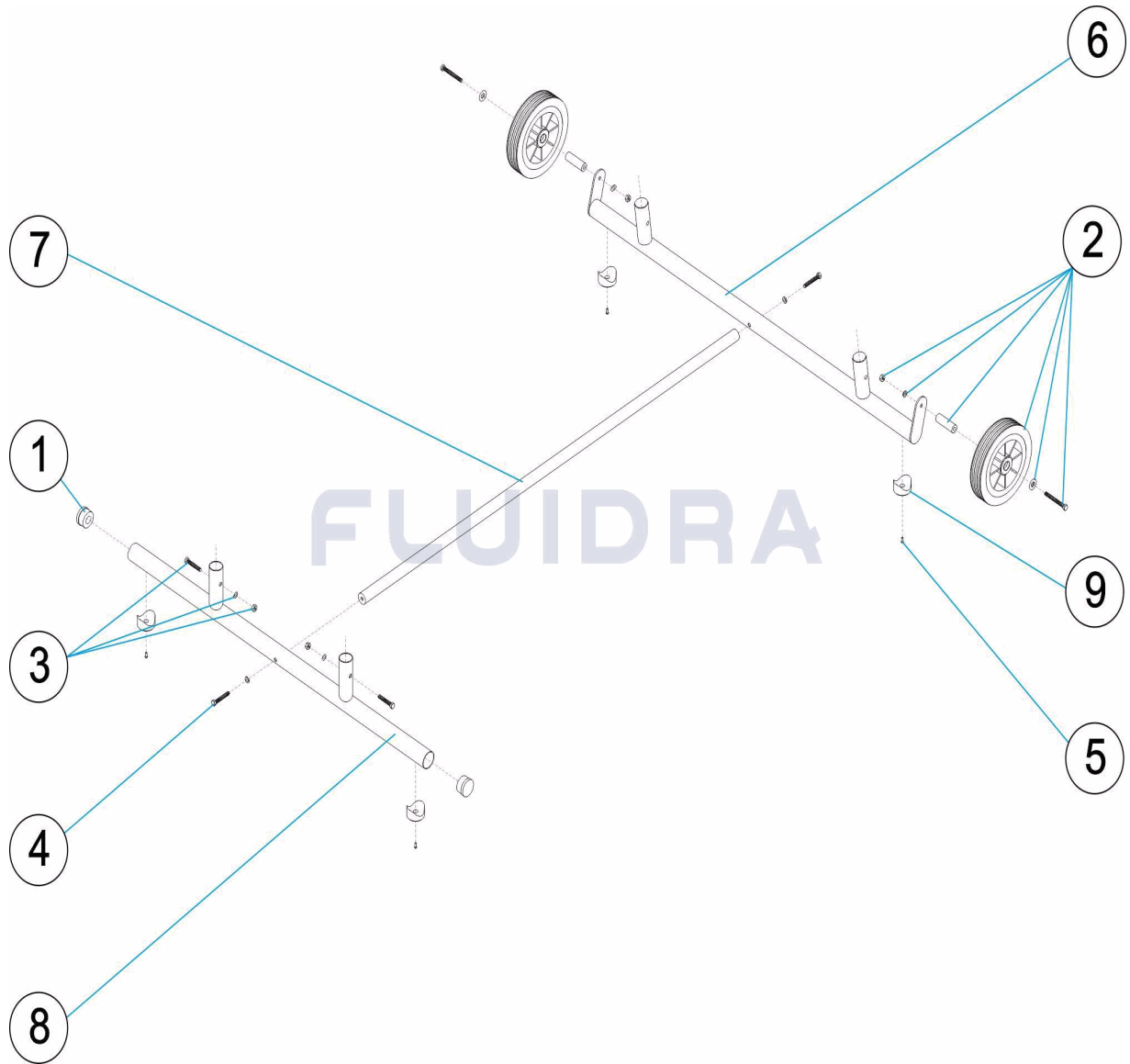

ESPAÑOL

POS	CODIGO	DESCRIPCION	CANTIDAD	POS	CODIGO	DESCRIPCION	CANTIDAD
1	4401070208	TAPON D.43		6	08730R0300	TUBO TRASERO	
2	4401070209	RUEDA SILLA SOCORRISTA		7	08730R0100	TUBO CENTRAL	
3	4401030103	TORNILLERIA FIJACION PISTA		8	08730R0200	TUBO DELANTERO	
4	70101R08055	TORNILLO DIN-933 M8X55		9	00127R0403	ANILLO CONCAVO	
5	07628R0005	REMACHE INOX					

CODE **08730**

DESCRIPTION: **BASE AVEC ROUES FAUTEUIL DE SURVEILLANCE**

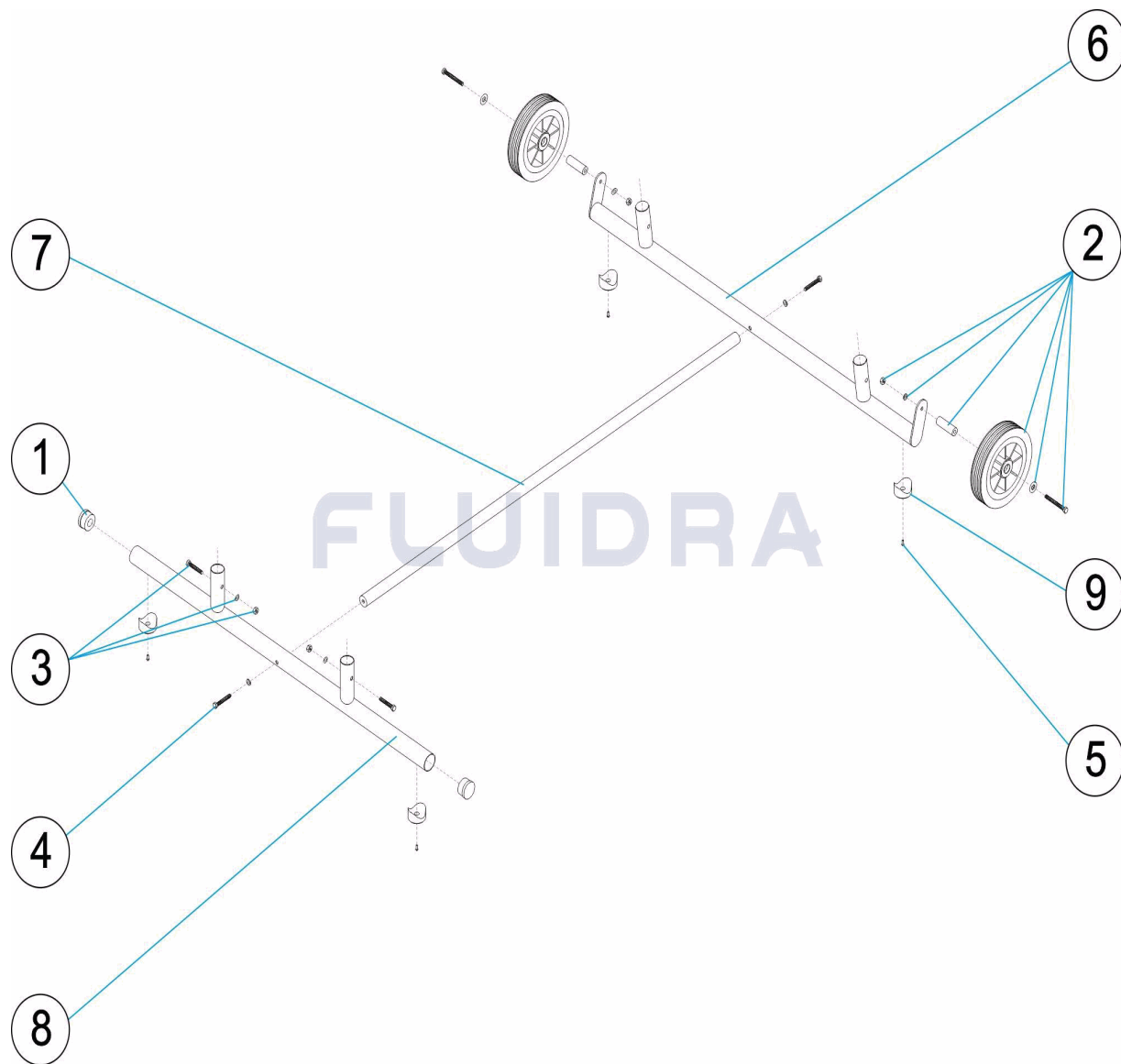

FRANCAIS

POS	CODE	DESCRIPTION	QUANTITE	POS	CODE	DESCRIPTION	QUANTITE
1	4401070208	BOUCHON D.43		6	08730R0300	TUBE ARRIERE	
2	4401070209	ROUE FAUTEUIL SECOURISTE		7	08730R0100	TUBE CENTRAL	
3	4401030103	VISSERIE DE FIXATION DE LA GLISSADE		8	08730R0200	TUBE AVANT	
4	70101R08055	VISSERIE DIN-933 M8X55		9	00127R0403	ANNEAU CONCAVE	
5	07628R0005	RIVET INOX					

CODE **08730**

DESCRIPTION: **LIFEGUARD CHAIR BASE WITH WHEELS**

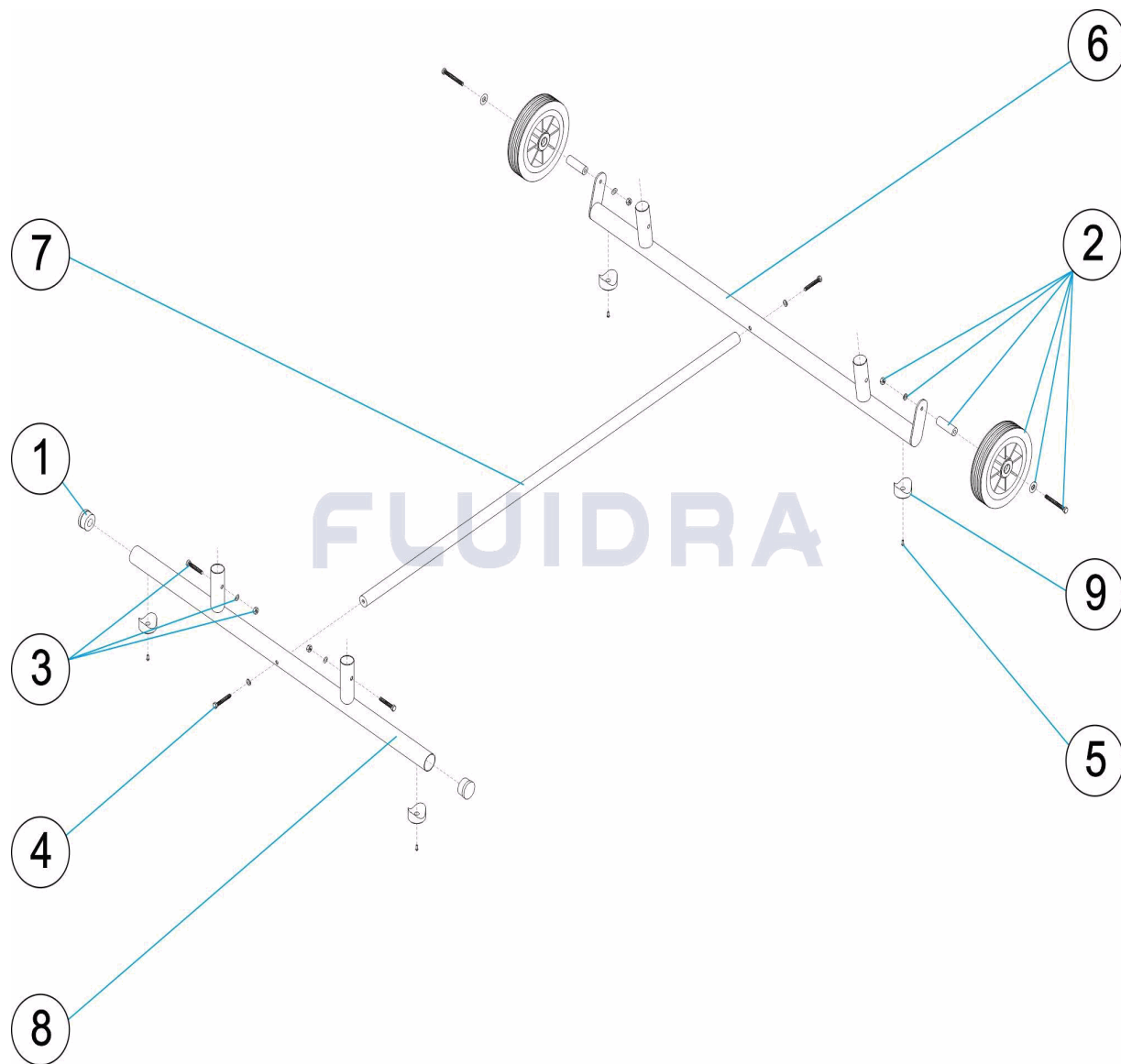

ENGLISH

POS	CODE	DESCRIPTION	QUANTITY	POS	CODE	DESCRIPTION	QUANTITY
1	4401070208	PLUG D.43		6	08730R0300	BACK TUBE	
2	4401070209	LIFEGUARD WHEEL		7	08730R0100	CENTRAL TUBE	
3	4401030103	CHUTE BOLT SET		8	08730R0200	FRONT TUBE	
4	70101R08055	DIN-933 SCREW M8X55		9	00127R0403	CONCAVE RING	
5	07628R0005	STAINLESS STEEL RIVET					

CODICE **08730**

DESCRIZIONE: **BASE CON RUOTE SEDIA BAGNINO**

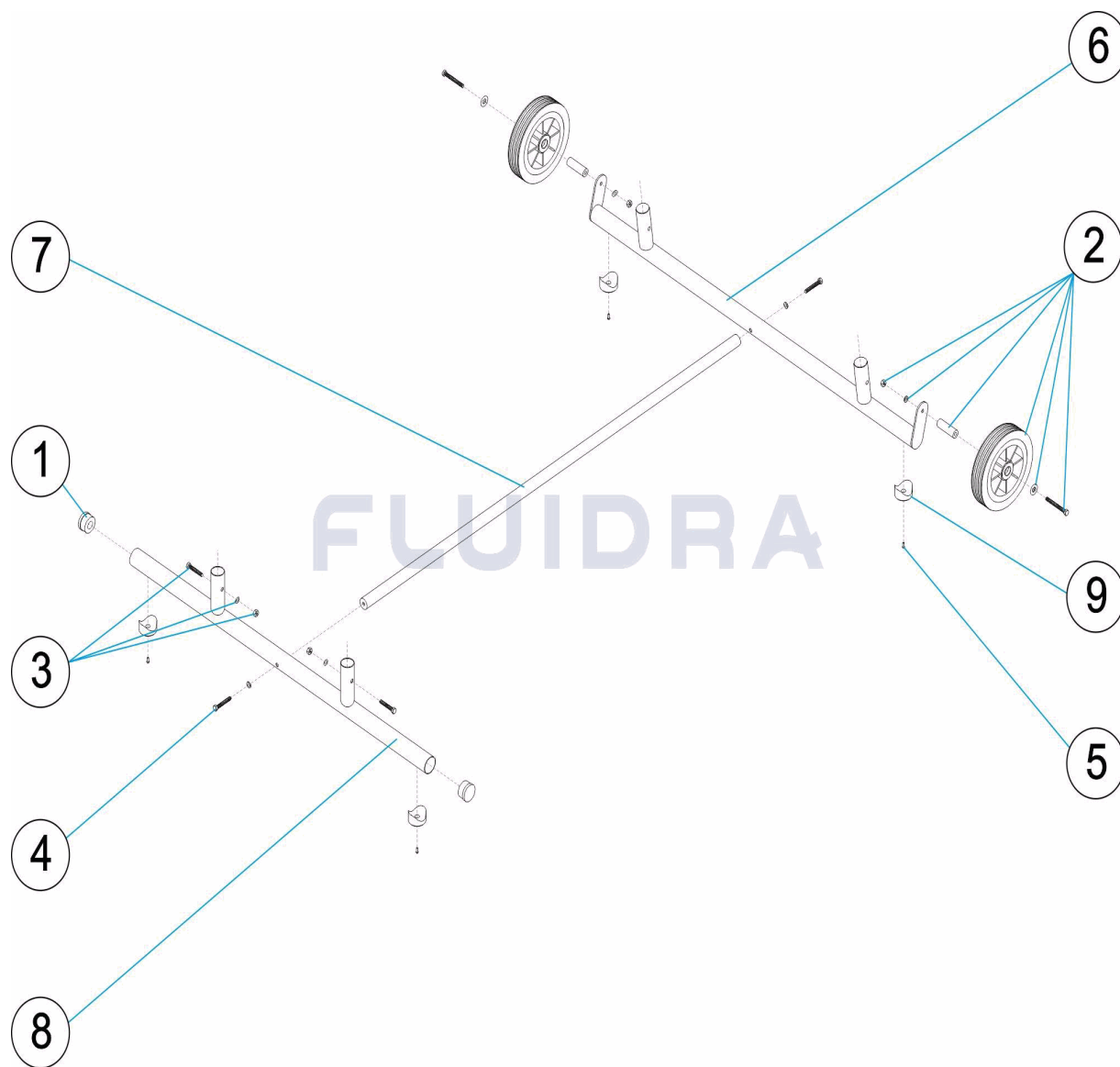

ITALIANO

POS	CODICE	DESCRIZIONE	QUANTITA'	POS	CODICE	DESCRIZIONE	QUANTITA'
1	4401070208	TAPPO D.43		6	08730R0300	TUBO POSTERIORE	
2	4401070209	RUOTA PIATTAFORMA VIGILANZA		7	08730R0100	TUBO CENTRALE	
3	4401030103	BULLONERIA PER FISSAGGIO PISTA		8	08730R0200	TUBO ANTERIORE	
4	70101R08055	VITE DIN-933 M8X55		9	00127R0403	ANELLO CONCAVO	
5	07628R0005	RIVETTO INOX					

CODE **08730**

BESCHREIBUNG: **BASIS MIT RÄNDERN RETTUNGSSCHWIMMERSITZ**

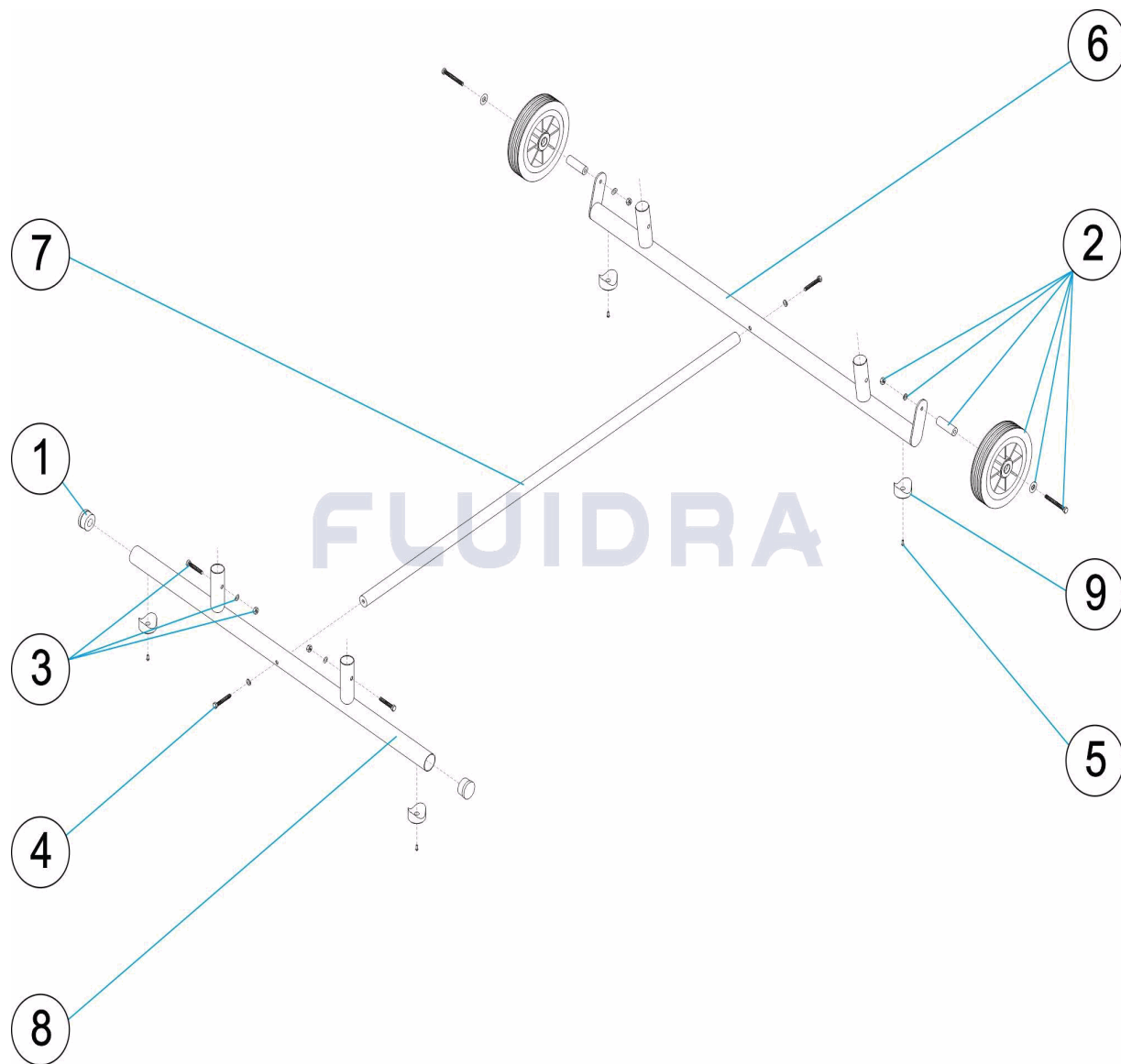

DEUTSCH

POS	CODE	BESCHREIBUNG	MENGE	POS	CODE	BESCHREIBUNG	MENGE
1	4401070208	STOPFEN D.43		6	08730R0300	ROHR HINTEN	
2	4401070209	RAD RETTUNGSSCHWIMMERSITZ		7	08730R0100	MITTLERES ROHR	
3	4401030103	FIXIERSCHRAUBEN		8	08730R0200	ROHR VORNE	
4	70101R08055	SCHRAUBE DIN-933 M8 X 55		9	00127R0403	KONKAVER RING	
5	07628R0005	NIETE EDELSTAHL					

CODIGO **08730**

DESCRIÇÃO: **BASE COM RODAS CADEIRA SOCORRISTA**

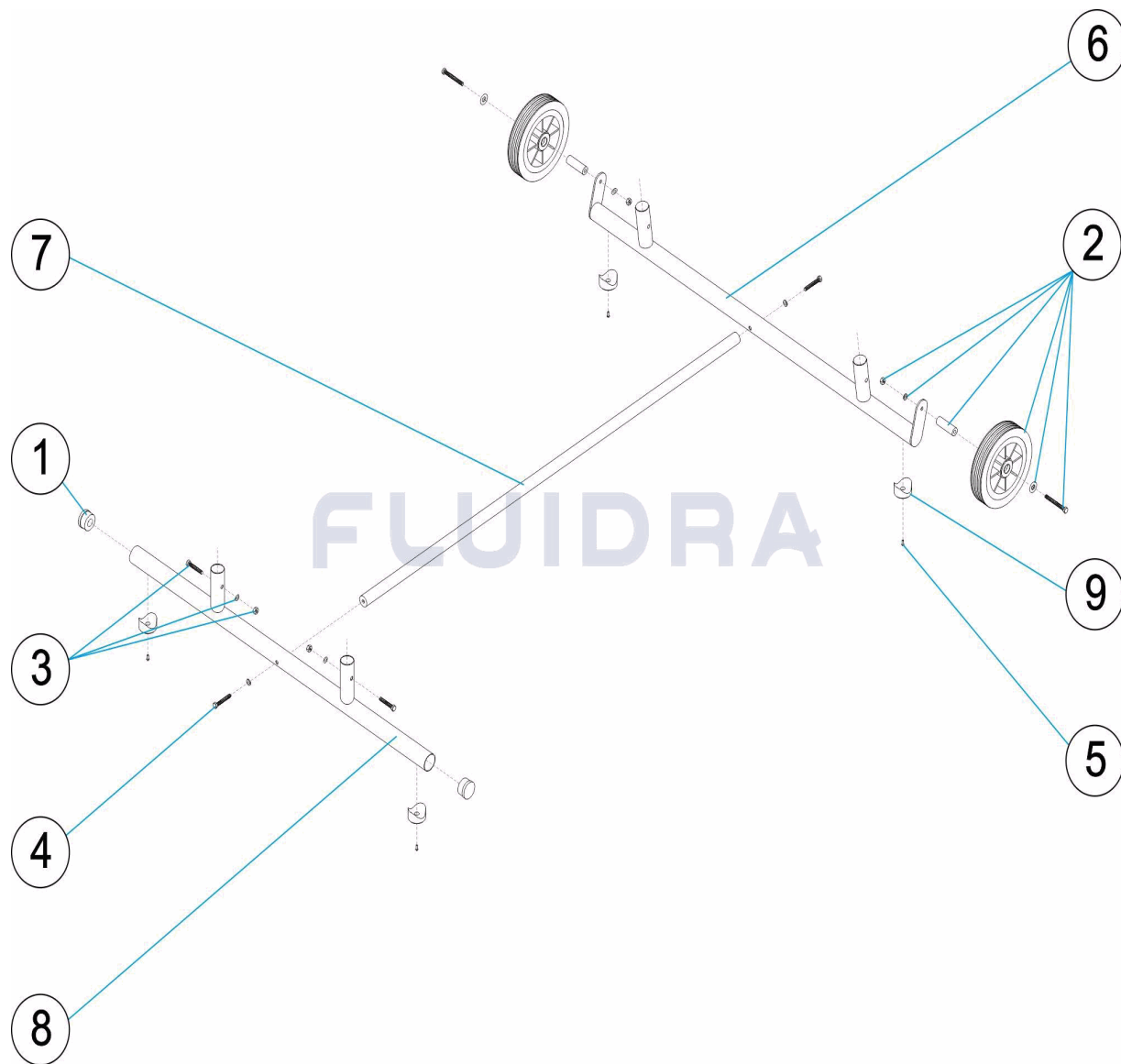

PORTUGUES

POS	CODIGO	DESCRIÇÃO	JANTIDADE	POS	CODIGO	DESCRIÇÃO	JANTIDADE
1	4401070208	TAMPÃO D.43		6	08730R0300	TUBO TRASEIRO	
2	4401070209	RODAS CADEIRA SOCORRISTA		7	08730R0100	TUBO CENTRAL	
3	4401030103	CONJ. PARAFUSOS PISTA		8	08730R0200	TUBO DIANTEIRO	
4	70101R08055	PARAFUSO DIN-933 M8 X 55		9	00127R0403	ANEL CONCAVO	
5	07628R0005	REBITE INOX					