

DESPIECE

REV.: 0

1512

FECHA: 09/07/2021

HOJA: 1/2

CODIGO M00133, M00134, M00135, M00136

DESCRIPCION: ESCALERA STANDARD PLUS 2-3-4-5 PELDAÑOS AISI-316

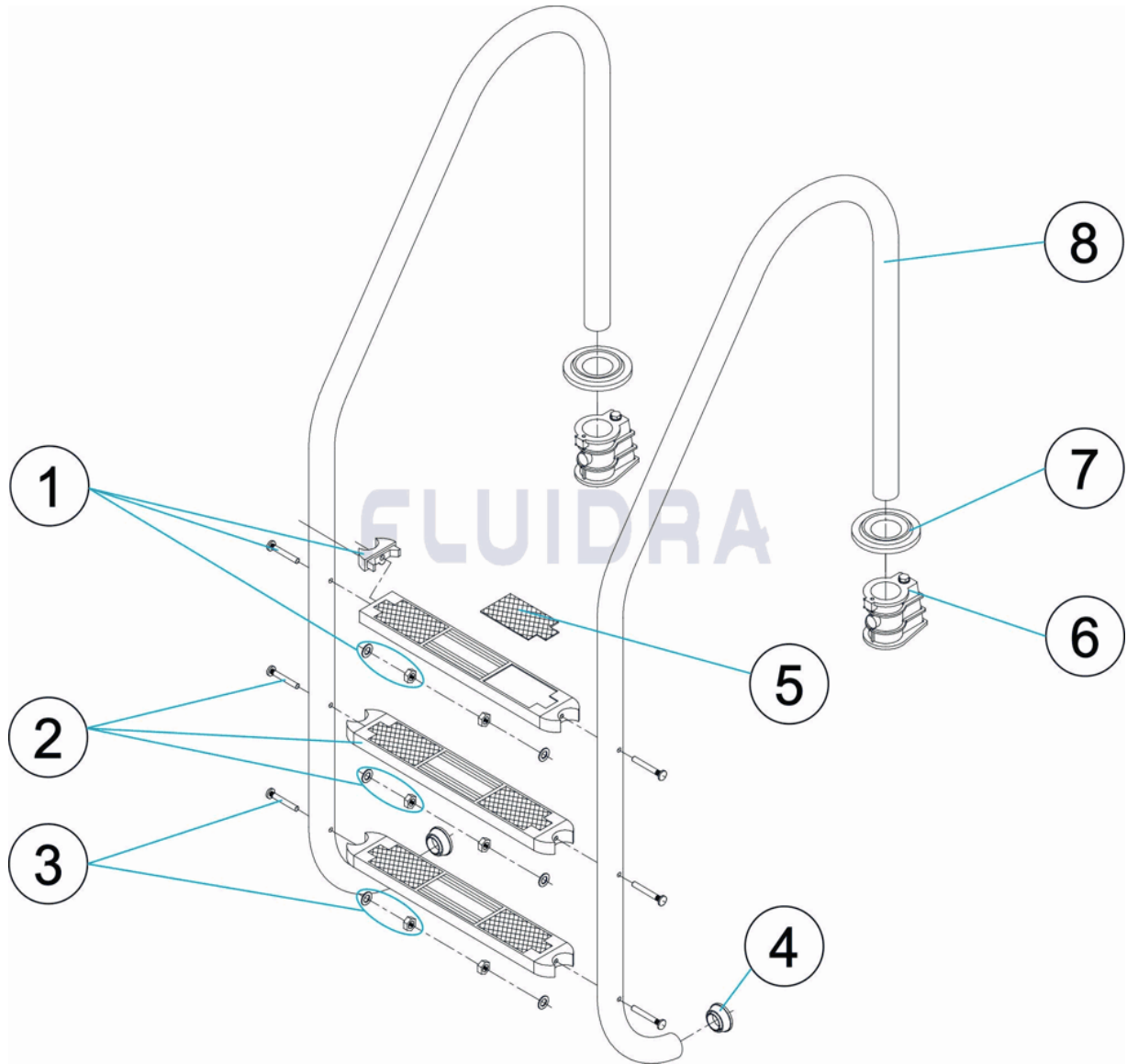

ESPAÑOL

POS	CODIGO	DESCRIPCION	CANTIDAD	POS	CODIGO	DESCRIPCION	CANTIDAD
1	4401013203	SOPORTE LATERAL PELDAÑO		7	4401010103	TAPETA EMBELLECEDORA 316	
2	4401010023	PELDAÑO LUXE		8	* 05476R0001	PASAMANO STANDARD 2 PELDAÑOS	
3	4401010111	TORNILLERIA PELDAÑO 316		8	* 05477R0001	PASAMANOS 3 PELDAÑOS AISI-316	
4	4401010112	TOPE ESCALERA		8	* 05478R0001	PASAMANOS 4 PELDAÑOS AISI-316	
5	4401010108	TAPETA PELDAÑO LUXE		8	* 05479R0001	PASAMANOS ESC. 5P. AISI 316	
6	4401010101	ANCLAJE ESCALERA					

* VER HOJA DE OBSERVACIONES

DESPIECE

REV.: 0

1512

FECHA: 09/07/2021

HOJA: 2/2

CODIGO **M00133, M00134, M00135, M00136**DESCRIPCION: **ESCALERA STANDARD PLUS 2-3-4-5 PELDAÑOS AISI-316**

OBSERVACIONES

POS	CODIGO	OBSERVACIONES
8	* 05476R0001	PARA: M00133
8	* 05477R0001	PARA: M00134
8	* 05478R0001	PARA: M00135
8	* 05479R0001	PARA: M00136

CODE **M00133, M00134, M00135, M00136**

DESCRIPTION: **ÉCHELLE STANDARD PLUS 2-3-4-5 MARCHES AISI-316**

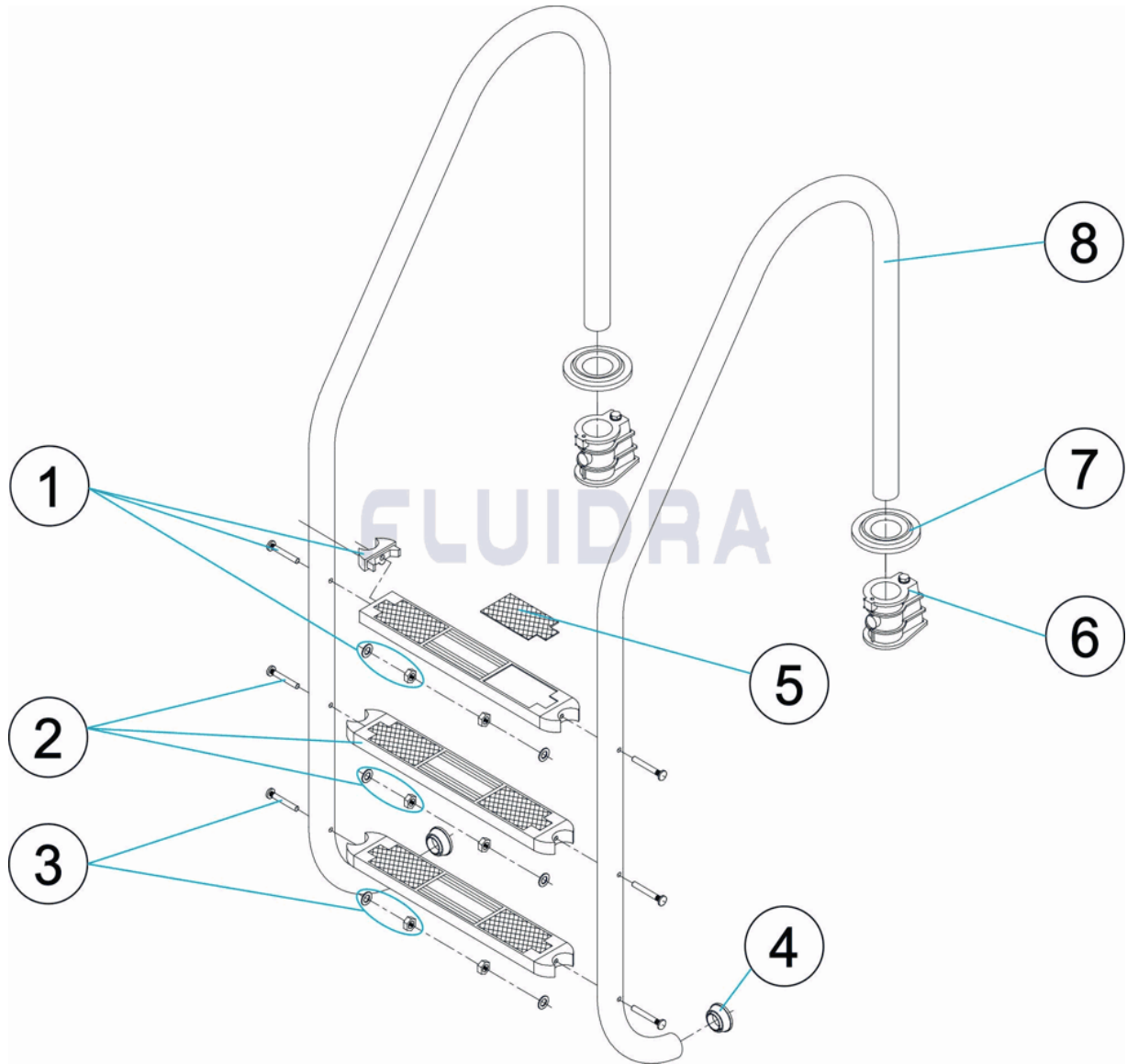

FRANCAIS

POS	CODE	DESCRIPTION	QUANTITE	POS	CODE	DESCRIPTION	QUANTITE
1	4401013203	SUPPORT LATÉRAL DE MARCHE		7	4401010103	ENJOLIVEUR AISI 316	
2	4401010023	MARCHE LUXE		8	* 05476R0001	MAIN COURANTE ECHELLE 2 MARCHES AI:	
3	4401010111	VISSERIE MARCHE AISI 316		8	* 05477R0001	MAIN COURANTE ECHELLE 3 MARCHES AI:	
4	4401010112	TAMPON D'ÉCHELLE		8	* 05478R0001	MAIN COURANTE ECHELLE 4 MARCHES AI:	
5	4401010108	PLAQUE NOIRE POUR MARCHE LUXE		8	* 05479R0001	MAIN COURANTE ECHELLE 5 MARCHES AI:	
6	4401010101	ANCORAGE D'ÉCHELLE					

ÉCLATÉ

REV.: 0
DATE: 09/07/2021
PAG.: 2/2

1512

CODE **M00133, M00134, M00135, M00136**

DESCRIPTION: **ÉCHELLE STANDARD PLUS 2-3-4-5 MARCHES AISI-316**

OBSERVATIONS

POS	CODE	OBSERVATIONS
8	* 05476R0001	POUR: M00133
8	* 05477R0001	POUR: M00134
8	* 05478R0001	POUR: M00135
8	* 05479R0001	POUR: M00136

PARTS BREAKDOWN

REV.: 0

1512

DATE: 09/07/2021

SHEET: 1/2

CODE M00133, M00134, M00135, M00136

DESCRIPTION: STANDARD PLUS LADDER 2-3-4-5 STEPS AISI-316

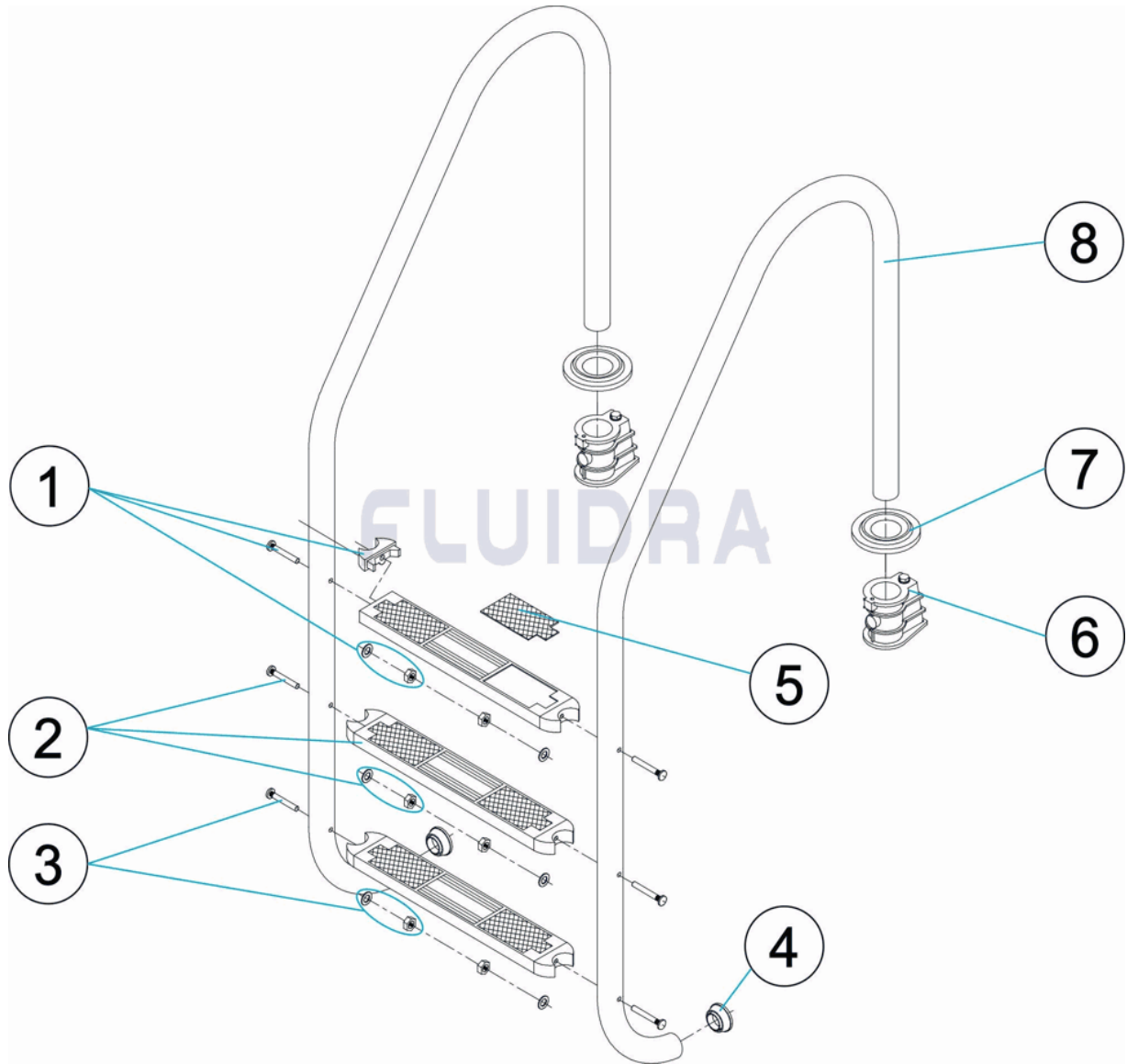

ENGLISH

POS	CODE	DESCRIPTION	QUANTITY	POS	CODE	DESCRIPTION	QUANTITY
1	4401013203	STEP END CAP		7	4401010103	ESCUTCHEON 316	
2	4401010023	DELUXE TREAD		8	* 05476R0001	STANDARD HANDRAIL 2 STEPS	
3	4401010111	TREAD BOLT SET 316		8	* 05477R0001	HANDRAIL 3 STEPS AISI-316	
4	4401010112	LADDER END CAP		8	* 05478R0001	HANDRAIL 4 STEPS AISI-316	
5	4401010108	DELUXE TREAD END INSERT		8	* 05479R0001	HANDRAIL LADDER 5 STEPS AISI 316	
6	4401010101	LADDER ANCHOR					

* SEE OBSERVATIONS SHEET

PARTS BREAKDOWN

REV.: 0

1512

DATE: 09/07/2021

SHEET: 2/2

CODE **M00133, M00134, M00135, M00136**

DESCRIPTION: **STANDARD PLUS LADDER 2-3-4-5 STEPS AISI-316**

OBSERVATIONS

POS	CODE	OBSERVATIONS
8	* 05476R0001	FOR: M00133
8	* 05477R0001	FOR: M00134
8	* 05478R0001	FOR: M00135
8	* 05479R0001	FOR: M00136

CODICE **M00133, M00134, M00135, M00136**

DESCRIZIONE: **SCALA STANDARD PLUS 2-3-4-5 SCALINI AISI-316**

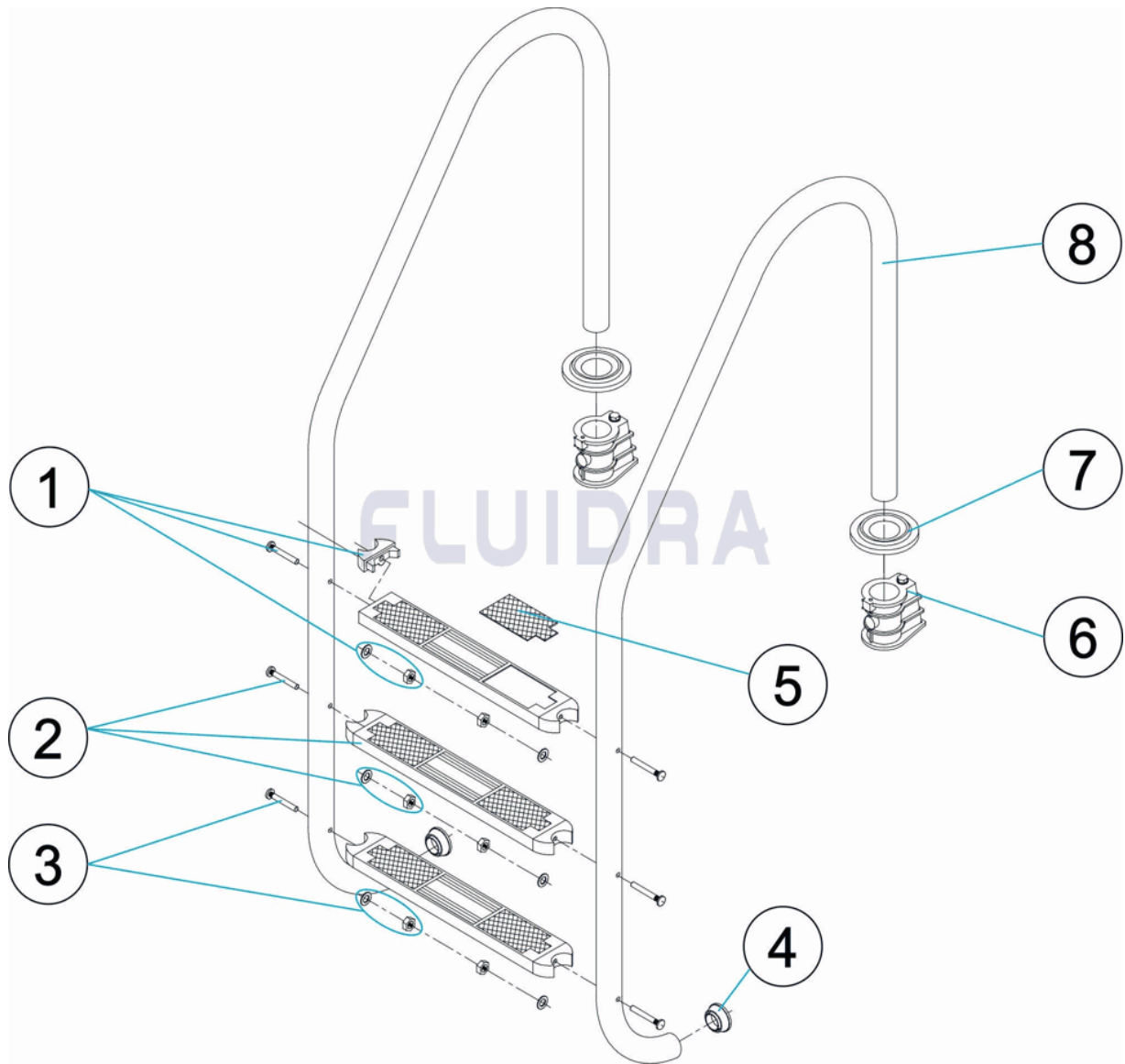

ITALIANO

POS	CODICE	DESCRIZIONE	QUANTITA'	POS	CODICE	DESCRIZIONE	QUANTITA'
1	4401013203	SOSTEGNO LATERALE GRADINO		7	4401010103	COPRIFLANGIA ANCORAGGIO AISI 316	
2	4401010023	GRADINO LUXE		8	* 05476R0001	CORRIMANO STANDARD 2 GRADINI	
3	4401010111	BULLONERIA GRADINO AISI 316		8	* 05477R0001	CORRIMANO 3 GRADINI AISI-316	
4	4401010112	TAPPO SCALA		8	* 05478R0001	CORRIMANO 4 GRADINI AISI-316	
5	4401010108	TAPPETINO FINITURA GRADINO LUXE		8	* 05479R0001	CORRIMANO SCALA 5 GRADINI AISI 316	
6	4401010101	ANCORAGGIO SCALA					

ESPLOSO

REV.: 0

1512

DATA: 09/07/2021

PAG.: 2/2

CODICE **M00133, M00134, M00135, M00136**DESCRIZIONE: **SCALA STANDARD PLUS 2-3-4-5 SCALINI AISI-316**

OSSERVAZIONI

POS	CODICE	OSSERVAZIONI
8	* 05476R0001	PER: M00133
8	* 05477R0001	PER: M00134
8	* 05478R0001	PER: M00135
8	* 05479R0001	PER: M00136

EINZELTEILE

ÜBER.: 0

1512

DATUM: 09/07/2021

BLATT: 1/2

CODE M00133, M00134, M00135, M00136

BESCHREIBUNG: TREPPE STANDARD PLUS 2-3-4-5 STUFEN AISI-316

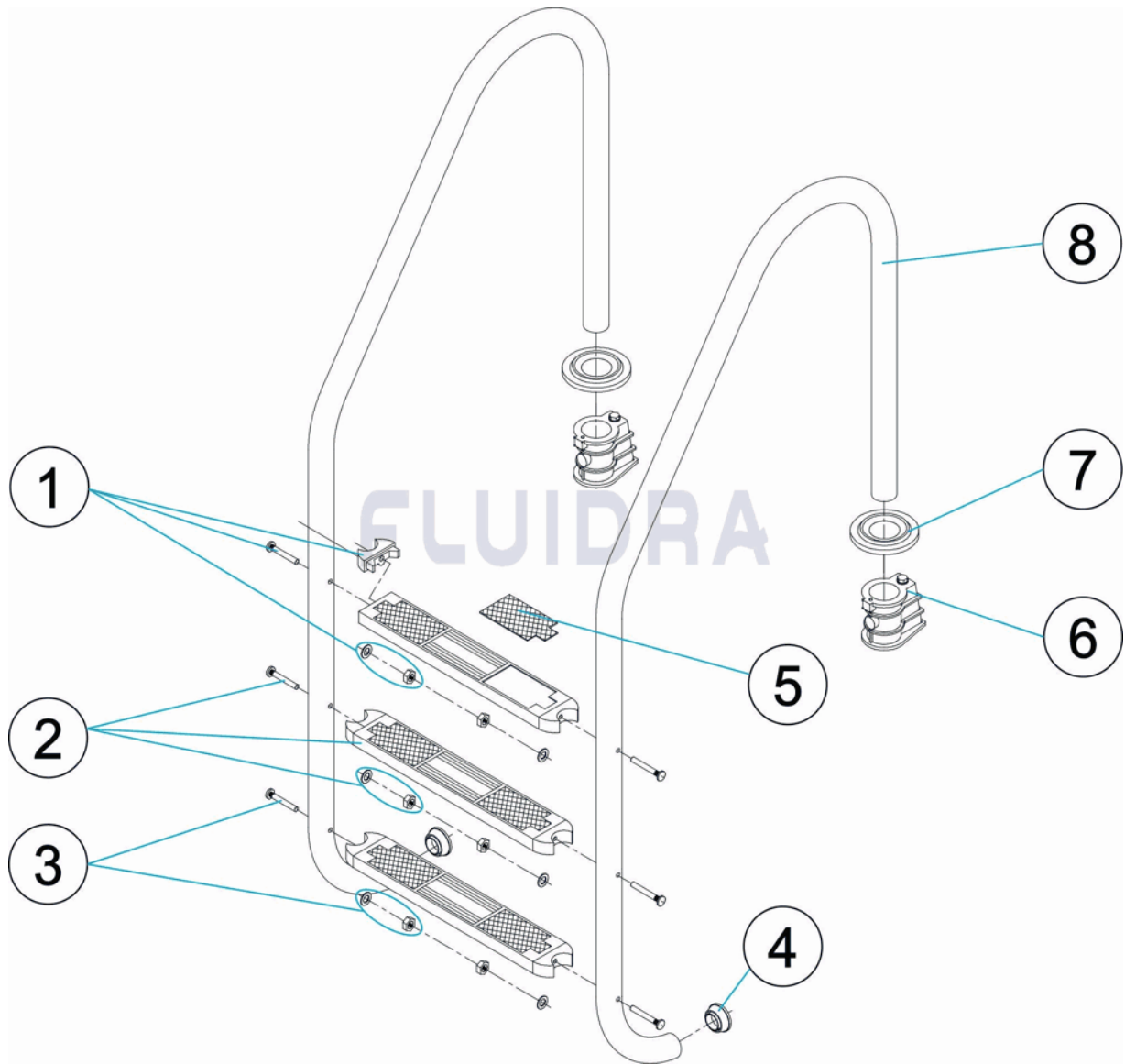

DEUTSCH

POS	CODE	BESCHREIBUNG	MENGE	POS	CODE	BESCHREIBUNG	MENGE
1	4401013203	SEITENHALTERUNG STUFE		7	4401010103	DEKO-ABSCHLUSSRING 316	
2	4401010023	STUFE LUXE		8	* 05476R0001	HANDLAUF STANDARD 2 STUFEN	
3	4401010111	SCHRAUBENSATZ STUFE 316		8	* 05477R0001	HANDLAUF 3 STUFEN AISI - 316	
4	4401010112	ABSCHLUSS TREPPE		8	* 05478R0001	HANDLAUF 4 STUFEN AISI - 316	
5	4401010108	ABSCHLUSSPLATTE STUFE LUXE		8	* 05479R0001	HANDLAUF TREPPE 5 STUFEN AISI 316	
6	4401010101	EINBAUHÜLSE					

* SIEHE ANMERKUNGSBLATT

EINZELTEILE

ÜBER.: 0

1512

DATUM: 09/07/2021

BLATT: 2/2

CODE **M00133, M00134, M00135, M00136**BESCHREIBUNG: **TREPPE STANDARD PLUS 2-3-4-5 STUFEN AISI-316**

HINWEISE

POS	CODE	HINWEISE
8	* 05476R0001	FÜR: M00133
8	* 05477R0001	FÜR: M00134
8	* 05478R0001	FÜR: M00135
8	* 05479R0001	FÜR: M00136

CODIGO M00133, M00134, M00135, M00136

DESCRICAÇÃO: ESCADA STANDARD PLUS 2-3-4-5 DEGRAUS AISI-316

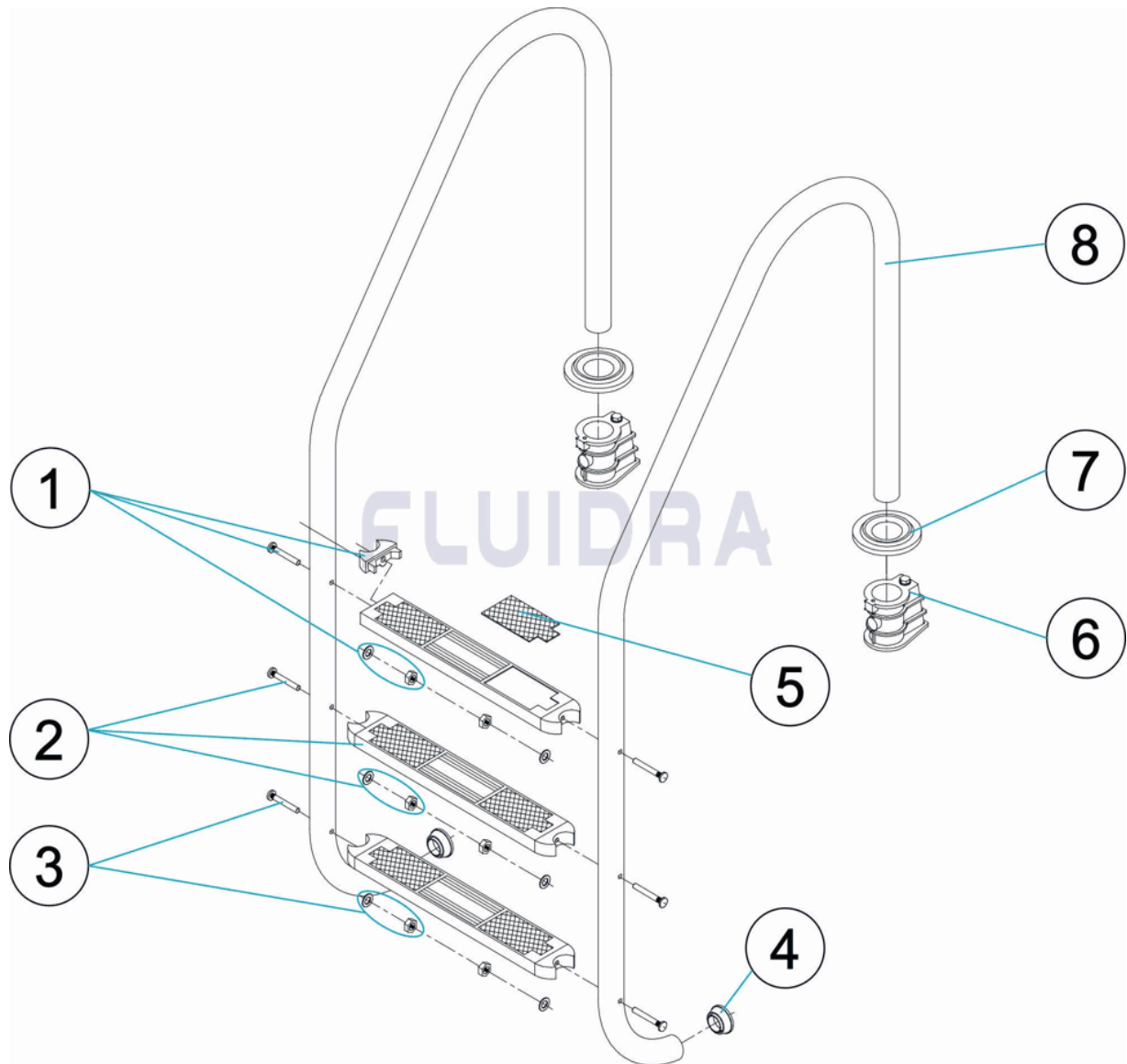

PORTUGUES

POS	CODIGO	DESCRICAÇÃO	JANTIDADE	POS	CODIGO	DESCRICAÇÃO	JANTIDADE
1	4401013203	SUPORTE LATERAL DEGRAU		7	4401010103	ESPELHO 316	
2	4401010023	DEGRAU LUXE		8	* 05476R0001	CORRIMÃO STANDARD 2 DEGRAUS	
3	4401010111	PARAFUSOS DEGRAU 316		8	* 05477R0001	CORRIMÃO 3 DEGRAUS AISI-316	
4	4401010112	BATENTE ESCADA		8	* 05478R0001	CORRIMÃO 4 DEGRAUS AISI-316	
5	4401010108	ANTI DERRAPANTE DEGRAU LUXE		8	* 05479R0001	CORRIMÃO ESC. 5 D. AISI 316	
6	4401010101	ÂNCORA					

ITEM

REV.: 0

1512

DATA: 09/07/2021

FOLHA: 2/2

CODIGO **M00133, M00134, M00135, M00136**DESCRICAÇÃO: **ESCADA STANDARD PLUS 2-3-4-5 DEGRAUS AISI-316**

OBSERVACÕES

POS	CODIGO	OBSERVACÕES
8	* 05476R0001	PARA: M00133
8	* 05477R0001	PARA: M00134
8	* 05478R0001	PARA: M00135
8	* 05479R0001	PARA: M00136