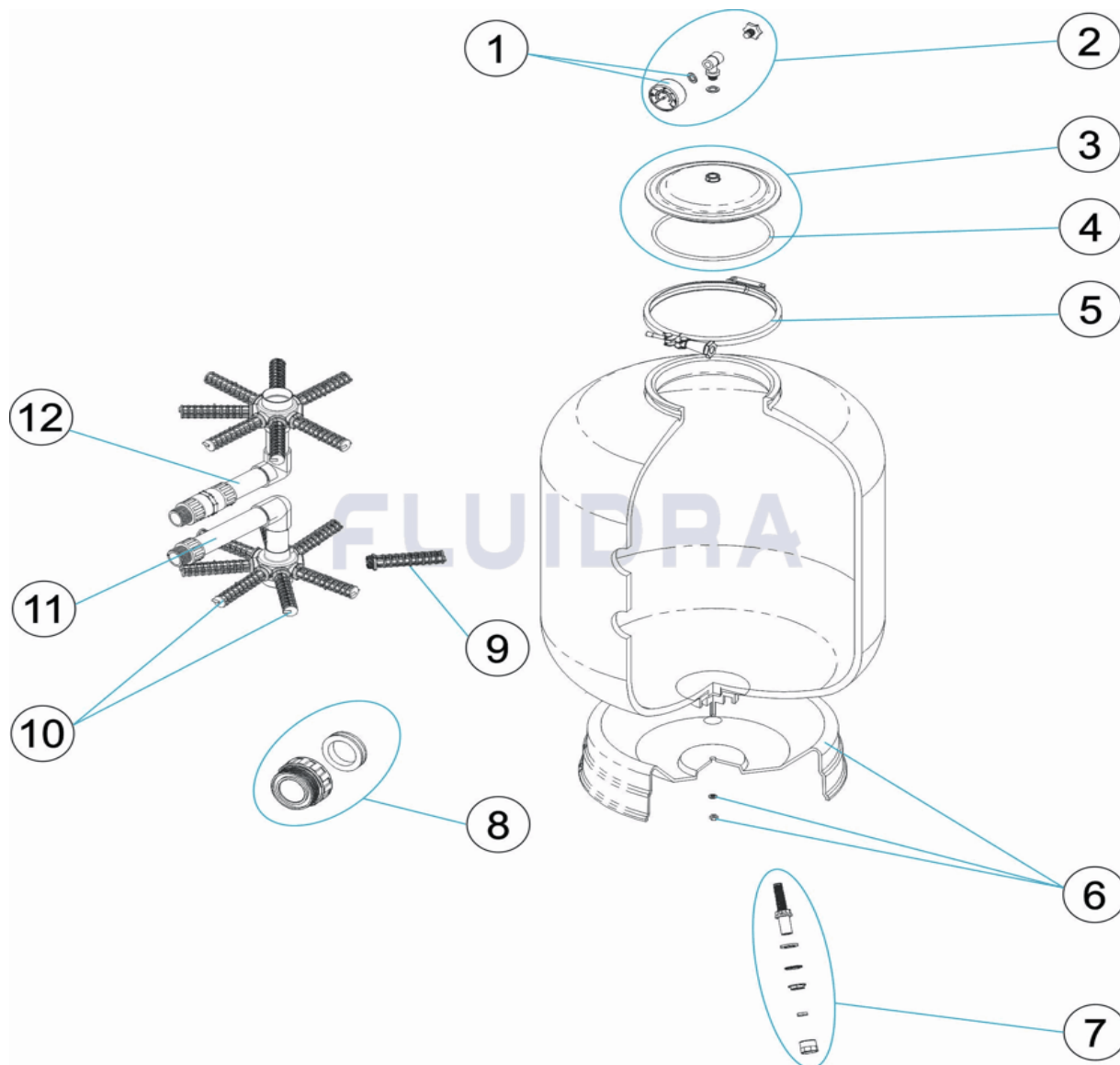

CODIGO **BWS400FX30, BWS500FX30, BWS600FX30**

 DESCRIPCION: **FILTRO HAWAII OC-1 D.400-600**

**ESPAÑOL**

| POS | CODIGO       | DESCRIPCION                          | CANTIDAD | POS | CODIGO       | DESCRIPCION                          | CANTIDAD |
|-----|--------------|--------------------------------------|----------|-----|--------------|--------------------------------------|----------|
| 1   | CE04180405   | MANOMETRO 1/8" 3 KG/C "              |          | 9   | * CE04040056 | BRAZO COLECTOR 1" 175 M " ABS BLANCC |          |
| 2   | CE04180404   | MANOMETRO COMPLETO                   |          | 9   | * CE04040055 | BRAZO COLECTOR 1" 225 M " ABS BLANCC |          |
| 3   | CE04080102   | TAPA TRANSPARENTE + ANILLO           |          | 10  | * CE04040133 | CJTO. BRAZOS COLECTOR D. 400         |          |
| 4   | CE04080101   | JUNTA TORICA TAPA                    |          | 10  | * CE04040063 | CJTO. BRAZOS COLECTOR D. 500         |          |
| 5   | CE04080103   | ANILLO CIERRE 203 NEGRO              |          | 10  | * CE04040064 | CJTO. BRAZOS COLECTOR D. 650         |          |
| 6   | * CE04010400 | PIE FILTRO D. 400                    |          | 11  | * CE04040187 | CJTO. COLECTOR 400                   |          |
| 6   | * CE04010256 | PIE FILTRO D. 500                    |          | 11  | * CE04040188 | CJTO. COLECTOR 500                   |          |
| 6   | * CE04010023 | PIE FILTRO D. 650                    |          | 11  | * CE04040189 | CJTO. COLECTOR 600                   |          |
| 7   | CE04070105   | CREPINA PURGA 3/8'                   |          | 12  | * CE04040190 | CJTO. DIFUSOR D. 400                 |          |
| 8   | CE04020103   | RACORD 1 1/2' + JUNTA CONCAVA        |          | 12  | * CE04040191 | CJTO. DIFUSOR D. 500                 |          |
| 9   | * CE04040057 | BRAZO COLECTOR 1" 110 M " ABS BLANCC |          | 12  | * CE04040192 | CJTO. DIFUSOR D. 600                 |          |

**CODIGO BWS400FX30, BWS500FX30, BWS600FX30**

**DESCRIPCION: FILTRO HAWAII OC-1 D.400-600**

## OBSERVACIONES

| POS | CODIGO       | OBSERVACIONES    |
|-----|--------------|------------------|
| 6   | * CE04010400 | PARA: BWS400FX30 |
| 6   | * CE04010256 | PARA: BWS500FX30 |
| 6   | * CE04010023 | PARA: BWS600FX30 |
| 9   | * CE04040057 | PARA: BWS400FX30 |
| 9   | * CE04040056 | PARA: BWS500FX30 |
| 9   | * CE04040055 | PARA: BWS600FX30 |
| 10  | * CE04040133 | PARA: BWS400FX30 |
| 10  | * CE04040063 | PARA: BWS500FX30 |
| 10  | * CE04040064 | PARA: BWS600FX30 |
| 11  | * CE04040187 | PARA: BWS400FX30 |
| 11  | * CE04040188 | PARA: BWS500FX30 |
| 11  | * CE04040189 | PARA: BWS600FX30 |
| 12  | * CE04040190 | PARA: BWS400FX30 |
| 12  | * CE04040191 | PARA: BWS500FX30 |
| 12  | * CE04040192 | PARA: BWS600FX30 |

CODE **BWS400FX30, BWS500FX30, BWS600FX30**

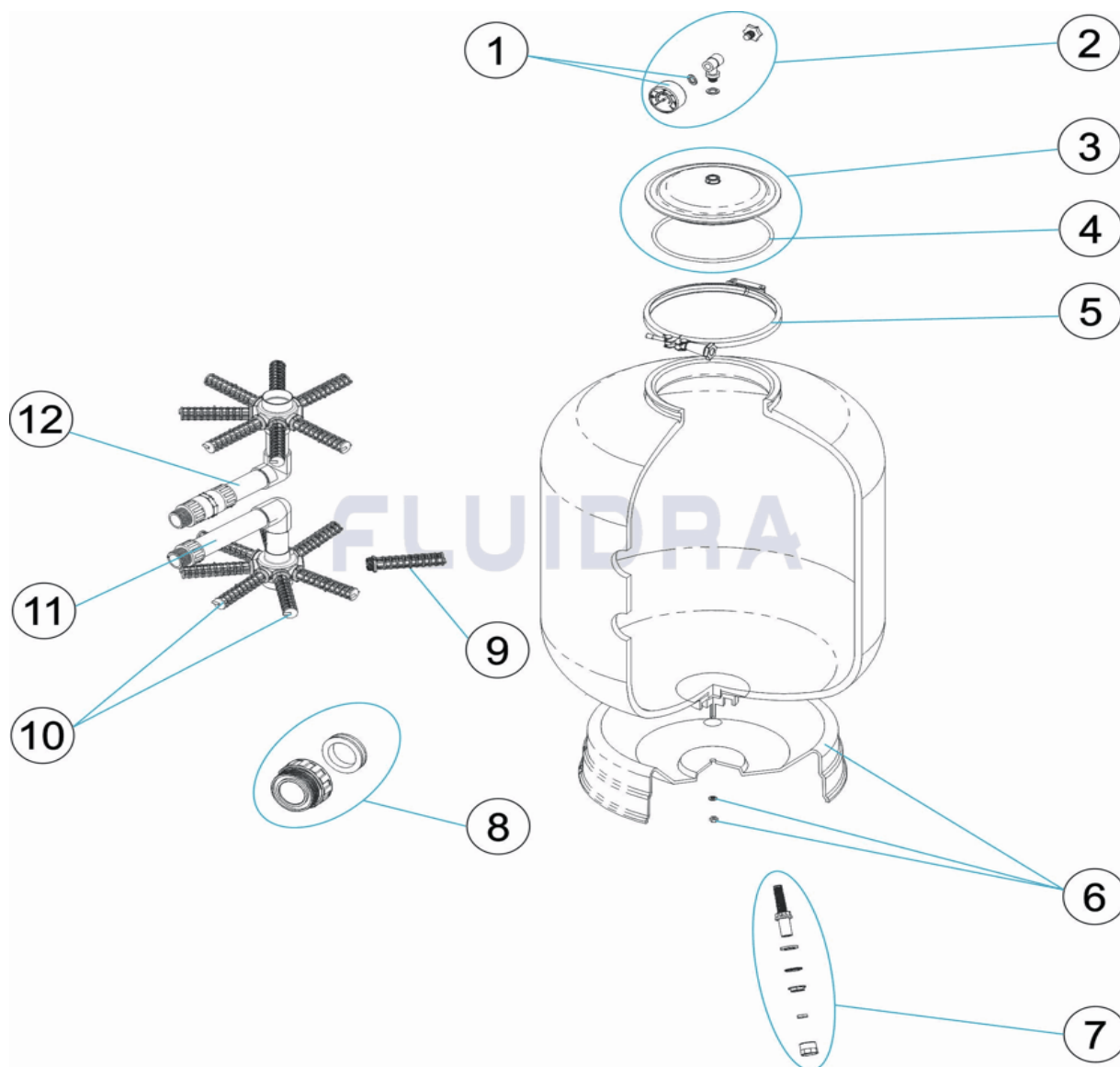
 DESCRIPTION: **FILTRES HAWAII OC-1 D.400-600**

**FRANCAIS**

| POS | CODE         | DESCRIPTION                           | QUANTITE | POS | CODE         | DESCRIPTION                           | QUANTITE |
|-----|--------------|---------------------------------------|----------|-----|--------------|---------------------------------------|----------|
| 1   | CE04180405   | MANOMETRE 1/8" 3 KG./C "              |          | 9   | * CE04040056 | BRAS DE REPARTITEUR 1" 175 M " ABS BL |          |
| 2   | CE04180404   | MANOMETRE COMPLET                     |          | 9   | * CE04040055 | BRAS DE REPARTITEUR 1" 225 M " ABS BL |          |
| 3   | CE04080102   | COUVERCLE TRANSPARENT + JOINT         |          | 10  | * CE04040133 | ENSEMBLE BRAS DE REPARTITEUR D. 400   |          |
| 4   | CE04080101   | JOINT TORIQUE COUVERCLE               |          | 10  | * CE04040063 | ENSEMBLE BRAS DE REPARTITEUR D. 500   |          |
| 5   | CE04080103   | COLLIER DE FERMETURE 203 NOIR         |          | 10  | * CE04040064 | ENSEMBLE BRAS DE REPARTITEUR D. 650   |          |
| 6   | * CE04010400 | SOCLE FILTRE D. 400                   |          | 11  | * CE04040187 | ENSEMBLE COLLECTEUR 400               |          |
| 6   | * CE04010256 | SOCLE FILTRE D. 500                   |          | 11  | * CE04040188 | ENSEMBLE COLLECTEUR 500               |          |
| 6   | * CE04010023 | SOCLE FILTRE D 650                    |          | 11  | * CE04040189 | ENSEMBLE COLLECTEUR 600               |          |
| 7   | CE04070105   | CREPINE DE PURGE 3/8'                 |          | 12  | * CE04040190 | ENSEMBLE DIFFUSEUR D. 400             |          |
| 8   | CE04020103   | RACCORD 1 1/2' + JOINT CONCAVE        |          | 12  | * CE04040191 | ENSEMBLE DIFFUSEUR D. 500             |          |
| 9   | * CE04040057 | BRAS DE REPARTITEUR 1" 110 M " ABS BL |          | 12  | * CE04040192 | ENSEMBLE DIFFUSEUR D. 600             |          |

CODE **BWS400FX30, BWS500FX30, BWS600FX30**DESCRIPTION: **FILTRES HAWAII OC-1 D.400-600**

## OBSERVATIONS

| POS | CODE         | OBSERVATIONS     |
|-----|--------------|------------------|
| 6   | * CE04010400 | POUR: BWS400FX30 |
| 6   | * CE04010256 | POUR: BWS500FX30 |
| 6   | * CE04010023 | POUR: BWS600FX30 |
| 9   | * CE04040057 | POUR: BWS400FX30 |
| 9   | * CE04040056 | POUR: BWS500FX30 |
| 9   | * CE04040055 | POUR: BWS600FX30 |
| 10  | * CE04040133 | POUR: BWS400FX30 |
| 10  | * CE04040063 | POUR: BWS500FX30 |
| 10  | * CE04040064 | POUR: BWS600FX30 |
| 11  | * CE04040187 | POUR: BWS400FX30 |
| 11  | * CE04040188 | POUR: BWS500FX30 |
| 11  | * CE04040189 | POUR: BWS600FX30 |
| 12  | * CE04040190 | POUR: BWS400FX30 |
| 12  | * CE04040191 | POUR: BWS500FX30 |
| 12  | * CE04040192 | POUR: BWS600FX30 |

CODE **BWS400FX30, BWS500FX30, BWS600FX30**

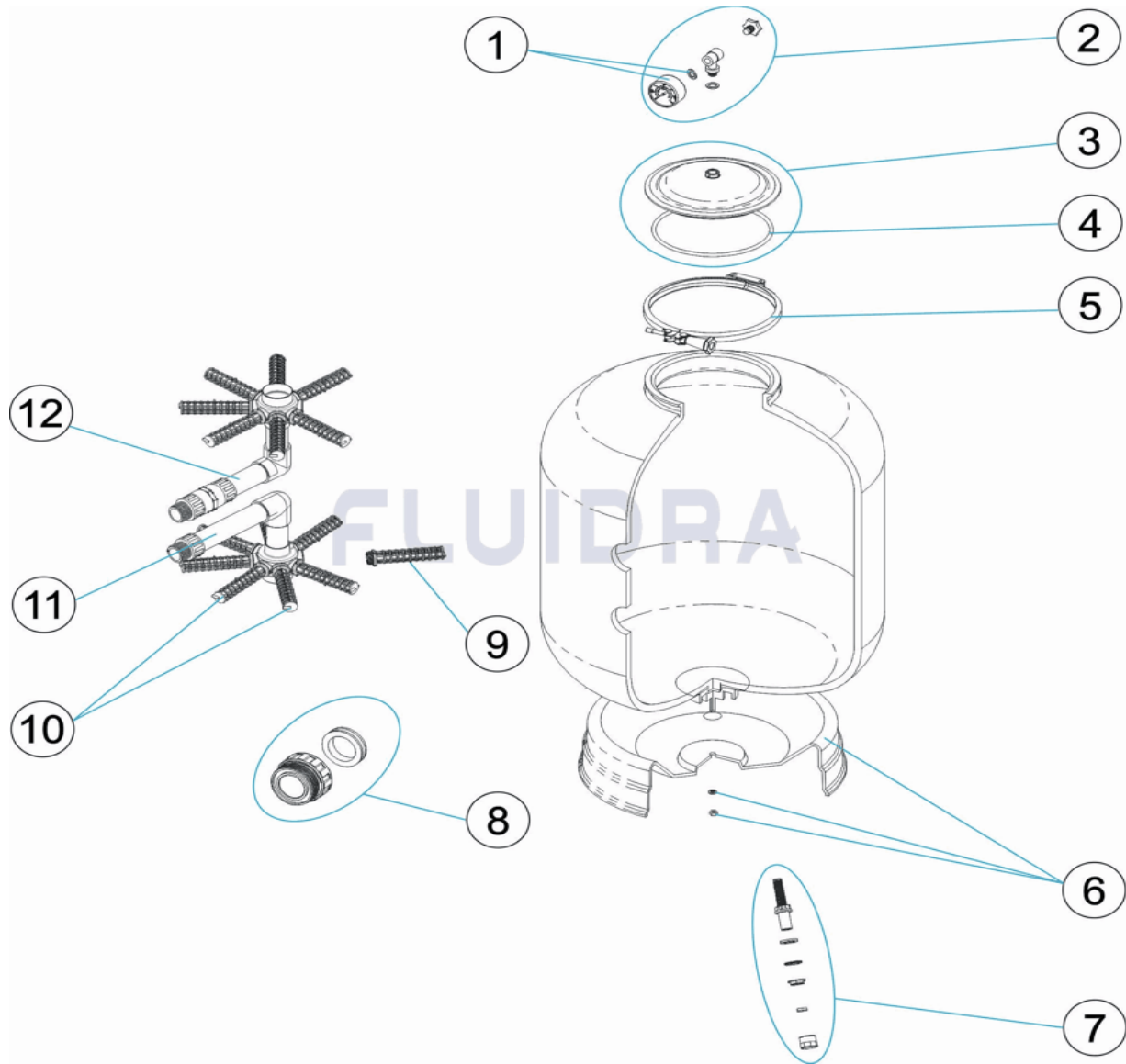
 DESCRIPTION: **HAWAII FILTERS OC-1 D.400-600**

**ENGLISH**

| POS | CODE         | DESCRIPTION                       | QUANTITY | POS | CODE         | DESCRIPTION                       | QUANTITY |
|-----|--------------|-----------------------------------|----------|-----|--------------|-----------------------------------|----------|
| 1   | CE04180405   | PRESSURE GAUGE 1/8" 3 KG./C "     |          | 9   | * CE04040056 | MANIFOLD ARM 1" 175 M " ABS WHITE |          |
| 2   | CE04180404   | COMPLETE PRESSURE GAUGE UNIT      |          | 9   | * CE04040055 | MANIFOLD ARM 1" 225 M " ABS WHITE |          |
| 3   | CE04080102   | TRANSPARENT LID + GASKET          |          | 10  | * CE04040133 | MANIFOLD ARM ASSEMBLY D. 400      |          |
| 4   | CE04080101   | LID 'O' RING                      |          | 10  | * CE04040063 | MANIFOLD ARM ASSEMBLY D. 500      |          |
| 5   | CE04080103   | BLACK LOCKING FIXTURE 203         |          | 10  | * CE04040064 | MANIFOLD ARM ASSEMBLY D. 650      |          |
| 6   | * CE04010400 | FILTER BASE D. 400                |          | 11  | * CE04040187 | MANIFOLD ASSEMBLY 400             |          |
| 6   | * CE04010256 | FILTER BASE D. 500                |          | 11  | * CE04040188 | MANIFOLD ASSEMBLY 500             |          |
| 6   | * CE04010023 | FILTER BASE D. 650                |          | 11  | * CE04040189 | MANIFOLD ASSEMBLY 600             |          |
| 7   | CE04070105   | DRAINAGE STRAINER NOZZLE 3/8'     |          | 12  | * CE04040190 | DIFFUSER ASSEMBLY D. 400          |          |
| 8   | CE04020103   | 1 1/2' FITTING + CONCAVE GASKET   |          | 12  | * CE04040191 | DIFFUSER ASSEMBLY D. 500          |          |
| 9   | * CE04040057 | MANIFOLD ARM 1" 110 M " ABS WHITE |          | 12  | * CE04040192 | DIFFUSER ASSEMBLY D. 600          |          |

CODE **BWS400FX30, BWS500FX30, BWS600FX30**DESCRIPTION: **HAWAII FILTERS OC-1 D.400-600**

## OBSERVATIONS

| POS | CODE         | OBSERVATIONS    |
|-----|--------------|-----------------|
| 6   | * CE04010400 | FOR: BWS400FX30 |
| 6   | * CE04010256 | FOR: BWS500FX30 |
| 6   | * CE04010023 | FOR: BWS600FX30 |
| 9   | * CE04040057 | FOR: BWS400FX30 |
| 9   | * CE04040056 | FOR: BWS500FX30 |
| 9   | * CE04040055 | FOR: BWS600FX30 |
| 10  | * CE04040133 | FOR: BWS400FX30 |
| 10  | * CE04040063 | FOR: BWS500FX30 |
| 10  | * CE04040064 | FOR: BWS600FX30 |
| 11  | * CE04040187 | FOR: BWS400FX30 |
| 11  | * CE04040188 | FOR: BWS500FX30 |
| 11  | * CE04040189 | FOR: BWS600FX30 |
| 12  | * CE04040190 | FOR: BWS400FX30 |
| 12  | * CE04040191 | FOR: BWS500FX30 |
| 12  | * CE04040192 | FOR: BWS600FX30 |

CODICE **BWS400FX30, BWS500FX30, BWS600FX30**

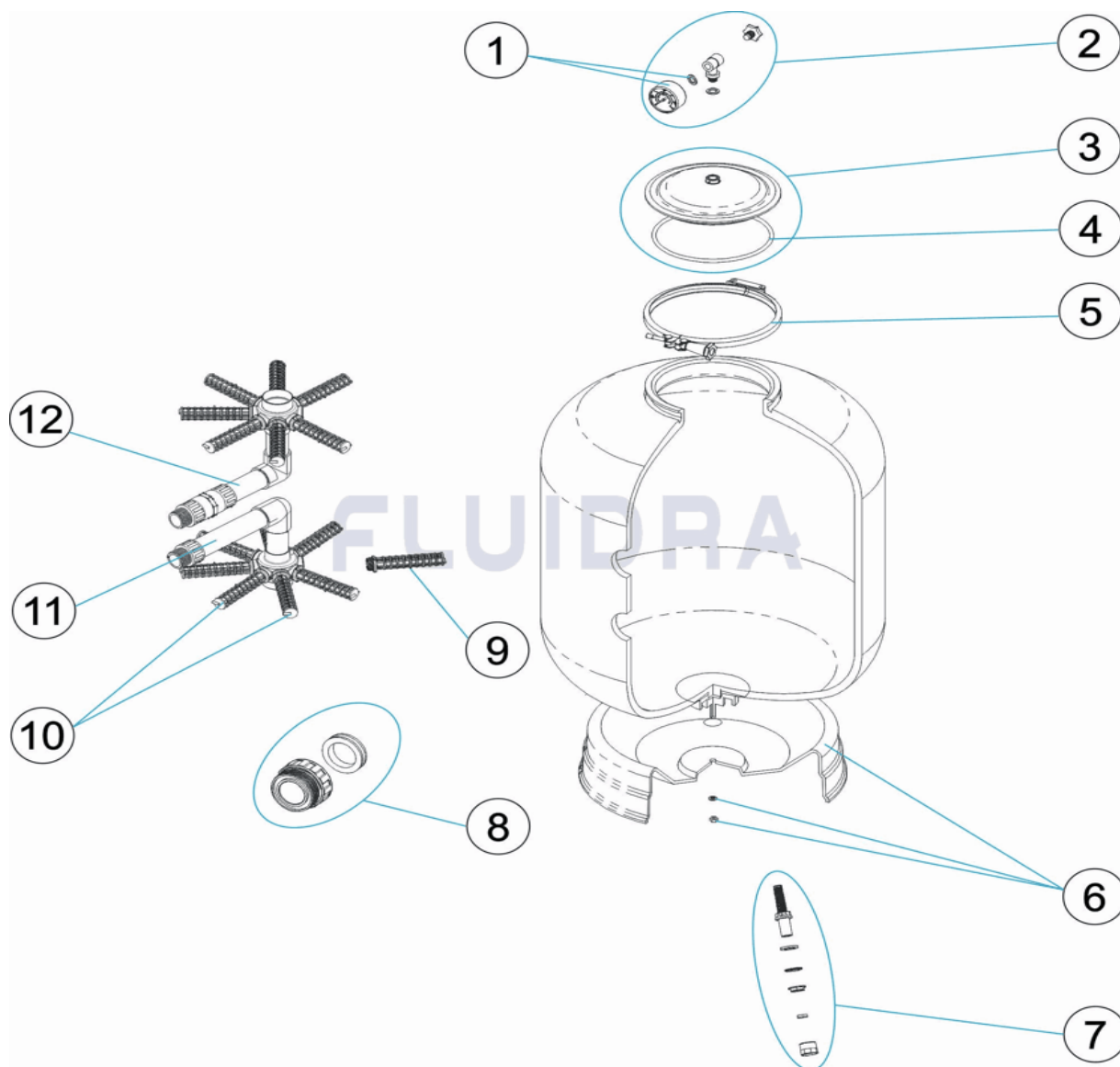
 DESCRIZIONE: **FILTRI HAWAII OC-1 D.400-600**

**ITALIANO**

| POS | CODICE       | DESCRIZIONE                         | QUANTITA' | POS | CODICE       | DESCRIZIONE                         | QUANTITA' |
|-----|--------------|-------------------------------------|-----------|-----|--------------|-------------------------------------|-----------|
| 1   | CE04180405   | MANOMETRO 1/8" 3 KG./C "            |           | 9   | * CE04040056 | CANDELOTTO COLLECTORE 1" 175 M " AB |           |
| 2   | CE04180404   | MANOMETRO COMPLETO                  |           | 9   | * CE04040055 | CANDELOTTO COLLECTORE 1" 225 M " AB |           |
| 3   | CE04080102   | COPERCHIO TRASPARENTE + ANELLO      |           | 10  | * CE04040133 | GRUPPO CANDELOTTO COLLECTORE D. 4   |           |
| 4   | CE04080101   | O-RING COPERCHIO                    |           | 10  | * CE04040063 | GRUPPO CANDELOTTO COLLECTORE D. 5   |           |
| 5   | CE04080103   | ANELLO CHIUSURA 203 NERO            |           | 10  | * CE04040064 | GRUPPO CANDELOTTO COLLECTORE D. 6   |           |
| 6   | * CE04010400 | BASE FILTRO D. 400                  |           | 11  | * CE04040187 | KIT COLLETTORE 400                  |           |
| 6   | * CE04010256 | BASE FILTRO D. 500                  |           | 11  | * CE04040188 | KIT COLLETTORE 500                  |           |
| 6   | * CE04010023 | BASE FILTRO D 650                   |           | 11  | * CE04040189 | KIT COLLETTORE 600                  |           |
| 7   | CE04070105   | DIFFUSORE SCARICO 3/8"              |           | 12  | * CE04040190 | RACCORDO DIFFUSORE D. 400           |           |
| 8   | CE04020103   | RACCORDO 1 1/2" + GUAR. CONCAVA     |           | 12  | * CE04040191 | RACCORDO DIFFUSORE D. 500           |           |
| 9   | * CE04040057 | CANDELOTTO COLLECTORE 1" 110 M " AE |           | 12  | * CE04040192 | RACCORDO DIFFUSORE D. 600           |           |

CODICE **BWS400FX30, BWS500FX30, BWS600FX30**DESCRIZIONE: **FILTRI HAWAII OC-1 D.400-600**

## OSSERVAZIONI

| POS | CODICE       | OSSERVAZIONI    |
|-----|--------------|-----------------|
| 6   | * CE04010400 | PER: BWS400FX30 |
| 6   | * CE04010256 | PER: BWS500FX30 |
| 6   | * CE04010023 | PER: BWS600FX30 |
| 9   | * CE04040057 | PER: BWS400FX30 |
| 9   | * CE04040056 | PER: BWS500FX30 |
| 9   | * CE04040055 | PER: BWS600FX30 |
| 10  | * CE04040133 | PER: BWS400FX30 |
| 10  | * CE04040063 | PER: BWS500FX30 |
| 10  | * CE04040064 | PER: BWS600FX30 |
| 11  | * CE04040187 | PER: BWS400FX30 |
| 11  | * CE04040188 | PER: BWS500FX30 |
| 11  | * CE04040189 | PER: BWS600FX30 |
| 12  | * CE04040190 | PER: BWS400FX30 |
| 12  | * CE04040191 | PER: BWS500FX30 |
| 12  | * CE04040192 | PER: BWS600FX30 |

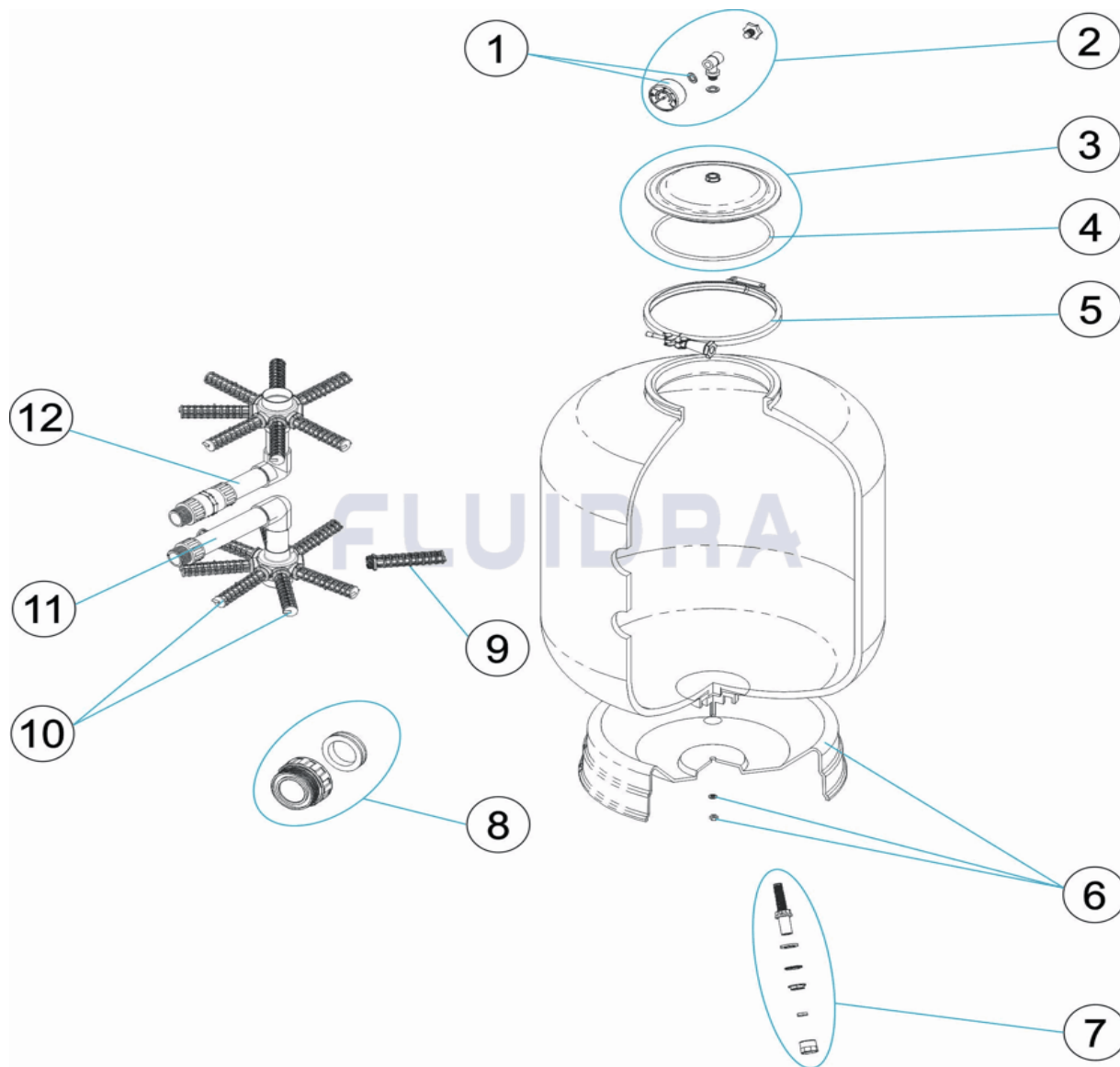

CODE **BWS400FX30, BWS500FX30, BWS600FX30**

 BESCHREIBUNG: **FILTER HAWAII OC-1 D.400-600**

**DEUTSCH**

| POS | CODE         | BESCHREIBUNG                          | MENGE | POS | CODE         | BESCHREIBUNG                          | MENGE |
|-----|--------------|---------------------------------------|-------|-----|--------------|---------------------------------------|-------|
| 1   | CE04180405   | MANOMETER 1/8" 3 KG/C "               |       | 9   | * CE04040056 | FILTERSTERN-SCHLITZROHR 1" 175 M " AB |       |
| 2   | CE04180404   | MANOMETER KOMPLETT                    |       | 9   | * CE04040055 | FILTERSTERN-SCHLITZROHR 1" 225 M " AB |       |
| 3   | CE04080102   | ABDECKUNG TRANSPARENT MIT RING        |       | 10  | * CE04040133 | SET FILTERSTERN-SCHLITZROHR D. 400    |       |
| 4   | CE04080101   | O-RING ABDECKUNG                      |       | 10  | * CE04040063 | SET FILTERSTERN-SCHLITZROHR D. 500    |       |
| 5   | CE04080103   | SCHLIESSRING 203 SCHWARZ              |       | 10  | * CE04040064 | SET FILTERSTERN-SCHLITZROHR D. 650    |       |
| 6   | * CE04010400 | FILTERFUSS D. 400                     |       | 11  | * CE04040187 | SAMMELROHRSET 400                     |       |
| 6   | * CE04010256 | FILTERFUSS D. 500                     |       | 11  | * CE04040188 | SAMMELROHRSET 500                     |       |
| 6   | * CE04010023 | FILTERFUSS D. 650                     |       | 11  | * CE04040189 | SAMMELROHRSET 600                     |       |
| 7   | CE04070105   | FILTERSTOPFEN ABLASS 3/8"             |       | 12  | * CE04040190 | SET WASSERVERTEILER D. 400            |       |
| 8   | CE04020103   | GEWINDESTÜCK 1 1/2' UND DICHTUNG KC   |       | 12  | * CE04040191 | SET WASSERVERTEILER D. 500            |       |
| 9   | * CE04040057 | FILTERSTERN-SCHLITZROHR 1" 110 M " AE |       | 12  | * CE04040192 | SET WASSERVERTEILER D. 600            |       |

CODE **BWS400FX30, BWS500FX30, BWS600FX30**BESCHREIBUNG: **FILTER HAWAII OC-1 D.400-600**

## HINWEISE

| POS | CODE         | HINWEISE        |
|-----|--------------|-----------------|
| 6   | * CE04010400 | FÜR: BWS400FX30 |
| 6   | * CE04010256 | FÜR: BWS500FX30 |
| 6   | * CE04010023 | FÜR: BWS600FX30 |
| 9   | * CE04040057 | FÜR: BWS400FX30 |
| 9   | * CE04040056 | FÜR: BWS500FX30 |
| 9   | * CE04040055 | FÜR: BWS600FX30 |
| 10  | * CE04040133 | FÜR: BWS400FX30 |
| 10  | * CE04040063 | FÜR: BWS500FX30 |
| 10  | * CE04040064 | FÜR: BWS600FX30 |
| 11  | * CE04040187 | FÜR: BWS400FX30 |
| 11  | * CE04040188 | FÜR: BWS500FX30 |
| 11  | * CE04040189 | FÜR: BWS600FX30 |
| 12  | * CE04040190 | FÜR: BWS400FX30 |
| 12  | * CE04040191 | FÜR: BWS500FX30 |
| 12  | * CE04040192 | FÜR: BWS600FX30 |

CODIGO **BWS400FX30, BWS500FX30, BWS600FX30**

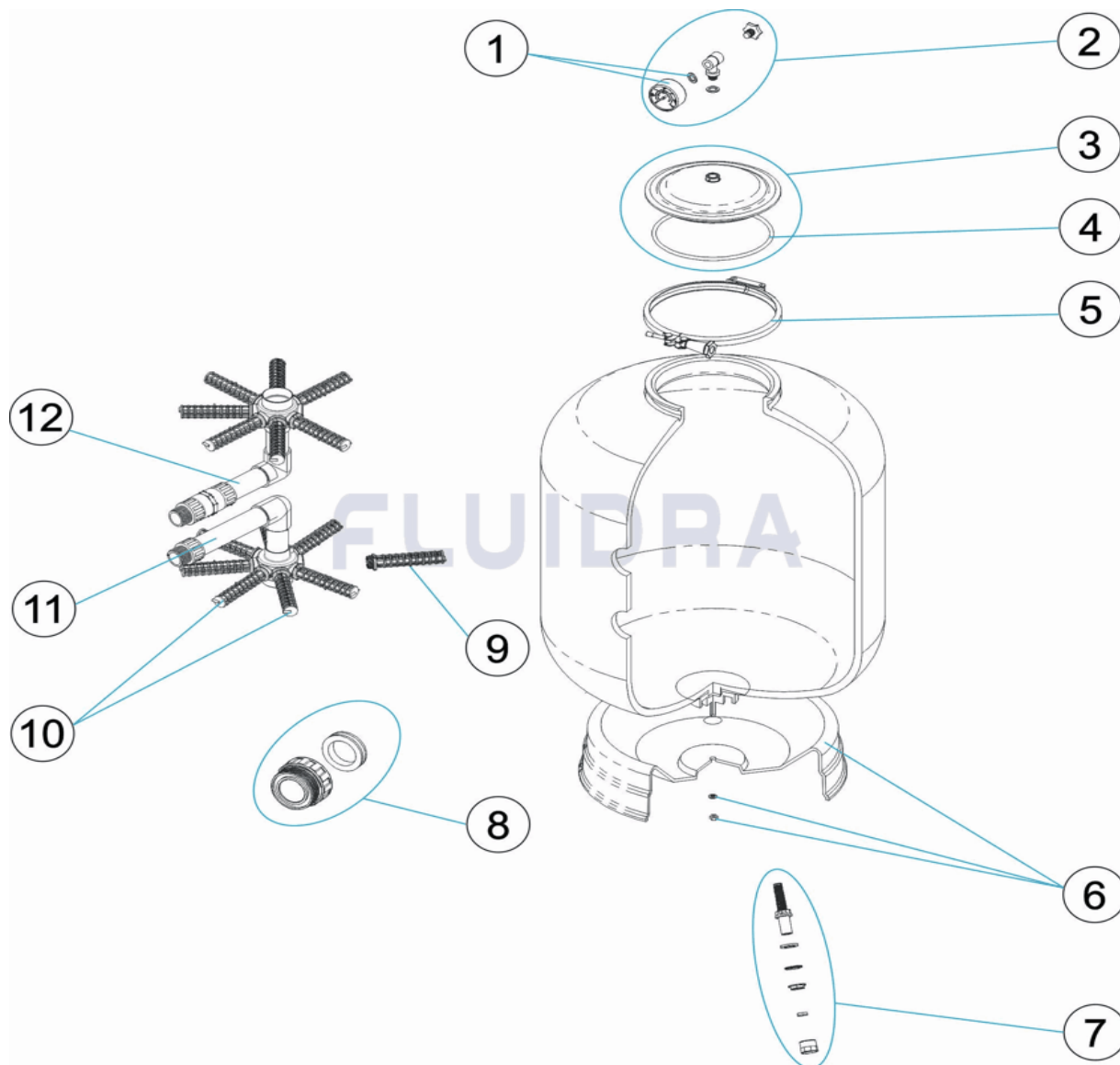
 DESCRIÇÃO: **FILTROS HAWAII OC-1 D.400-600**

### PORTUGUES

| POS | CODIGO       | DESCRIÇÃO                           | JANTIDADE | POS | CODIGO       | DESCRIÇÃO                           | JANTIDADE |
|-----|--------------|-------------------------------------|-----------|-----|--------------|-------------------------------------|-----------|
| 1   | CE04180405   | MANOMETRO 1/8" 3 KG./C "            |           | 9   | * CE04040056 | BRAÇO COLECTOR 1" 175 M " ABS BRANC |           |
| 2   | CE04180404   | MANÓMETRO COMPLETO                  |           | 9   | * CE04040055 | BRAÇO COLECTOR 1" 225 M " ABS BRANC |           |
| 3   | CE04080102   | TAMPA TRANSPARENTE + ARO            |           | 10  | * CE04040133 | CJTO. BRAÇO COLECTOR D. 400         |           |
| 4   | CE04080101   | JUNTA TÓRICA TAMPA                  |           | 10  | * CE04040063 | CJTO. BRAÇO COLECTOR D. 500         |           |
| 5   | CE04080103   | FECHO COMPLETO                      |           | 10  | * CE04040064 | CJTO. BRAÇO COLECTOR D. 650         |           |
| 6   | * CE04010400 | PÉ FILTRO D. 400                    |           | 11  | * CE04040187 | CJTO. COLECTOR 400                  |           |
| 6   | * CE04010256 | PÉ FILTRO D. 500                    |           | 11  | * CE04040188 | CJTO. COLECTOR 500                  |           |
| 6   | * CE04010023 | PÉ FILTRO D 650                     |           | 11  | * CE04040189 | CJTO. COLECTOR 600                  |           |
| 7   | CE04070105   | DRENO 3/8"                          |           | 12  | * CE04040190 | CJTO. DIFUSOR D. 400                |           |
| 8   | CE04020103   | RACORD 1 1/2' + JUNTA CONCAVA       |           | 12  | * CE04040191 | CJTO. DIFUSOR D. 500                |           |
| 9   | * CE04040057 | BRAÇO COLECTOR 1" 110 M " ABS BRANC |           | 12  | * CE04040192 | CJTO. DIFUSOR D. 600                |           |

CODIGO **BWS400FX30, BWS500FX30, BWS600FX30**DESCRICAÇÃO: **FILTROS HAWAII OC-1 D.400-600****OBSERVACÕES**

| POS | CODIGO       | OBSERVACÕES      |
|-----|--------------|------------------|
| 6   | * CE04010400 | PARA: BWS400FX30 |
| 6   | * CE04010256 | PARA: BWS500FX30 |
| 6   | * CE04010023 | PARA: BWS600FX30 |
| 9   | * CE04040057 | PARA: BWS400FX30 |
| 9   | * CE04040056 | PARA: BWS500FX30 |
| 9   | * CE04040055 | PARA: BWS600FX30 |
| 10  | * CE04040133 | PARA: BWS400FX30 |
| 10  | * CE04040063 | PARA: BWS500FX30 |
| 10  | * CE04040064 | PARA: BWS600FX30 |
| 11  | * CE04040187 | PARA: BWS400FX30 |
| 11  | * CE04040188 | PARA: BWS500FX30 |
| 11  | * CE04040189 | PARA: BWS600FX30 |
| 12  | * CE04040190 | PARA: BWS400FX30 |
| 12  | * CE04040191 | PARA: BWS500FX30 |
| 12  | * CE04040192 | PARA: BWS600FX30 |