

CODIGO **64315**

DESCRIPCION: **BERING SEL**

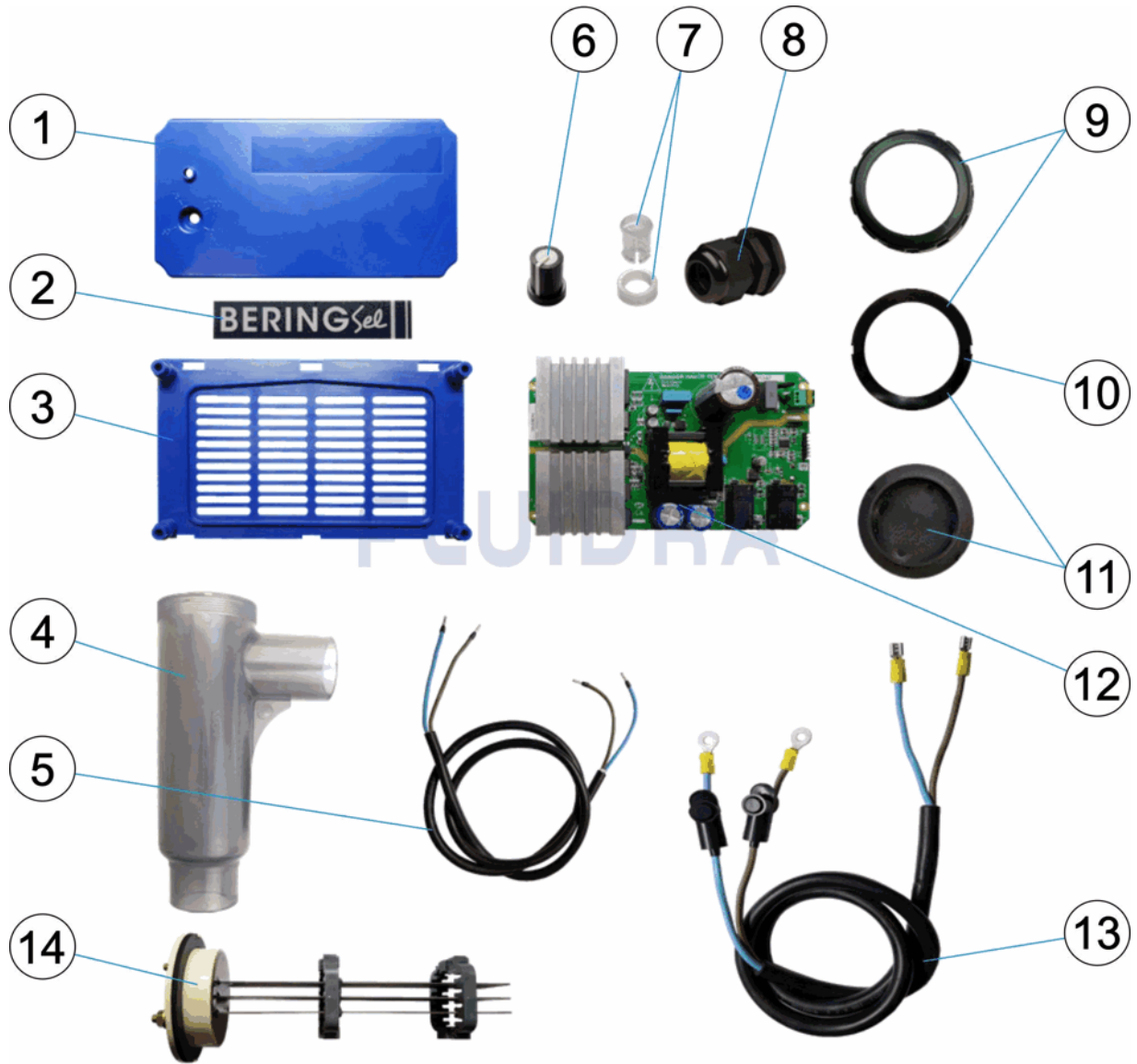

ESPAÑOL

POS	CODIGO	DESCRIPCION	CANTIDAD	POS	CODIGO	DESCRIPCION	CANTIDAD
1	4408040413	CARCASA BERING	8	4408040419	CJTO. PRENSAESTOPAS PG20		
2	4408040414	ETIQUETA BERING	9	4408060105	TUERCA D. 92 ELECTRODO SEL + JUNTA		
3	4408040415	CARCASA TRASERA	10	4408060106	JUNTA PLANA ELECTRODO SEL		
4	4408060201	VASO SEL PEQUEÑO PARA BASIC	11	4408060122	TAPON GRANDE VASO + JUNTA		
5	4408040416	CABLE ALIMENTACION 2X1,5MM2 1.2M	12	4408040420	CIRC. ELECTRONICO BERING SEL		
6	4408040417	POTENCIOMETRO	13	4408040421	CABLE ELECTRODO COMPLETO		
7	4408040418	LENTE LED	14	72889	ELECTRODO SEL 3 PLACAS		

CODE **64315**
DESCRIPTION: **BERING SEL**

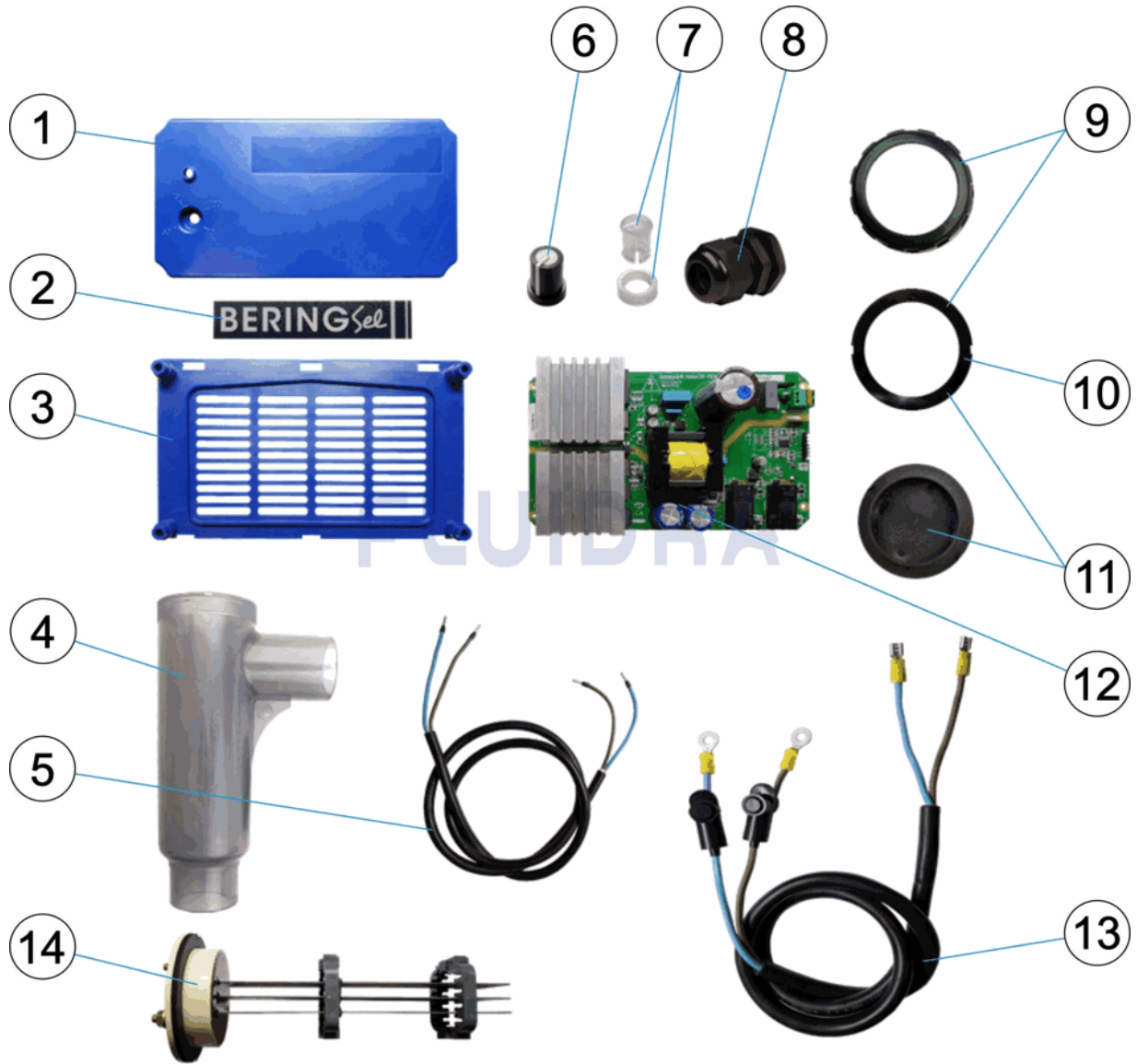

FRANCAIS

POS	CODE	DESCRIPTION	QUANTITE	POS	CODE	DESCRIPTION	QUANTITE
1	4408040413	CARCASSE BERING		8	4408040419	ENS. PRESSE-ÉTOUPES PG20	
2	4408040414	ÉTIQUETTE BERING		9	4408060105	ECROU D. 92 ELECTRODE SEL + JOINT	
3	4408040415	CARCASSE ARRIÈRE		10	4408060106	JOINT PLAT ÉLECTRODE SEL	
4	4408060201	VASE SEL POUR BASIC		11	4408060122	COUVERCLE GRAND VASE + JOINT	
5	4408040416	CÂBLE ALIMENTATION 2X1,5MM2 1.2M		12	4408040420	CIRCUIT ELECTRONIQUE BERING SEL	
6	4408040417	POTENTIOMÈTRE		13	4408040421	CABLE ELECTRODE	
7	4408040418	LENTILLE LED		14	72889	ELECTRODE SEL 3 PLAQUES	

CODE **64315**
DESCRIPTION: **BERING SEL**

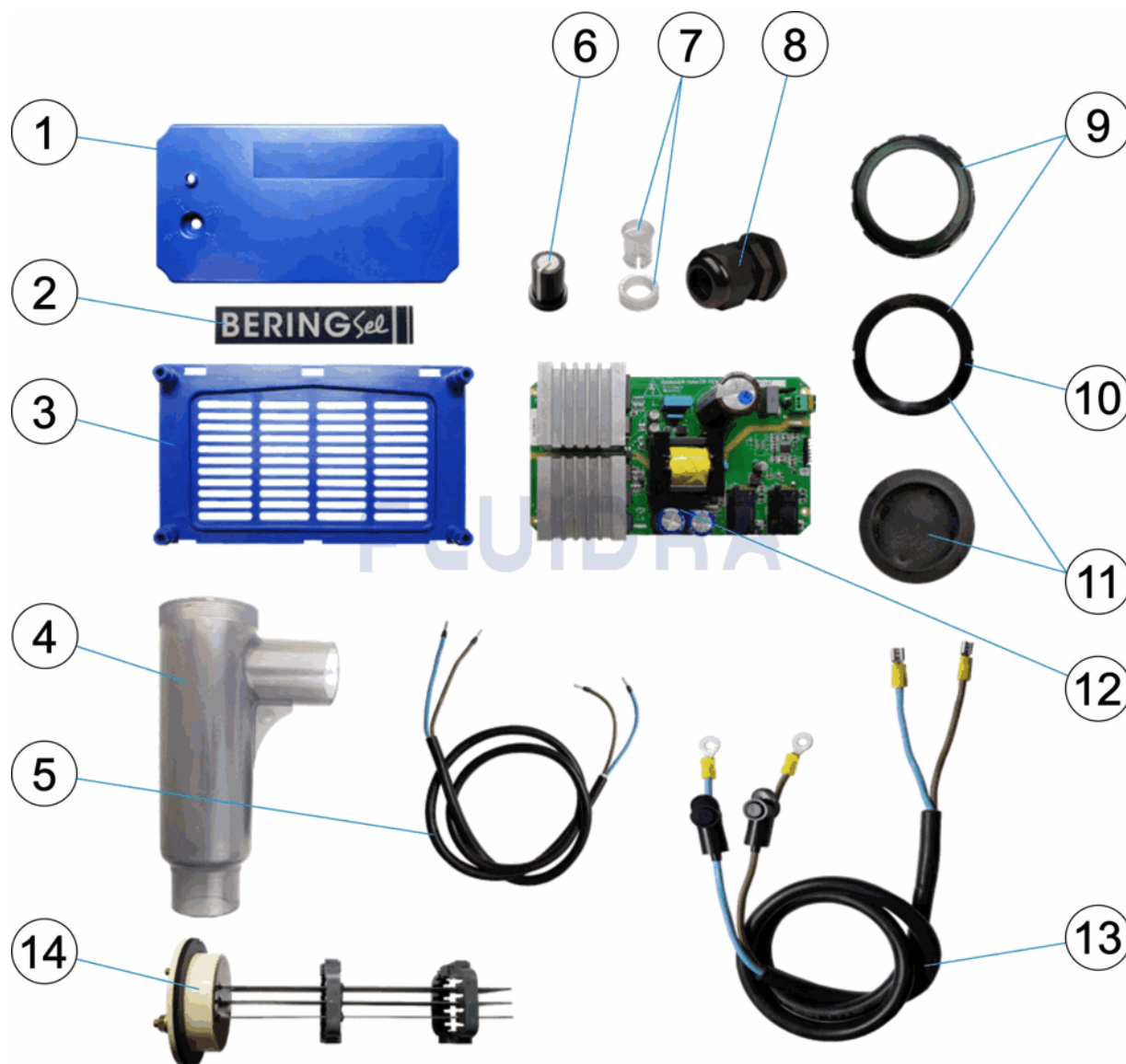

ENGLISH

POS	CODE	DESCRIPTION	QUANTITY	POS	CODE	DESCRIPTION	QUANTITY
1	4408040413	BERING SHELL		8	4408040419	PG20 PACKING GLAND UNIT	
2	4408040414	BERING STICKER		9	4408060105	D. 92 ELECTRODE NUT + GASKET	
3	4408040415	BACK COVER		10	4408060106	ELECTRODE GASKET	
4	4408060201	BASIC SEL CLASS		11	4408060122	HOUSING CAP + GASKET	
5	4408040416	2X1,5MM2 1.2M SUPPLY CABLE		12	4408040420	BERING SEL ELECTRONIC CIRCUIT	
6	4408040417	POTENTIOMETER		13	4408040421	ELECTRODE CABLE	
7	4408040418	LED LENS		14	72889	SEL ELECTRODE 3 PLATES	

CODICE **64315**
 DESCRIZIONE: **BERING SEL**

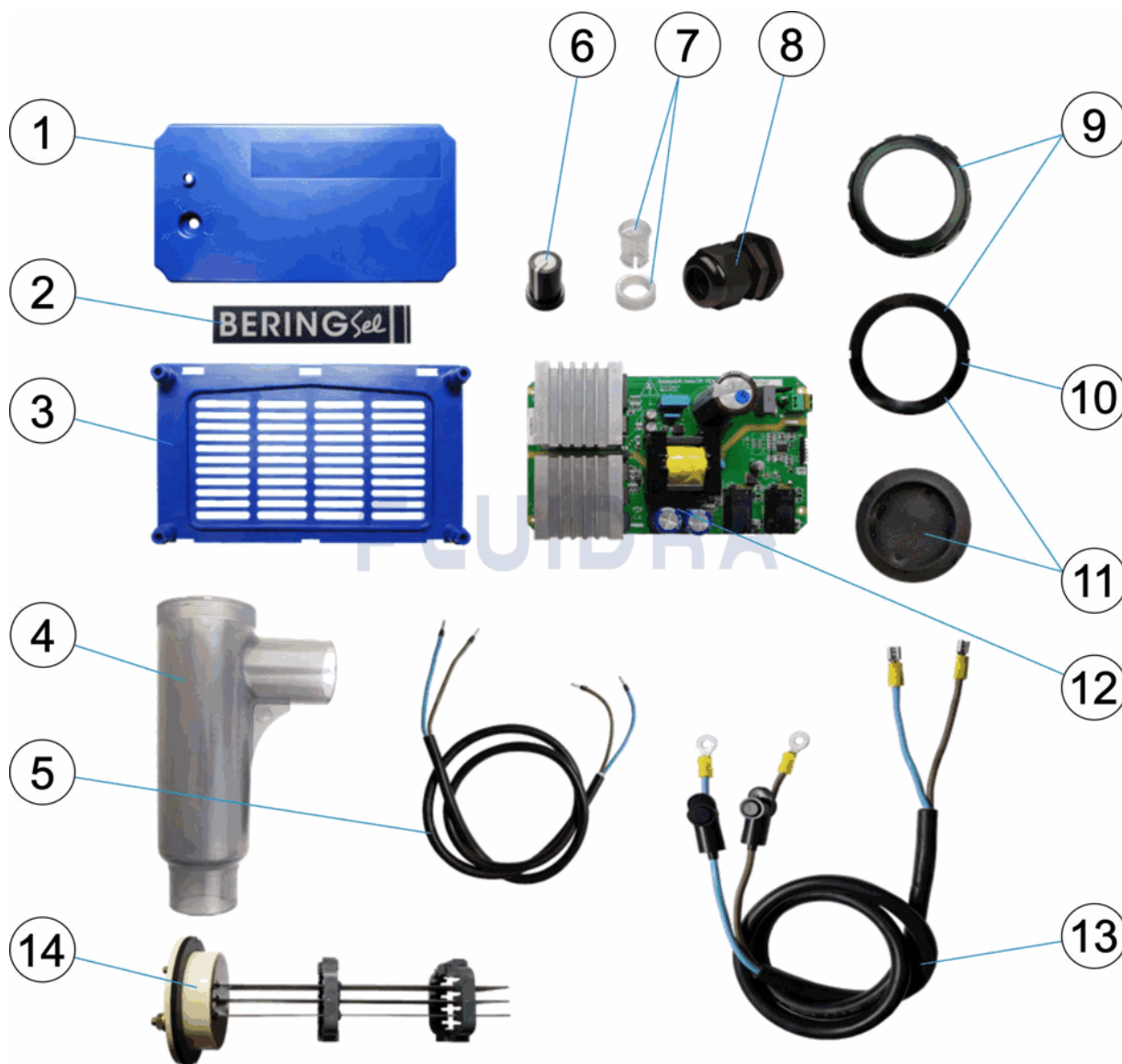

ITALIANO

POS	CODICE	DESCRIZIONE	QUANTITA'	POS	CODICE	DESCRIZIONE	QUANTITA'
1	4408040413	SCATOLA BERING		8	4408040419	GRUPPO PREMISTOPPA PG20	
2	4408040414	ETICHETTA BERING		9	4408060105	GHIERA D.92 ELETTRODO + GUARNIZIONE	
3	4408040415	CARCASSA POSTERIORE		10	4408060106	GUARNIZIONE ELETTRODO	
4	4408060201	PORTAELETTODI SEL		11	4408060122	TAPPO NERO GRANDE ELETTRODO + GUA	
5	4408040416	CAVO DI ALIMENTAZIONE 2X1,5MM2 1.2M		12	4408040420	CIRCUITO ELETTRONICO BERING SEL	
6	4408040417	POTENZIOMETRO		13	4408040421	CAVO ELETTRODO	
7	4408040418	LENTE LED		14	72889	ELETTRODO SEL 3 PLACHE	

CODE **64315**

BESCHREIBUNG: **BERING SEL**

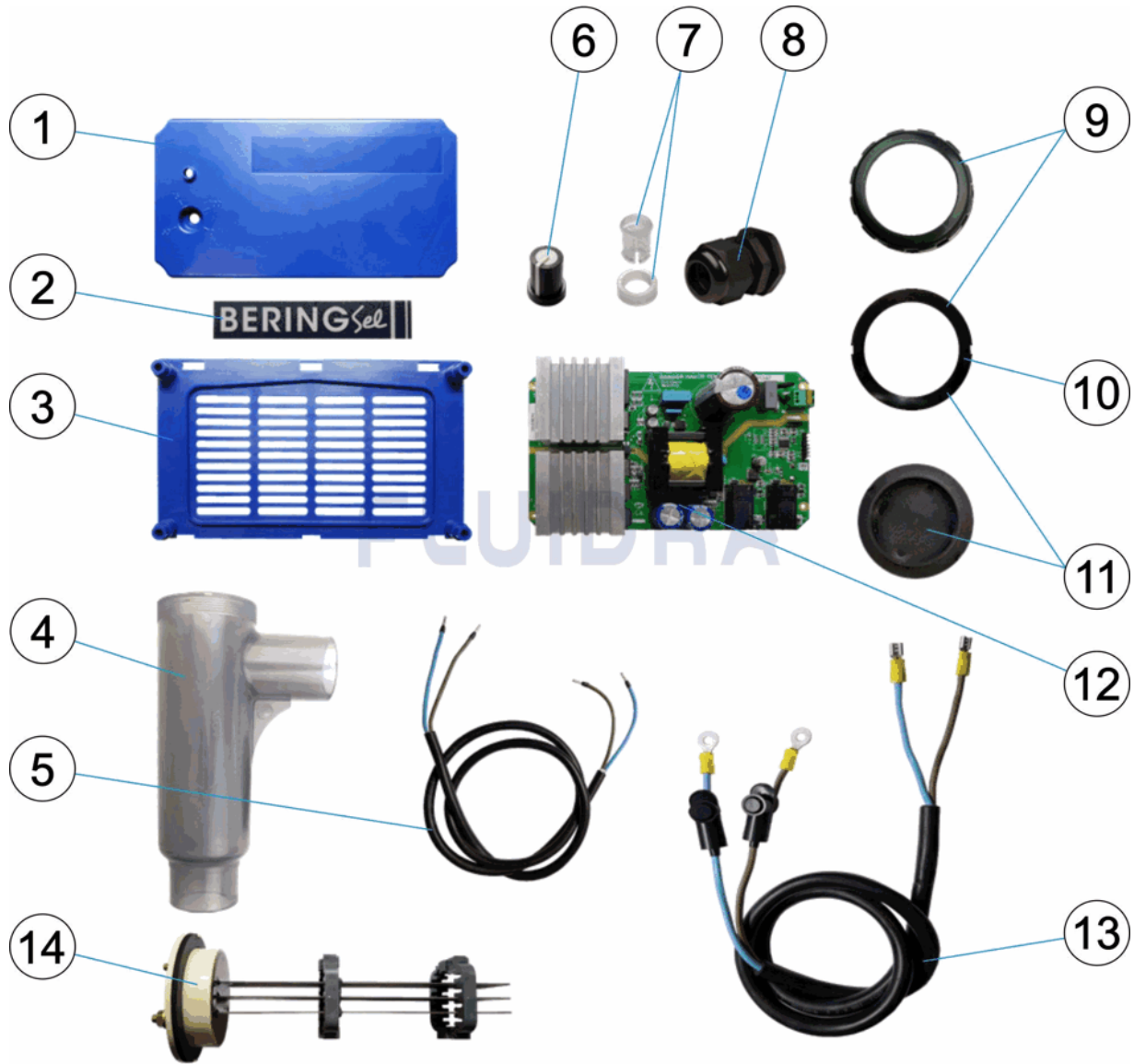

DEUTSCH

POS	CODE	BESCHREIBUNG	MENGE	POS	CODE	BESCHREIBUNG	MENGE
1	4408040413	GEHÄUSE BERING		8	4408040419	SET QUETSCHVERSCHRAUBUNG PG20	
2	4408040414	ETIKETTE BERING		9	4408060105	MUTTER D. 92 ELEKTRODE SEL UND DICHT	
3	4408040415	GEHÄUSE HINTEN		10	4408060106	FLACHDICHTUNG ELEKTRODE SEL	
4	4408060201	GEHÄUSE SEL KLEIN FÜR BASIC		11	4408060122	STOPFEN GROSS GEHÄUSE UND DICHTUN	
5	4408040416	VERSORGUNGSKABEL 2X1,5MM2 1.2M		12	4408040420	PLATINE SCHALTKREIS BERING SEL	
6	4408040417	POTENTIOMETER		13	4408040421	ELEKTRODENKABEL KOMPLETT	
7	4408040418	LINSE LED		14	72889	ELEKTRODE SEL 3 PLATINEN	

CODIGO **64315**

DESCRIÇÃO: **BERING SEL**

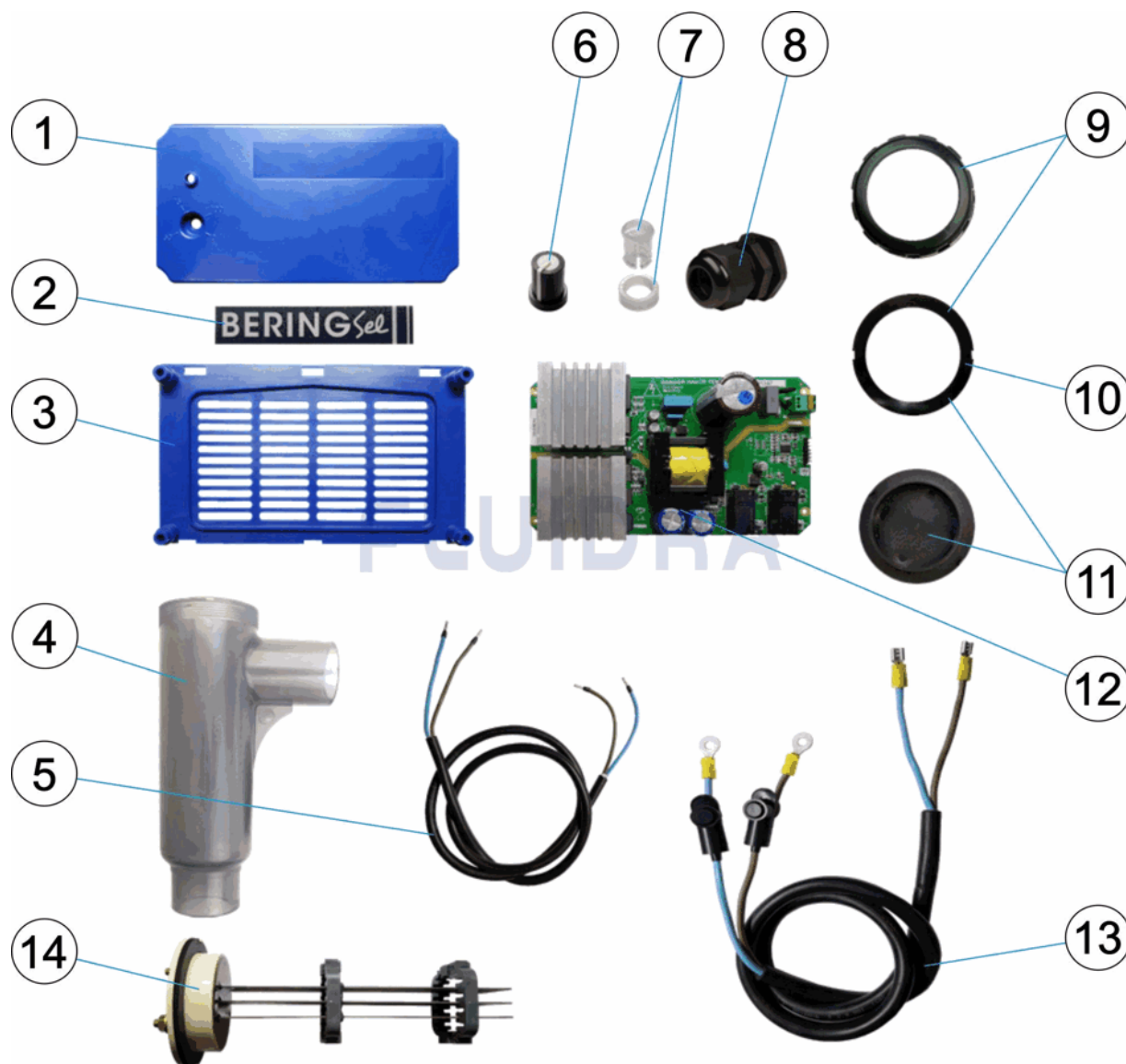

PORTUGUES

POS	CODIGO	DESCRIÇÃO	JANTIDADE	POS	CODIGO	DESCRIÇÃO	JANTIDADE
1	4408040413	CARCAÇA BERING	8	4408040419	CJTO. PRENSA-ESTOPAS PG20		
2	4408040414	ETIQUETA BERING	9	4408060105	PORCA D. 92 ELÉCTRODO SEL + JUNTA		
3	4408040415	CARCAÇA TRASEIRA	10	4408060106	JUNTA PLANA ELÉCTRODO SEL		
4	4408060201	COPO PEQUEÑO PARA BASIC	11	4408060122	TAMPÃO GRANDE COPO + JUNTA		
5	4408040416	CABO ALIMENTAÇÃO 2X1,5MM2 1.2M	12	4408040420	CIRCUITO ELECTRONICO BERING SEL		
6	4408040417	POTENCIOMETRO	13	4408040421	CABO SONDA		
7	4408040418	LENTE LED	14	72889	ELÉCTRODO SEL 3 PLACAS		