

CODIGO **08013**

DESCRIPCION: **SOPORTE PASAMANO**

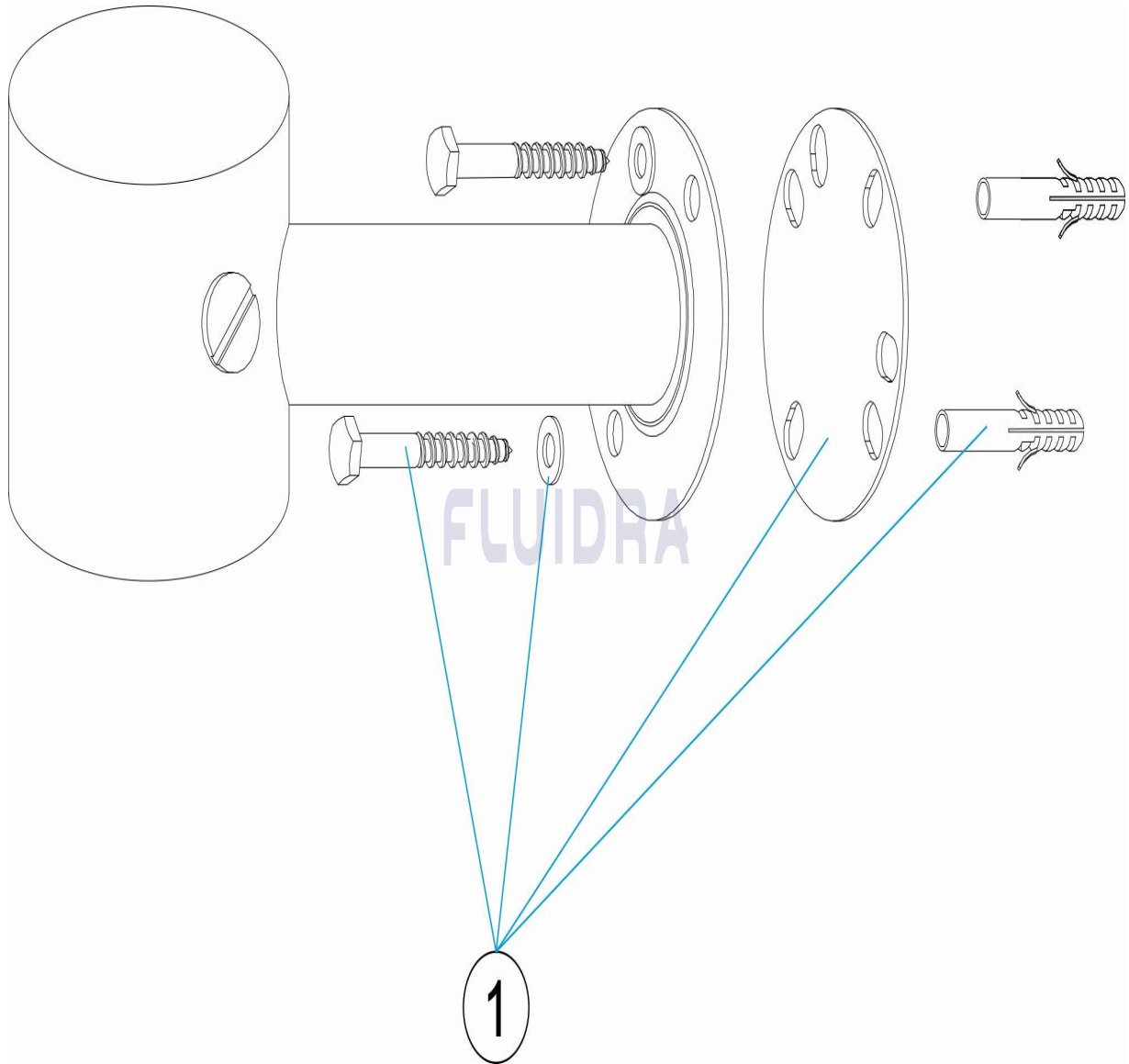

ESPAÑOL

POS	CODIGO	DESCRIPCION	CANTIDAD	POS	CODIGO	DESCRIPCION	CANTIDAD
1	4401012304	JUNTA PLETINA					

CODE **08013**

DESCRIPTION: **SUPPORT MAIN COURANTE**

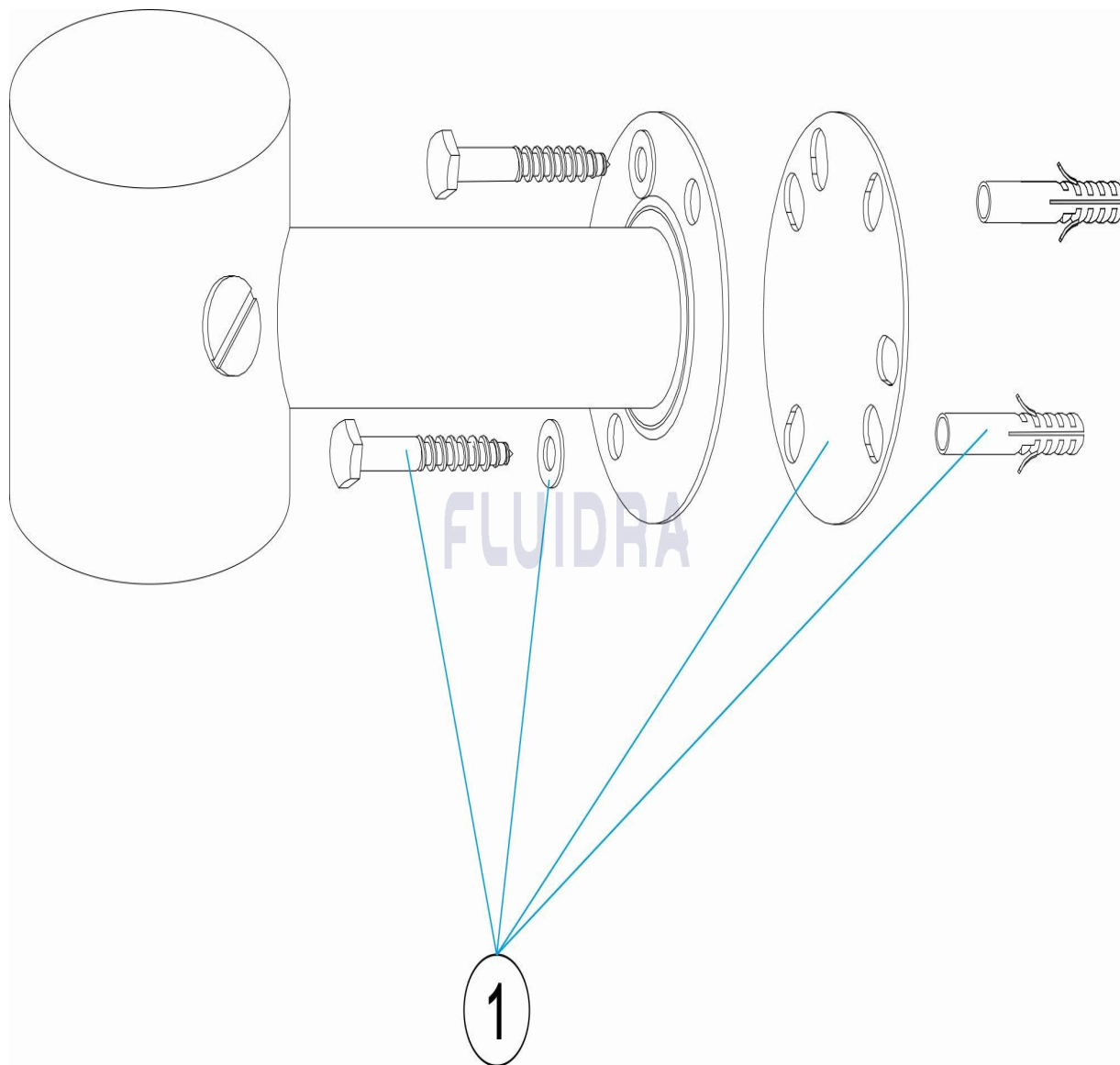

FRANCAIS

POS	CODE	DESCRIPTION	QUANTITE	POS	CODE	DESCRIPTION	QUANTITE
1	4401012304	JOINT PLATINE					

CODE **08013**

DESCRIPTION: **HANDRAIL SUPPORT**

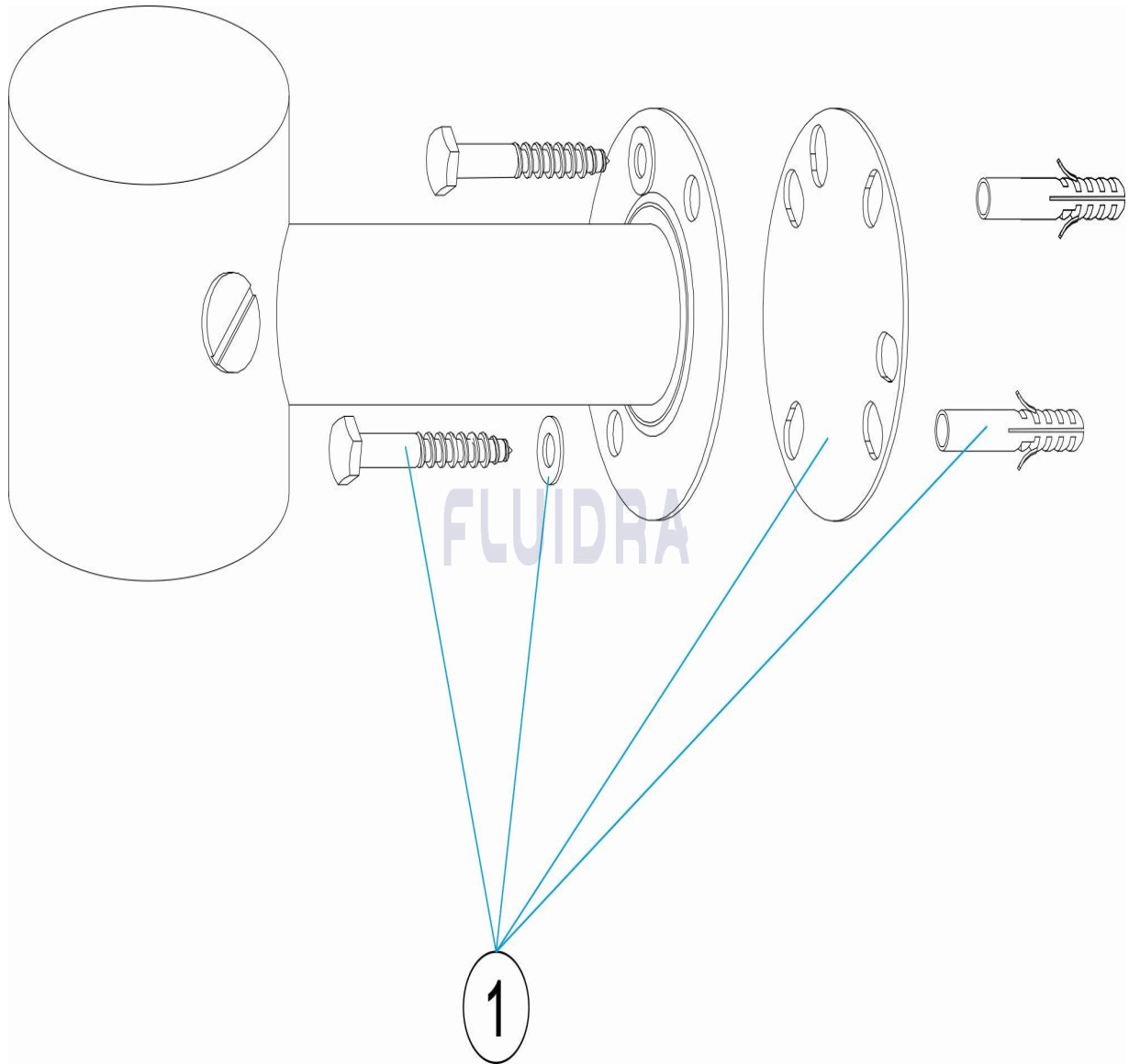

ENGLISH

POS	CODE	DESCRIPTION	QUANTITY	POS	CODE	DESCRIPTION	QUANTITY
1	4401012304	GASKET					

CODICE **08013**

DESCRIZIONE: **SUPPORTO PASSAMANO**

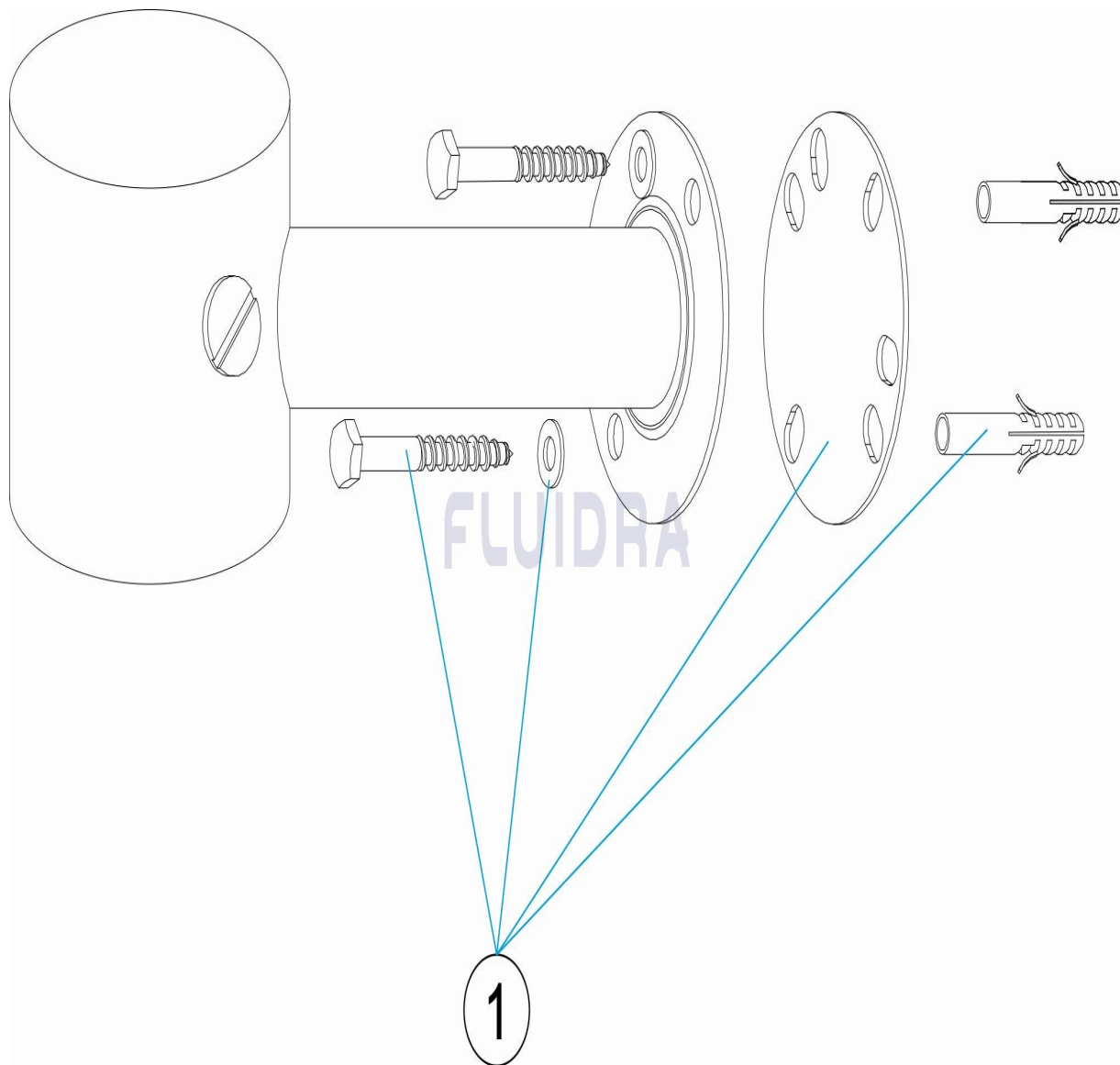

ITALIANO

POS	CODICE	DESCRIZIONE	QUANTITA'	POS	CODICE	DESCRIZIONE	QUANTITA'
1	4401012304	GUARNIZIONE					

CODE **08013**

BESCHREIBUNG: **HALTERUNG HANDLAUF**

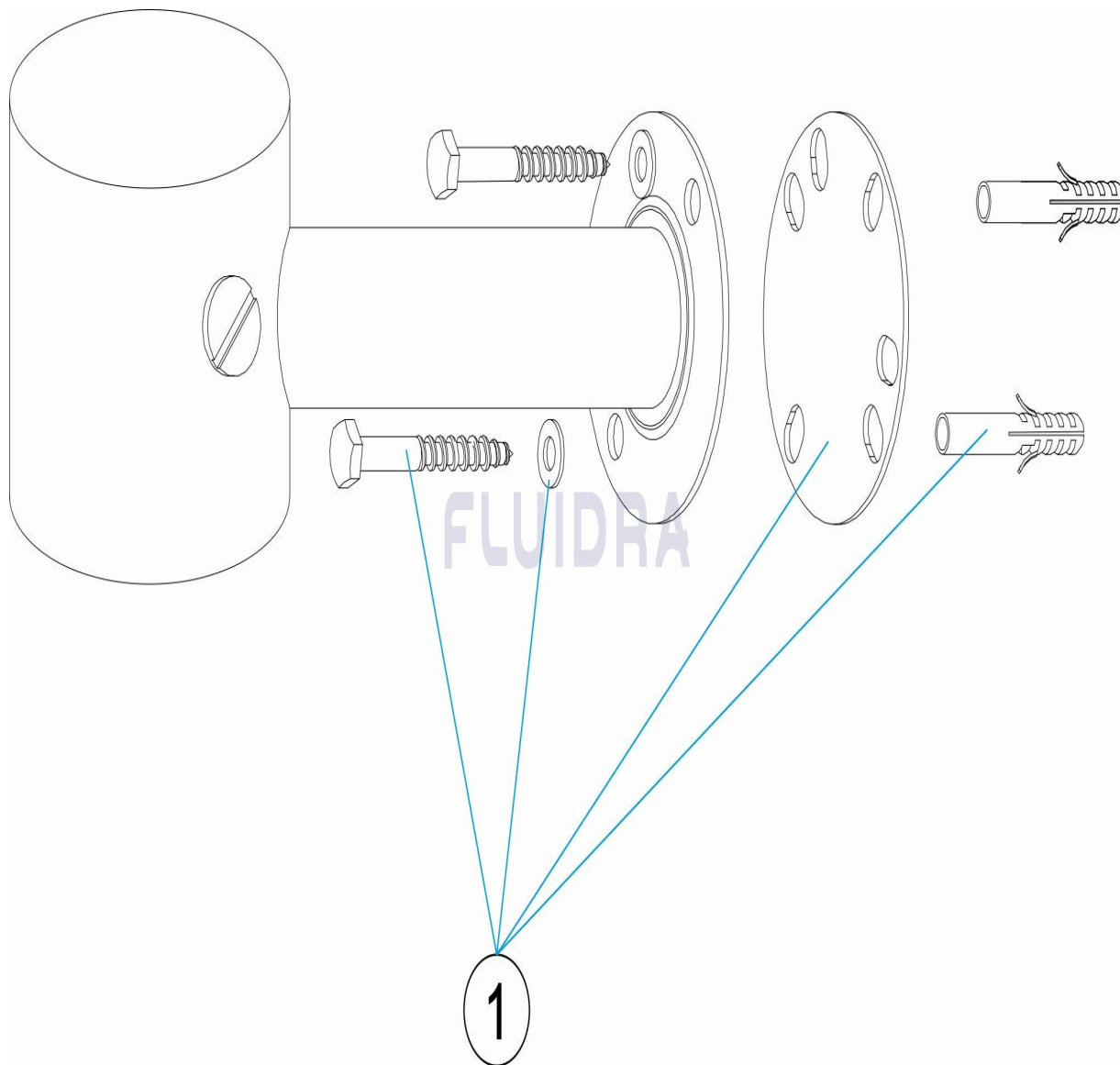

DEUTSCH

POS	CODE	BESCHREIBUNG	MENGE	POS	CODE	BESCHREIBUNG	MENGE
1	4401012304	DICHTUNG GRUNDPLATINE					

CODIGO **08013**

DESCRIÇÃO: **SUPORE CORRIMÃO**

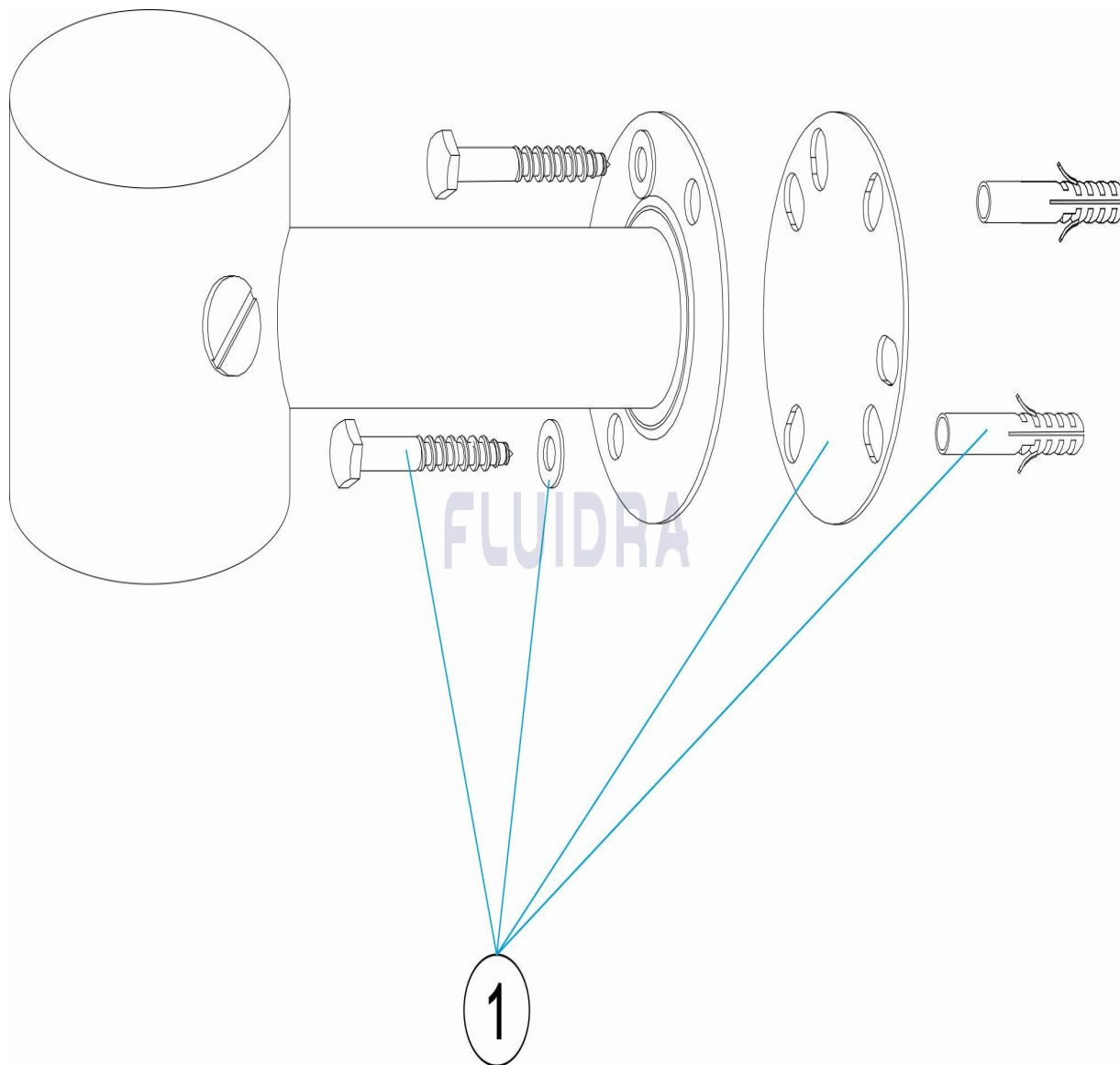

PORTUGUES

POS	CODIGO	DESCRIÇÃO	JANTIDADE	POS	CODIGO	DESCRIÇÃO	JANTIDADE
1	4401012304	JUNTA PLATINA					