

CODIGO **60140**

DESCRIPCION: LIMPIAFONDOS ULTRA 250

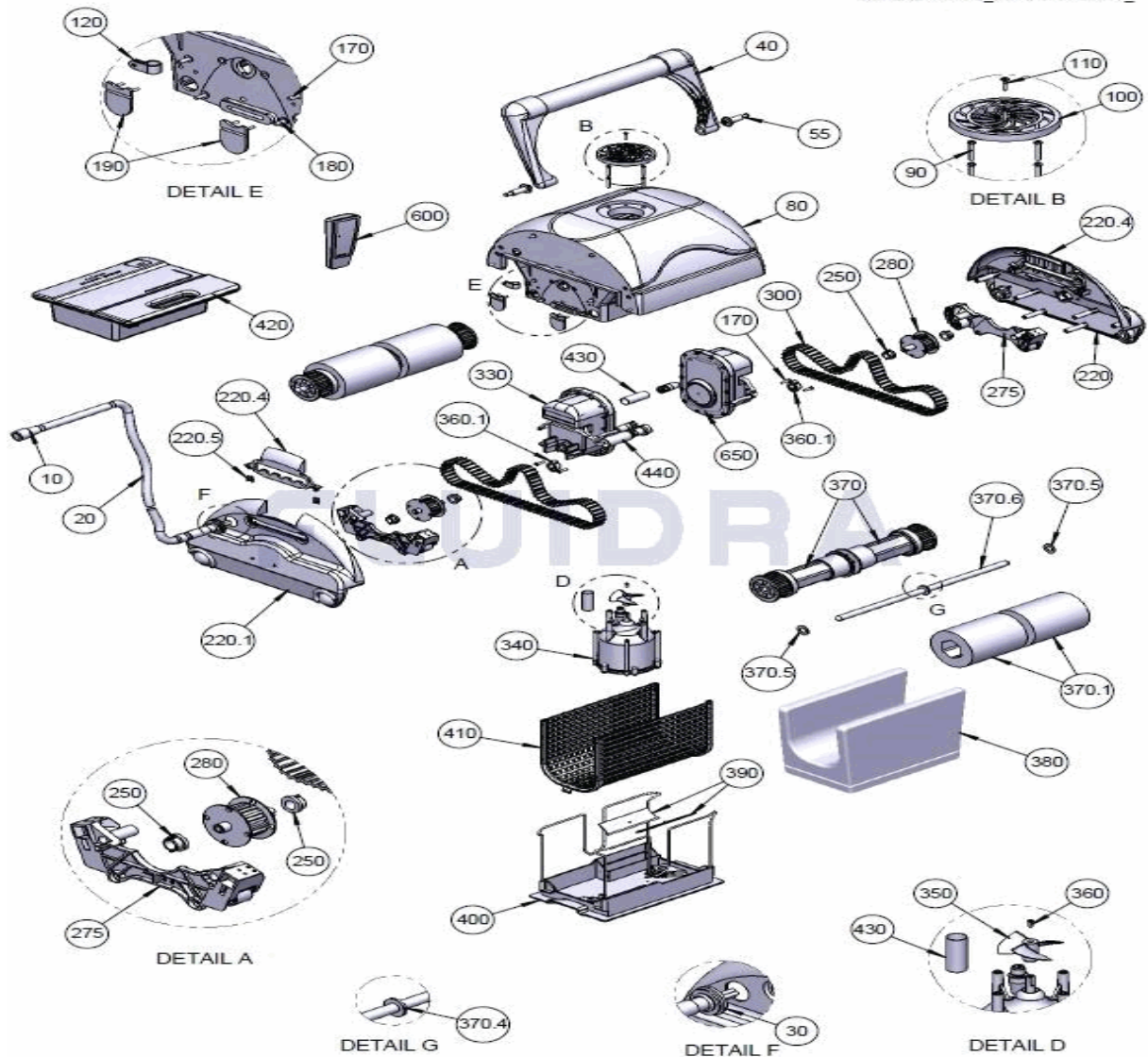

ESPAÑOL

POS	CODIGO	DESCRIPCION	CANTIDAD	POS	CODIGO	DESCRIPCION	CANTIDAD
10	ASPL00002M	ENCHUFE 4 TERMINALES		220,4	5088BL	PALANCA DE BLOQUEO	
20	WA00030CGL	CABLE FLOTADOR CG/30M/4C/EZ-SW/FAS		220,5	5087	MUELLE	
30	PP0001623	JUNTA PASACABLES		250	2613	RODAMIENTO DE EJES	
40	AS1049930	CONJUNTO MANGO		275	ASPP036200	SISTEMA DE TENSORES	
55	SK00000BK	PASADOR COMPLETO PARA MANGO		280	AS2000500	CONJUNTO POLEA	
80	AS1016220	CUERPO COMPLETO		300	RB00098GY	CORREA DE TRACCIÓN	
90	2500	TORNILLO PARA MOTOR BOMBA		330	AS08705-SP	MOTOR DE TRACCION	
100	5093CG	TAPA SUPERIOR		340	AS00035R-SP	MOTOR DE BOMBEO	
110	5061	TORNILLO DE TAPA SUPERIOR		350	P00038	HELICE	
120	2105	SUJECION CABLE		360	SW00069	TORNILLO PARA HELICE	
170	2700	TORNILLO SUPERIOR LATERAL		360,1	PP0004500	CUBIERTA DEL PASADOR	
180	2701	TORNILLO INFERIOR LATERAL		370	A38223BL	RODILLO CEPILLO	
190	2305N	VALVULA DE GOMA		370,1	3009AG	CEPILLO PVA GRIS (ANTIGUO)	

CODIGO 60140

DESCRIPCION: LIMPIAFONDOS ULTRA 250

220	AS1066400	PLACA LATERAL	370.4	A2607PK	ARANDELA EXTREMOS EJE 4 PK
220.1	AS1066450	PLACA LATERAL CON AGUJERO	370.5	3603	ARANDELA INTERMEDIA DE EJE
370.6	MP00212	EJE RUEDAS 413 MM	440	AS111161408	TUBO RETRACTIL 1614 (80mm)
380	8150	BOLSA FILTRO	600	RC0100500	CONTROL REMOTO
390	9305B-NT	VALVULA PLASTICA CIERRE FONDO	650	AS08694-SP	MOTOR ESCLAVO
400	BS6100200	CONJUNTO TAPA INFERIOR	Not shown	4613	PASADOR CON RANURA
410	AS09240	CJTO. REJILLA FILTRO	Not shown	PL00008F	CONECTOR ELECTRICO 4 PIN HEMBRA
420	AS2722810-SP	TRANSFORMADOR	Not shown	PP0005000	FLOTADOR MOTOR
430	AS110162506	TUBO RETRACTIL 20/6 (60mm)			

CODE 60140

DESCRIPTION: NETTOYEUR DE FOND ULTRA 250

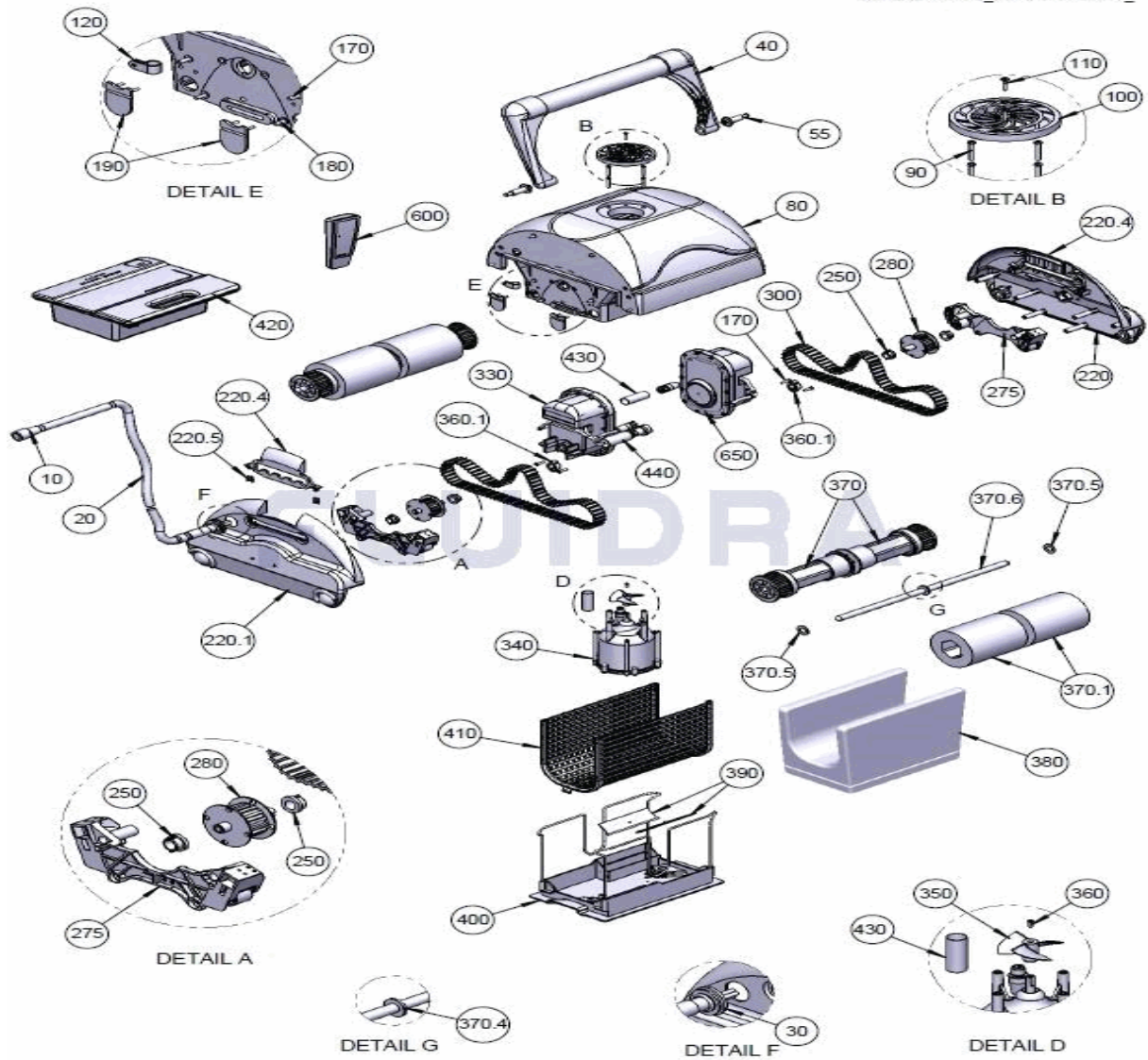

FRANCAIS

POS	CODE	DESCRIPTION	QUANTITE	POS	CODE	DESCRIPTION	QUANTITE
10	ASPL00002M	PRISE À 4 FICHES		220,4	5088BL	LEVIER DE BLOCAGE	
20	WA00030CGL	CÂBLE FLOTTANT CG/30M/4C/EZ-SW/FAST		220,5	5087	RESSORT	
30	PP0001623	(not defined)		250	2613	BAGUE EN MOLYBDÈNE	
40	AS1049930	ENSEMBLE MANCHE		275	ASPP036200	SYSTÈME DE TENSION	
55	SK00000BK	BROCHE COMPLÈTE POUR MANCHE		280	AS2000500	ENSEMBLE POULIE	
80	AS1016220	ENSEMBLE CORPS		300	RB00098GY	COURROIE DE TRACTION	
90	2500	VIS 8X1,175 PH PN		330	AS08705-SP	MOTEUR DE TRACTION	
100	5093CG	SORTIE SUPÉRIEURE		340	AS00035R-SP	MOTEUR DE LA POMPE	
110	5061	VIS 6-32X5/8 S/S PH PA		350	P00038	HÉLICE	
120	2105	FIXATION CÂBLE		360	SW00069	VIS M-3X10 PHIL DIN-965	
170	2700	VIS 8X11/16 PHIL PN		360,1	PP0004500	LOGEMENT DE TIGE	
180	2701	VIS 8X11/16PHIL PN		370	A38223BL	ROULEAU BROSSE	
190	2305N	VALVE CAOUTCHOUTÉE		370,1	3009AG	BROSSE PVA GRISE (ANCIENNE)	

CODE **60140**

DESCRIPTION: **NETTOYEUR DE FOND ULTRA 250**

220	AS1066400	PLAQUE LATÉRALE	370.4	A2607PK	RONDELLE D'EXTRÉMITÉ D'ARBRE
220.1	AS1066450	PLAQUE LATÉRALE AVEC ORIFICE	370.5	3603	RONDELLE INTERMÉDIAIRE AXE
370.6	MP00212	AXE ROUES 413 MM	440	AS111161408	TUBE RÉTRACTABLE 1614 (80MM)
380	8150	(not defined)	600	RC0100500	TÉLÉCOMMANDE
390	9305B-NT	VANNE PLASTIQUE FERMETURE FOND	650	AS08694-SP	MOTEUR ESCLAVE
400	BS6100200	ENSEMBLE COUVERCLE INFÉRIEUR	Not shown	4613	GOUPILLE À RAINURE
410	AS09240	ENS. GRILLE ET FILTRE	Not shown	PL00008F	CONNECTEUR ÉLECTRIQUE 4 BROCHES F
420	AS2722810-SP	TRANSFORMATEUR	Not shown	PP0005000	FLOTTEUR MOTEUR
430	AS110162506	TUBE RÉTRACTABLE 20/6 (60MM)			

CODE **60140**

DESCRIPTION: **POOL CLEANER ULTRA 250**

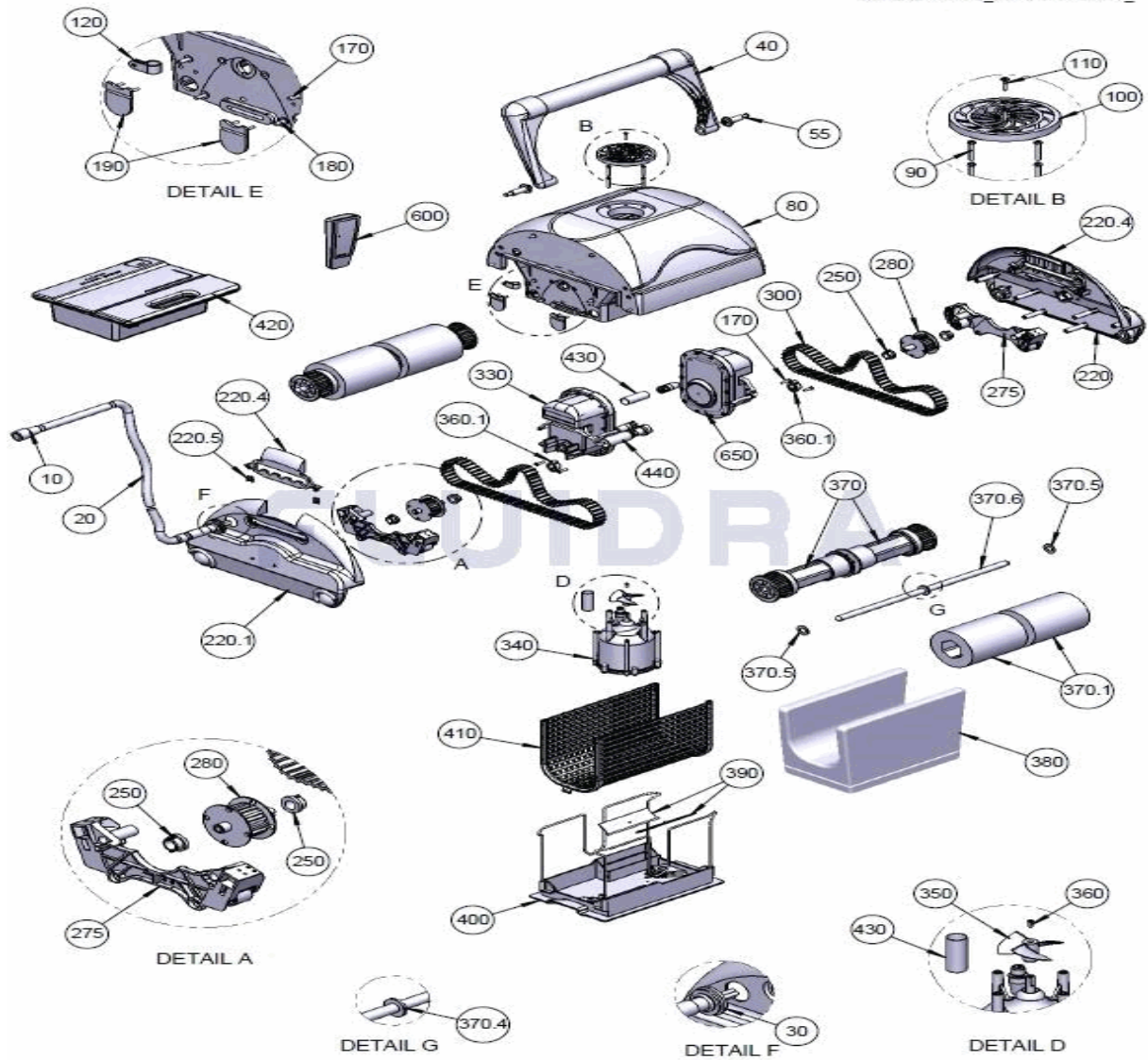

ENGLISH

POS	CODE	DESCRIPTION	QUANTITY	POS	CODE	DESCRIPTION	QUANTITY
10	ASPL00002M	4 PIN PLUG		220,4	5088BL	HANDLE LOCK	
20	WA00030CGL	FLOAT CABLE CG/30M/4C/EZ-SW/FAST		220,5	5087	SPRING	
30	PP0001623	SEALING GROMMET		250	2613	MOLYBDENUM BUSHING	
40	AS1049930	HANDLE ASSEMBLY		275	ASPP036200	TENSION SYSTEM	
55	SK00000BK	PIN ASSY FOR HANDLE		280	AS2000500	PULLEY ASSY	
80	AS1016220	BODY ASSY		300	RB00098GY	DRIVE BELT	
90	2500	SCREW 8X1,175 PH PN		330	AS08705-SP	DRIVE MOTOR	
100	5093CG	OUTLET TOP		340	AS00035R-SP	PUMP MOTOR	
110	5061	SCREW 6-32X5/8 S/S PH PA		350	P00038	PROPELLER	
120	2105	CABLE RETAINER SOPHIA		360	SW00069	SCRERW M-3X10 PHIL DIN-965	
170	2700	SCREW 8X11/16 PHIL PN		360,1	PP0004500	CASE FOR PIN	
180	2701	SCREW 8X11/16PHIL PN		370	A38223BL	WHEEL TUBE ASSY	
190	2305N	RUBBER VALVE		370,1	3009AG	PVA BRUSH	

CODE **60140**

DESCRIPTION: **POOL CLEANER ULTRA 250**

220	AS1066400	SIDE PLATE, ROUND,	370.4	A2607PK	DELRIN WASHER 4 PK
220.1	AS1066450	SIDE PLATE WITH HOLE	370.5	3603	FLAT DELRIN WASHER
370.6	MP00212	AXLE 413 MM FOR WHEEL	440	AS111161408	SHRINK TUBE 1614 (80MM)
380	8150	(not defined)	600	RC0100500	RC RES IDP INTEG RAD
390	9305B-NT	BOTTOM LID VALVE	650	AS08694-SP	SLAVE MOTOR
400	BS6100200	BOTTOM LID ASSY	Not shown	4613	GROOVE PIN 1/8X5/8 S/S
410	AS09240	FILTER SCREEN ASSY	Not shown	PL00008F	CONNECTOR 4 PIN FEMALE
420	AS2722810-SP	POWER SUPPLY	Not shown	PP0005000	FLOAT FOR MOTOR
430	AS110162506	SHRINK TUBE 20/6 (60MM)			

CODICE 60140

DESCRIZIONE: PULISCIFONDI ULTRA 250

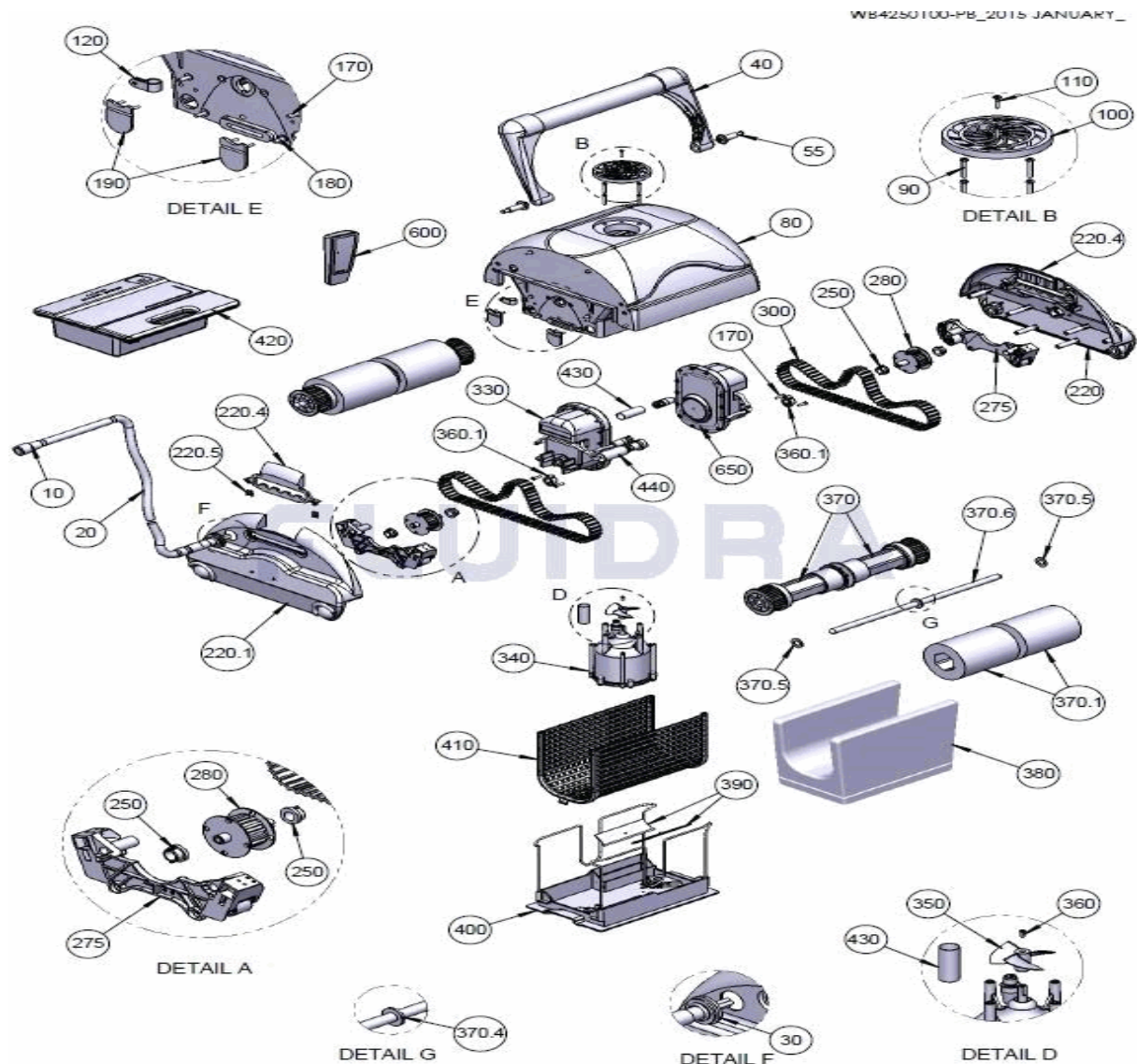

ITALIANO

POS	CODICE	DESCRIZIONE	QUANTITA'	POS	CODICE	DESCRIZIONE	QUANTITA'
10	ASPL00002M	PRESA A QUATTRO SPINE		220,4	5088BL	LEVA DI BLOCCO	
20	WA00030CGL	CAVO GALLEGGIANTE CG/30M/4C/EZ-SW/I		220,5	5087	MOLLA	
30	PP0001623	(not defined)		250	2613	BOCCOLA IN MOLYBDENUM	
40	AS1049930	INSIEME MANICO		275	ASPP036200	SISTEMA DI TENSORI	
55	SK00000BK	PASSANTE COMPLETO PER MANICO		280	AS2000500	BLOCCO PULEGGIA	
80	AS1016220	BLOCCO CORPO		300	RB00098GY	CINGHIA DI TRASMISSIONE	
90	2500	VITE 8X1,175 PH PN		330	AS08705-SP	MOTORE DI TRAZIONE	
100	5093CG	SORTIE SUPÉRIEURE		340	AS00035R-SP	INIETTORE A POMPA	
110	5061	VITE 6-32X5/8 S/S PH PA		350	P00038	ELICA	
120	2105	ATTACCO CAVO		360	SW00069	VITE M-3X10 PHIL DIN-965	
170	2700	VITE 8X11/16 PHIL PN		360,1	PP0004500	PERNO	
180	2701	VITE 8X11/16 PHIL PN		370	A38223BL	RULLO SPAZZOLA	
190	2305N	VALVOLA DI GOMMA		370,1	3009AG	SPAZZOLA PVA GRIGIO (VECCHIO)	

CODICE **60140**

DESCRIZIONE: **PULISCIFONDI ULTRA 250**

220	AS1066400	PLACCA LATERALE	370.4	A2607PK	RONDELLA ESTREMITÀ ALBERO
220.1	AS1066450	PLACCA LATERALE CON FORO	370.5	3603	RONDELLA INTERMEDIA DI ASSE
370.6	MP00212	ASSE RUOTE 413 MM	440	AS111161408	TUBO RETRACTIL 1614 (80MM)
380	8150	(not defined)	600	RC0100500	CONTROLLO REMOTO
390	9305B-NT	VALVOLA PLASTICA CHIUSURA FONDO	650	AS08694-SP	MOTORE SCHIAVO
400	BS6100200	BLOCCO COPERCHIO INFERIORE	Not shown	4613	COPPIGLIA CON SCANALATURA
410	AS09240	INSIEME GRIGLIA FILTRO	Not shown	PL00008F	CONNETTORE ELETTRICO 4 PIN FEMMINA
420	AS2722810-SP	TRASFORMATORE	Not shown	PP0005000	GALLEGGIANTE MOTORE
430	AS110162506	TUBO RETRACTIL 20/6 (60MM)			

CODE **60140**

BESCHREIBUNG: **BODENREINIGER ULTRA 250**

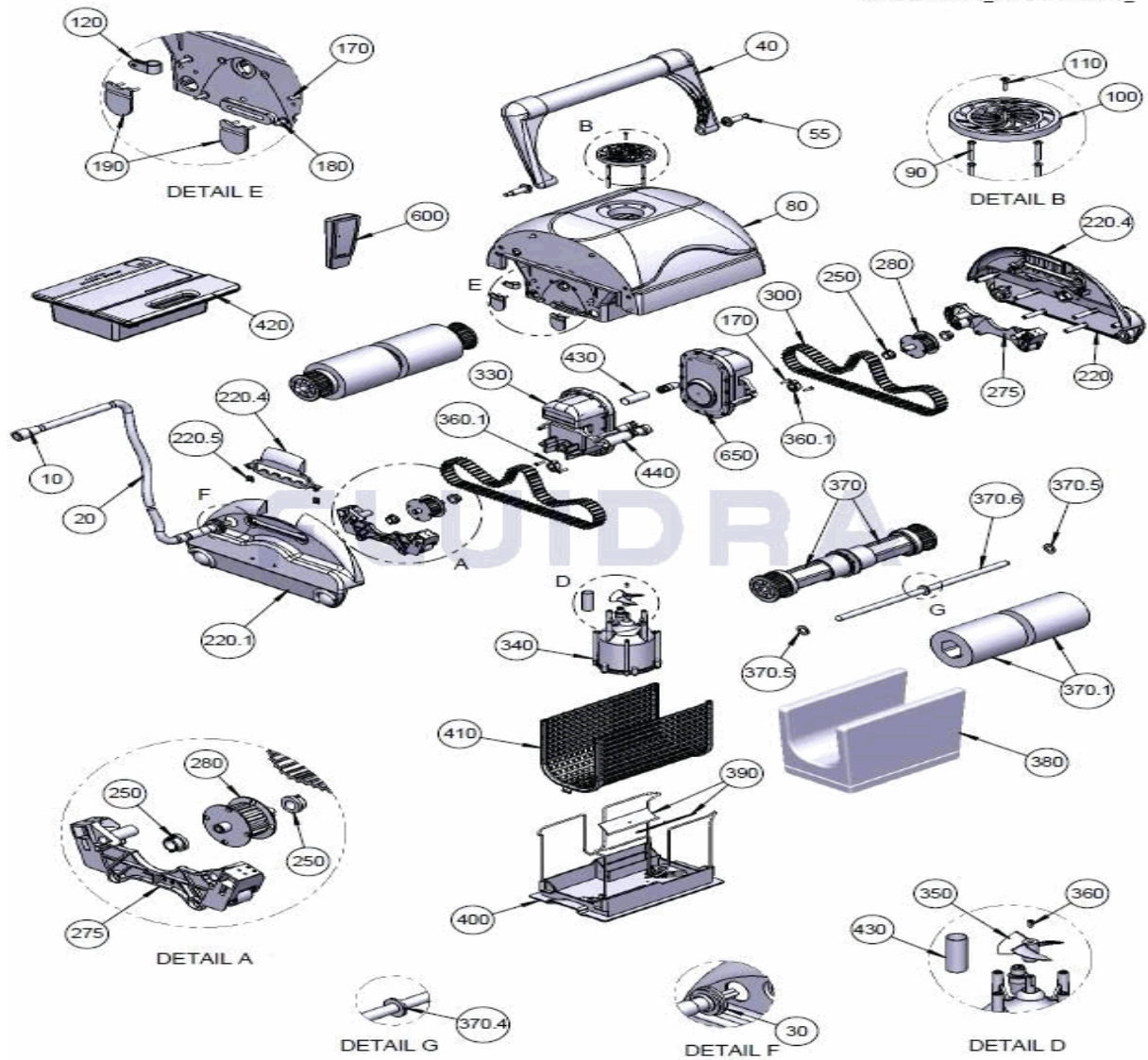

DEUTSCH

POS	CODE	BESCHREIBUNG	MENGE	POS	CODE	BESCHREIBUNG	MENGE
10	ASPL00002M	STECKDOSE 4 ANSCHLÜSSE		220,4	5088BL	SPERRVERRIEGELUNG	
20	WA00030CGL	SCHWIMMERKABEL CG/30M/4C/EZ-SW/FA'		220,5	5087	FEDER	
30	PP0001623	(not defined)		250	2613	WÄLZLAGER AXHSEN	
40	AS1049930	SET GRIFF		275	ASPP036200	SPANNSYSTEM	
55	SK00000BK	BÜGEL KOMPLETT FÜR GRIFF		280	AS2000500	ANTRIEBSSCHEIBE GERÄT	
80	AS1016220	GERÄTEGEHÄUSE		300	RB00098GY	ANTRIEBSRIEMEN	
90	2500	SCHRAUBE FÜR PUMPENMOTOR		330	AS08705-SP	ZUGMOTOR	
100	5093CG	OBERER ABZUG		340	AS00035R-SP	PUMP MOTOR	
110	5061	SCHRAUBE ABDECKUNG OBEN		350	P00038	ANTRIEBSSCHRAUBE	
120	2105	BEFESTIGUNG KABEL		360	SW00069	SCHRAUBE FÜR ANTRIEBSSCHRAUBE	
170	2700	SCHRAUBE OBEN SEITLICH		360,1	PP0004500	ABDECKUNG STIFT	
180	2701	SCHRAUBE UNTEN SEITLICH		370	A38223BL	BÜRSTENROLLE	
190	2305N	GUMMIVENTIL		370,1	3009AG	BÜRSTE PVA GRAU (VORVERSION)	

CODE **60140**

BESCHREIBUNG: **BODENREINIGER ULTRA 250**

220	AS1066400	SEITENPLAKETTE	370.4	A2607PK	WELLENENDWASCHMASCHINE
220.1	AS1066450	SEITLICHE PLAKETTE MIT LOCH	370.5	3603	UNTERLEGSCHEIBE MITTIG ACHSE
370.6	MP00212	ACHSE RÄDER 413 MM	440	AS111161408	EINLAUFROHR 1614 (80MM)
380	8150	(not defined)	600	RC0100500	FERNBEDIENUNG
390	9305B-NT	VENTIL KUNSTSTOFF SCHLIESSVORRICH	650	AS08694-SP	HILFSMOTOR
400	BS6100200	SET ABDECKUNG UNTEN	Not shown	4613	STIFT MIT SCHLITZ
410	AS09240	SET GITTERFILTER	Not shown	PL00008F	ELEKTRISCHER VERBINDER 4 PIN WEIBLIC
420	AS2722810-SP	TRANSFORMATOR	Not shown	PP0005000	SCHWIMMTEIL MOTOR
430	AS110162506	EINLAUFROHR 20/6 (60MM)			

CODIGO **60140**

DESCRIÇÃO: LIMPADOR DE FUNDOS ULTRA 250

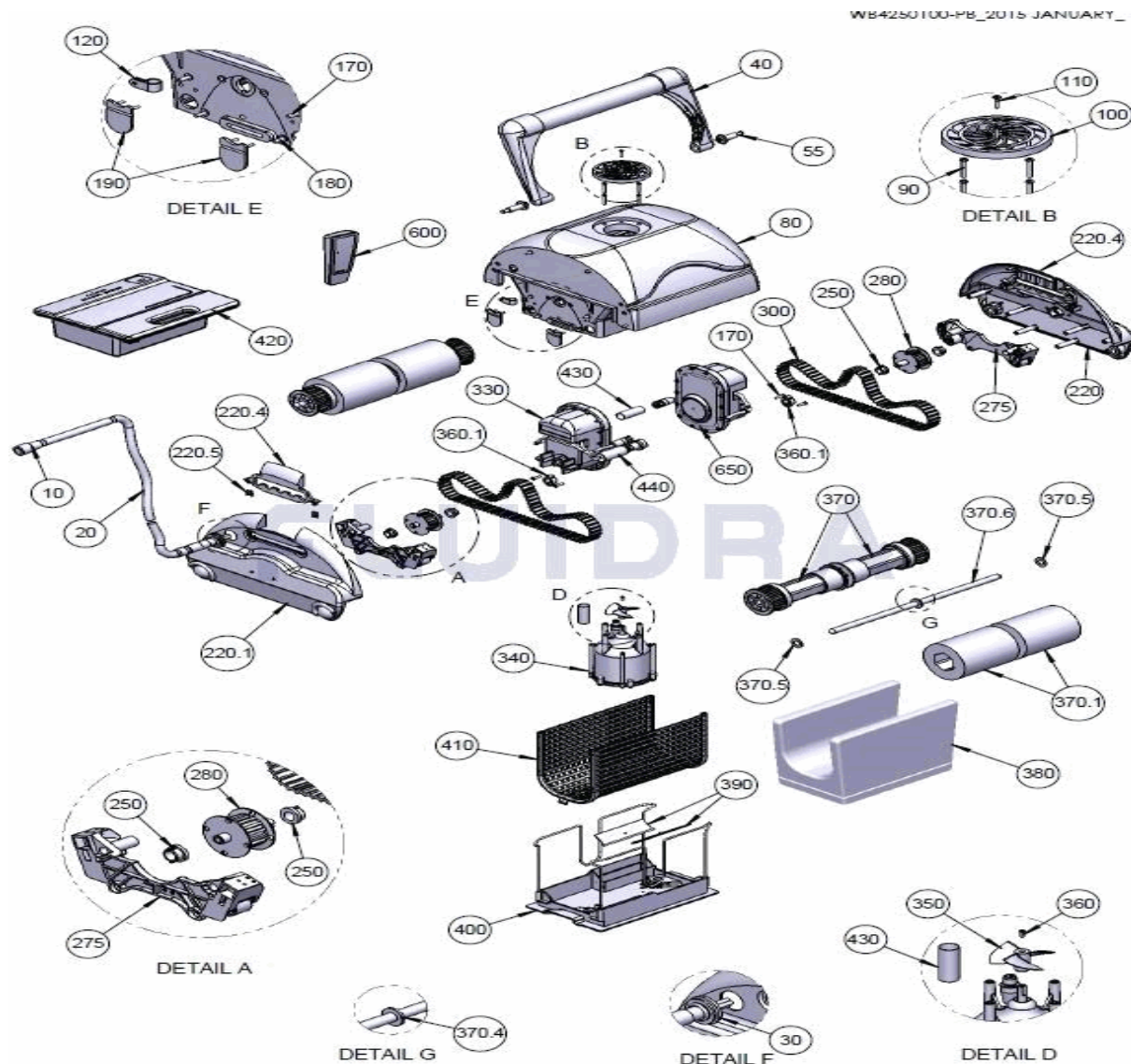

PORTUGUES

POS	CODIGO	DESCRIÇÃO	JANTIDADE	POS	CODIGO	DESCRIÇÃO	JANTIDADE
10	ASPL00002M	FICHA DE 4 PINOS		220,4	5088BL	ALAVANCA DE BLOQUEIO	
20	WA00030CGL	CONJUNTO CABO BOIA CG/30M/4C/EZ-SW		220,5	5087	MOLA	
30	PP0001623	(not defined)		250	2613	BUCHA MOLIBDÉNIO	
40	AS1049930	CONJUNTO PEGA		275	ASPP036200	SISTEMA DE TENSORES	
55	SK00000BK	PASSADOR COMPLETO PARA PEGA		280	AS2000500	CONJUNTO ROLDANA	
80	AS1016220	CONJUNTO CORPO		300	RB00098GY	CORREIA DE TRANSMISSÃO	
90	2500	PARAFUSO 8 X 1,175 PH PN		330	AS08705-SP	MOTOR DE TRACÇÃO	
100	5093CG	SORTIE SUPÉRIEURE		340	AS00035R-SP	BOMBA MOTOR	
110	5061	PARAFUSO 6-32 X 5/8 S/S PH PA		350	P00038	HÉLICE	
120	2105	FIXAÇÃO CABO		360	SW00069	PARAFUSO M-3 X 10 PHIL DIN-965	
170	2700	PARAFUSO 8 X 11/16 PHIL PN		360,1	PP0004500	ENCAIXE PARA PINO	
180	2701	PARAFUSO 8 X 11/16 PHIL PN		370	A38223BL	CILINDRO ESCOVA	
190	2305N	VÁLVULA DE BORRACHA		370,1	3009AG	ESCOVA PVA CINZENTA (ANTIGA)	

CODIGO 60140

DESCRIÇÃO: LIMPADOR DE FUNDOS ULTRA 250

220	AS1066400	PLACA LATERAL	370.4	A2607PK	LAVADORA DE EXTREMIDADE DO EIXO
220.1	AS1066450	PLACA LATERAL COM ORIFÍCIO	370.5	3603	ANILHA INTERMÉDIA DO EIXO
370.6	MP00212	EIXO RODAS 413 MM	440	AS111161408	TUBO ENCOLHÍVEL 1614 (80MM)
380	8150	(not defined)	600	RC0100500	CONTROLO REMOTO
390	9305B-NT	VÁLVULA PLÁSTICA FECHO FUNDO	650	AS08694-SP	MOTOR ESCRAVO
400	BS6100200	CONJUNTO TAMPA INFERIOR	Not shown	4613	PASSADOR COM RANHURA
410	AS09240	CJTO. GRELHA FILTRO	Not shown	PL00008F	FICHA DE 4 PINOS FÊMEA
420	AS2722810-SP	TRANSFORMADOR	Not shown	PP0005000	BOIA MOTOR
430	AS110162506	TUBO ENCOLHÍVEL 20/6 (60MM)			