

CODIGO **60140**

DESCRIPCION: LIMPIAFONDOS ULTRA 250

RECS-MGJ0-U2513 (2016)

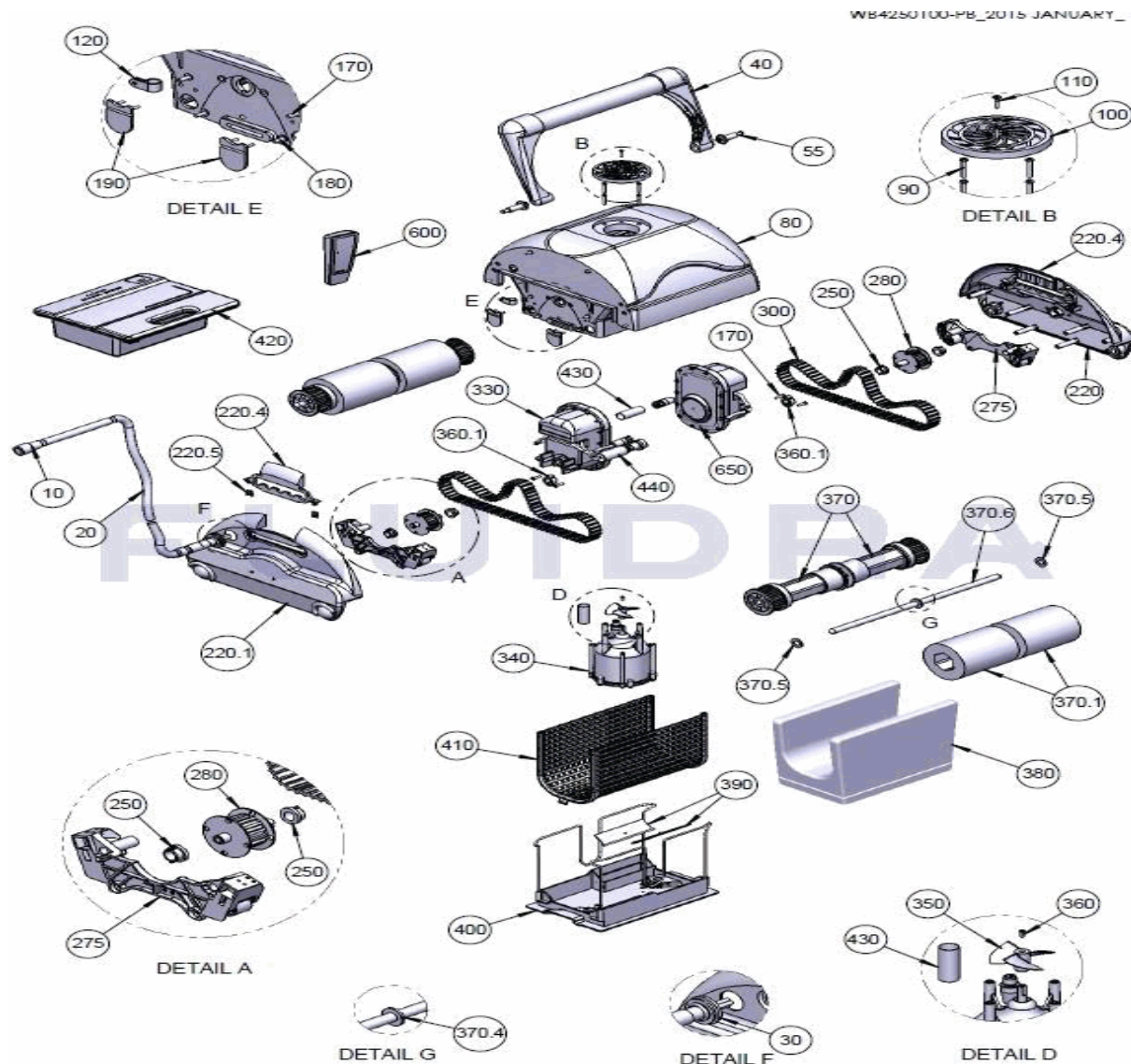

**ESPAÑOL**

POS	CODIGO	DESCRIPCION	CANTIDAD	POS	CODIGO	DESCRIPCION	CANTIDAD
10	PL00002M	ENCHUFE 4 TERMINALES		220,4	5088B	PALANCA DE BLOQUEO	
20	WA00030CGL	CABLE FLOTADOR CG/30M/4C/EZ-SW/FAS		220,5	5087	MUELLE	
30	1623	TUERCA FIJACIÓN CABLE		250	2613	RODAMIENTO DE EJES	
40	AS1049930	CONJUNTO MANGO		275	ASPP036200	SISTEMA DE TENSORES	
55	SK00000BK	PASADOR COMPLETO PARA MANGO		280	AS2000500	CONJUNTO POLEA	
80	AS1016220	CUERPO COMPLETO		300	RB00098	CORREA DE TRACCIÓN	
90	2500	TORNILLO PARA MOTOR BOMBA		330	AS08705-SP	MOTOR DE TRACCION	
100	5093CG	TAPA SUPERIOR		340	AS00035R-SP	MOTOR DE BOMBEO	
110	5061	TORNILLO DE TAPA SUPERIOR		350	P00038	HELICE	
120	2105	SUJECION CABLE		360	SW00069	TORNILLO PARA HELICE	
170	2700	TORNILLO SUPERIOR LATERAL		360,1	PP0004500	CUBIERTA DEL PASADOR	
180	2701	TORNILLO INFERIOR LATERAL		370	A38223BL	RODILLO CEPILLO	
190	2305N	VALVULA DE GOMA		370,1	3009A	CEPILLO PVA	

CODIGO **60140**

DESCRIPCION: LIMPIAFONDOS ULTRA 250

**RECS-MGJ0-U2513 (2016)**

220	AS1066400	PLACA LATERAL	370,4	2607	ARANDELA EXTREMOS EJE
220,1	AS1066450	PLACA LATERAL CON AGUJERO	370,5	3603	ARANDELA INTERMEDIA DE EJE
370,6	MP00233	EJE 410 MM 1/2" S/S 304"	440	AS110161408	TUBO RETRÁCTIL 33/8
380	8100S	BOLSA FILTRO	600	RC0100500	CONTROL REMOTO
390	9305B-NT	VALVULA PLASTICA CIERRE FONDO	650	AS08694-SP	MOTOR ESCLAVO
400	BS6100200	CONJUNTO TAPA INFERIOR	shown	4613	PASADOR CON RANURA
410	AS09240	CJTO. REJILLA FILTRO	shown	PL00008F	CONECTOR ELECTRICO 4 PIN HEMBRA
420	AS2722810-SP	TRANSFORMADOR	shown	PP0005000	FLOTADOR MOTOR
430	AS110162506	TUBO RETRACTIL 20/6 (60mm)			

CODE **60140**

DESCRIPTION: **NETTOYEUR DE FOND ULTRA 250**

**RECS-MGJ0-U2513 (2016)**

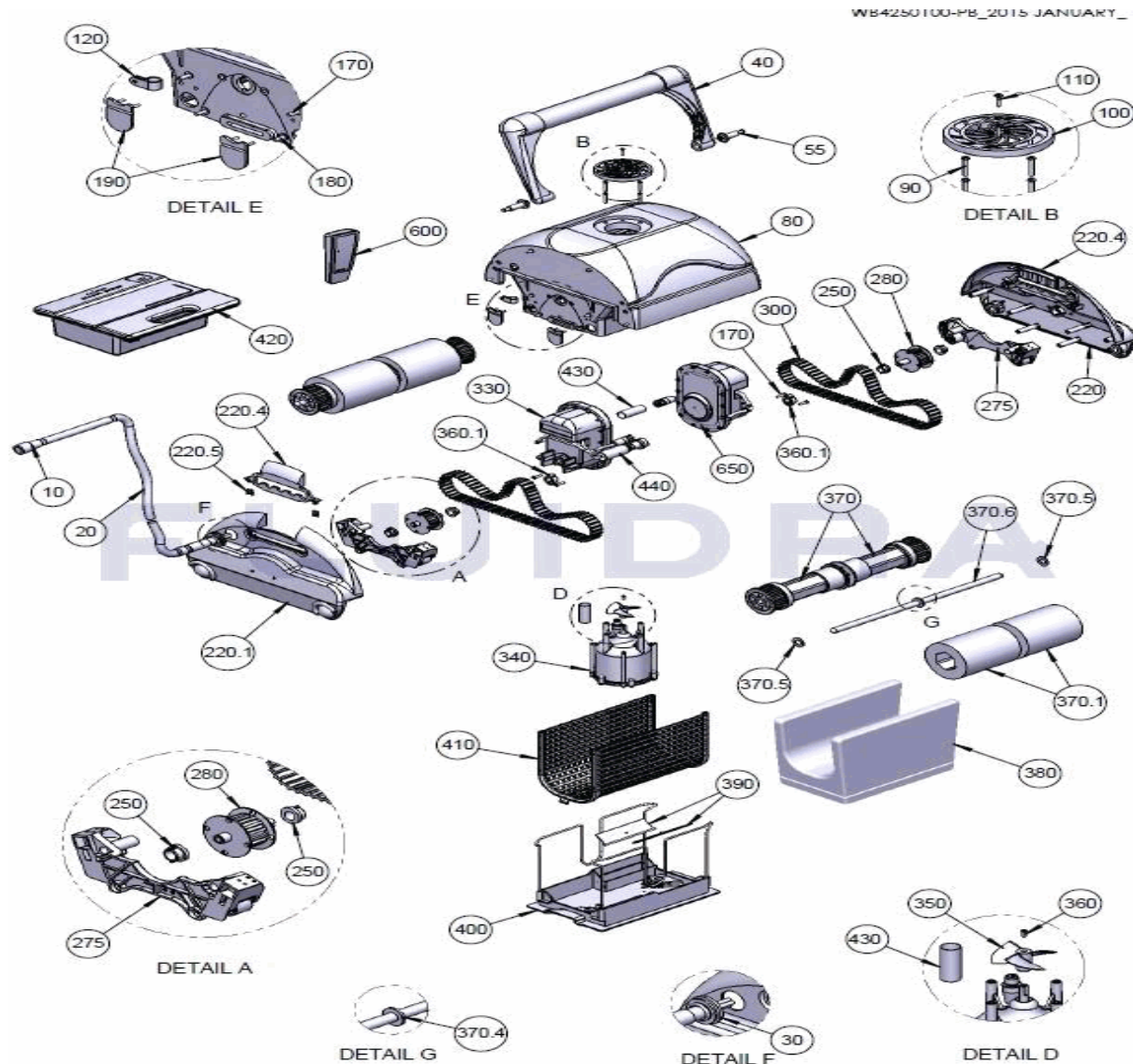

**FRANCAIS**

POS	CODE	DESCRIPTION	QUANTITE	POS	CODE	DESCRIPTION	QUANTITE
10	PL00002M	PRISE À 4 FICHES		220,4	5088B	LEVIER DE BLOCAGE	
20	WA00030CGL	CÂBLE FLOTTANT CG/30M/4C/EZ-SW/FAST		220,5	5087	RESSORT	
30	1623	ÉCROU FIXATION CÂBLE		250	2613	BAGUE EN MOLYBDÈNE	
40	AS1049930	ENSEMBLE MANCHE		275	ASPP036200	SYSTÈME DE TENSION	
55	SK00000BK	BROCHE COMPLÈTE POUR MANCHE		280	AS2000500	ENSEMBLE POULIE	
80	AS1016220	ENSEMBLE CORPS		300	RB00098	COURROIE DE TRACTION	
90	2500	VIS 8X1,175 PH PN		330	AS08705-SP	MOTEUR DE TRACTION	
100	5093CG	SORTIE SUPÉRIEURE		340	AS00035R-SP	MOTEUR DE LA POMPE	
110	5061	VIS 6-32X5/8 S/S PH PA		350	P00038	HÉLICE	
120	2105	FIXATION CÂBLE		360	SW00069	VIS M-3X10 PHIL DIN-965	
170	2700	VIS 8X11/16 PHIL PN		360,1	PP0004500	LOGEMENT DE TIGE	
180	2701	VIS 8X11/16PHIL PN		370	A38223BL	ROULEAU BROSSE	
190	2305N	VALVE CAOUTCHOUTÉE		370,1	3009A	BROSSE PVA	

CODE **60140**

DESCRIPTION: **NETTOYEUR DE FOND ULTRA 250**

**RECS-MGJ0-U2513 (2016)**

220	AS1066400	PLAQUE LATÉRALE	370,4	2607	RONDELLE EXTRÉMITÉS AXE
220,1	AS1066450	PLAQUE LATÉRALE AVEC ORIFICE	370,5	3603	RONDELLE INTERMÉDIAIRE AXE
370,6	MP00233	AXE 410 MM 1/2" S/S 304"	440	AS110161408	TUBE RÉTRACTABLE 33/8
380	8100S	SAC FILTRANT	600	RC0100500	TÉLÉCOMMANDE
390	9305B-NT	VANNE PLASTIQUE FERMETURE FOND	650	AS08694-SP	MOTEUR ESCLAVE
400	BS6100200	ENSEMBLE COUVERCLE INFÉRIEUR	shown	4613	GOUPILLE À RAINURE
410	AS09240	ENS. GRILLE ET FILTRE	shown	PL00008F	CONNECTEUR ÉLECTRIQUE 4 BROCHES F
420	AS2722810-SP	TRANSFORMATEUR	shown	PP0005000	FLOTTEUR MOTEUR
430	AS110162506	TUBE RÉTRACTABLE 20/6 (60MM)			

CODE **60140**

DESCRIPTION: **POOL CLEANER ULTRA 250**

**RECS-MGJ0-U2513 (2016)**

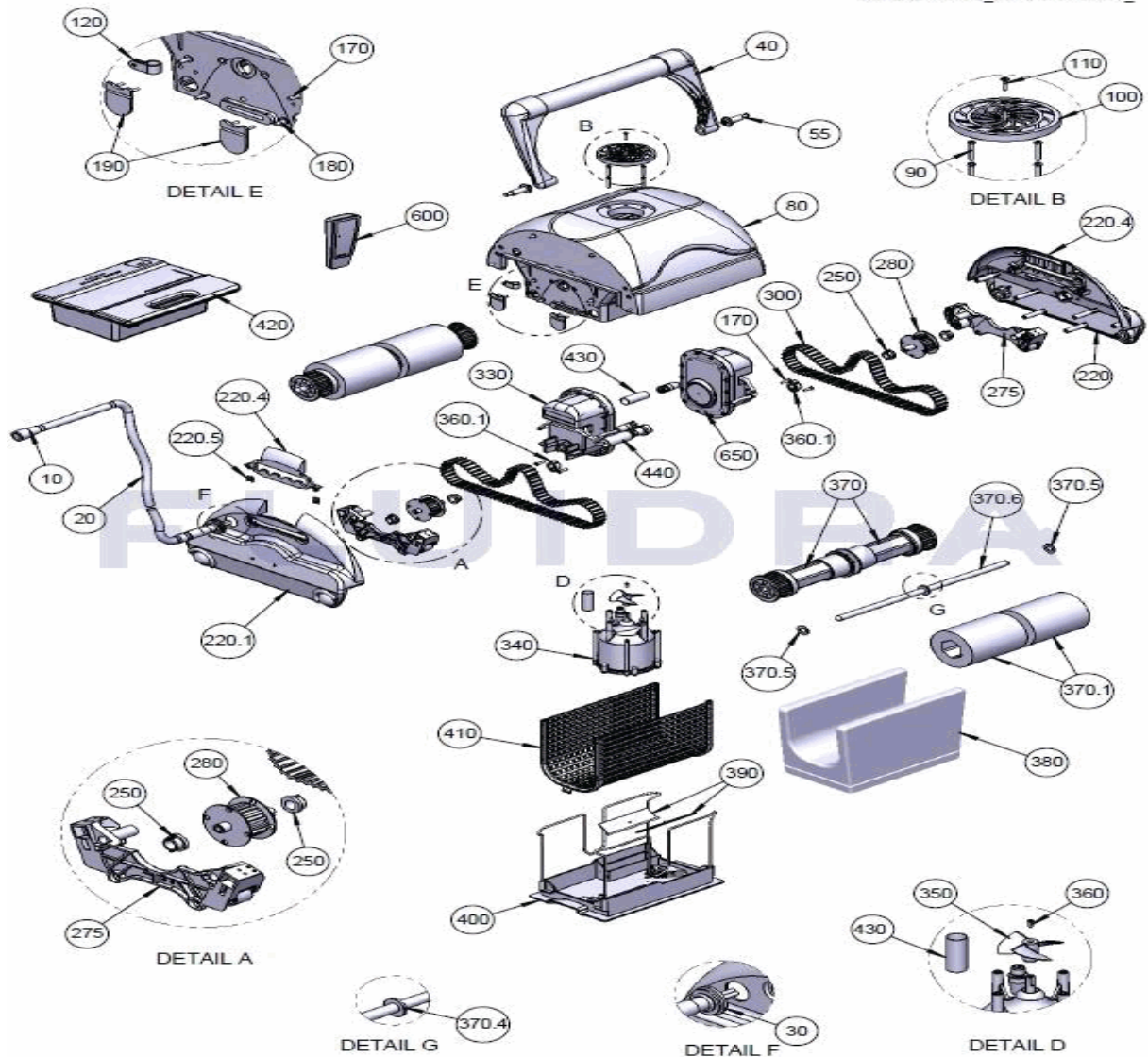

**ENGLISH**

POS	CODE	DESCRIPTION	QUANTITY	POS	CODE	DESCRIPTION	QUANTITY
10	PL00002M	4 PIN PLUG		220,4	5088B	HANDLE LOCK	
20	WA00030CGL	FLOAT CABLE CG/30M/4C/EZ-SW/FAST		220,5	5087	SPRING	
30	1623	SEALING GROMMET		250	2613	MOLYBDENUM BUSHING	
40	AS1049930	HANDLE ASSEMBLY		275	ASPP036200	TENSION SYSTEM	
55	SK00000BK	PIN ASSY FOR HANDLE		280	AS2000500	PULLEY ASSY	
80	AS1016220	BODY ASSY		300	RB00098	DRIVE BELT	
90	2500	SCREW 8X1,175 PH PN		330	AS08705-SP	DRIVE MOTOR	
100	5093CG	OUTLET TOP		340	AS00035R-SP	PUMP MOTOR	
110	5061	SCREW 6-32X5/8 S/S PH PA		350	P00038	PROPELLER	
120	2105	CABLE RETAINER SOPHIA		360	SW00069	SCRERW M-3X10 PHIL DIN-965	
170	2700	SCREW 8X11/16 PHIL PN		360,1	PP0004500	CASE FOR PIN	
180	2701	SCREW 8X11/16PHIL PN		370	A38223BL	WHEEL TUBE ASSY	
190	2305N	RUBBER VALVE		370,1	3009A	PVA BRUSH	

CODE                    **60140**

DESCRIPTION: **POOL CLEANER ULTRA 250**

**RECS-MGJ0-U2513 (2016)**

220	AS1066400	SIDE PLATE, ROUND,	370,4	2607	DELRIN WASHER
220,1	AS1066450	SIDE PLATE WITH HOLE	370,5	3603	FLAT DELRIN WASHER
370,6	MP00233	AXLE 410 MM 1/2" S/S 304"	440	AS110161408	SHRINK TUBE 33/8
380	8100S	FILTER BAG	600	RC0100500	RC RES IDP INTEG RAD
390	9305B-NT	BOTTOM LID VALVE	650	AS08694-SP	SLAVE MOTOR
400	BS6100200	BOTTOM LID ASSY	shown	4613	GROOVE PIN 1/8X5/8 S/S
410	AS09240	FILTER SCREEN ASSY	shown	PL00008F	CONNECTOR 4 PIN FEMALE
420	AS2722810-SP	POWER SUPPLY	shown	PP0005000	FLOAT FOR MOTOR
430	AS110162506	SHRINK TUBE 20/6 (60MM)			

CODICE **60140**

DESCRIZIONE: **PULISCIFONDI ULTRA 250**

**RECS-MGJ0-U2513 (2016)**

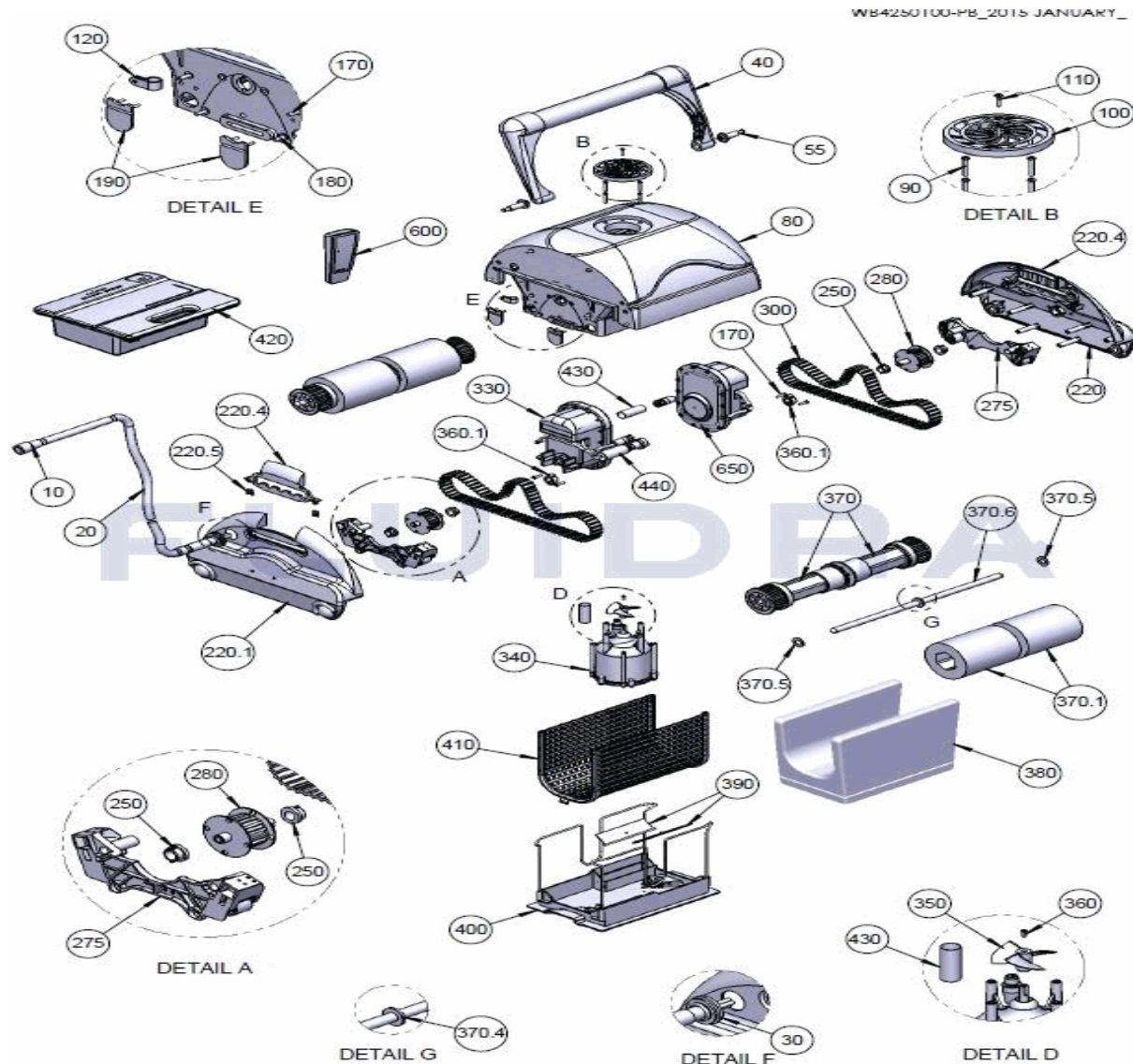

**ITALIANO**

POS	CODICE	DESCRIZIONE	QUANTITA'	POS	CODICE	DESCRIZIONE	QUANTITA'
10	PL00002M	PRESA A QUATTRO SPINE		220,4	5088B	LEVA DI BLOCCO	
20	WA00030CGL	CAVO GALLEGGIANTE CG/30M/4C/EZ-SW/I		220,5	5087	MOLLA	
30	1623	OCCHIELLO SIGILLANTE		250	2613	BOCCOLA IN MOLYBDENUM	
40	AS1049930	INSIEME MANICO		275	ASPP036200	SISTEMA DI TENSORI	
55	SK00000BK	PASSANTE COMPLETO PER MANICO		280	AS2000500	BLOCCO PULEGGIA	
80	AS1016220	BLOCCO CORPO		300	RB00098	CINGHIA DI TRASMISSIONE	
90	2500	VITE 8X1,175 PH PN		330	AS08705-SP	MOTORE DI TRAZIONE	
100	5093CG	SORTIE SUPÉRIEURE		340	AS00035R-SP	INIETTORE A POMPA	
110	5061	VITE 6-32X5/8 S/S PH PA		350	P00038	ELICA	
120	2105	ATTACCO CAVO		360	SW00069	VITE M-3X10 PHIL DIN-965	
170	2700	VITE 8X11/16 PHIL PN		360,1	PP0004500	PERNO	
180	2701	VITE 8X11/16 PHIL PN		370	A38223BL	RULLO SPAZZOLA	
190	2305N	VALVOLA DI GOMMA		370,1	3009A	SPAZZOLA PVA	

**CODICE 60140**
**DESCRIZIONE: PULISCIFONDI ULTRA 250**
**RECS-MGJ0-U2513 (2016)**

220	AS1066400	PLACCA LATERALE	370,4	2607	RONDELLA ESTREMI ASSE
220,1	AS1066450	PLACCA LATERALE CON FORO	370,5	3603	RONDELLA INTERMEDIA DI ASSE
370,6	MP00233	ASSE 410 MM 1 /2" S/S 304	440	AS110161408	TUBO RETRÁCTIL 33/8
380	8100S	BORSA FILTRO	600	RC0100500	CONTROLLO REMOTO
390	9305B-NT	VALVOLA PLASTICA CHIUSURA FONDO	650	AS08694-SP	MOTORE SCHIAVO
400	BS6100200	BLOCCO COPERCHIO INFERIORE	shown	4613	COPPIGLIA CON SCANALATURA
410	AS09240	INSIEME GRIGLIA FILTRO	shown	PL00008F	CONNETTORE ELETTRICO 4 PIN FEMMINA
420	AS2722810-SP	TRASFORMATORE	shown	PP0005000	GALLEGGIANTE MOTORE
430	AS110162506	TUBO RETRACTIL 20/6 (60MM)			





CODE **60140**

BESCHREIBUNG: **BODENREINIGER ULTRA 250**

**RECS-MGJ0-U2513 (2016)**

220	AS1066400	SEITENPLAKETTE	370,4	2607	UNTERLEGSCHEIBE ACHSENENDSTÜCKE
220,1	AS1066450	SEITLICHE PLAKETTE MIT LOCH	370,5	3603	UNTERLEGSCHEIBE MITTIG ACHSE
370,6	MP00233	ACHSE 410 MM 1/2" S/S 304"	440	AS110161408	ROHR 33/8
380	8100S	FILTERBEUTEL	600	RC0100500	FERNBEDIENUNG
390	9305B-NT	VENTIL KUNSTSTOFF SCHLIESSVORRICHT	650	AS08694-SP	HILFSMOTOR
400	BS6100200	SET ABDECKUNG UNTEN	shown	4613	STIFT MIT SCHLITZ
410	AS09240	SET GITTERFILTER	shown	PL00008F	ELEKTRISCHER VERBINDER 4 PIN WEIBLIC
420	AS2722810-SP	TRANSFORMATOR	shown	PP0005000	SCHWIMMTEIL MOTOR
430	AS110162506	EINLAUFROHR 20/6 (60MM)			

**CODIGO 60140**

**DESCRIÇÃO: LIMPADOR DE FUNDOS ULTRA 250**

**RECS-MGJ0-U2513 (2016)**

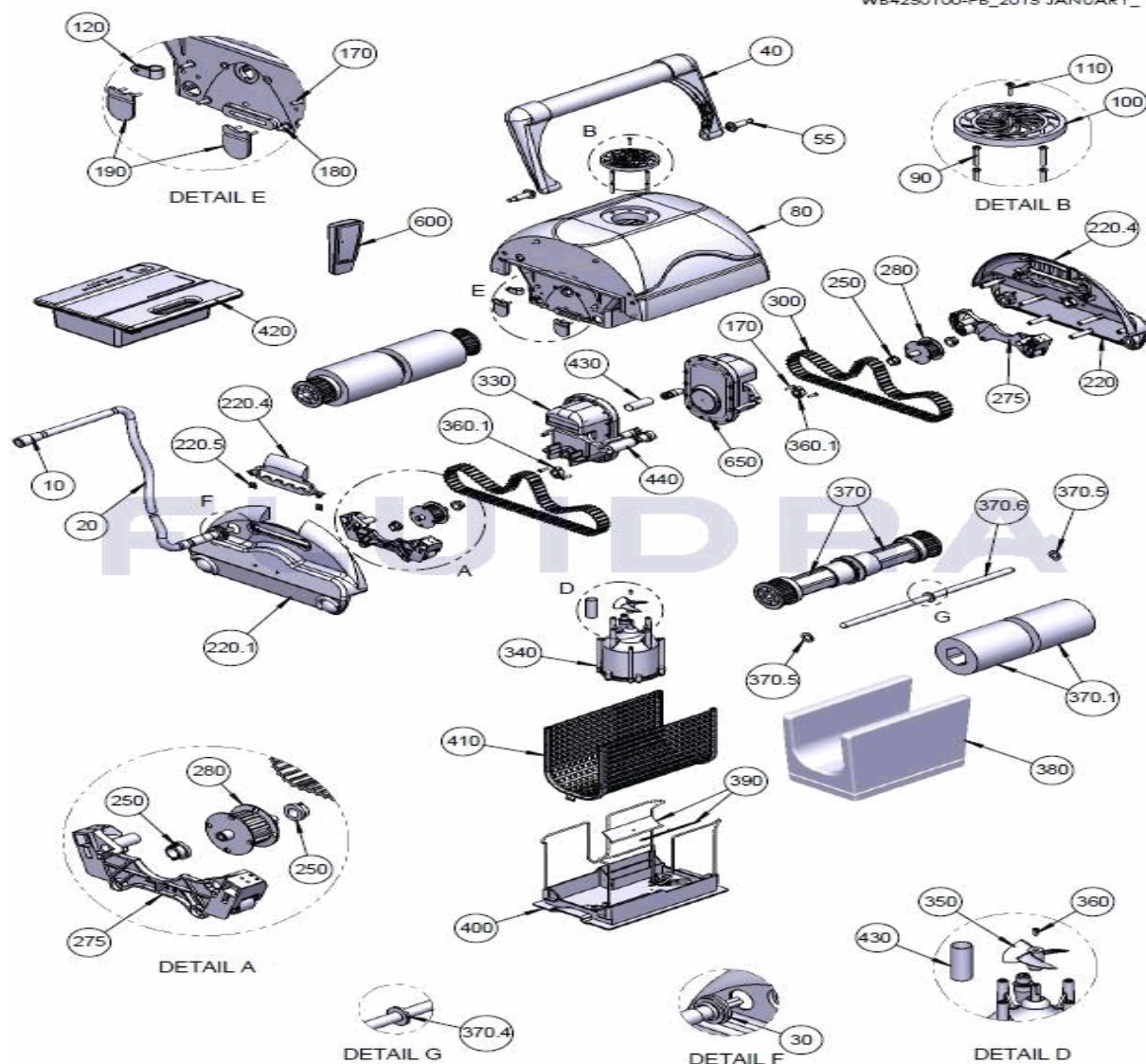

**PORTUGUES**

POS	CODIGO	DESCRIÇÃO	JANTIDADE	POS	CODIGO	DESCRIÇÃO	JANTIDADE
10	PL00002M	FICHA DE 4 PINOS		220,4	5088B	ALAVANCA DE BLOQUEIO	
20	WA00030CGL	CONJUNTO CABO BOIA CG/30M/4C/EZ-SW		220,5	5087	MOLA	
30	1623	ANEL ISOLANTE		250	2613	BUCHA MOLIBDÉNIO	
40	AS1049930	CONJUNTO PEGA		275	ASPP036200	SISTEMA DE TENSORES	
55	SK00000BK	PASSADOR COMPLETO PARA PEGA		280	AS2000500	CONJUNTO ROLDANA	
80	AS1016220	CONJUNTO CORPO		300	RB00098	CORREIA DE TRANSMISSÃO	
90	2500	PARAFUSO 8 X 1,175 PH PN		330	AS08705-SP	MOTOR DE TRACÇÃO	
100	5093CG	SORTIE SUPÉRIEURE		340	AS00035R-SP	BOMBA MOTOR	
110	5061	PARAFUSO 6-32 X 5/8 S/S PH PA		350	P00038	HÉLICE	
120	2105	FIXAÇÃO CABO		360	SW00069	PARAFUSO M-3 X 10 PHIL DIN-965	
170	2700	PARAFUSO 8 X 11/16 PHIL PN		360,1	PP0004500	ENCAIXE PARA PINO	
180	2701	PARAFUSO 8 X 11/16 PHIL PN		370	A38223BL	CILINDRO ESCOVA	
190	2305N	VÁLVULA DE BORRACHA		370,1	3009A	ESCOVA PVA	

**CODIGO 60140**

**DESCRIÇÃO: LIMPADOR DE FUNDOS ULTRA 250**

**RECS-MGJ0-U2513 (2016)**

220	AS1066400	PLACA LATERAL	370,4	2607	ANILHA EXTREMIDADES DO EIXO
220,1	AS1066450	PLACA LATERAL COM ORIFÍCIO	370,5	3603	ANILHA INTERMÉDIA DO EIXO
370,6	MP00233	EIXO 410 MM 1/2" S/S 304"	440	AS110161408	TUBO ENCOLHÍVEL 33/8
380	8100S	BOLSA FILTRO	600	RC0100500	CONTROLO REMOTO
390	9305B-NT	VÁLVULA PLÁSTICA FECHO FUNDO	650	AS08694-SP	MOTOR ESCRAVO
400	BS6100200	CONJUNTO TAMPA INFERIOR	shown	4613	PASSADOR COM RANHURA
410	AS09240	CJTO. GRELHA FILTRO	shown	PL00008F	FICHA DE 4 PINOS FÊMEA
420	AS2722810-SP	TRANSFORMADOR	shown	PP0005000	BOIA MOTOR
430	AS110162506	TUBO ENCOLHÍVEL 20/6 (60MM)			