

CODE **60165**

BESCHREIBUNG: **BODENREINIGER ULTRA 125**

RECS-BRA0-U2513 (2016)

WB4250050-PB_2015 JANUARY

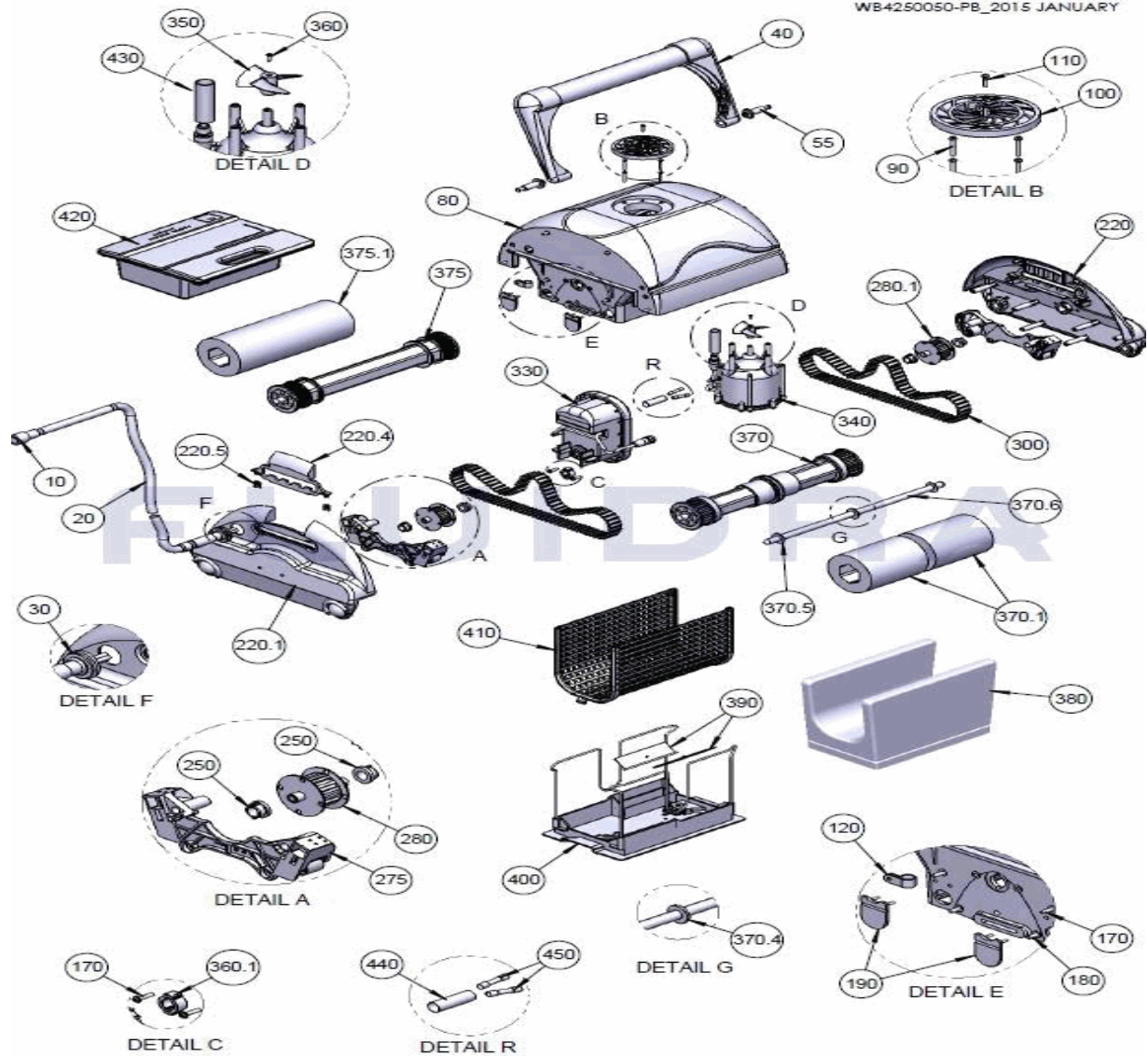

DEUTSCH

POS	CODE	BESCHREIBUNG	MENGE	POS	CODE	BESCHREIBUNG	MENGE
10	PL00002M	STECKDOSE 4 ANSCHLÜSSE		220,4	5088B	SPERRVERRIEGELUNG	
20	WA00123CGL	SCHWIMMERKABEL CG/23M/2C/EZ-SW		250	2613	WÄLZLAGER AXHSEN	
30	1623	FIXIERMUTTER KABEL		275	ASPP036200	SPANNSYSTEM	
40	AS1049930	SET GRIFF		280	AS2000500	ANTRIEBSSCHEIBE GERÄT	
55	SK00000BK	BÜGEL KOMPLETT FÜR GRIFF		280,1	AS2000500A	SET ROLLE	
80	AS1016220	GERÄTEGEHÄUSE		300	RB00098	ANTRIEBSRIEMEN	
90	2500	SCHRAUBE FÜR PUMPENMOTOR		330	AS08710-SP	ZUGMOTOR	
100	5093CG	OBERER ABZUG		340	AS00035R-SP	PUMP MOTOR	
110	5061	SCHRAUBE ABDECKUNG OBEN		350	P00038	ANTRIEBSSCHRAUBE	
120	HW0006700	BEFESTIGUNG KABEL		360	SW00069	SCHRAUBE FÜR ANTRIEBSSCHRAUBE	
170	2700	SCHRAUBE OBEN SEITLICH		360,1	PP0004500	ABDECKUNG STIFT	
180	2701	SCHRAUBE UNTEN SEITLICH		370	A38223BL	BÜRSTENROLLE	
190	2305N	GUMMIVENTIL		370,1	3009A	PVA-BÜRSTE	

CODE **60165**

BESCHREIBUNG: **BODENREINIGER ULTRA 125**

RECS-BRA0-U2513 (2016)

220	AS1066400	SEITENPLAKETTE	370,4	2607	UNTERLEGSCHEIBE ACHSENENDSTÜCKE
220,1	AS1066450	SEITLICHE PLAKETTE MIT LOCH	370,5	3603	UNTERLEGSCHEIBE MITTIG ACHSE
370,6	MP00233	ACHSE 410 MM 1/2" S/S 304"	430	AS110162506	EINLAUFROHR 20/6 (60MM)
375	AS38249BL	LAUFROLLE	440	AS110011010	ROHR 16/4 WCSM
375,1	PP03009BL	PVA-BÜRSTE	450	5473	VERBINDUNGSSTÜCK ROT
380	8100S	FILTERBEUTEL	550,1	SW00008	SCHRAUBE PT KB40 X 12 S/S 304
390	9305B-NT	VENTIL KUNSTSTOFF SCHLISSVORRICHT	shown	PP0005108	SCHWIMMER OVAL
400	BS6100200	SET ABDECKUNG UNTEN	shown	4613	STIFT MIT SCHLITZ
410	AS09240	SET GITTERFILTER	shown	XW0100400	NIETE KUNSTSTOFF 28 MM
420	AS2722402-SP	TRAFO BASIC 180 W GRAU			

CODE **60165**

DESCRIPTION: **POOL CLEANER ULTRA 125**

RECS-BRA0-U2513 (2016)

WB4250050-PB_2015 JANUARY

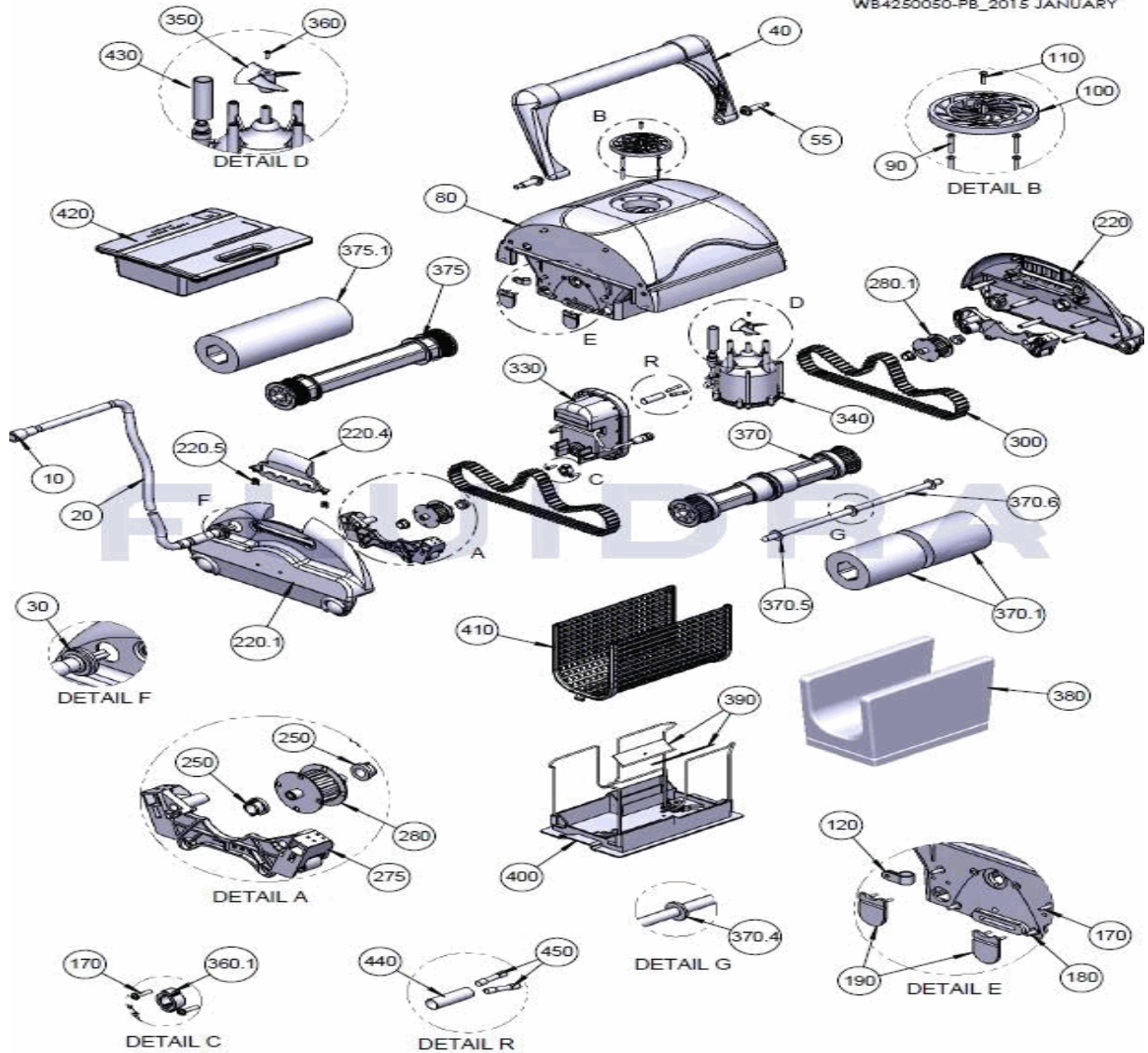

ENGLISH

POS	CODE	DESCRIPTION	QUANTITY	POS	CODE	DESCRIPTION	QUANTITY
10	PL00002M	4 PIN PLUG		220,4	5088B	HANDLE LOCK	
20	WA00123CGL	FLOAT CABLE CG/23M/2C/EZ-SW		250	2613	MOLYBDENUM BUSHING	
30	1623	SEALING GROMMET		275	ASPP036200	TENSION SYSTEM	
40	AS1049930	HANDLE ASSEMBLY		280	AS2000500	PULLEY ASSY	
55	SK00000BK	PIN ASSY FOR HANDLE		280,1	AS2000500A	PULLEY ASSY SHORT	
80	AS1016220	BODY ASSY		300	RB00098	DRIVE BELT	
90	2500	SCREW 8X1,175 PH PN		330	AS08710-SP	DRIVE MOTOR	
100	5093CG	OUTLET TOP		340	AS00035R-SP	PUMP MOTOR	
110	5061	SCREW 6-32X5/8 S/S PH PA		350	P00038	PROPELLER	
120	HW0006700	CABLE RETAINER SOPHIA		360	SW00069	SCRERW M-3X10 PHIL DIN-965	
170	2700	SCREW 8X11/16 PHIL PN		360,1	PP0004500	CASE FOR PIN	
180	2701	SCREW 8X11/16PHIL PN		370	A38223BL	WHEEL TUBE ASSY	
190	2305N	RUBBER VALVE		370,1	3009A	PVA BRUSH	

CODE **60165**

DESCRIPTION: **POOL CLEANER ULTRA 125**

RECS-BRA0-U2513 (2016)

220	AS1066400	SIDE PLATE, ROUND,	370,4	2607	DELRIN WASHER
220,1	AS1066450	SIDE PLATE WITH HOLE	370,5	3603	FLAT DELRIN WASHER
370,6	MP00233	AXLE 410 MM 1/2" S/S 304"	430	AS110162506	SHRINK TUBE 20/6 (60MM)
375	AS38249BL	PINCH ROLLER	440	AS110011010	SHRINK TUBE 16/4 WCSM
375,1	PP03009BL	PVA BRUSH	450	5473	BUTT CONNECTOR
380	8100S	FILTER BAG	550,1	SW00008	SCREW PT KB40X12 S/S 304
390	9305B-NT	BOTTOM LID VALVE	shown	PP0005108	FLOAT OVAL
400	BS6100200	BOTTOM LID ASSY	shown	4613	GROOVE PIN 1/8X5/8 S/S
410	AS09240	FILTER SCREEN ASSY	shown	XW0100400	SNAP RIVET NYLON 28 MM
420	AS2722402-SP	SPS BASIC 180W GREY			

CODIGO **60165**

DESCRIPCION: LIMPIAFONDOS ULTRA 125

RECS-BRA0-U2513 (2016)

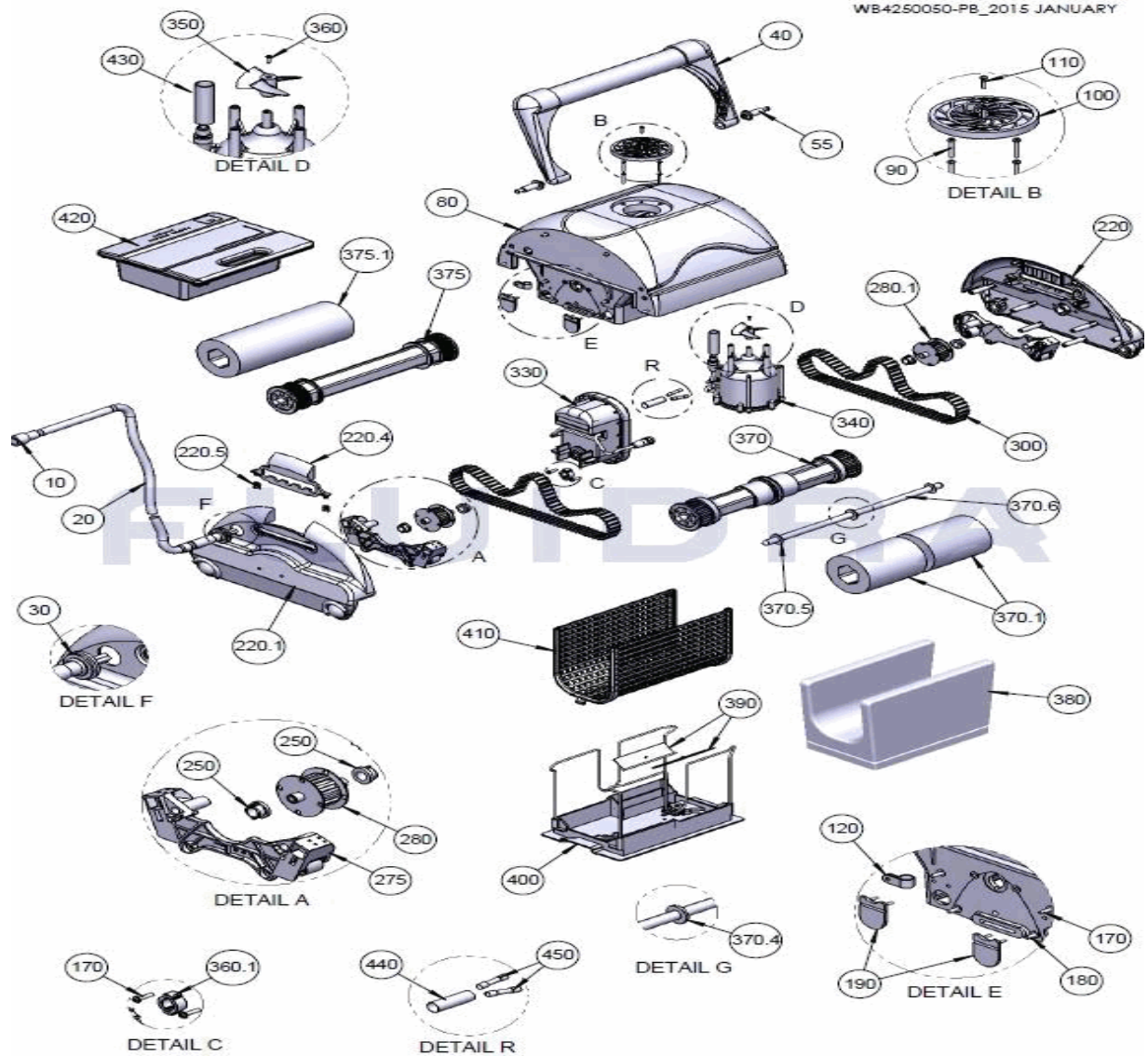

WB4250050-PB_2015 JANUARY

ESPAÑOL

POS	CODIGO	DESCRIPCION	CANTIDAD	POS	CODIGO	DESCRIPCION	CANTIDAD
10	PL00002M	ENCHUFE 4 TERMINALES		220,4	5088B	PALANCA DE BLOQUEO	
20	WA00123CGL	CABLE FLOTADOR CG/23M/2C/EZ-SW		250	2613	RODAMIENTO DE EJES	
30	1623	TUERCA FIJACIÓN CABLE		275	ASPP036200	SISTEMA DE TENSORES	
40	AS1049930	CONJUNTO MANGO		280	AS2000500	CONJUNTO POLEA	
55	SK00000BK	PASADOR COMPLETO PARA MANGO		280,1	AS2000500A	CJTO. POLEA	
80	AS1016220	CUERPO COMPLETO		300	RB00098	CORREA DE TRACCIÓN	
90	2500	TORNILLO PARA MOTOR BOMBA		330	AS08710-SP	MOTOR DE TRACCIÓN	
100	5093CG	TAPA SUPERIOR		340	AS00035R-SP	MOTOR DE BOMBEO	
110	5061	TORNILLO DE TAPA SUPERIOR		350	P00038	HELICE	
120	HW0006700	SUJECION CABLE		360	SW00069	TORNILLO PARA HELICE	
170	2700	TORNILLO SUPERIOR LATERAL		360,1	PP0004500	CUBIERTA DEL PASADOR	
180	2701	TORNILLO INFERIOR LATERAL		370	A38223BL	RODILLO CEPILLO	
190	2305N	VALVULA DE GOMA		370,1	3009A	CEPILLO PVA	

CODIGO 60165

DESCRIPCION: LIMPIAFONDOS ULTRA 125

RECS-BRA0-U2513 (2016)

220	AS1066400	PLACA LATERAL	370,4	2607	ARANDELA EXTREMOS EJE
220,1	AS1066450	PLACA LATERAL CON AGUJERO	370,5	3603	ARANDELA INTERMEDIA DE EJE
370,6	MP00233	EJE 410 MM 1/2" S/S 304"	430	AS110162506	TUBO RETRACTIL 20/6 (60mm)
375	AS38249BL	RODILLO DE ARRASTRE	440	AS110011010	TUBO RETRACTIL 16/4 WCSM
375,1	PP03009BL	CEPILLO DE PVA	450	5473	CONECTOR RETRÁCTIL ROJO
380	8100S	BOLSA FILTRO	550,1	SW00008	TORNILLO PT KB40X12 S/S 304
390	9305B-NT	VALVULA PLASTICA CIERRE FONDO	shown	PP0005108	FLOTADOR OVALADO
400	BS6100200	CONJUNTO TAPA INFERIOR	shown	4613	PASADOR CON RANURA
410	AS09240	CJTO. REJILLA FILTRO	shown	XW0100400	REMACHE PLASTICO 28 MM
420	AS2722402-SP	TRANSFORMADOR BASICO 180W GRIS			

CODE **60165**

DESCRIPTION: **NETTOYEUR DE FOND ULTRA 125**

RECS-BRA0-U2513 (2016)

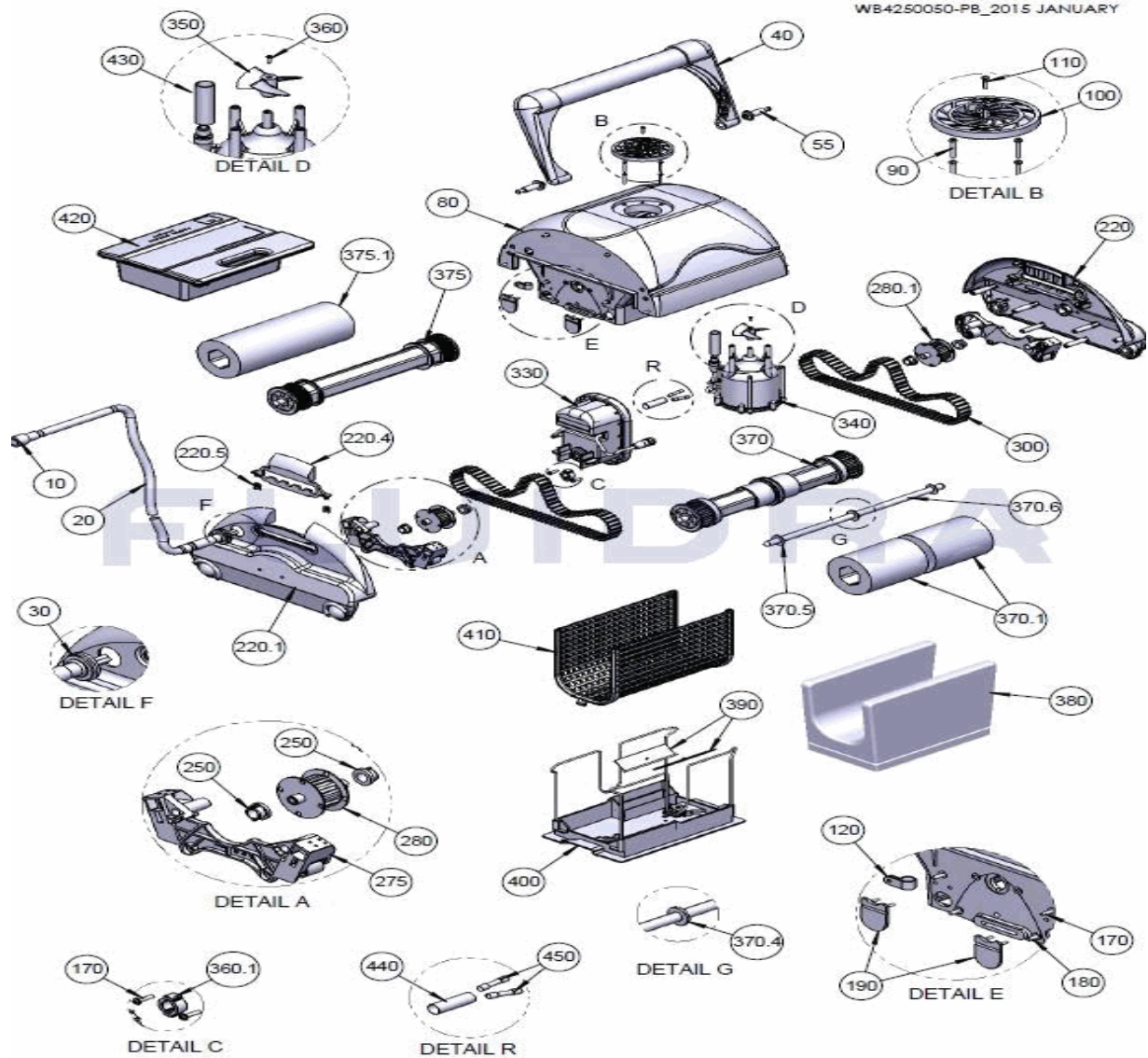

FRANCAIS

POS	CODE	DESCRIPTION	QUANTITE	POS	CODE	DESCRIPTION	QUANTITE
10	PL00002M	PRISE À 4 FICHES		220,4	5088B	LEVIER DE BLOCAGE	
20	WA00123CGL	CÂBLE FLOTTANT CG/23M/2C/EZ-SW		250	2613	BAGUE EN MOLYBDÉNE	
30	1623	ÉCROU FIXATION CÂBLE		275	ASPP036200	SYSTÈME DE TENSION	
40	AS1049930	ENSEMBLE MANCHE		280	AS2000500	ENSEMBLE POULIE	
55	SK00000BK	BROCHE COMPLÈTE POUR MANCHE		280,1	AS2000500A	ENS. POULIE	
80	AS1016220	ENSEMBLE CORPS		300	RB00098	COURROIE DE TRACTION	
90	2500	VIS 8X1,175 PH PN		330	AS08710-SP	MOTEUR DE TRACTION	
100	5093CG	SORTIE SUPÉRIEURE		340	AS00035R-SP	MOTEUR DE LA POMPE	
110	5061	VIS 6-32X5/8 S/S PH PA		350	P00038	HÉLICE	
120	HW0006700	FIXATION CÂBLE		360	SW00069	VIS M-3X10 PHIL DIN-965	
170	2700	VIS 8X11/16 PHIL PN		360,1	PP0004500	LOGEMENT DE TIGE	
180	2701	VIS 8X11/16PHIL PN		370	A38223BL	ROULEAU BROSSE	
190	2305N	VALVE CAOUTCHOUTÉE		370,1	3009A	BROSSE PVA	

CODE **60165**

DESCRIPTION: **NETTOYEUR DE FOND ULTRA 125**

RECS-BRA0-U2513 (2016)

220	AS1066400	PLAQUE LATÉRALE	370,4	2607	RONDELLE EXTRÉMITÉS AXE
220,1	AS1066450	PLAQUE LATÉRALE AVEC ORIFICE	370,5	3603	RONDELLE INTERMÉDIAIRE AXE
370,6	MP00233	AXE 410 MM 1/2" S/S 304"	430	AS110162506	TUBE RÉTRACTABLE 20/6 (60MM)
375	AS38249BL	ROULEAU DE TRACTION	440	AS110011010	TUYAU RÉTRACTILE 16/4 WCSM
375,1	PP03009BL	BROSSE EN PVA	450	5473	CONNECTEUR BOUT À BOUT
380	8100S	SAC FILTRANT	550,1	SW00008	VIS PT KB40X12 S/S 304
390	9305B-NT	VANNE PLASTIQUE FERMETURE FOND	shown	PP0005108	FLOTTEUR OVALE
400	BS6100200	ENSEMBLE COUVERCLE INFÉRIEUR	shown	4613	GOUPILLE À RAINURE
410	AS09240	ENS. GRILLE ET FILTRE	shown	XW0100400	RIVET PLASTIQUE 28 MM
420	AS2722402-SP	TRANSFORMATEUR BASIQUE 180W GRIS			

CODICE **60165**

DESCRIZIONE: **PULISCIFONDI ULTRA 125**

RECS-BRA0-U2513 (2016)

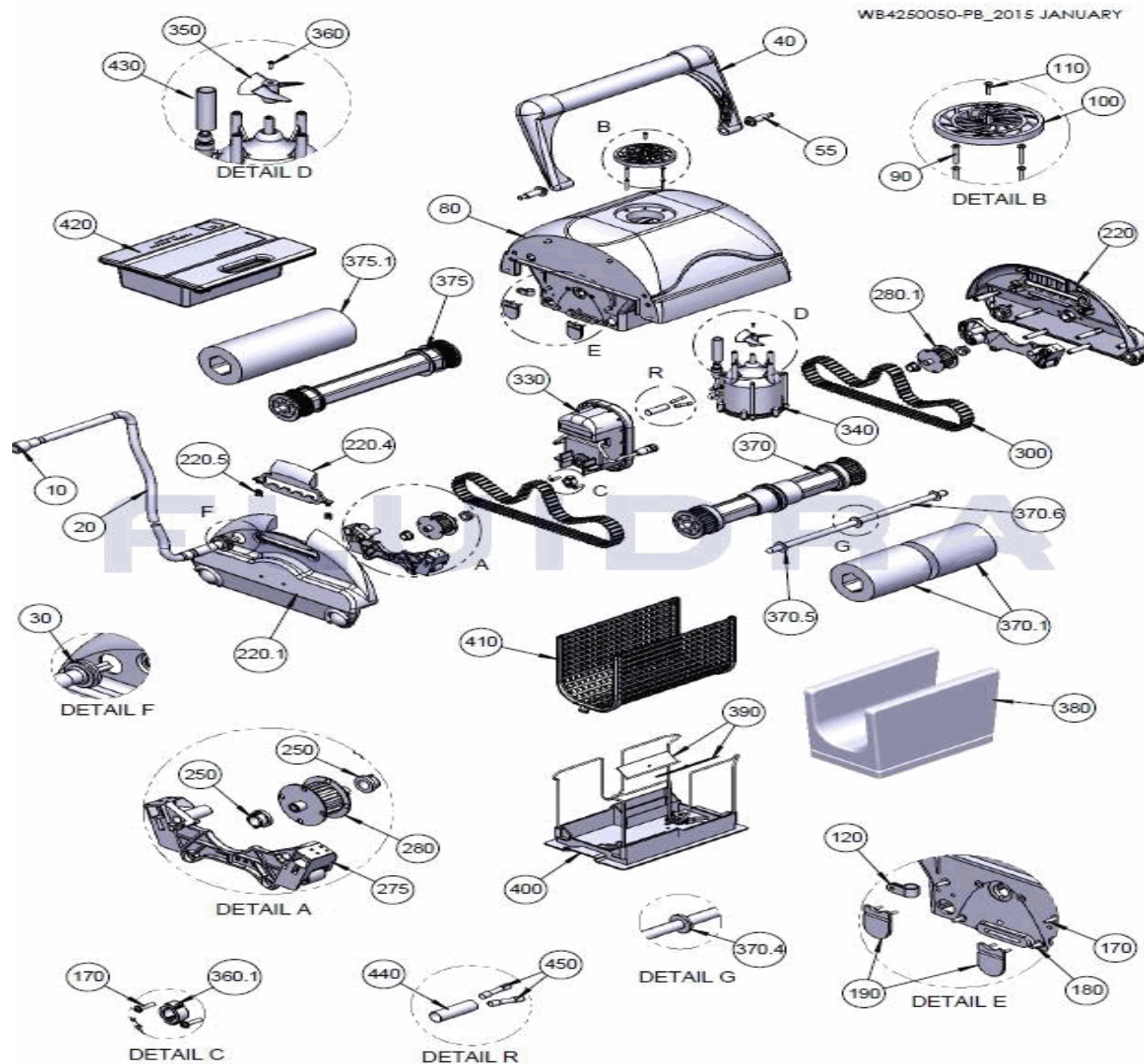

ITALIANO

POS	CODICE	DESCRIZIONE	QUANTITA'	POS	CODICE	DESCRIZIONE	QUANTITA'
10	PL00002M	PRESA A QUATTRO SPINE		220.4	5088B	LEVA DI BLOCCO	
20	WA00123CGL	CAVO GALLEGGIANTE CG/23M/2C/EZ-SW		250	2613	BOCCOLA IN MOLYBDENUM	
30	1623	OCCHIELLO SIGILLANTE		275	ASPP036200	SISTEMA DI TENSORI	
40	AS1049930	INSIEME MANICO		280	AS2000500	BLOCCO PULEGGIA	
55	SK00000BK	PASSANTE COMPLETO PER MANICO		280.1	AS2000500A	INSIEME PULEGGIA	
80	AS1016220	BLOCCO CORPO		300	RB00098	CINGHIA DI TRASMISSIONE	
90	2500	VITE 8X1,175 PH PN		330	AS08710-SP	MOTORE DI TRAZIONE	
100	5093CG	SORTIE SUPÉRIEURE		340	AS00035R-SP	INIETTORE A POMPA	
110	5061	VITE 6-32X5/8 S/S PH PA		350	P00038	ELICA	
120	HW0006700	ATTACCO CAVO		360	SW00069	VITE M-3X10 PHIL DIN-965	
170	2700	VITE 8X11/16 PHIL PN		360.1	PP0004500	PERNO	
180	2701	VITE 8X11/16 PHIL PN		370	A38223BL	RULLO SPAZZOLA	
190	2305N	VALVOLA DI GOMMA		370.1	3009A	SPAZZOLA PVA	

CODICE **60165**

DESCRIZIONE: **PULISCIFONDI ULTRA 125**

RECS-BRA0-U2513 (2016)

220	AS1066400	PLACCA LATERALE	370,4	2607	RONDELLA ESTREMI ASSE
220,1	AS1066450	PLACCA LATERALE CON FORO	370,5	3603	RONDELLA INTERMEDIA DI ASSE
370,6	MP00233	ASSE 410 MM 1 /2" S/S 304	430	AS110162506	TUBO RETRACTIL 20/6 (60MM)
375	AS38249BL	RULLO DI TRAINO	440	AS110011010	TUBO RETRACTIL 16/4 WCSM
375,1	PP03009BL	SPAZZOLA DI PVA	450	5473	CONNETTORI ISOLATI DI ESTREMITÀ
380	8100S	BORSA FILTRO	550,1	SW00008	VITE PT KB40X12 S/S 304
390	9305B-NT	VALVOLA PLASTICA CHIUSURA FONDO	shown	PP0005108	GALLEGGIANTE OVALE
400	BS6100200	BLOCCO COPERCHIO INFERIORE	shown	4613	COPPIGLIA CON SCANALATURA
410	AS09240	INSIEME GRIGLIA FILTRO	shown	XW0100400	RIVETTO PLASTICA 28 MM
420	AS2722402-SP	TRASFORMATORE BASICO 180 W. GRIGIO			

CODIGO 60165

DESCRIÇÃO: LIMPADOR DE FUNDOS ULTRA 125

RECS-BRA0-U2513 (2016)

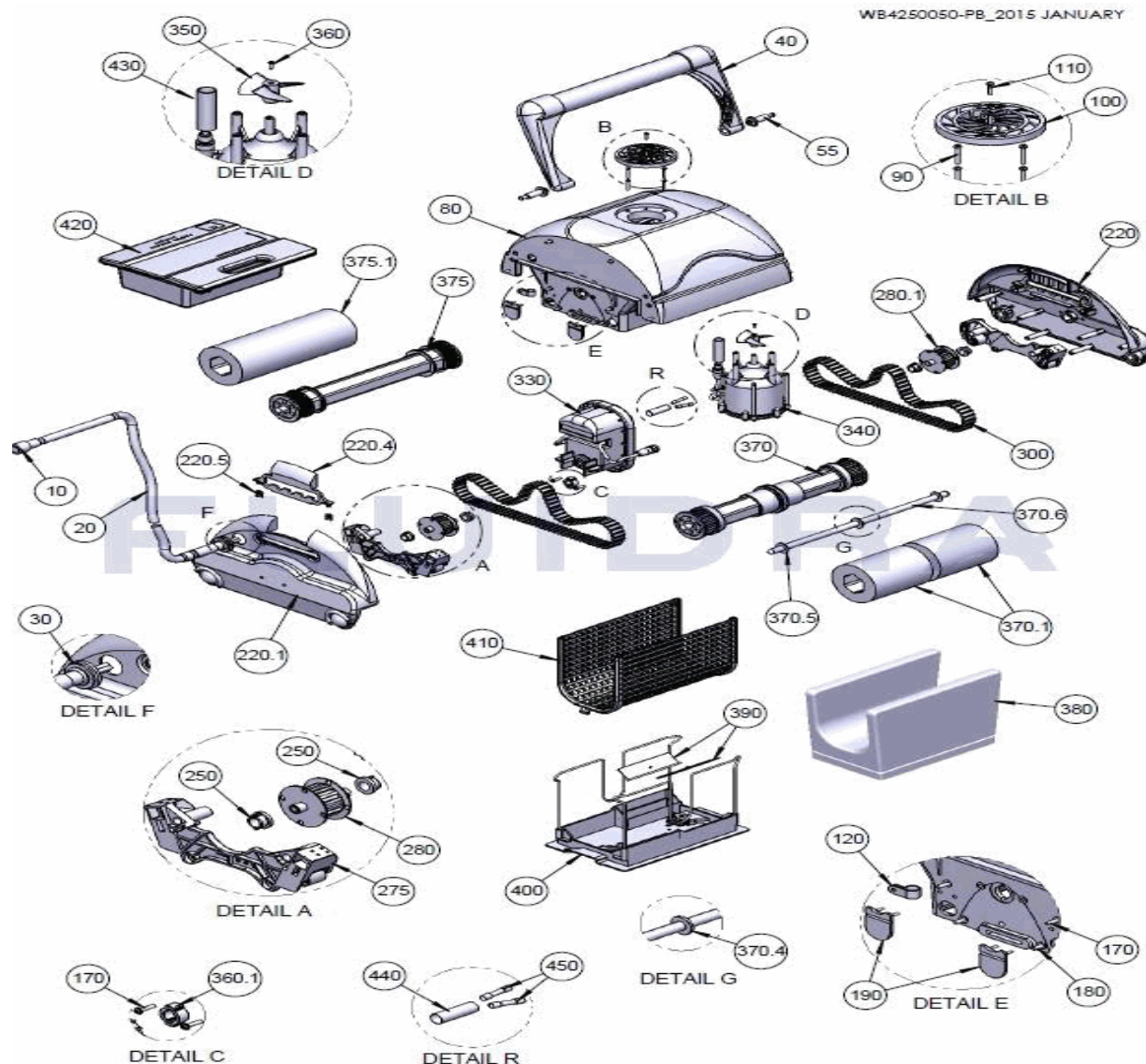

PORTUGUES

POS	CODIGO	DESCRIÇÃO	JANTIDADE	POS	CODIGO	DESCRIÇÃO	JANTIDADE
10	PL00002M	FICHA DE 4 PINOS		220,4	5088B	ALAVANCA DE BLOQUEIO	
20	WA00123CGL	CONJUNTO CABO DA BOIA CG/23M/2C/EZ-		250	2613	BUCHA MOLIBDÉNIO	
30	1623	ANEL ISOLANTE		275	ASPP036200	SISTEMA DE TENSORES	
40	AS1049930	CONJUNTO PEGA		280	AS2000500	CONJUNTO ROLDANA	
55	SK00000BK	PASSADOR COMPLETO PARA PEGA		280,1	AS2000500A	CJTO. POLIA	
80	AS1016220	CONJUNTO CORPO		300	RB00098	CORREIA DE TRANSMISSÃO	
90	2500	PARAFUSO 8 X 1,175 PH PN		330	AS08710-SP	MOTOR DE TRACÇÃO	
100	5093CG	SORTIE SUPÉRIEURE		340	AS00035R-SP	BOMBA MOTOR	
110	5061	PARAFUSO 6-32 X 5/8 S/S PH PA		350	P00038	HÉLICE	
120	HW0006700	FIXAÇÃO CABO		360	SW00069	PARAFUSO M-3 X 10 PHIL DIN-965	
170	2700	PARAFUSO 8 X 11/16 PHIL PN		360,1	PP0004500	ENCAIXE PARA PINO	
180	2701	PARAFUSO 8 X 11/16 PHIL PN		370	A38223BL	CILINDRO ESCOVA	
190	2305N	VÁLVULA DE BORRACHA		370,1	3009A	ESCOVA PVA	

CODIGO 60165

DESCRIÇÃO: LIMPADOR DE FUNDOS ULTRA 125

RECS-BRA0-U2513 (2016)

220	AS1066400	PLACA LATERAL	370,4	2607	ANILHA EXTREMIDADES DO EIXO
220,1	AS1066450	PLACA LATERAL COM ORIFÍCIO	370,5	3603	ANILHA INTERMÉDIA DO EIXO
370,6	MP00233	EIXO 410 MM 1/2" S/S 304"	430	AS110162506	TUBO ENCOLHÍVEL 20/6 (60MM)
375	AS38249BL	ROLO DE ARRASTO	440	AS110011010	TUBO RETRÁTIL 16/4 WCSM
375,1	PP03009BL	ESCOVA PVA	450	5473	CONECTOR DE EXTREMIDADE
380	8100S	BOLSA FILTRO	550,1	SW00008	PARAFUSO PT KB40 X 12 S/S 304
390	9305B-NT	VÁLVULA PLÁSTICA FECHO FUNDO	shown	PP0005108	BOIA OVALADA
400	BS6100200	CONJUNTO TAMPA INFERIOR	shown	4613	PASSADOR COM RANHURA
410	AS09240	CJTO. GRELHA FILTRO	shown	XW0100400	REBITE PLÁSTICO 28 MM
420	AS2722402-SP	TRANSFORMADOR BÁSICO 180 W. CINZEI			