

CODIGO **06544**

DESCRIPCION: **BOQUILLA 103X59 LINER TAPON D. 50 - TG 2"**

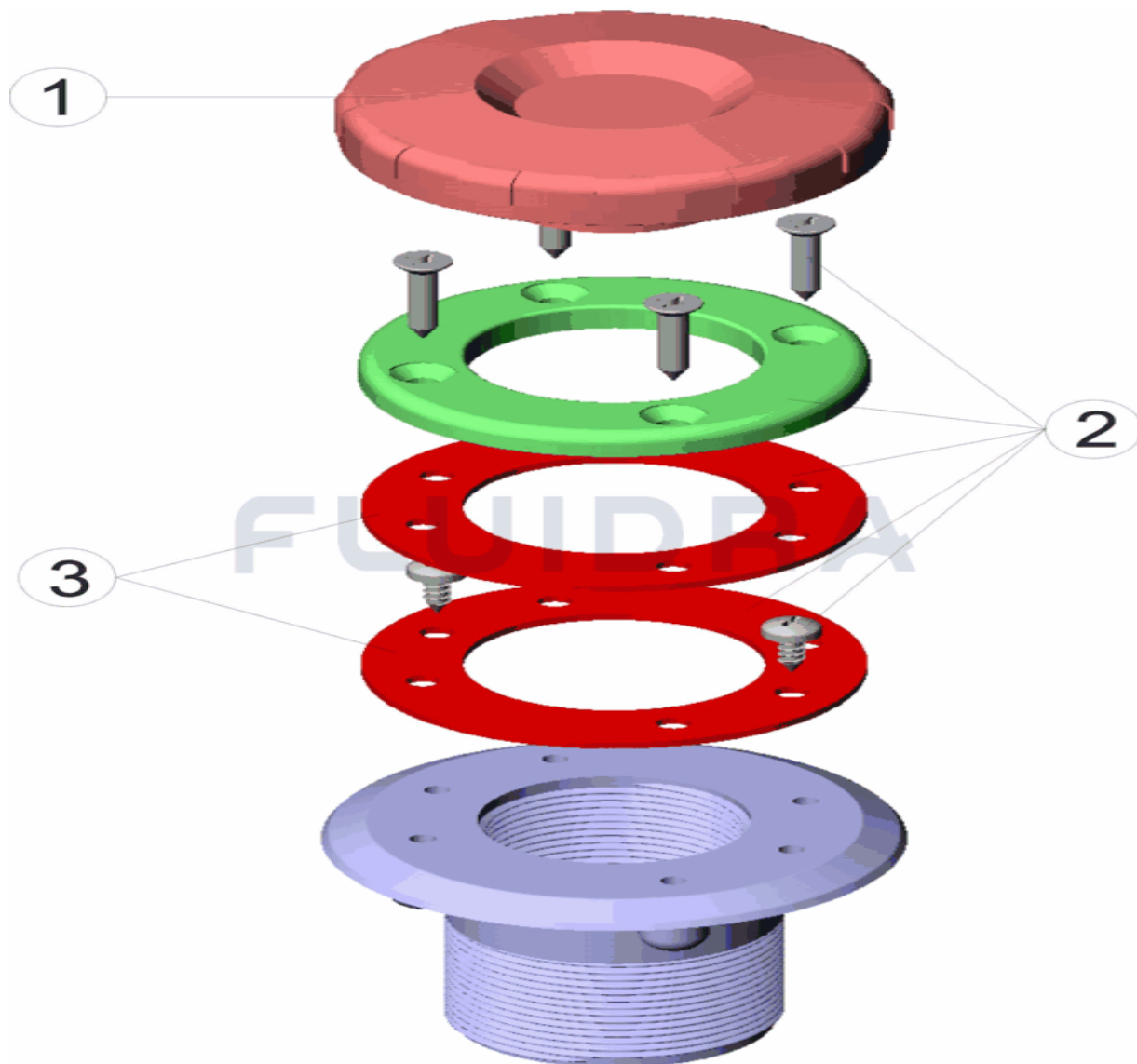

ESPAÑOL

POS	CODIGO	DESCRIPCION	CANTIDAD	POS	CODIGO	DESCRIPCION	CANTIDAD
1	4402046803	TAPON BOQUILLA		3	4403015406	JUNTA ADHESIVA BOQUILLA	
2	4402042102	ARO BOQUILLA P. PREF.					

CODE **06544**

DESCRIPTION: **BUSE 103X59 LINER BOUCHON D. 50 - TG 2"**

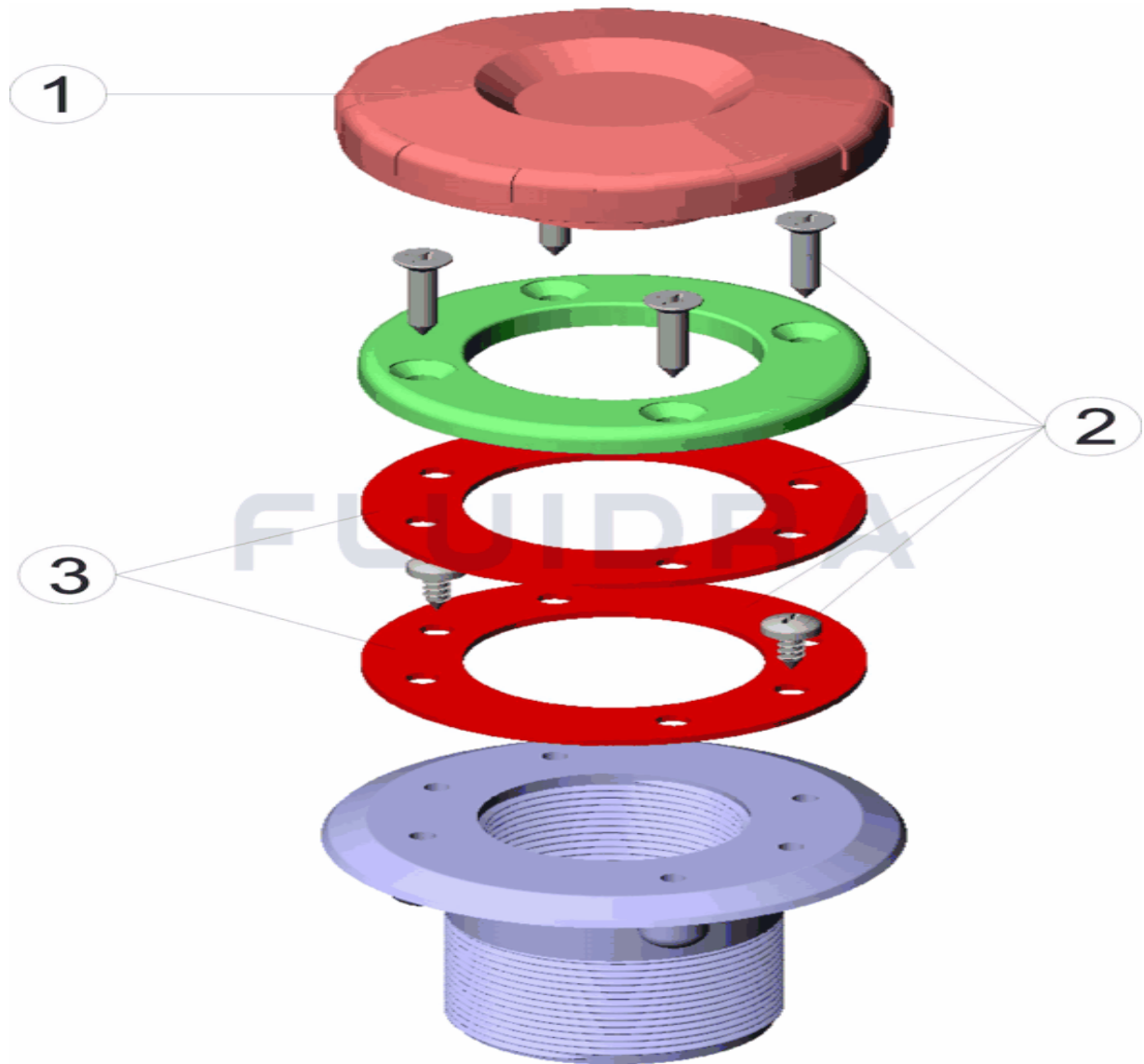

FRANCAIS

POS	CODE	DESCRIPTION	QUANTITE	POS	CODE	DESCRIPTION	QUANTITE
1	4402046803	BOUCHON DE BOUCHE		3	4403015406	JOINT ADHESIF	
2	4402042102	BRIDE BOUCHE PISC. LINER					

CODE **06544**

DESCRIPTION: **NOZZLE 103X59 LINER CAP D. 50 - TG 2"**

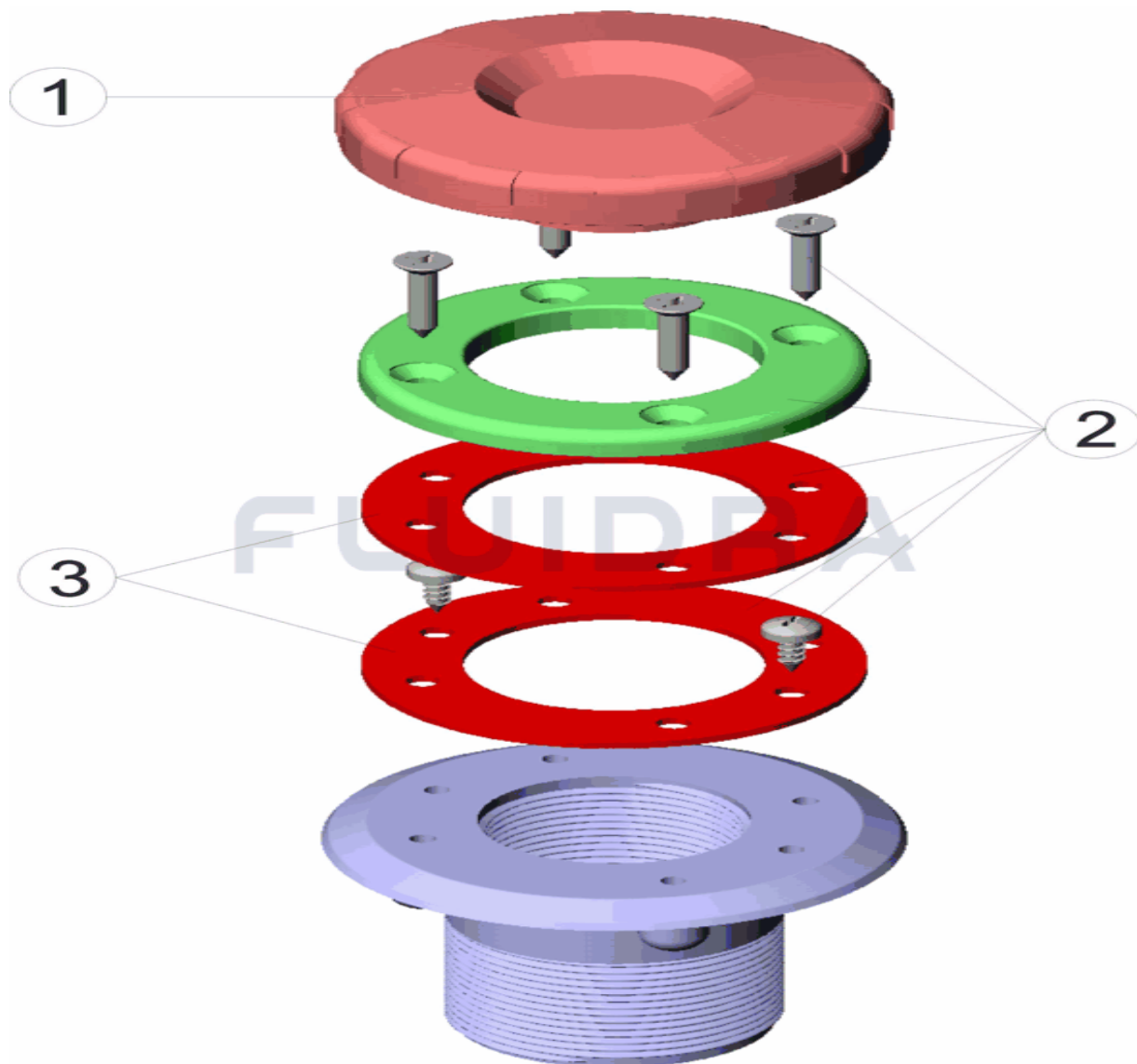

ENGLISH

POS	CODE	DESCRIPTION	QUANTITY	POS	CODE	DESCRIPTION	QUANTITY
1	4402046803	INLET CAP		3	4403015406	ADHESIVE GASKET	
2	4402042102	LINER INLET FLANGE					

CODICE **06544**

DESCRIZIONE: **BOCCHETTA 103X59 LINER TAPPO D. 50 - TG 2"**

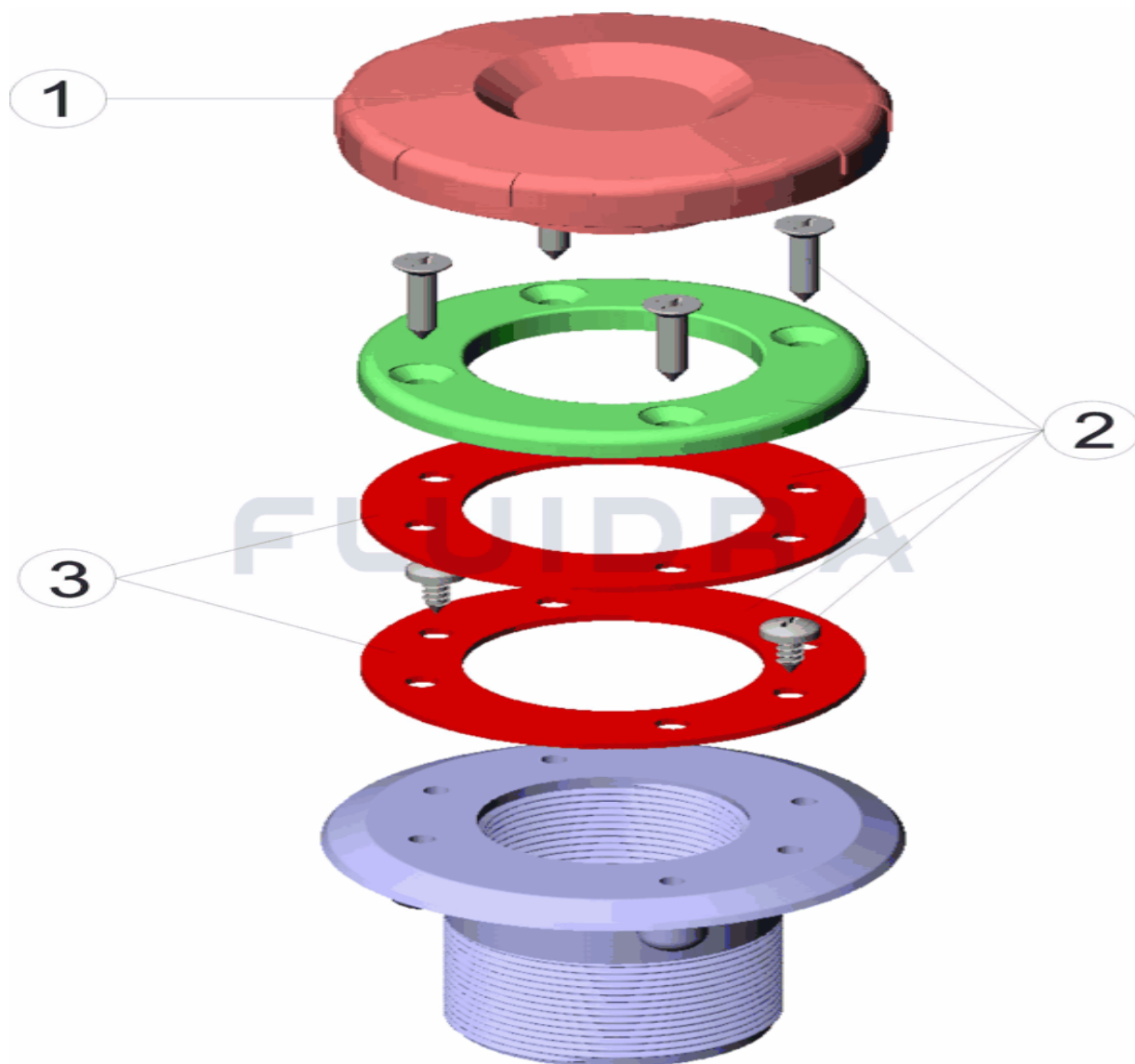

ITALIANO

POS	CODICE	DESCRIZIONE	QUANTITA'	POS	CODICE	DESCRIZIONE	QUANTITA'
1	4402046803	COPERCHIO BOCCHETTA		3	4403015406	GUARNIZIONE ADESIVA	
2	4402042102	ANELLO BOCCHETTA P. PREF					

CODE **06544**

BESCHREIBUNG: **DÜSE 103X59 FOLIE ABDECKUNG D. 50 - TG 2"**

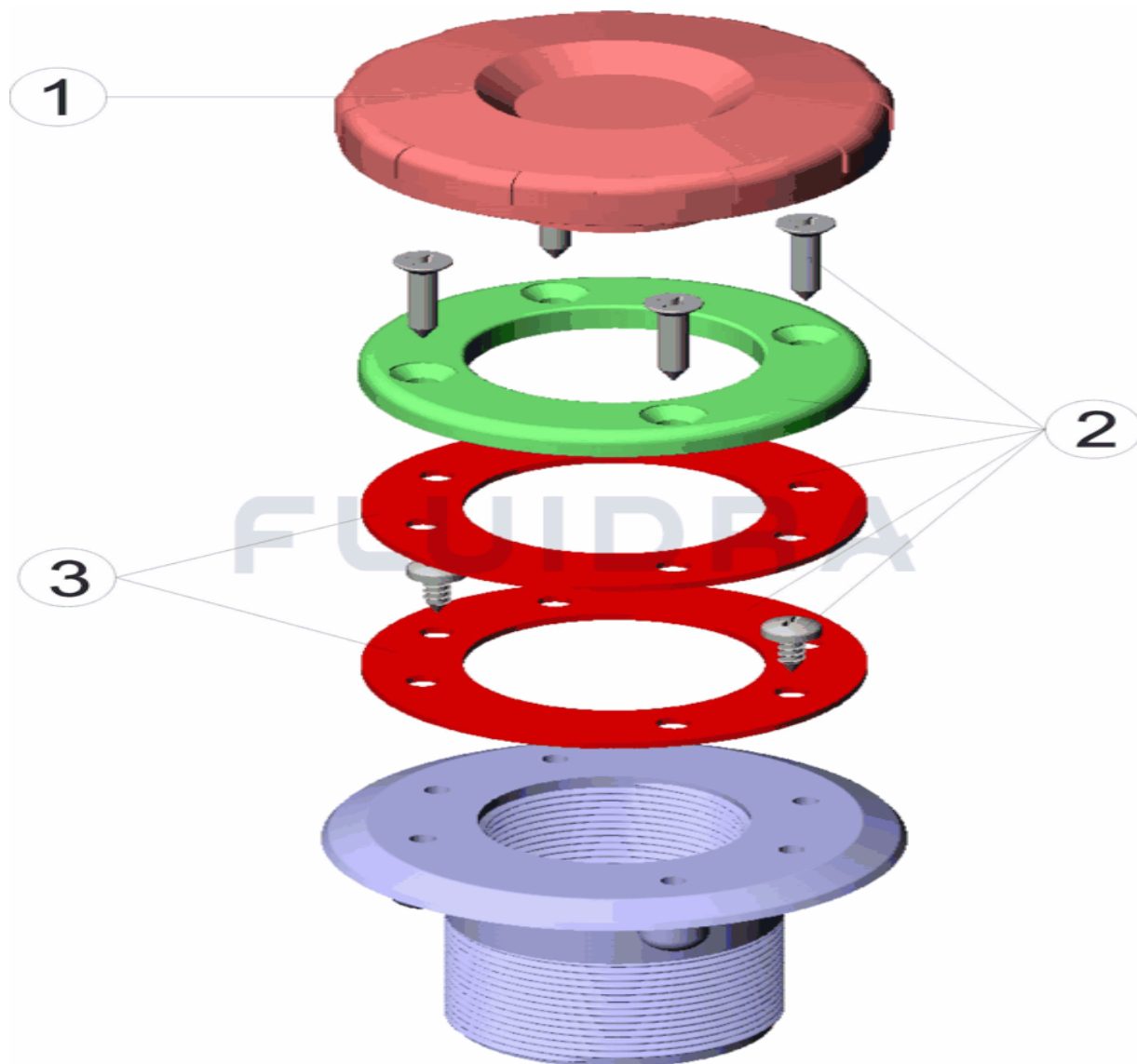

DEUTSCH

POS	CODE	BESCHREIBUNG	MENGE	POS	CODE	BESCHREIBUNG	MENGE
1	4402046803	STOPFEN DÜSE		3	4403015406	DICHTUNG SELBSTKLEBEND DÜSE	
2	4402042102	RING DÜSE FERTIGBECKEN					

CODIGO **06544**

DESCRIÇÃO: **BOQUILHA 103X59 LINER TAMPÃO D. 50 - TG 2"**

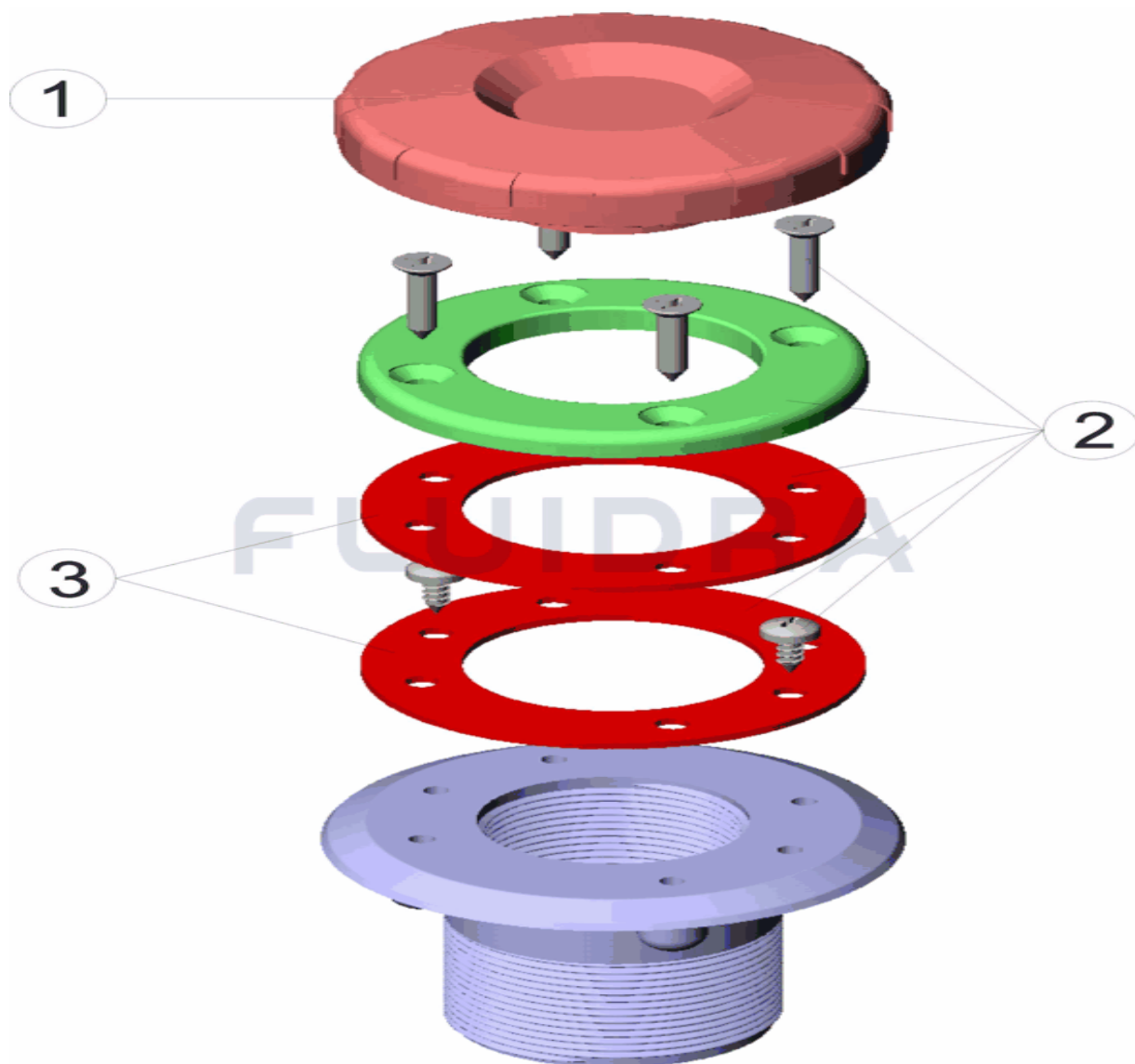

PORTUGUES

POS	CODIGO	DESCRIÇÃO	JANTIDADE	POS	CODIGO	DESCRIÇÃO	JANTIDADE
1	4402046803	TAMPÃO BOCA		3	4403015406	JUNTA ADESIVA	
2	4402042102	ARO BOCA P. PREF.					