

DESPIECE

REV: 0

10044

FECHA: 02/02/2024

HOJA: 1/3

CODIGO 1440, 1441, 1442, HPGIC30, HPGIC45, HPGIC60, HPGIC75

DESCRIPCION: BOMBA DE CALOR

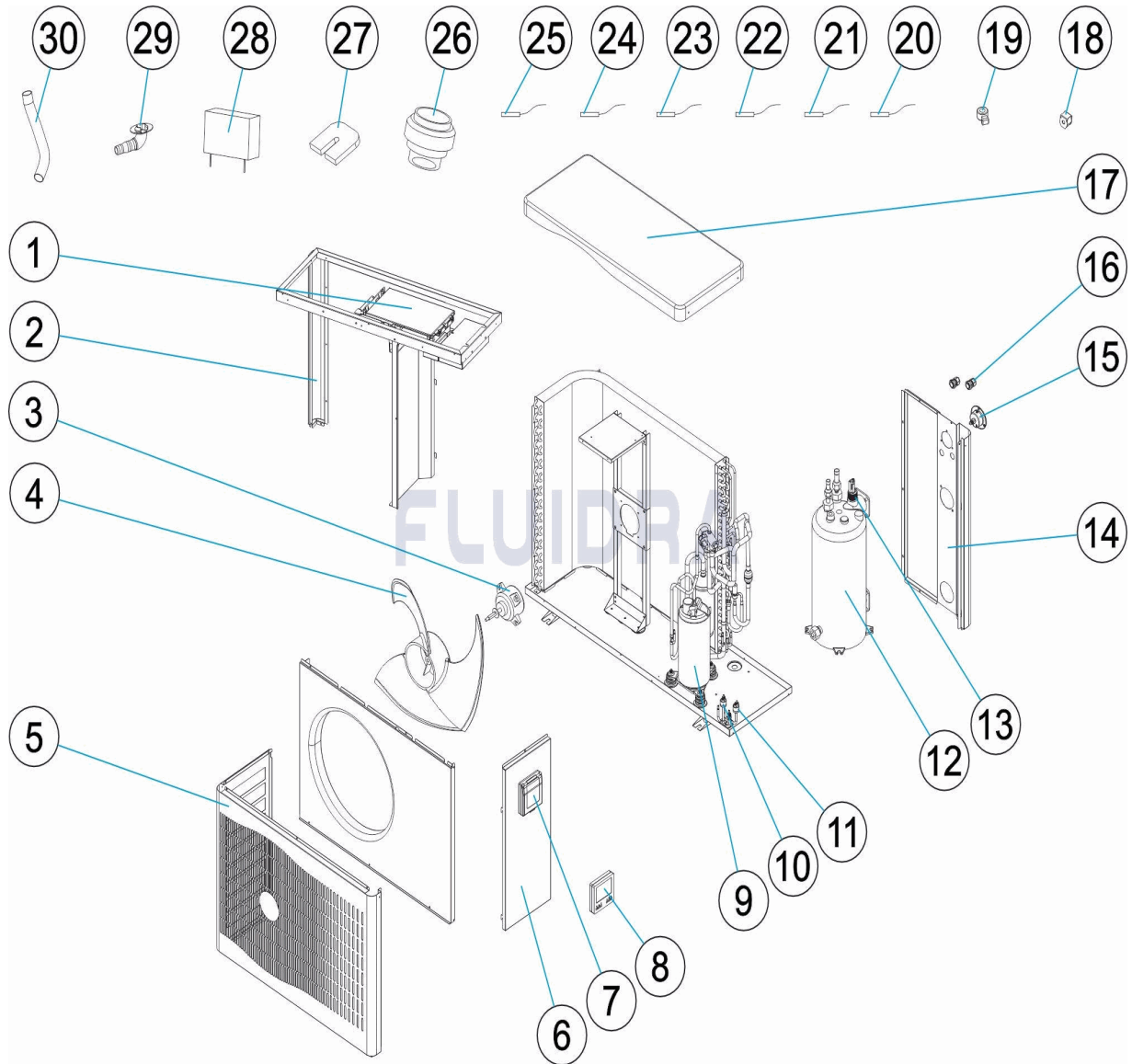

ESPAÑOL

| POS | CODIGO | DESCRIPCION | CANTIDAD | POS | CODIGO | DESCRIPCION | CANTIDAD |
|-----|---------------|------------------------------|----------|-----|--------------|----------------------------------|----------|
| 1 | * 75336R0021A | PLACA BASE PCB | | 12 | * 75311R0006 | INTERCAMBIADOR DE TITANIO | |
| 1 | * 75336R0021B | PLACA BASE PCB | | 12 | * 75312R0006 | INTERCAMBIADOR DE TITANIO | |
| 1 | * 75338R0021 | PLACA BASE PCB | | 12 | * 75313R0006 | INTERCAMBIADOR DE TITANIO | |
| 2 | 75336R0517 | PILAR | | 13 | 75336R0005 | FLUJOSTATO | |
| 3 | 75336R0015 | MOTOR VENTILADOR | | 14 | * 75336R0504 | PANEL TRASERO | |
| 4 | 75311R0014 | ASPAS VENTILADOR | | 14 | * 75338R0504 | PANEL TRASERO | |
| 5 | 75336R0513 | PANEL FRONTAL | | 15 | 75311R0003 | MANOMETRO | |
| 6 | 75336R0510 | PANEL DERECHO | | 16 | 75311R0002 | PRENSAESTOPAS | |
| 7 | 75311R0012 | CAJA CONTROLADOR IMPERMEABLE | | 17 | 75336R0501 | TAPA SUPERIOR | |
| 8 | 75311R0037B | CONTROLADOR | | 18 | 75336R0023 | BOBINA VALVULA DE 4 VIAS | |
| 9 | * 75336R0009 | COMPRESOR | | 19 | 75336R0025 | BOBINA EEV | |
| 9 | * 75337R0009 | COMPRESOR | | 20 | 75336R0037 | SENSOR TEMPERATURA SUCCIÓN GAS | |
| 9 | * 75338R0009 | COMPRESOR | | 21 | 75336R0026 | SENSOR TEMPERATURA SORTIDA AIGUA | |

* NOTA OBSERVACIONES

DESPIECE

REV: 0

10044

FECHA: 02/02/2024

HOJA: 2/3

CODIGO **1440, 1441, 1442, HPGIC30, HPGIC45, HPGIC60, HPGIC75**DESCRIPCION: **BOMBA DE CALOR**

| | | | | | |
|----|------------|---------------------------------|----|------------|---------------------------------|
| 10 | 75336R0007 | DETECTOR DE PRESIÓN BAJA | 22 | 75336R0028 | SENSOR TEMPERATURA ENTRADA AGUA |
| 11 | 75336R0008 | DETECTOR DE PRESIÓN ALTA | 23 | 75336R0029 | SENSOR TEMPERATURA AMBIENTE |
| 24 | 75336R0030 | SENSOR TEMPERATURA EVAPORADOR | 28 | 75311R0036 | CUBIERTA DE INVIERNO |
| 25 | 75336R0031 | SENSOR TEMPERATURA DESCARGA GAS | 29 | 75311R0034 | BOQUILLA DE AGUA |
| 26 | 75311R0032 | KIT DE CONEXIÓN AGUA | 30 | 75311R0033 | MANGUERA DE DRENAJE |
| 27 | 75311R0035 | PIES ANTIVIBRATORIOS | | | |

* NOTA OBSERVACIONES

DESPIECE

REV: 0

10044

FECHA: 02/02/2024

HOJA: 3/3

CODIGO **1440, 1441, 1442, HPGIC30, HPGIC45, HPGIC60, HPGIC75**DESCRIPCION: **BOMBA DE CALOR**

OBSERVACIONES

| POS | CODIGO | OBSERVACIONES |
|-----|---------------|---|
| 1 | * 75336R0021A | PARA: 1440, HPGIC30, HPGIC45 |
| 1 | * 75336R0021B | PARA: 1441, HPGIC60 |
| 1 | * 75338R0021 | PARA: 1442, HPGIC75 |
| 9 | * 75336R0009 | PARA: 1440, HPGIC30, HPGIC45 |
| 9 | * 75337R0009 | PARA: 1441, HPGIC60 |
| 9 | * 75338R0009 | PARA: 1442 |
| 12 | * 75311R0006 | PARA: 1440, HPGIC30, HPGIC45 |
| 12 | * 75312R0006 | PARA: 1441, HPGIC60 |
| 12 | * 75313R0006 | PARA: 1442, HPGIC75 |
| 14 | * 75336R0504 | PARA: 1440, 1441, HPGIC30, HPGIC45, HPGIC60 |
| 14 | * 75338R0504 | PARA: 1442, HPGIC75 |

ÉCLATÉ

REV.: 0

10044

DATE: 02/02/2024

PAG.: 1/3

CODE 1440, 1441, 1442, HPGIC30, HPGIC45, HPGIC60, HPGIC75

DESCRIPTION: POMPE À CHALEUR

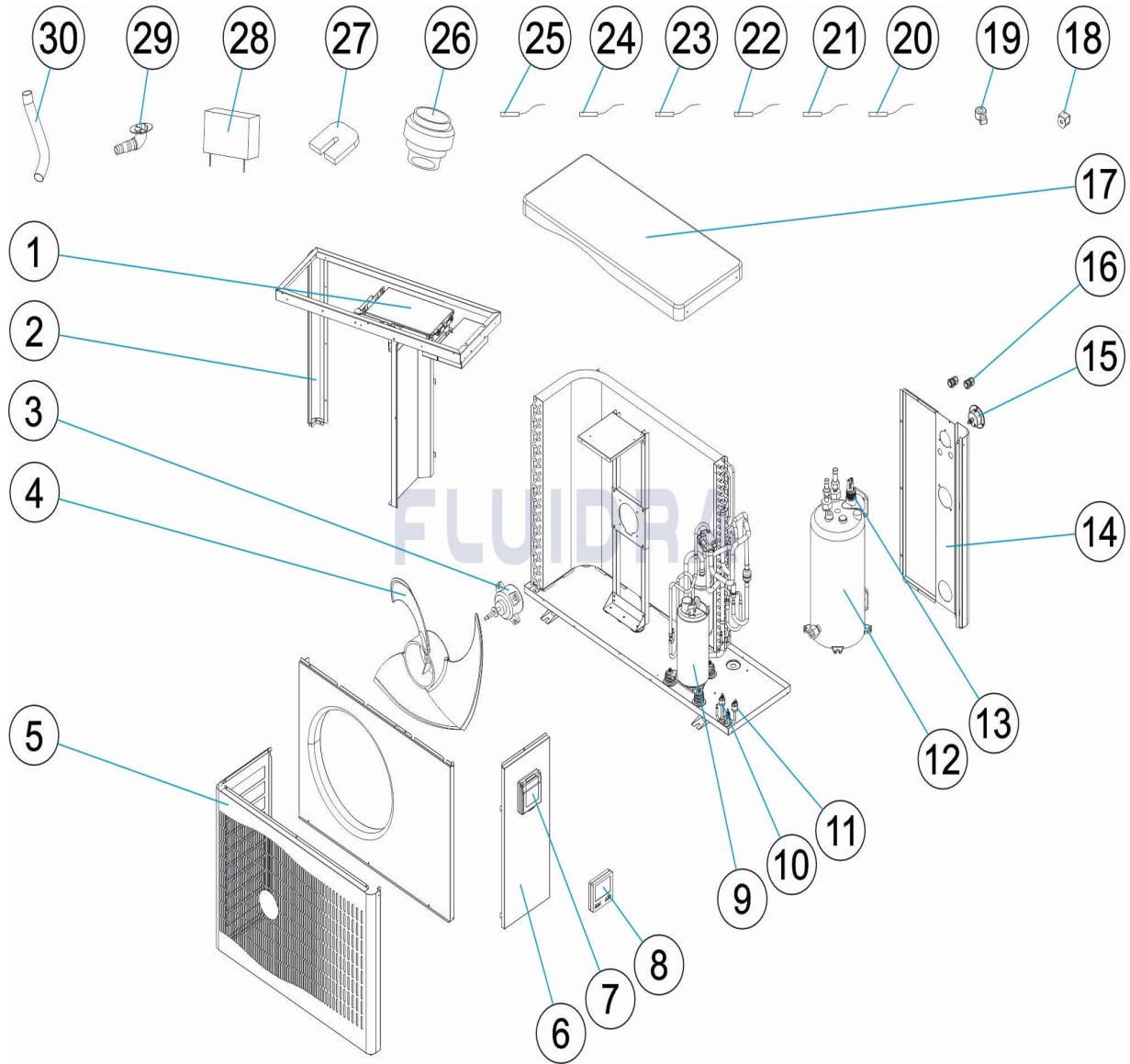

FRANCAIS

| POS | CODE | DESCRIPTION | QUANTITE | POS | CODE | DESCRIPTION | QUANTITE |
|-----|---------------|----------------------------|----------|-----|--------------|-----------------------------------|----------|
| 1 | * 75336R0021A | PLAQUE BASE PCB | | 12 | * 75311R0006 | ÉCHANGEUR EN TITANE | |
| 1 | * 75336R0021B | PLAQUE BASE PCB | | 12 | * 75312R0006 | ÉCHANGEUR EN TITANE | |
| 1 | * 75338R0021 | PLAQUE BASE PCB | | 12 | * 75313R0006 | ÉCHANGEUR EN TITANE | |
| 2 | 75336R0517 | PILIER | | 13 | 75336R0005 | CONTROLEUR DE DEBIT | |
| 3 | 75336R0015 | MOTEUR VENTILATEUR | | 14 | * 75336R0504 | PANNEAU ARRIÈRE | |
| 4 | 75311R0014 | PALES VENTILATEUR | | 14 | * 75338R0504 | PANNEAU ARRIÈRE | |
| 5 | 75336R0513 | PANNEAU AVANT | | 15 | 75311R0003 | MANOMETRE | |
| 6 | 75336R0510 | PANNEAU DROIT | | 16 | 75311R0002 | PRESSE-ÉTOUPES | |
| 7 | 75311R0012 | BOÎTIER CONTRÔLEUR ÉTANCHE | | 17 | 75336R0501 | COUVERCLE SUPÉRIEUR | |
| 8 | 75311R0037B | CONTRÔLEUR | | 18 | 75336R0023 | BOBINE VANNE 4 VOIES | |
| 9 | * 75336R0009 | COMPRESSEUR | | 19 | 75336R0025 | BOBINE EEV | |
| 9 | * 75337R0009 | COMPRESSEUR | | 20 | 75336R0037 | CAPTEUR TEMPÉRATURE ASPIRATION GA | |
| 9 | * 75338R0009 | COMPRESSEUR | | 21 | 75336R0026 | CAPTEUR TEMPÉRATURE EAU SORTIE | |

* VOIR FICHE D'OBSERVATIONS

ÉCLATÉ

REV.: 0

10044

DATE: 02/02/2024

PAG.: 2/3

CODE **1440, 1441, 1442, HPGIC30, HPGIC45, HPGIC60, HPGIC75**DESCRIPTION: **POMPE À CHALEUR**

| | | | | | |
|----|------------|---------------------------------|----|------------|-----------------------------------|
| 10 | 75336R0007 | DÉTECTEUR BASSE PRESSION | 22 | 75336R0028 | CAPTEUR TEMPÉRATURE ARRIVÉE D'EAU |
| 11 | 75336R0008 | DÉTECTEUR HAUTE PRESSION | 23 | 75336R0029 | CAPTEUR TEMPÉRATURE AMBIANT |
| 24 | 75336R0030 | CAPTEUR TEMPÉRATURE ÉVAPORATEUR | 28 | 75311R0036 | COUVERTURE D'HIVERNAGE |
| 25 | 75336R0031 | CAPTEUR TEMPÉRATURE DÉCHARGE GA | 29 | 75311R0034 | BUSE D'EAU |
| 26 | 75311R0032 | ENSEMBLES CONNEXION D'EAU | 30 | 75311R0033 | TUYAU DE DRAINAGE |
| 27 | 75311R0035 | PIEDS ANTI-VIBRATION | | | |

ÉCLATÉ

REV.: 0

10044

DATE: 02/02/2024

PAG.: 3/3

CODE 1440, 1441, 1442, HPGIC30, HPGIC45, HPGIC60, HPGIC75

DESCRIPTION: POMPE À CHALEUR

OBSERVATIONS

| POS | CODE | OBSERVATIONS |
|-----|---------------|---|
| 1 | * 75336R0021A | POUR: 1440, HPGIC30, HPGIC45 |
| 1 | * 75336R0021B | POUR: 1441, HPGIC60 |
| 1 | * 75338R0021 | POUR: 1442, HPGIC75 |
| 9 | * 75336R0009 | POUR: 1440, HPGIC30, HPGIC45 |
| 9 | * 75337R0009 | POUR: 1441, HPGIC60 |
| 9 | * 75338R0009 | POUR: 1442 |
| 12 | * 75311R0006 | POUR: 1440, HPGIC30, HPGIC45 |
| 12 | * 75312R0006 | POUR: 1441, HPGIC60 |
| 12 | * 75313R0006 | POUR: 1442, HPGIC75 |
| 14 | * 75336R0504 | POUR: 1440, 1441, HPGIC30, HPGIC45, HPGIC60 |
| 14 | * 75338R0504 | POUR: 1442, HPGIC75 |

PARTS BREAKDOWN

REV.: 0

10044

DATE: 02/02/2024

SHEET: 1/3

CODE

1440, 1441, 1442, HPGIC30, HPGIC45, HPGIC60, HPGIC75

DESCRIPTION: HEAT PUMP

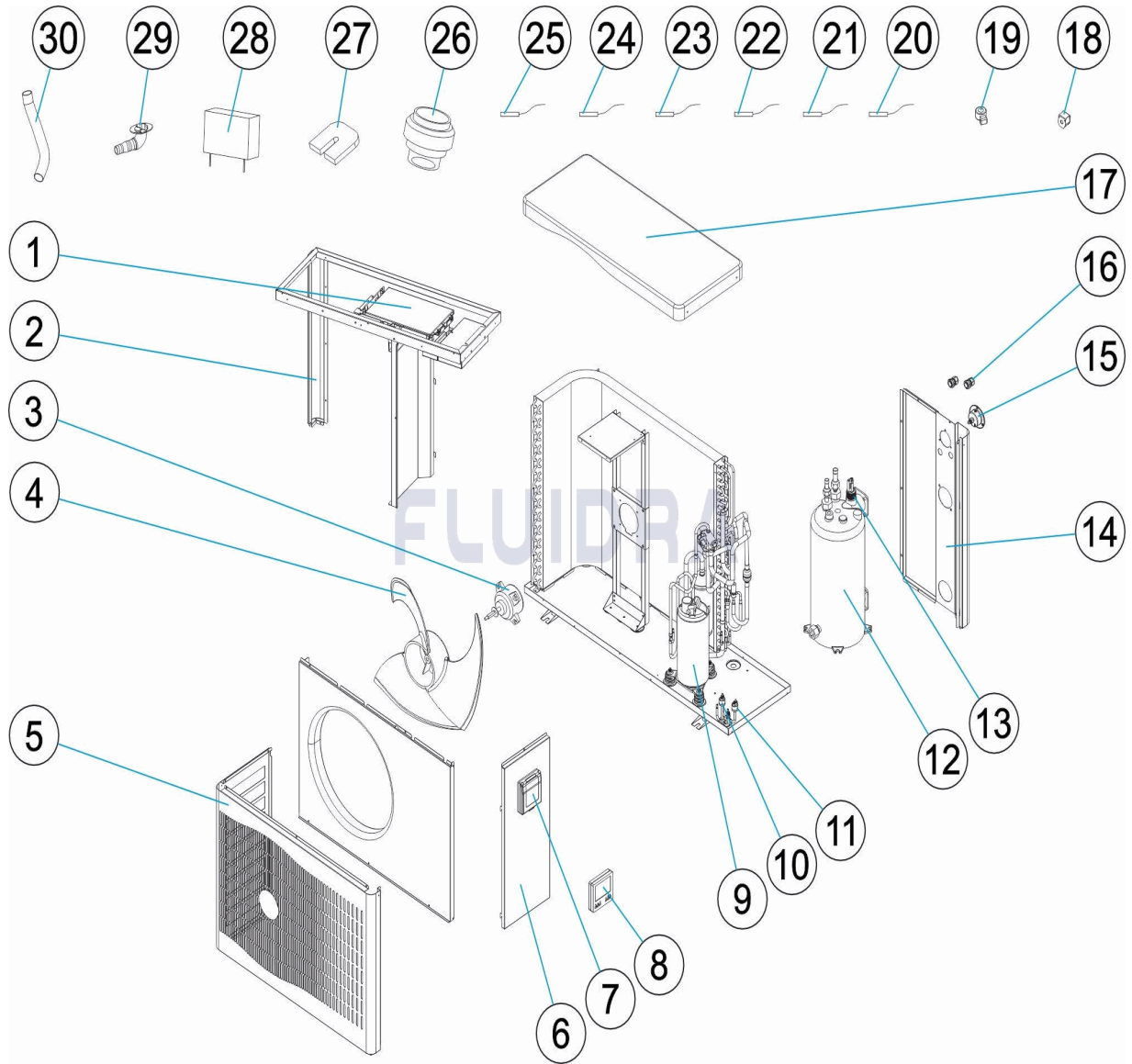

ENGLISH

| POS | CODE | DESCRIPTION | QUANTITY | POS | CODE | DESCRIPTION | QUANTITY |
|-----|---------------|---------------------------|----------|-----|--------------|---------------------------------|----------|
| 1 | * 75336R0021A | PC BOARD | | 12 | * 75311R0006 | TITANIUM HEAT EXCHANGER | |
| 1 | * 75336R0021B | PC BOARD | | 12 | * 75312R0006 | TITANIUM HEAT EXCHANGER | |
| 1 | * 75338R0021 | PC BOARD | | 12 | * 75313R0006 | TITANIUM HEAT EXCHANGER | |
| 2 | 75336R0517 | PILLAR | | 13 | 75336R0005 | WATER FLOW SWITCH | |
| 3 | 75336R0015 | FAN MOTOR | | 14 | * 75336R0504 | BACK PANEL | |
| 4 | 75311R0014 | FAN BLADE | | 14 | * 75338R0504 | BACK PANEL | |
| 5 | 75336R0513 | FRONT PANEL | | 15 | 75311R0003 | PRESSURE GAUGE | |
| 6 | 75336R0510 | RIGHT PANEL | | 16 | 75311R0002 | CABLE GLANDS | |
| 7 | 75311R0012 | WATERPROOF CONTROLLER BOX | | 17 | 75336R0501 | TOP COVER | |
| 8 | 75311R0037B | CONTROLLER | | 18 | 75336R0023 | 4-WAY VALVE COIL | |
| 9 | * 75336R0009 | COMPRESSORE | | 19 | 75336R0025 | EEV COIL | |
| 9 | * 75337R0009 | COMPRESSORE | | 20 | 75336R0037 | GAS SUCTION TEMPERATURE SENSOR | |
| 9 | * 75338R0009 | COMPRESSORE | | 21 | 75336R0026 | WATER OUTLET TEMPERATURE SENSOR | |

* SEE OBSERVATIONS SHEET

PARTS BREAKDOWN

REV.: 0

10044

DATE: 02/02/2024

SHEET: 2/3

CODE 1440, 1441, 1442, HPGIC30, HPGIC45, HPGIC60, HPGIC75

DESCRIPTION: HEAT PUMP

| | | | | | |
|----|------------|-----------------------------------|----|------------|--------------------------------|
| 10 | 75336R0007 | LOW PRESSURE SWITCH | 22 | 75336R0028 | WATER INLET TEMPERATURE SENSOR |
| 11 | 75336R0008 | HIGH PRESSURE SWITCH | 23 | 75336R0029 | AMBIENT TEMPERATURE SENSOR |
| 24 | 75336R0030 | WATER INLET TEMPERATURE EVAPORATC | 28 | 75311R0036 | WINTER COVER |
| 25 | 75336R0031 | GAS DISCHARGE TEMPERATURE SENSO | 29 | 75311R0034 | WATER NOZZLE |
| 26 | 75311R0032 | WATER CONNECTION SETS | 30 | 75311R0033 | DRAIN HOSE |
| 27 | 75311R0035 | ANTI-VIBRATION FEET | | | |

PARTS BREAKDOWN

REV.: 0
DATE: 02/02/2024
SHEET: 3/3

10044

CODE 1440, 1441, 1442, HPGIC30, HPGIC45, HPGIC60, HPGIC75

DESCRIPTION: HEAT PUMP

OBSERVATIONS

| POS | CODE | OBSERVATIONS |
|-----|---------------|--|
| 1 | * 75336R0021A | FOR: 1440, HPGIC30, HPGIC45 |
| 1 | * 75336R0021B | FOR: 1441, HPGIC60 |
| 1 | * 75338R0021 | FOR: 1442, HPGIC75 |
| 9 | * 75336R0009 | FOR: 1440, HPGIC30, HPGIC45 |
| 9 | * 75337R0009 | FOR: 1441, HPGIC60 |
| 9 | * 75338R0009 | FOR: 1442 |
| 12 | * 75311R0006 | FOR: 1440, HPGIC30, HPGIC45 |
| 12 | * 75312R0006 | FOR: 1441, HPGIC60 |
| 12 | * 75313R0006 | FOR: 1442, HPGIC75 |
| 14 | * 75336R0504 | FOR: 1440, 1441, HPGIC30, HPGIC45, HPGIC60 |
| 14 | * 75338R0504 | FOR: 1442, HPGIC75 |

ESPLOSO

REV.: 0

10044

DATA: 02/02/2024

PAG.: 1/3

CODICE 1440, 1441, 1442, HPGIC30, HPGIC45, HPGIC60, HPGIC75

DESCRIZIONE: POMPA DI CALORE

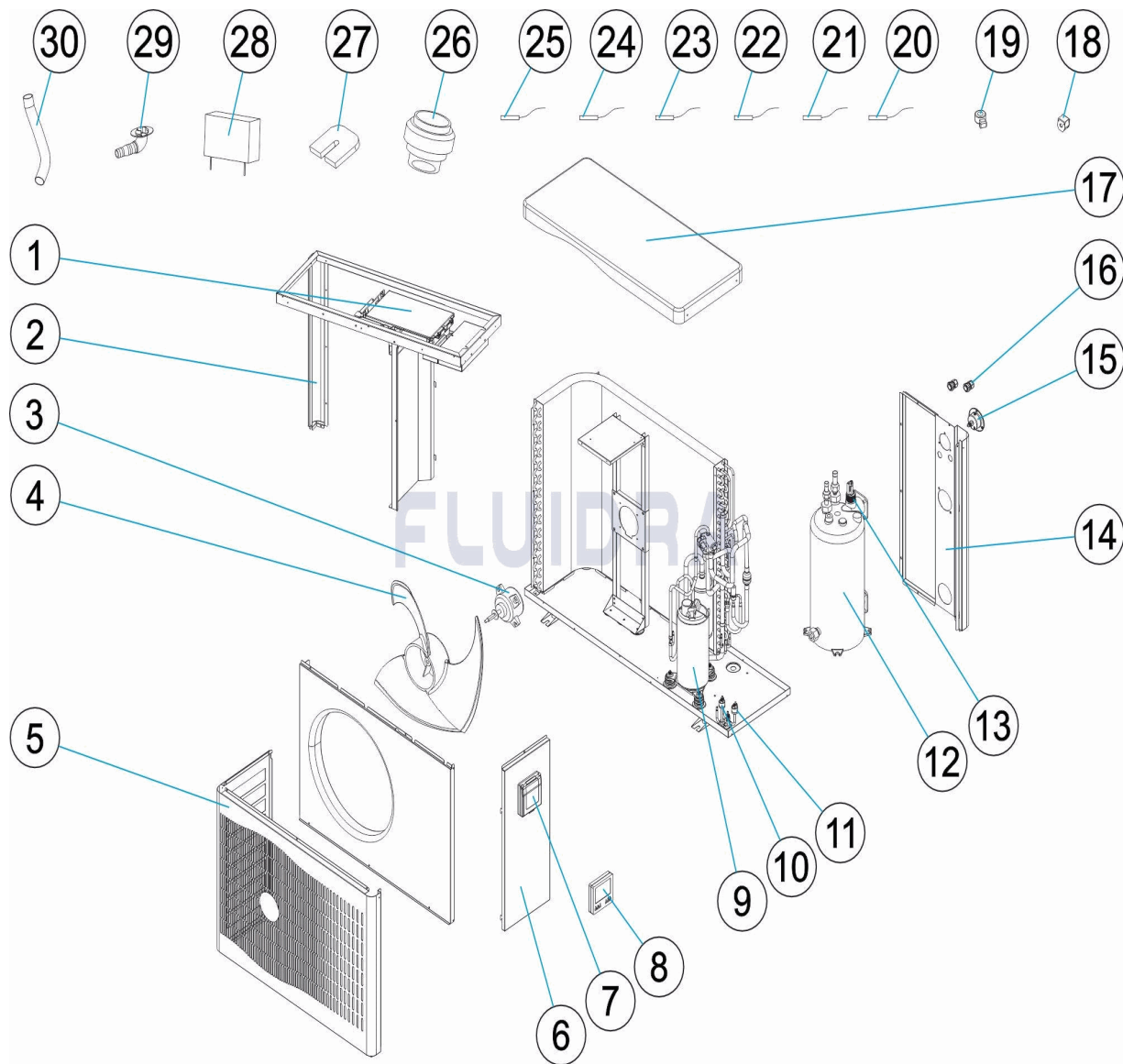

ITALIANO

| POS | CODICE | DESCRIZIONE | QUANTITA' | POS | CODICE | DESCRIZIONE | QUANTITA' |
|-----|---------------|--------------------------------|-----------|-----|--------------|-----------------------------------|-----------|
| 1 | * 75336R0021A | SCHEDA BASE PCB | | 12 | * 75311R0006 | INTERCAMBIATORE IN TITANIO | |
| 1 | * 75336R0021B | SCHEDA BASE PCB | | 12 | * 75312R0006 | INTERCAMBIATORE IN TITANIO | |
| 1 | * 75338R0021 | SCHEDA BASE PCB | | 12 | * 75313R0006 | INTERCAMBIATORE IN TITANIO | |
| 2 | 75336R0517 | PILASTRO | | 13 | 75336R0005 | FLUSSOSTATO | |
| 3 | 75336R0015 | MOTORE VENTOLA | | 14 | * 75336R0504 | PANNELLO INDIETRO | |
| 4 | 75311R0014 | PALE VENTILATORE | | 14 | * 75338R0504 | PANNELLO INDIETRO | |
| 5 | 75336R0513 | PANNELLO FRONTALE | | 15 | 75311R0003 | MANOMETRO | |
| 6 | 75336R0510 | PANNELLO DESTRO | | 16 | 75311R0002 | PRESSACAVI | |
| 7 | 75311R0012 | SCATOLA CONTROLLO IMPERMEABILE | | 17 | 75336R0501 | COPERCHIO SUPERIORE | |
| 8 | 75311R0037B | CONTROLADOR | | 18 | 75336R0023 | BOBINA VALVOLA A 4 VIE | |
| 9 | * 75336R0009 | COMPRESSORE | | 19 | 75336R0025 | BOBINA EEV | |
| 9 | * 75337R0009 | COMPRESSORE | | 20 | 75336R0037 | SENSORE TEMPERATURA ASPIRAZIONE G | |
| 9 | * 75338R0009 | COMPRESSORE | | 21 | 75336R0026 | SENSORE TEMPERATURA USCITA ACQUA | |

* SI FACCIA RIFERIMENTO AL FOGLIO DELLE OSSERVAZIONI

ESPLOSO

REV.: 0
DATA: 02/02/2024
PAG.: 2/3

10044

CODICE **1440, 1441, 1442, HPGIC30, HPGIC45, HPGIC60, HPGIC75**

DESCRIZIONE: **POMPA DI CALORE**

| | | | | | |
|----|------------|---------------------------------|----|------------|----------------------------------|
| 10 | 75336R0007 | RIVELATORE BASSO PRESSIONE | 22 | 75336R0028 | SENSORE TEMPERATURA INGRESSO ACQ |
| 11 | 75336R0008 | RILEVATORE DI ALTA PRESSIONE | 23 | 75336R0029 | SENSORE TEMPERATURA AMBIENTE |
| 24 | 75336R0030 | SENSORE TEMPERATURA EVAPORATORE | 28 | 75311R0036 | COPERTA DI INVERNO |
| 25 | 75336R0031 | SENSORE TEMPERATURA SCARICO GAS | 29 | 75311R0034 | UGELLO DELL'ACQUA |
| 26 | 75311R0032 | SET CONNESSIONE DELL'ACQUA | 30 | 75311R0033 | TUBO DI SCARICO |
| 27 | 75311R0035 | PIEDINI ANTIVIBRAZIONE | | | |

ESPLOSO

REV.: 0
DATA: 02/02/2024
PAG.: 3/3

10044

CODICE 1440, 1441, 1442, HPGIC30, HPGIC45, HPGIC60, HPGIC75

DESCRIZIONE: POMPA DI CALORE

OSSERVAZIONI

| POS | CODICE | OSSERVAZIONI |
|-----|---------------|--|
| 1 | * 75336R0021A | PER: 1440, HPGIC30, HPGIC45 |
| 1 | * 75336R0021B | PER: 1441, HPGIC60 |
| 1 | * 75338R0021 | PER: 1442, HPGIC75 |
| 9 | * 75336R0009 | PER: 1440, HPGIC30, HPGIC45 |
| 9 | * 75337R0009 | PER: 1441, HPGIC60 |
| 9 | * 75338R0009 | PER: 1442 |
| 12 | * 75311R0006 | PER: 1440, HPGIC30, HPGIC45 |
| 12 | * 75312R0006 | PER: 1441, HPGIC60 |
| 12 | * 75313R0006 | PER: 1442, HPGIC75 |
| 14 | * 75336R0504 | PER: 1440, 1441, HPGIC30, HPGIC45, HPGIC60 |
| 14 | * 75338R0504 | PER: 1442, HPGIC75 |

EINZELTEILE

ÜBER.: 0

10044

DATUM: 02/02/2024

BLATT: 1/3

CODE 1440, 1441, 1442, HPGIC30, HPGIC45, HPGIC60, HPGIC75

BESCHREIBUNG: WÄRMEPUMPE

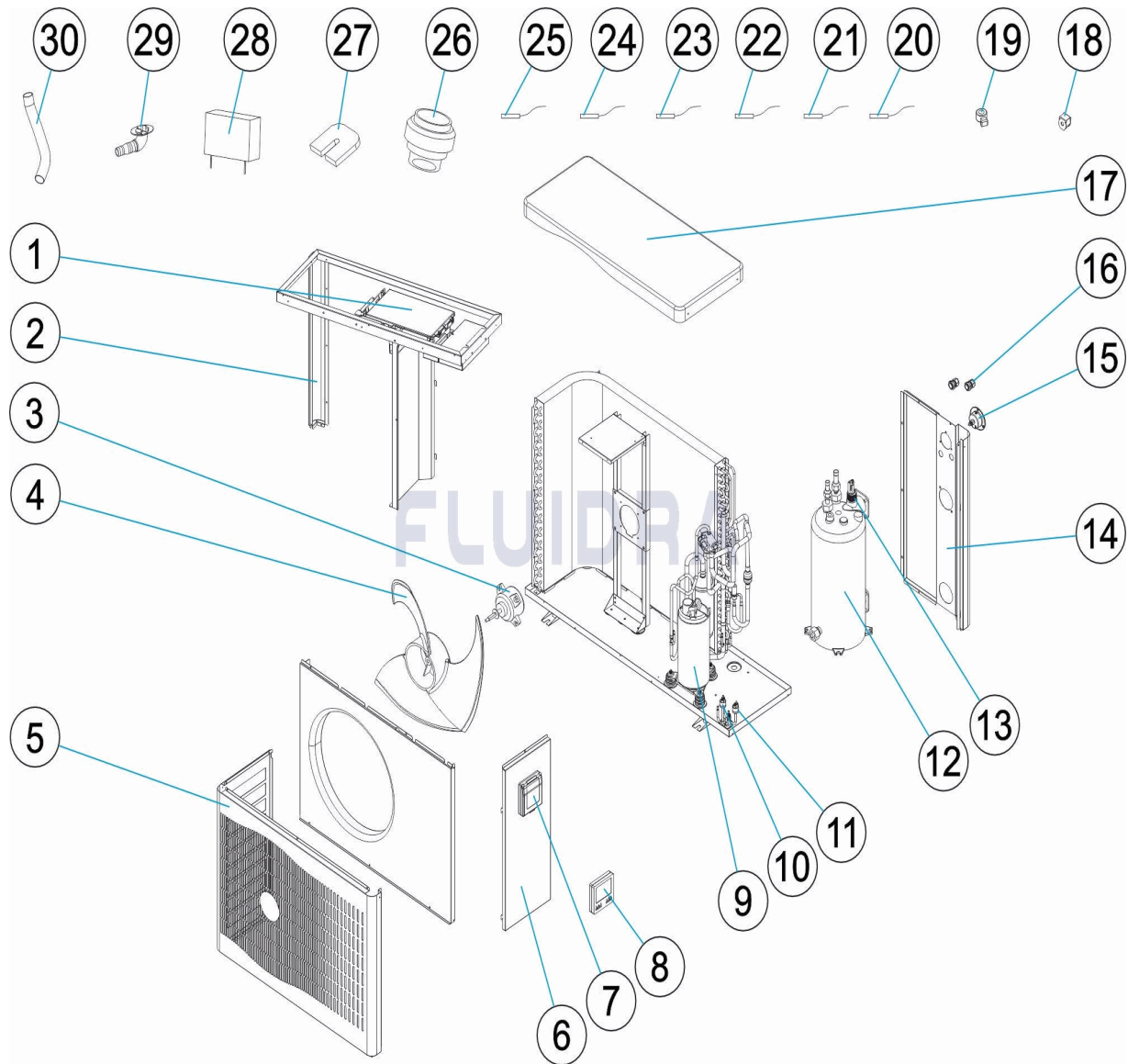

DEUTSCH

| POS | CODE | BESCHREIBUNG | MENGE | POS | CODE | BESCHREIBUNG | MENGE |
|-----|---------------|-----------------------------|-------|-----|--------------|--------------------------------|-------|
| 1 | * 75336R0021A | BASISPLATTE PCB | | 12 | * 75311R0006 | WÄRMEÜBERTRAGER TITANIUM | |
| 1 | * 75336R0021B | BASISPLATTE PCB | | 12 | * 75312R0006 | WÄRMEÜBERTRAGER TITANIUM | |
| 1 | * 75338R0021 | BASISPLATTE PCB | | 12 | * 75313R0006 | WÄRMEÜBERTRAGER TITANIUM | |
| 2 | 75336R0517 | SÄULE | | 13 | 75336R0005 | DURCHFLUSSMESSER | |
| 3 | 75336R0015 | LÜFTERMOTOR | | 14 | * 75336R0504 | FÜHRERHAUSRÜCKKWAND | |
| 4 | 75311R0014 | ROTORBLÄTTER VENTILATOR | | 14 | * 75338R0504 | FÜHRERHAUSRÜCKKWAND | |
| 5 | 75336R0513 | FRONTPLATTE | | 15 | 75311R0003 | MANOMETER | |
| 6 | 75336R0510 | RECHTENPLATTE | | 16 | 75311R0002 | KABELVERSCHRAUBUNGEN | |
| 7 | 75311R0012 | WASSERDICHTHE STEUERUNGSBOX | | 17 | 75336R0501 | ABDECKUNG OBEN | |
| 8 | 75311R0037B | STEUERUNG | | 18 | 75336R0023 | SPULE 4-WEGE-VENTIL | |
| 9 | * 75336R0009 | KOMPRESSOR | | 19 | 75336R0025 | SPULE EEV | |
| 9 | * 75337R0009 | KOMPRESSOR | | 20 | 75336R0037 | GASANSAUG TEMPERATURFÜHLER | |
| 9 | * 75338R0009 | KOMPRESSOR | | 21 | 75336R0026 | WASSERABFLUSS TEMPERATURFÜHLER | |

* SIEHE ANMERKUNGSBLATT

EINZELTEILE

ÜBER.: 0

10044

DATUM: 02/02/2024

BLATT: 2/3

CODE **1440, 1441, 1442, HPGIC30, HPGIC45, HPGIC60, HPGIC75**BESCHREIBUNG: **WÄRMEPUMPE**

| | | | | | |
|----|------------|-----------------------------|----|------------|--------------------------------|
| 10 | 75336R0007 | DETEKTOR NIEDERDRUCK | 22 | 75336R0028 | WASSERZUFLUSS TEMPERATURFÜHLER |
| 11 | 75336R0008 | DETEKTOR HOCHDRUCK | 23 | 75336R0029 | UMGEBUNGS TEMPERATURFÜHLER |
| 24 | 75336R0030 | VERDAMPFER TEMPERATURFÜHLER | 28 | 75311R0036 | WINTERDECKEL |
| 25 | 75336R0031 | GASDAUER TEMPERATURFÜHLER | 29 | 75311R0034 | WASSERDÜSE |
| 26 | 75311R0032 | WASSERANSCHLUSS SET | 30 | 75311R0033 | ABFLUSSSCHLAUCH |
| 27 | 75311R0035 | ANTI-VIBRATIONSFÜSSE | | | |

EINZELTEILE

ÜBER.: 0

10044

DATUM: 02/02/2024

BLATT: 3/3

CODE **1440, 1441, 1442, HPGIC30, HPGIC45, HPGIC60, HPGIC75**BESCHREIBUNG: **WÄRMEPUMPE**

HINWEISE

| POS | CODE | HINWEISE |
|-----|---------------|--|
| 1 | * 75336R0021A | FÜR: 1440, HPGIC30, HPGIC45 |
| 1 | * 75336R0021B | FÜR: 1441, HPGIC60 |
| 1 | * 75338R0021 | FÜR: 1442, HPGIC75 |
| 9 | * 75336R0009 | FÜR: 1440, HPGIC30, HPGIC45 |
| 9 | * 75337R0009 | FÜR: 1441, HPGIC60 |
| 9 | * 75338R0009 | FÜR: 1442 |
| 12 | * 75311R0006 | FÜR: 1440, HPGIC30, HPGIC45 |
| 12 | * 75312R0006 | FÜR: 1441, HPGIC60 |
| 12 | * 75313R0006 | FÜR: 1442, HPGIC75 |
| 14 | * 75336R0504 | FÜR: 1440, 1441, HPGIC30, HPGIC45, HPGIC60 |
| 14 | * 75338R0504 | FÜR: 1442, HPGIC75 |

ITEM

REV.: 0

10044

DATA: 02/02/2024

FOLHA: 1/3

CODIGO 1440, 1441, 1442, HPGIC30, HPGIC45, HPGIC60, HPGIC75

DESCRIÇÃO: BOMBA DE CALOR

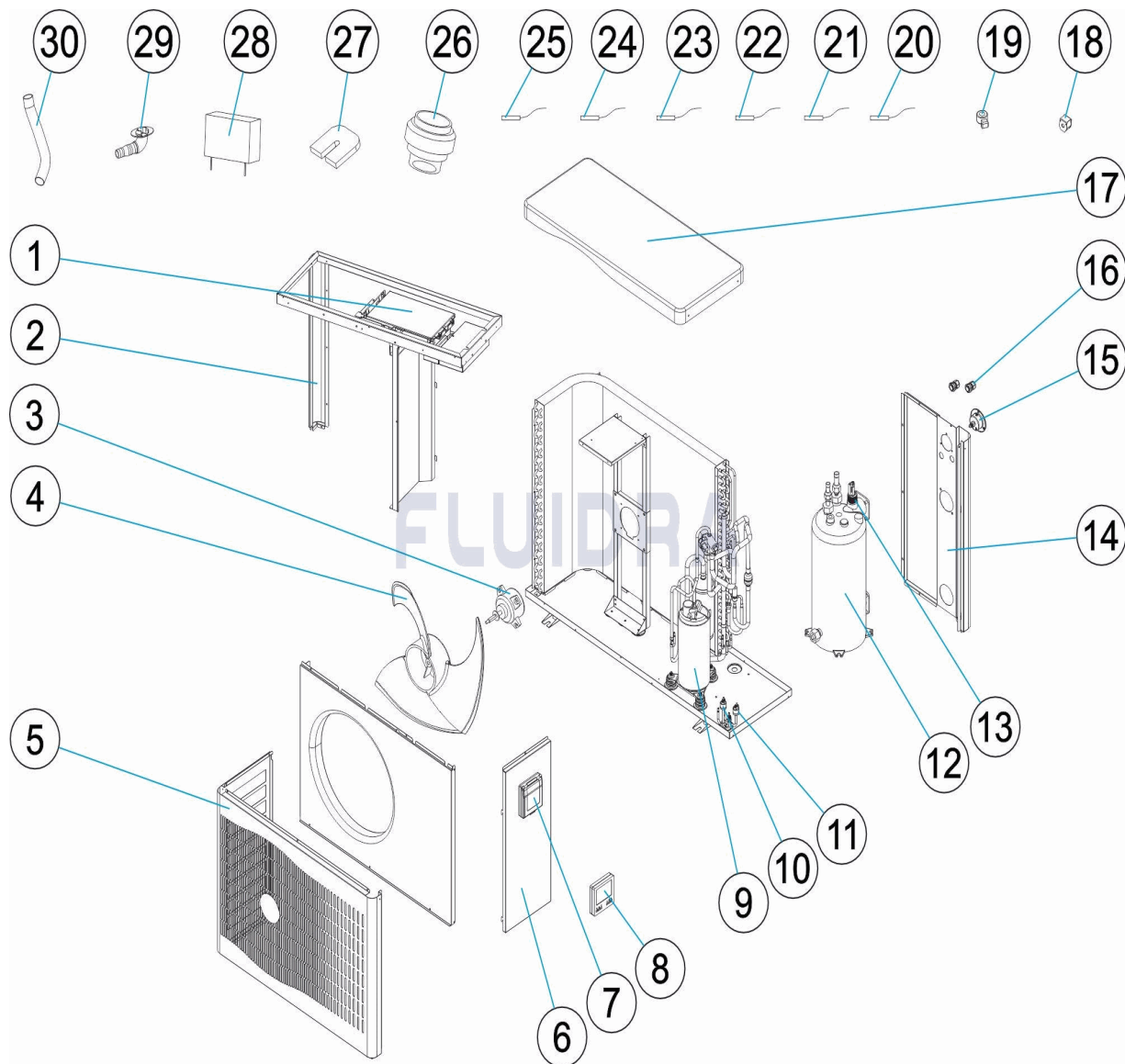

PORTUGUES

| POS | CODIGO | DESCRIÇÃO | JANTIDADE | POS | CODIGO | DESCRIÇÃO | JANTIDADE |
|-----|---------------|-------------------------------|-----------|-----|--------------|-------------------------------|-----------|
| 1 | * 75336R0021A | PLACA BASE PCB | | 12 | * 75311R0006 | PERMUTADOR DE TITÂNIO | |
| 1 | * 75336R0021B | PLACA BASE PCB | | 12 | * 75312R0006 | PERMUTADOR DE TITÂNIO | |
| 1 | * 75338R0021 | PLACA BASE PCB | | 12 | * 75313R0006 | PERMUTADOR DE TITÂNIO | |
| 2 | 75336R0517 | PILAR | | 13 | 75336R0005 | FLUXO-ESTATO | |
| 3 | 75336R0015 | MOTOR VENTILADOR | | 14 | * 75336R0504 | PAINEL TRASEIRO | |
| 4 | 75311R0014 | PÁS VENTILADOR | | 14 | * 75338R0504 | PAINEL TRASEIRO | |
| 5 | 75336R0513 | PAINEL FRONTAL | | 15 | 75311R0003 | MANOMETRO | |
| 6 | 75336R0510 | PAINEL DIREITO | | 16 | 75311R0002 | PRENSA-CABOS | |
| 7 | 75311R0012 | CAIXA DE CONTROLE IMPERMEÁVEL | | 17 | 75336R0501 | TAMPA SUPERIOR | |
| 8 | 75311R0037B | CONTROLLATORE | | 18 | 75336R0023 | BOBINA VÁLVULA DE 4 VIAS | |
| 9 | * 75336R0009 | COMPRESSOR | | 19 | 75336R0025 | BOBINA EEV | |
| 9 | * 75337R0009 | COMPRESSOR | | 20 | 75336R0037 | SENSOR TEMPERATURA SUÇÃO GÁS | |
| 9 | * 75338R0009 | COMPRESSOR | | 21 | 75336R0026 | SENSOR TEMPERATURA SAÍDA ÁGUA | |

* VEJA A FICHA DE OBSERVAÇÕES

ITEM

REV.: 0

10044

DATA: 02/02/2024

FOLHA: 2/3

CODIGO **1440, 1441, 1442, HPGIC30, HPGIC45, HPGIC60, HPGIC75**DESCRICAÇÃO: **BOMBA DE CALOR**

| | | | | | |
|----|------------|---------------------------------|----|------------|---------------------------------|
| 10 | 75336R0007 | DETECTOR DE BAIXA PRESSÃO | 22 | 75336R0028 | SENSOR TEMPERATURA ENTRADA ÁGUA |
| 11 | 75336R0008 | DETECTOR DE ALTA PRESSÃO | 23 | 75336R0029 | SENSOR TEMPERATURA AMBIENTE |
| 24 | 75336R0030 | SENSOR TEMPERATURA EVAPORADOR | 28 | 75311R0036 | COBERTURA DE INVERNO |
| 25 | 75336R0031 | SENSOR TEMPERATURA DESCARGA GÁS | 29 | 75311R0034 | BOCAL DE ÁGUA |
| 26 | 75311R0032 | CONJECTIVOS CONEXÃO DE ÁGUA | 30 | 75311R0033 | MANGUEIRA DE DRENAGEM |
| 27 | 75311R0035 | PÉS ANTIVIBRAÇÃO | | | |

* VEJA A FICHA DE OBSERVAÇÕES

ITEM

REV.: 0

10044

DATA: 02/02/2024

FOLHA: 3/3

CODIGO 1440, 1441, 1442, HPGIC30, HPGIC45, HPGIC60, HPGIC75

DESCRIÇÃO: BOMBA DE CALOR

OBSERVAÇÕES

| POS | CODIGO | OBSERVAÇÕES |
|-----|---------------|---|
| 1 | * 75336R0021A | PARA: 1440, HPGIC30, HPGIC45 |
| 1 | * 75336R0021B | PARA: 1441, HPGIC60 |
| 1 | * 75338R0021 | PARA: 1442, HPGIC75 |
| 9 | * 75336R0009 | PARA: 1440, HPGIC30, HPGIC45 |
| 9 | * 75337R0009 | PARA: 1441, HPGIC60 |
| 9 | * 75338R0009 | PARA: 1442 |
| 12 | * 75311R0006 | PARA: 1440, HPGIC30, HPGIC45 |
| 12 | * 75312R0006 | PARA: 1441, HPGIC60 |
| 12 | * 75313R0006 | PARA: 1442, HPGIC75 |
| 14 | * 75336R0504 | PARA: 1440, 1441, HPGIC30, HPGIC45, HPGIC60 |
| 14 | * 75338R0504 | PARA: 1442, HPGIC75 |